

STA. 1+490.712
OFFSET LT. 4 350
TOP OF APPROACH SLAB
EL. 175.969

STA. 1+496.924
OFFSET LT. 4 350
TOP OF APPROACH SLAB
EL. 176.074

STA. 1+522.960
OFFSET LT. 4 350
TOP OF APPROACH SLAB
EL. 176.284

STA. 1+528.862
OFFSET LT. 4 350
TOP OF APPROACH SLAB
EL. 176.280

BEGIN APPROACH
SLAB NO. 1
STA. 1+492.090
TOP OF APPROACH SLAB
EL. 175.732

BEGIN BRIDGE
STA. 1+498.090
END APPROACH SLAB NO. 1
TOP OF APPROACH SLAB
EL. 175.830

BEGIN APPROACH
SLAB NO. 2
STA. 1+524.512
TOP OF APPROACH SLAB
EL. 176.024

END APPROACH
SLAB NO. 2
STA. 1+530.512
TOP OF APPROACH SLAB
EL. 176.015

STA. 1+493.255
OFFSET RT. 4 350
TOP OF APPROACH SLAB
EL. 175.492

STA. 1+499.263
OFFSET RT. 4 350
TOP OF APPROACH SLAB
EL. 175.586

STA. 1+526.114
OFFSET RT. 4 350
TOP OF APPROACH SLAB
EL. 175.762

STA. 1+532.215
OFFSET RT. 4 350
TOP OF APPROACH SLAB
EL. 175.748

APPROACH SLAB PLAN VIEW

SCALE 1:50

SEE VALUE
ENGINEERING
DESIGN
(FOLLOWING SHEET)

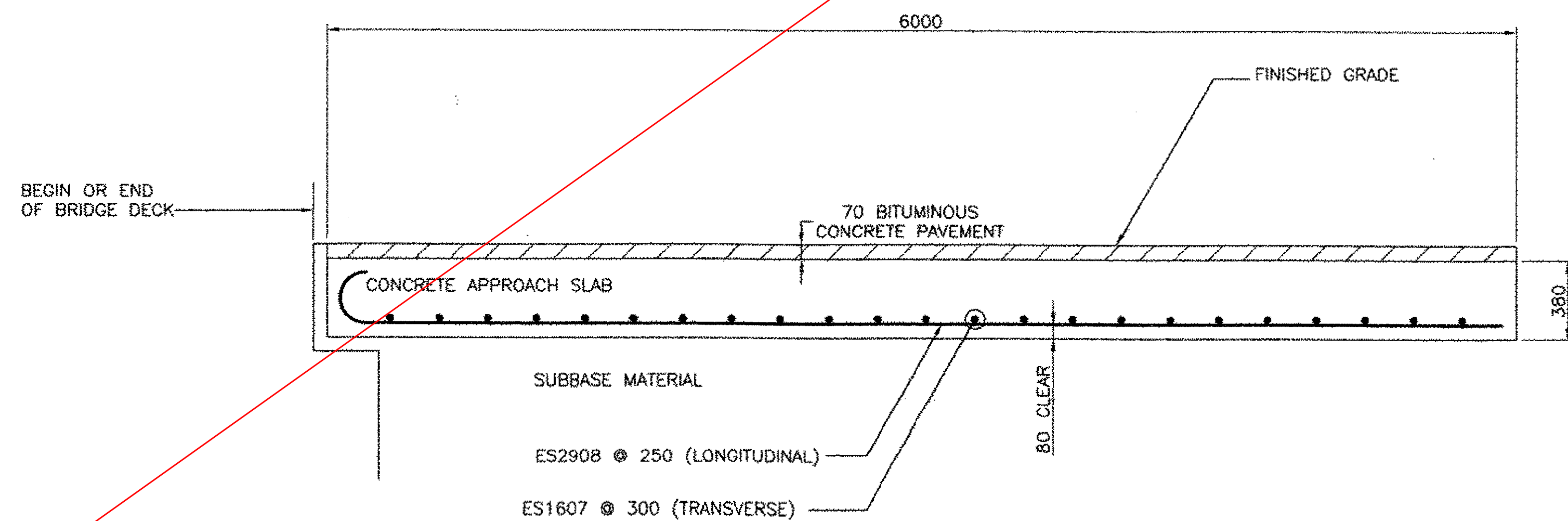

APPROACH SLAB DETAIL

SCALE 1:20

REVISIONS			STATE OF VERMONT AGENCY OF TRANSPORTATION	
NO.	DESCRIPTION	BY & DATE		
			CLARENDON, VERMONT	
			TOWN HIGHWAY NO. 1	
			TOWN HIGHWAY NO. 1 OVER THE COLD RIVER	
			APPROACH SLAB DETAILS	
			Designed by: B. C. AUSTIN	Drawn by: E. B. SMALL
			Checked by: K. S. MARSHIA date 05/02	Bridge Design Supervisor: J.W. TUCKER date 05/02
			PROJECT: CLARENDON	PROJECT NO.: BRO 1443(29)
			Bridge Sheet No.	SHEET 29 OF 41

