

LEGEND

- 100 MAPLE DECIDUOUS TREE
- 100 PINE CONIFEROUS TREE
- STUMP
- EXISTING TREE LINE
- NEW TREE LINE
- EDGE OF NEW PAVEMENT
- OVERHEAD LINE
- EXISTING GRAVEL ROAD
- PROPOSED GRAVEL ROAD
- SURVEY CONTROL LOCATION
- UTILITY POLE
- GUY WIRE
- MAIL BOX
- STONE WALL
- R.O.W.
- EXISTING GUARD RAIL
- EDGE OF RIVER
- CLEAR ZONE
- TEMPORARY BRIDGE CONSTRUCTION LIMITS
- EXISTING STONEFILL
- TEMPORARY PROTECTIVE FENCING

REMOVE AND RESET FENCE
 STA. 1+525.153 LT TO 1+545.117 LT
 REMOVE AS NECESSARY, AND TEMPORARILY RESET AS FENCE REMOVED
 DIRECTED BY ENGINEER OUTSIDE CONSTRUCTION LIMITS.
 THEN RESET WHEN CONSTRUCTION IS COMPLETED. PAYMENT
 FOR TEMPORARY RESET SHALL BE INCIDENTAL TO
 ITEM 620.50

CONSTRUCT NEW FIELD DRIVE
 STA. 1+552.542 PAVEMENT TO
 R.O.W. LIMIT. CRUSHED GRAVEL
 FROM R.O.W. LIMIT TO FIELD
 DRIVE STA. 0+025.000
 SEE DETAIL SHEET 37.

NOTE:
 THE EXISTING ADELPHIA OVERHEAD CABLE RUNS OVER
 WINGWALLS 1 & 3. THE CONTRACTOR WILL BE RESPONSIBLE
 TO MAKE ARRANGEMENTS WITH ADELPHIA TO TEMPORARILY
 RELOCATE THIS LINE IF THEY CANNOT BUILD THE PROJECT
 WITH THE LINE IN ITS PRESENT POSITION.

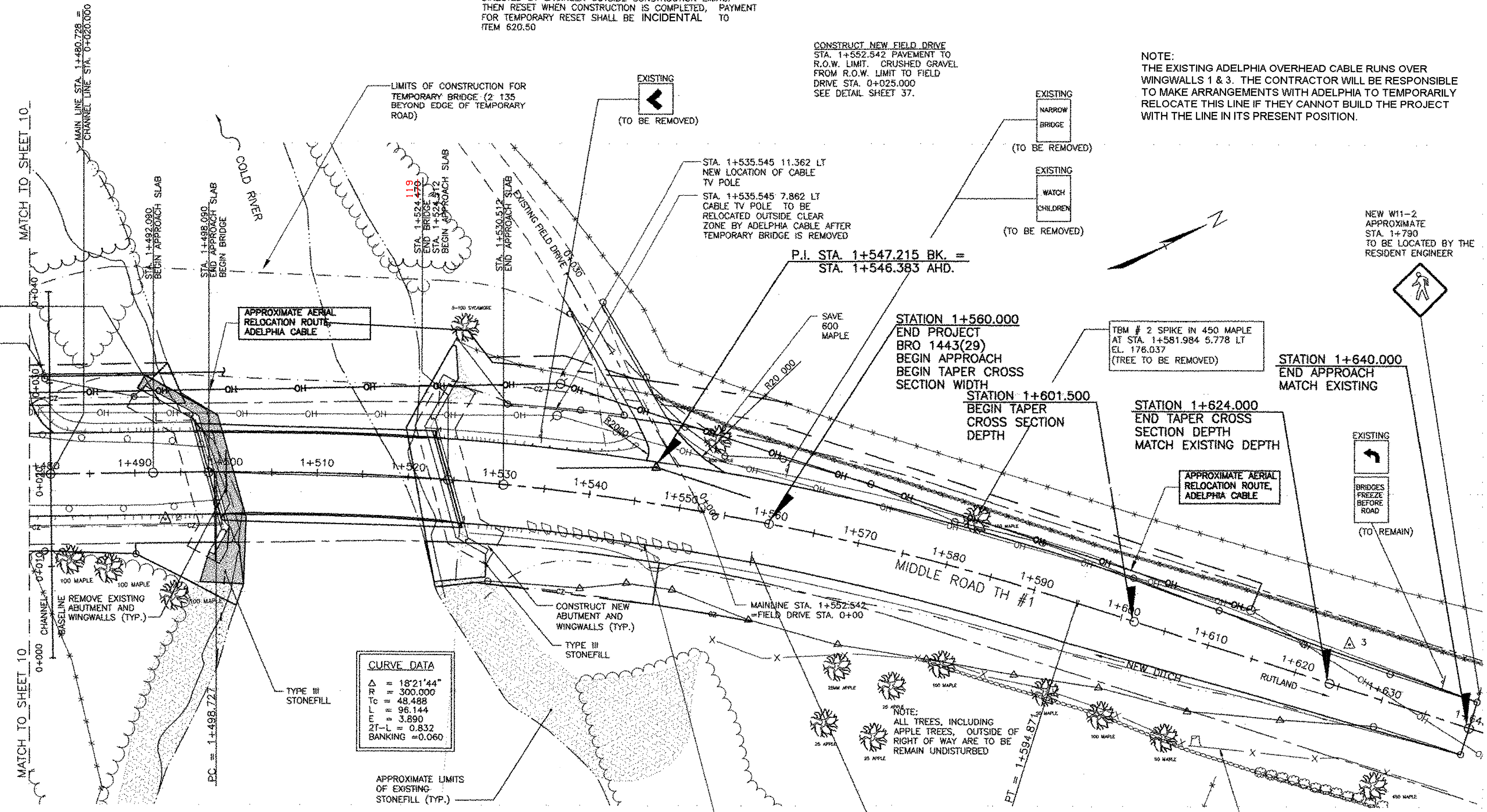

CURVE DATA

Δ	= 18°21'44"
R	= 300.000
Tc	= 48.488
L	= 96.144
E	= 3.890
2T-L	= 0.832
BANKING	= 0.060

EXISTING BRIDGE DATA

STRUCTURE TYPE : STEEL PONY TRUSS W/ CONCRETE DECK BRIDGE
 CLEAR SPAN: 22.8 m
 DISPOSITION OF STRUCTURE: TO BE REMOVED AND DISPOSED OF

- REMOVE AND RESET FENCE**
 STA. 1+433.000 to STA. 1+477.000 RT
 STA. 1+525.153 to STA. 1+545.117 LT
- RELOCATE MAILBOX SINGLE SUPPORT**
 STA. 1+429.000 LT
- CONSTRUCT DRIVES**
 STA. 1+435.250 LT
 STA. 1+444.900 LT
 STA. 1+475.000 LT
 STA. 1+552.542 LT
- CONSTRUCT DITCH**
 STA. 1+528.000 to STA. 1+625.000 RT
- BRIDGE RAILING**
 STA. 1+494.173 to STA. 1+525.725 LT
 STA. 1+496.457 to STA. 1+529.074 RT
- GUARDRAIL APPROACH SECTION, NETC 2 RAIL**
 STA. 1+486.553 to STA. 1+494.173 LT
 STA. 1+488.837 to STA. 1+496.457 RT
 STA. 1+525.725 to STA. 1+533.345 LT
 STA. 1+529.074 to STA. 1+536.694 RT
- MODIFIED ECCENTRIC LOAD TERMINAL**
 STA. 1+533.345 to STA. 1+544.745 LT
 STA. 1+460.268 to STA. 1+471.668 RT
 STA. 1+536.694 to STA. 1+548.094 RT
- HEAVY DUTY STEEL BEAM GUARDRAIL**
 STA. 1+471.668 to STA. 1+488.837 RT
 STA. 1+479.614 to STA. 1+486.553 LT
- ANCHOR FOR GUARDRAIL**
 STA. 1+480.883 LT

LAYOUT PLAN

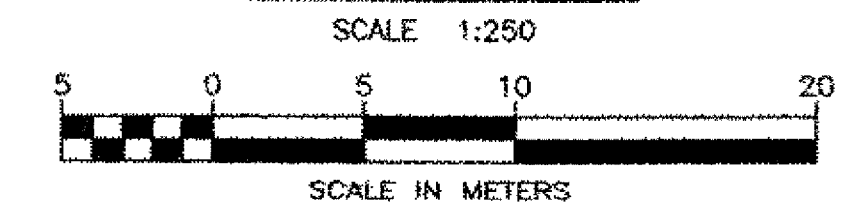

REVISIONS		
NO.	DESCRIPTION	BY & DATE

STATE OF VERMONT AGENCY OF TRANSPORTATION	
CLARENDON, VERMONT	Bridge No. 14
TOWN HIGHWAY NO. 1	Log Sta.
TOWN HIGHWAY NO. 1 OVER THE COLD RIVER	
LAYOUT SHEET	
Designed by: W.S. CHESBROUGH	Drawn by: N.B. DIMICK
Checked by: K.S. MARSHIA date 05/02	Bridge Design Supervisor: J.W. TUCKER date 05/02
PROJECT: CLARENDON	PROJECT NO.: BRO 1443(29)
Bridge Sheet No.	SHEET 11 OF 41

