

SEE SHEET 2 FOR INDEX OF SHEETS

STATE OF VERMONT AGENCY OF TRANSPORTATION



PROPOSED IMPROVEMENT BRIDGE PROJECT

CITY OF BARRE
COUNTY OF WASHINGTON

ROUTE NO : GRANITE STREET, CL 2 BRIDGE NO : 11

PROJECT LOCATION : BEGINNING AT A POINT ON GRANITE STREET APPROXIMATELY 0.222 MILES
SOUTHWESTERLY OF THE INTERSECTION OF US 302 (NORTH MAIN STREET)
AND EXTENDING NORTHERLY 0.038 MILES FROM THE INTERSECTION OF BURNHAM STREET.

PROJECT DESCRIPTION : THE REPLACEMENT OF STRUCTURALLY DEFICIENT BRIDGE #11 WITH A
NEW PREFABRICATED STEEL TRUSS STRUCTURE INCLUDING ALL THE NECESSARY
ROADWAY APPROACH WORK.

LENGTH OF STRUCTURE : 116.67 FEET
LENGTH OF ROADWAY : 83.33 FEET
LENGTH OF PROJECT : 200.00 FEET

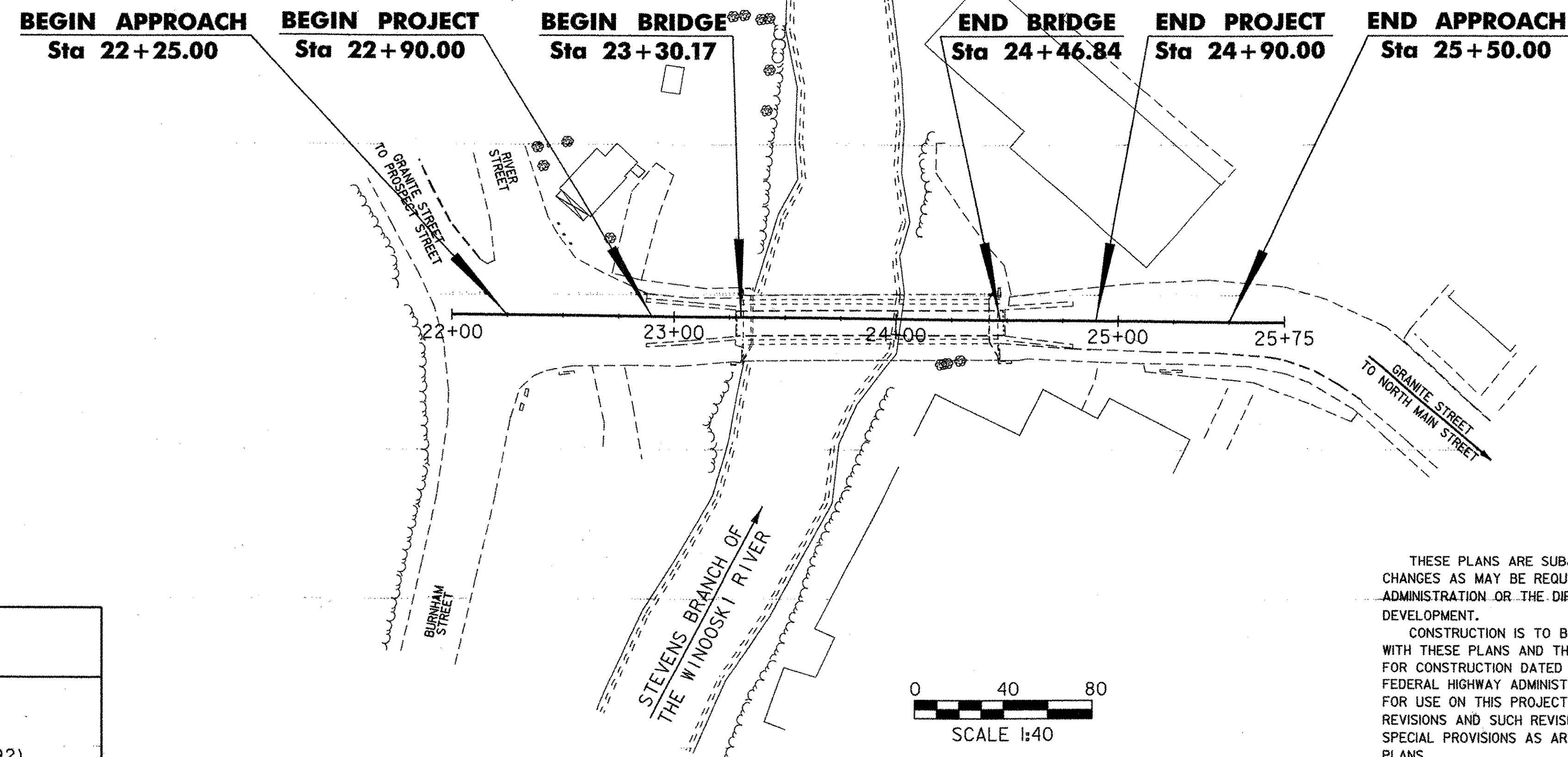
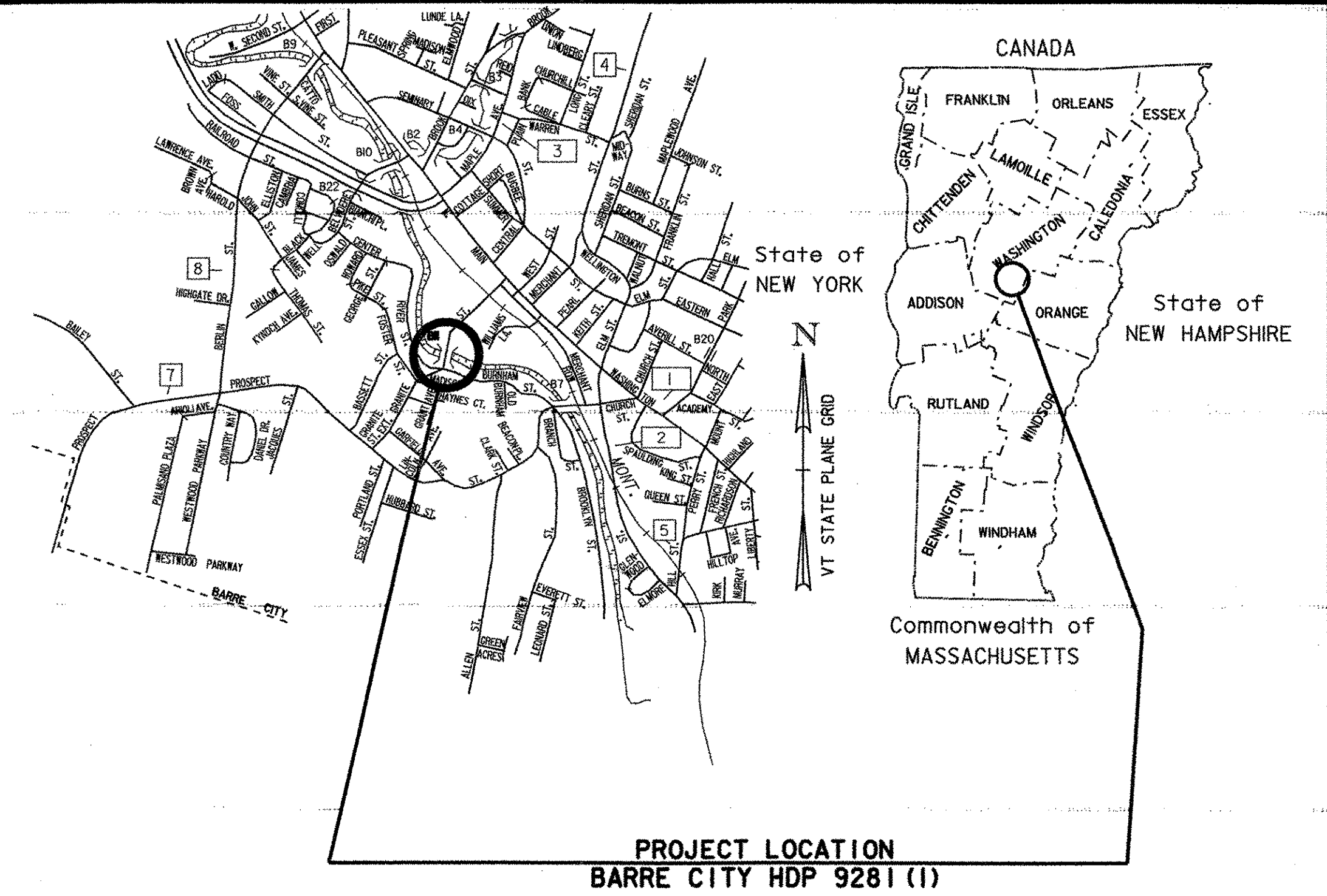

RECORD PLANS	
CONTRACTOR:	WINTERSET, INC. - LYNDONVILLE, VT
RESIDENT ENGINEER:	JIM FOREST
CONSTRUCTION BEGAN:	SEPTEMBER 24, 2004
CONSTRUCTION COMPLETE:	NOVEMBER 15, 2006
RECORD PLANS BY:	JIM FOREST & CRAIG PIERCE
I HEREBY CERTIFY THAT ALL THE CONSTRUCTION REQUIRED BY THIS SET OF DRAWINGS HAS BEEN ACCOMPLISHED AS INDICATED HEREIN.	
BY	<i>James C. Forest</i> RESIDENT ENGINEER
DATE	04-18-07
NOTE: Any further information concerning final quantities, amounts or other details relative to this project may be found at Central Files in the electronic archives.	

CONVENTIONAL SYMBOLS	
COUNTY LINE	
TOWN LINE	
LIMITS OF ACCESS	
POINT OF ACCESS	
FENCE LINE	
STONE WALL	
TRAVELED WAY	
GUARD RAIL	
RAILROAD	
SURVEY LINE	
CULVERT	
POWER POLE	
TELEPHONE POLE	
TREES	
CONTROL OF ACCESS	
PROPERTY LINE	
R.O.W. TAKING LINE	
SLOPE RIGHTS	
TOP OF CUT	
TOE OF SLOPE	

SURVEYED BY :
SURVEYED DATE :

DATUM
VERTICAL NAVD88
HORIZONTAL NAD83 (92)

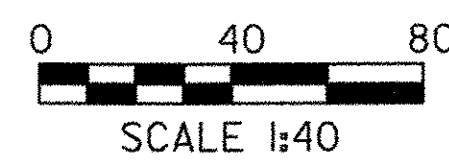

THESE PLANS ARE SUBJECT TO SUCH ENGINEERING CHANGES AS MAY BE REQUIRED BY THE FEDERAL HIGHWAY ADMINISTRATION OR THE DIRECTOR OF PROJECT DEVELOPMENT.
CONSTRUCTION IS TO BE CARRIED ON IN ACCORDANCE WITH THESE PLANS AND THE STANDARD SPECIFICATIONS FOR CONSTRUCTION DATED 2001, AS APPROVED BY THE FEDERAL HIGHWAY ADMINISTRATION ON JANUARY 4, 2001 FOR USE ON THIS PROJECT, INCLUDING ALL SUBSEQUENT REVISIONS AND SUCH REVISED SPECIFICATIONS AND SPECIAL PROVISIONS AS ARE INCORPORATED IN THESE PLANS.

DEPARTMENT OF TRANSPORTATION FEDERAL HIGHWAY ADMINISTRATOR	
APPROVED _____	DATE _____
DIRECTOR OF PROJECT DEVELOPMENT	
APPROVED <i>[Signature]</i>	DATE 5/19/07
PROJECT MANAGER : CRAIG KELLER	
PROJECT NAME : BARRE CITY	
PROJECT NUMBER : HDP 9281 (1)	
SHEET 1 OF 58 SHEETS	