

4" YELLOW LINE (DOUBLE LINE)
 SUR M STA 10+50 - REV M STA 11+85
 SUR M STA 12+62 - SUR M STA 16+00
 REV S "A" STA 0+26 - REV S "A" STA 1+50
 REV S "B" STA 0+22 - REV S "B" STA 1+50

24" STOP BAR
 REV S "A" STA 0+26
 REV S "B" STA 0+22

LETTERS
 (STOP) REV S "A" STA 0+35
 (STOP) REV S "B" STA 0+30

REMOVING SIGNS
 (STOP) REV S "A" STA 0+24
 (STOP) REV S "B" STA 0+26

STOP SIGNS
 REV S "A" STA 0+32 LT
 REV S "B" STA 0+25 LT

CROSSWALK WITH DIAGONAL LINES
 REV M STA 11+72 RT - REV M STA 12+42 RT

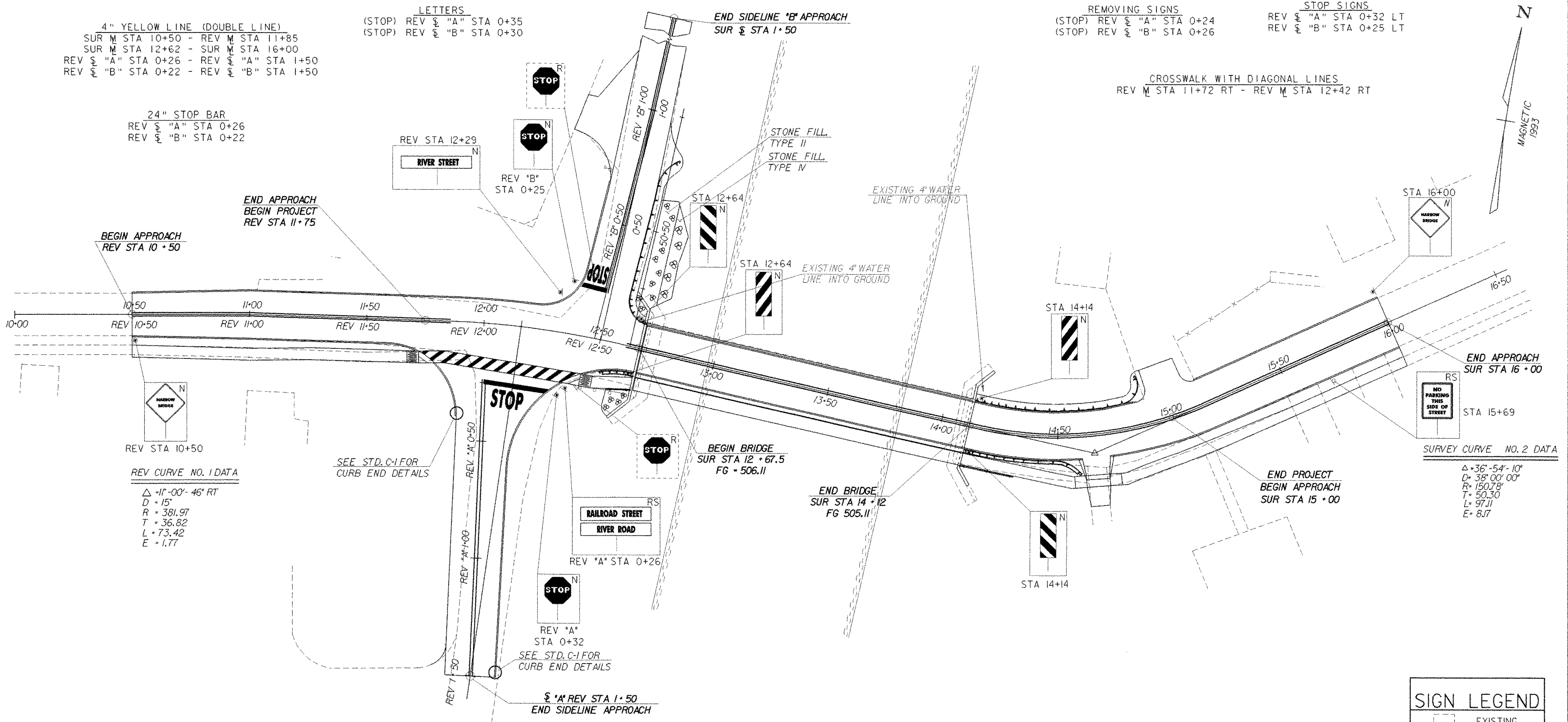

REV CURVE NO. 1 DATA
 $\Delta = 11^{\circ}00' - 46'$ RT
 $D = 15'$
 $R = 381.97$
 $T = 36.82$
 $L = 73.42$
 $E = 1.77$

SEE STD. C-1 FOR CURB END DETAILS

BEGIN BRIDGE
 SUR STA 12 + 67.5
 FG = 506.11

END BRIDGE
 SUR STA 14 + 12
 FG 505.11

END PROJECT
 BEGIN APPROACH
 SUR STA 15 + 00

SURVEY CURVE NO. 2 DATA
 $\Delta = 36^{\circ}54' - 10'$
 $D = 38^{\circ}00' - 00'$
 $R = 150.78$
 $T = 50.30$
 $L = 97.11$
 $E = 8.17$

SIGN LEGEND	
	EXISTING
	REMOVE
	NEW
	NEW
	REMOVE AND SALVAGE

SCALE 1" = 20'-0"
 20 0 20

SHEET NAME: SIGN LAYOUT AND LINE STRIPING	
PROJECT NAME: JOHNSON	HIGHWAY NO.: TH 2
PROJECT NUMBER: BHO 1448(18)	BRIDGE NO.: 6
	OVER: THE LAMOILLE RIVER
FILE NAME: /s/tri/90j067/sj067sgn.dgn	PLOT DATE: 02-SEP-2005
PROJECT MANAGER: R. WHITCOMB	DRAWN BY: J. GILMORE
DESIGNED BY: C. MEUNIER	IPARM NAME: sc067sls.1
BRIDGE SHEET NUMBER:	SHEET 48 OF 73