

**BRIDGE RAILING: HD STEEL BEAM/
FASCIA MOUNTED/STEEL TUBING**

ML STA. 2+29 LT - ML STA. 2+67 LT
ML STA. 2+40 RT - ML STA. 2+77 RT

HD STEEL BEAM GUARD RAIL

REV. SL STA. 18+59 LT - ML STA. 2+29 LT
ML STA. 2+67 LT - ML STA. 2+68 LT
REV. SL STA. 19+87 LT - ML STA. 2+40 RT
ML STA. 2+77 RT - ML STA. 3+45 RT

ANCHOR FOR STEEL BEAM RAIL

REV. SL STA. 18+67 LT
REV. SL STA. 19+80 LT
ML STA. 3+37 RT

**CONSTRUCT TYPE I STONE LINED DITCH
w/ GEOTEXTILE UNDER STONE FILL**

ML STA. 2+75 RT - ML STA. 3+92 RT

CONSTRUCT DITCH

ML STA. 4+33 RT - ML STA. 4+62 RT

REMOVE SMALL TREES

ML STA. 1+72, 18' LT, 24" MAPLE
ML STA. 2+24, 23' LT, 18" MAPLE
ML STA. 4+25, 6" MAPLE

WOOD MARKER POST

ML STA. 1+65 LT
ML STA. 1+73 LT
ML STA. 1+78 LT
ML STA. 1+82 LT

**CONSTRUCT GRAVEL DRIVE
WITH PAVED APRON**

ML STA. 1+03 LT
ML STA. 2+75 LT
ML STA. 3+28 LT
ML STA. 4+16 RT

WOOD GUIDE POST
ML 3+92 +/- RT (4)
ML 4+24 +/- LT (4)

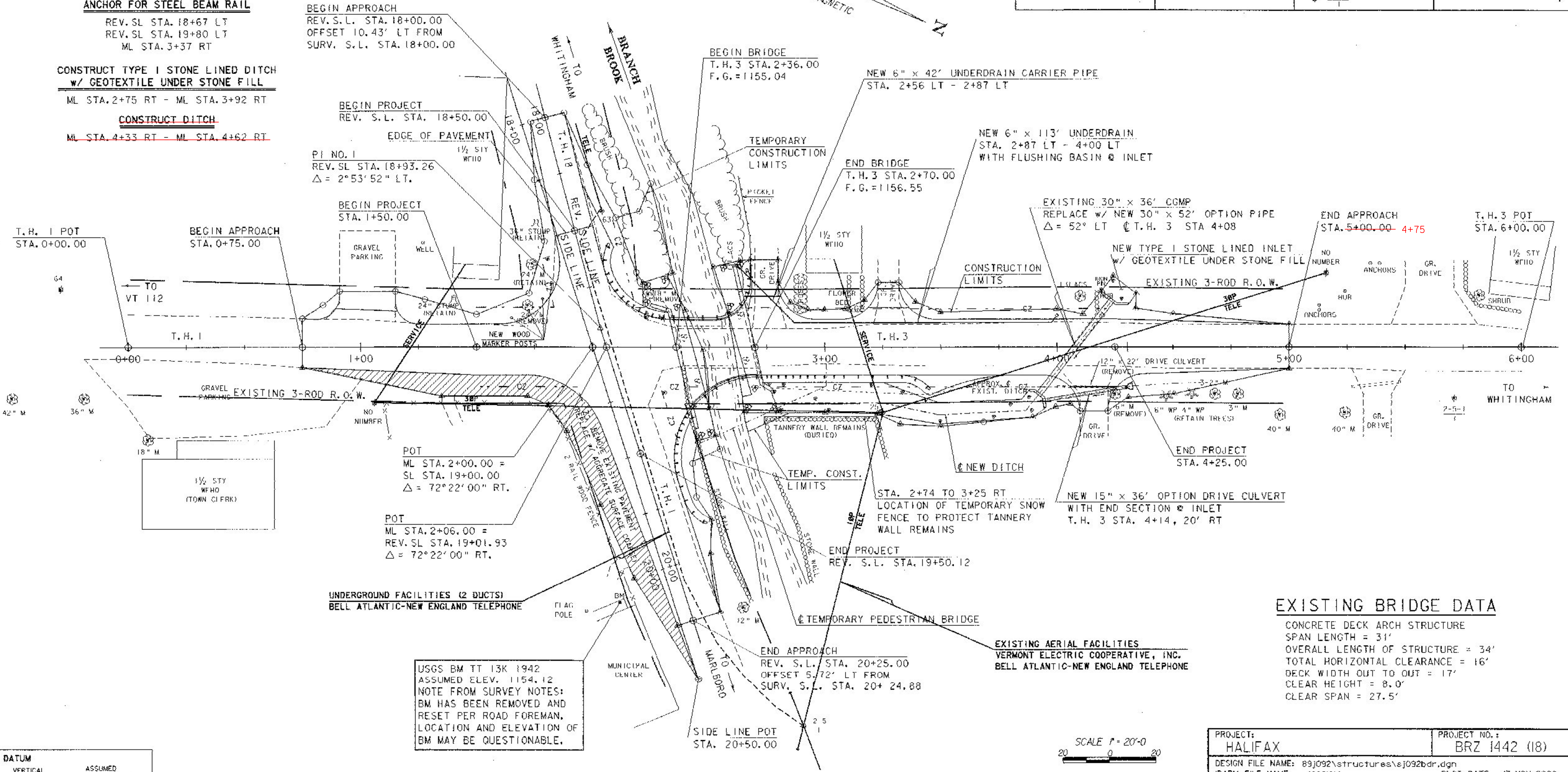
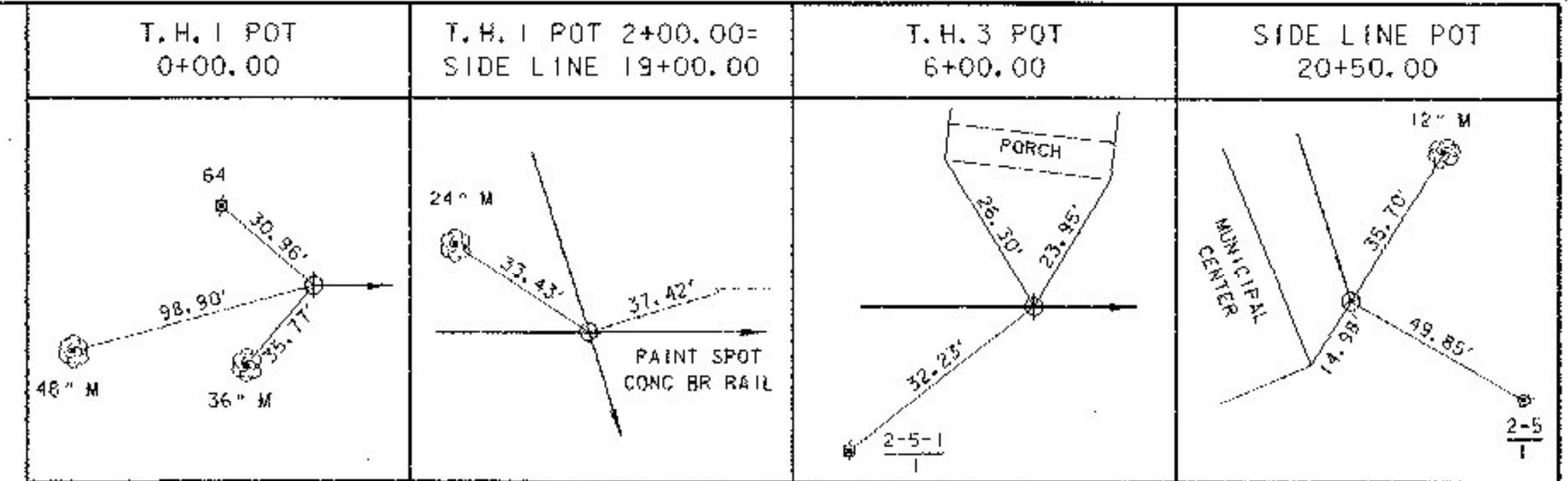

EXISTING BRIDGE DATA

CONCRETE DECK ARCH STRUCTURE
SPAN LENGTH = 31'
OVERALL LENGTH OF STRUCTURE = 34'
TOTAL HORIZONTAL CLEARANCE = 16'
DECK WIDTH OUT TO OUT = 17'
CLEAR HEIGHT = 8.0'
CLEAR SPAN = 27.5'

USGS BM TT 13K 1942
ASSUMED ELEV. 1154.12
NOTE FROM SURVEY NOTES:
BM HAS BEEN REMOVED AND
RESET PER ROAD FOREMAN.
LOCATION AND ELEVATION OF
BM MAY BE QUESTIONABLE.

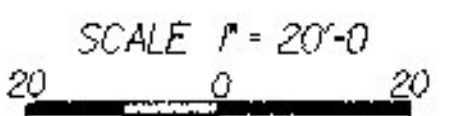

DATUM	
VERTICAL	ASSUMED
HORIZONTAL	N/A

PROJECT: HALIFAX	PROJECT NO. # BRZ 1442 (18)
DESIGN FILE NAME: 89j092\structures\sj092bdr.dgn	PLOT DATE: 17-NOV-2000
IPARM FILE NAME: sj092101.i	SURVEY DATE: 1/99
SURVEYED BY: FELTON	DRAWN BY: J. ARMSTRONG
PROJECT MANAGER: R. R. WHITCOMB	SHEET: 9 OF 33
LAYOUT SHEET	