

Readsboro BRF0105(3)

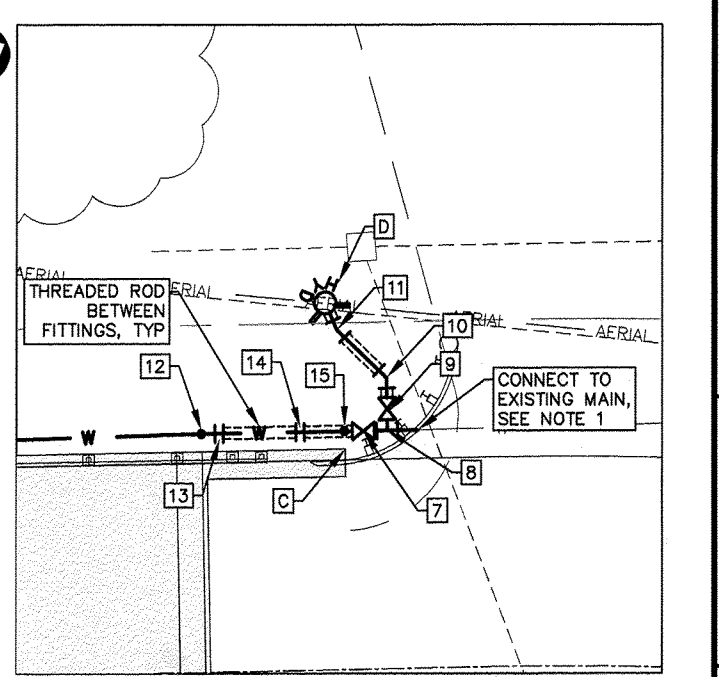
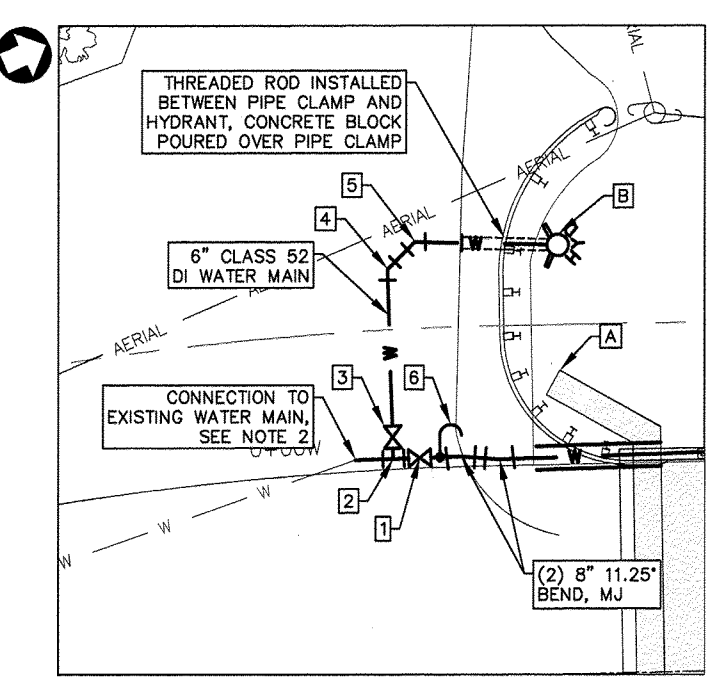
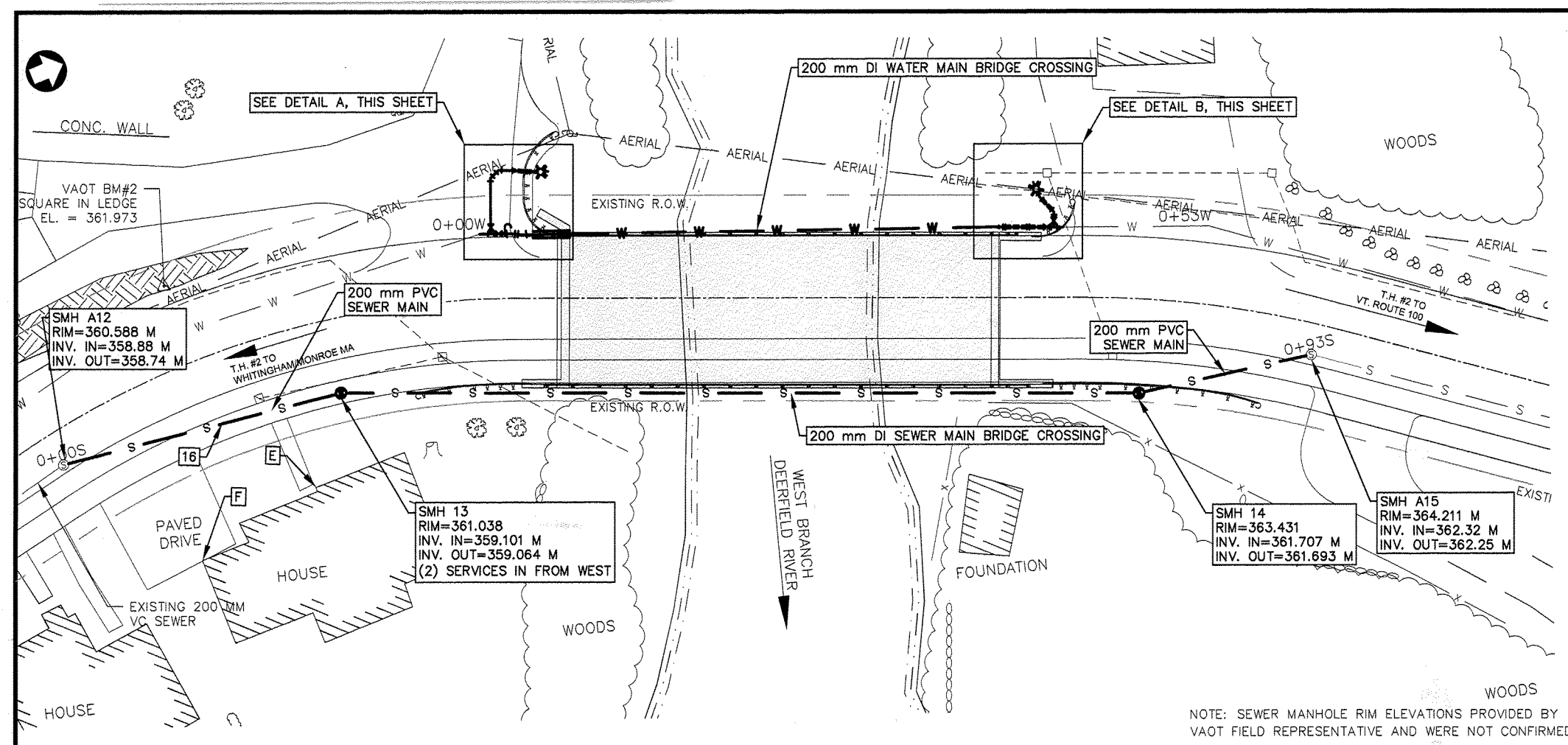

**DETAIL A - WATER MAIN (SOUTH END):**  
SCALE: 1:100  
NOTES:  
1. 4" THICK RIGID BOARD INSULATION INSTALLED OVER 6" WATER MAIN BETWEEN ITEM 3 (6" GATE VALVE) AND ITEM B (HYDRANT)  
2. CONNECTION TO EXISTING MAIN SHOWN IN APPROXIMATE LOCATION. CONNECTION WAS NOT FIELD OBSERVED.

**DETAIL B - WATER MAIN (NORTH END):**  
SCALE: 1:100  
NOTES:  
1. CONNECTION TO EXISTING MAIN SHOWN IN APPROXIMATE LOCATION. CONNECTION WAS NOT FIELD OBSERVED.

NOTE: SEWER MANHOLE RIM ELEVATIONS PROVIDED BY VAOT FIELD REPRESENTATIVE AND WERE NOT CONFIRMED.

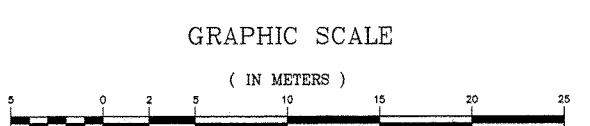

TIES (FEET)					
NUMBER	ITEM DESCRIPTION	LETTER	TIE	LETTER	TIE
1	8" GATE VALVE WITH VALVE BOX, MJ	A	12.0	B	17.6
2	8"x6" DI ANCHOR TEE, MJ	-	-	-	-
3	6" GATE VALVE WITH VALVE BOX	A	12.8	B	18.0
4	6" 45° DI BEND, MJ	-	-	-	-
5	6" 45° DI BEND, MJ	-	-	-	-
6	3/4" MANUAL AIR RELEASE	A	9.2	B	13.7
7	8" GATE VALVE WITH VALVE BOX, MJ	C	3.3	D	9.1
8	8"x6" DI ANCHOR TEE, MJ	-	-	-	-
9	6" GATE VALVE WITH VALVE BOX, MJ	C	5.4	D	8.5
10	6" 45° DI BEND, MJ	-	-	-	-
11	6" 22.5° DI BEND, MJ	-	-	-	-
12	3/4" MANUAL AIR RELEASE	-	-	-	-
13	8" 45° DI BEND, VERT, MJ	-	-	-	-
14	8" 45° DI BEND, VERT, MJ	-	-	-	-
15	2" CORPORATION WITH SADDLE	-	-	-	-
16	8"x4" SEWER SERVICE WYE	E	27.7	F	33.7

LETTER TIE POINT			
A	SW CORNER OF WINGWALL		
B	HYDRANT		
C	NW CORNER OF WINGWALL		
D	HYDRANT		
E	BUILDING CORNER		
F	BUILDING CORNER		

DISTANCES (FEET)		
FROM	TO	DISTANCE
B	5	10.0
A	B	8.9
3	4	11.5
4	5	3.0
9	10	2.5
10	11	8.9
11	D	2.1
7	14	8.0
7	15	APP. 2.0

**GENERAL NOTES:**

- EXISTING DRAWINGS PROVIDED BY VTRANS. LOCATION OF EXISTING UTILITIES ARE APPROXIMATE BASED ON INFORMATION PROVIDED BY THE TOWN OF READSBORO. THIS IS NOT A BOUNDARY SURVEY.
- EXPLORATORY EXCAVATION IS REQUIRED TO LOCATE UNDERGROUND UTILITIES. CONTRACTOR SHALL USE EXTREME CAUTION TO PREVENT DAMAGE TO EXISTING UTILITIES. CONTRACTOR SHALL COORDINATE WITH DIG SAFE (1-888-DIG SAFE) A MINIMUM OF 72 HOURS PRIOR TO EXCAVATION.
- LOCATION OF PROPOSED WATER MAIN IS INTENDED NOT TO DISTURB ROOT SYSTEMS OF EXISTING TREES OR SHRUBS. CONTRACTOR SHALL EXERCISE DUE CARE TO PREVENT DAMAGE THERETO. ALL DISTURBED AREAS SHALL BE RESTORED TO PRECONSTRUCTION CONDITIONS.
- ALL WORK IS TO BE DONE SHALL BE IN PUBLIC RIGHT-OF-WAY OR EASEMENT AREAS. REFER TO R.O.W. AND EASEMENT LIMITS ON SEPARATE VAOT SHEETS.
- LISTING OF ADAPTERS, FITTINGS, NIPPLES, ETC IS FOR THE CONVENIENCE OF THE CONTRACTOR ONLY. ADDITIONAL MATERIAL MAY BE REQUIRED. SLOD SLEEVE COUPLINGS WILL BE REQUIRED FOR CONNECTION TO EXISTING MAINS.
- MINIMUM VERTICAL CLEARANCE BETWEEN NEW WATER MAINS AND ALL EXISTING UTILITIES, EXCEPT SEWERS AND STORM DRAINS TO BE 150 mm AT CROSSING LOCATIONS.
- ALL BURIED FITTINGS MUST BE BLOCKED. REFER TO THRUST BLOCK DETAILS, AND TRENCH DETAIL SHOWN ON DRAWING C4.
- MECHANICAL JOINT RESTRAINTS SHALL BE USED WHERE VALVES WILL BE SUBJECTED TO SERVICE PRESSURES ON ONE SIDE BEFORE BEING FULLY INCORPORATED INTO THE DISTRIBUTION SYSTEM.
- WATER MAINS TO HAVE 1.675 METERS MINIMUM COVER UNLESS OTHERWISE STATED OR SHOWN ON THE PROFILES. WHEN 1.675 METERS OF COVER CANNOT BE MAINTAINED 100 mm RIGID BOARD INSULATION SHALL BE USED. DEPTH OF COVER SHALL NOT BE LESS THAN 1.200 METERS EVEN WITH INSULATION. SEE MATERIAL SPECIFICATION SECTION 735.01.
- ALL MECHANICAL JOINT FITTINGS AND VALVES SHALL INCORPORATE A WEDGE-STYLE RETAINER GLAND INSTEAD OF THE COMMON FOLLOWER GLAND, AT THE CONTRACTOR'S EXPENSE.
- ALL EXISTING UNDERGROUND UTILITIES WERE LOCATED USING THE BEST AVAILABLE INFORMATION. CONTRACTOR IS RESPONSIBLE FOR PROTECTION OF ALL UTILITIES WHETHER OR NOT THEY ARE SHOWN ON THE PLANS. ALL REPAIRS TO DAMAGED UTILITIES SHALL BE MADE BY THE CONTRACTOR USING MATERIALS APPROVED BY THE ENGINEER PRIOR TO INSTALLATION, AT THE CONTRACTOR'S EXPENSE.
- CONTRACTOR IS RESPONSIBLE FOR FLUSHING, PRESSURE TESTING AND DISINFECTING ALL NEW WATER MAIN. CHLORINE INJECTION POINTS SHALL BE INSTALLED WHERE REQUIRED AND APPROVED BY THE ENGINEER PRIOR TO INSTALLATION AND REMOVED UPON COMPLETION OF TESTING. CONTRACTOR IS RESPONSIBLE FOR TESTING ALL SEWER MANHOLES AND SEWER MAIN ACCORDING TO THE SPECIFICATIONS.
- CONTRACTOR SHALL VERIFY LOCATION OF ALL OVERHEAD AND UNDERGROUND ELECTRIC, CABLE AND TELEPHONE LINES AND TAKE NECESSARY PRECAUTIONS IN STRICT ACCORDANCE WITH OSHA STANDARDS DURING CONSTRUCTION. CONTRACTOR SHALL CONTACT THE LOCAL POWER UTILITY AND TELEPHONE UTILITY REGARDING ANY NECESSARY SUPPORT OF ANY UTILITY POLES DURING CONSTRUCTION. LOCAL ELECTRIC UTILITY IS CVPS. LOCAL PHONE UTILITY IS FAIRPOINT.
- TEMPORARY WATER AND SEWER ARE REQUIRED FOR THIS PROJECT. TEMPORARY SEWER SHALL BE PROVIDED USING A TEMPORARY GRAVITY SYSTEM OR BY MEANS OF BYPASS PUMPING. ANY ABOVE GROUND PIPING SHALL BE SECURED TO THE TEMPORARY BRIDGE OR OTHER RIGID STRUCTURES AT A SPACING OF 3.05 M MINIMUM. THE CONTRACTOR SHALL SUBMIT A TEMPORARY UTILITIES PLAN TO THE ENGINEER PRIOR TO THE INSTALLATION. TEMPORARY UTILITIES SHALL NOT AFFECT TRAFFIC. REFER TO THE SPECIFICATIONS FOR MORE INFORMATION.
- GENERALLY HEAVY OR DARK LINE WORK OR NOTES REFER TO PROPOSED IMPROVEMENTS. LIGHT LINE WORK OR SCREENED GENERALLY DENOTES EXISTING FEATURES.
- TECHNICAL SPECIFICATIONS PROVIDE NECESSARY INFORMATION AND ARE PART OF THE CONTRACT DOCUMENTS FOR THIS PROJECT.
- CONTRACTOR SHALL CONNECT WATER SERVICES TO IDENTIFIED WATER USERS UPON COMPLETION OF INSTALLATION OF WATER MAIN AND RECEIPT OF SUCCESSFUL BACTERIOLOGICAL TESTS.
- REFER TO ELECTRICAL SHEETS FOR HEAT TRACE REQUIREMENTS.
- ALL EXISTING WATER MAIN AND MANHOLES BETWEEN SMH A12 AND SMH A15 SHALL BE ABANDONED AND REMOVED AS PART OF THIS PROJECT.
- ALL EXISTING WATER MAIN AND FITTINGS LOCATED BETWEEN THE TWO PROPOSED INTERCONNECTIONS ON EITHER SIDE OF THE PROPOSED BRIDGE SHALL BE ABANDONED AND REMOVED AS PART OF THIS PROJECT.

**LOCAL VALVE OPERATION**

- EXISTING AND PROPOSED MAIN LINE GATE VALVES SHALL OPEN LEFT OR COUNTER CLOCKWISE. OPERATION OF GATE VALVES WILL BE PERFORMED BY THE OWNER'S STAFF ONLY.
- ALL INTERCONNECTIONS TO THE EXISTING SYSTEM CAN ONLY BE MADE WITH THE WRITTEN PERMISSION OF THE TOWN OF READSBORO.

**NOTE:**

**-READSBORO, VERMONT - BRIDGE 32 - WATER AND SEWER UTILITIES**  
1. AS RESIDENT PROJECT REPRESENTATIVE FOR THE ABOVE REFERENCED PROJECT I HAVE REVIEWED THE RECORD DRAWINGS. MY REVIEW INCLUDED COMPARING THE INFORMATION ON THESE RECORD DRAWINGS TO THE INFORMATION THAT WAS PLACED IN THE FIELD BOOKS, AND ON DAILY REPORTS. AS SUCH, I ATTEST THAT THE INFORMATION SHOWN ON THESE RECORD DRAWING PLANS REPRESENT WHAT WAS CONSTRUCTED AS SO FAR AS IT WAS OBSERVED.

SIGNED,  
*Christina M. Legge*  
CHRISTINA M. LEGGE, RPR - DUFRESNE GROUP

ABBREVIATIONS	
CI	CAST IRON PIPE
CMP	CORRUGATED METAL PIPE
CPP	CORRUGATED PLASTIC PIPE
CU	COPPER PIPE
DI	DUCTILE IRON PIPE
EL	ELEVATION
ER	EROSION
HYD	FIRE HYDRANT
INV	INVERT
IP	IRON PIPE
MJ	MECHANICAL JOINT
P	ELECTRICAL POWER
ROW	RIGHT OF WAY
STA	STATION
TBM	TEMPORARY BENCH MARK
TYP	TYPICAL
W	WATER MAIN
WSO	WATER SHUT OFF
WV	WATER VALVE

LEGEND	
<b>EXISTING:</b>	
	EDGE OF RIVER
	EDGE OF PAVEMENT
	EDGE OF GRAVEL
	BUILDING
	WATER MAIN
	SEWER MAIN
	AERIAL TEMP OVERHEAD WIRE
	TREE LINE
	STONE WALL
	FENCE
	SWALE
	UTILITY POLE
	GUY WIRE
	CATCH BASIN
	MAIL BOX
	SEWER MANHOLE
	FIRE HYDRANT
	IRON PIN FOUND
	BENCH MARK
	ROAD SIGN
	DECIDUOUS TREE
	EVERGREEN TREE
<b>PROPOSED:</b>	
	WATER MAIN
	SEWER MAIN
	UTILITY SLEEVE
	GATE VALVE
	MANUAL AIR RELEASE
	SEWER MANHOLE

RECORD DRAWINGS

**DUFRESNE GROUP CONSULTING ENGINEERS**  
54 Main Street, P.O. Box 9  
Windsor, Vermont 05099  
E-mail: dufresne@vermont.net  
1802 www.dufresnegrp.com

Windsor, VT • Tel: (802) 874-2914 Fax: (802) 874-2913  
Barnes, VT • Tel: (802) 478-8888 Fax: (802) 478-2881  
St. Johnsbury, VT • Tel: (802) 748-8055 Fax: (802) 748-4512  
Dufresne Group is owned by Dufresne & Associates, P.C.

REVISIONS	DATE	COMMENTS	BY	CHK

**TH 2, FAS 105 BRIDGE #32**

**WATER AND SEWER MAIN LEGEND, ABBREVIATIONS, GENERAL NOTES, AND PLAN**

READSBORO, VERMONT

Project #	416008
Project Mgr.	NRJ
Design by	TPK
Drawn by	TPK
Reviewed by	CMJ
Approved by	NRJ
Date	MAY 2011
Scale	AS SHOWN

**C1**

SHEET 1 OF 4