

ABUTMENT #1 FOOTING REINFORCING PLAN

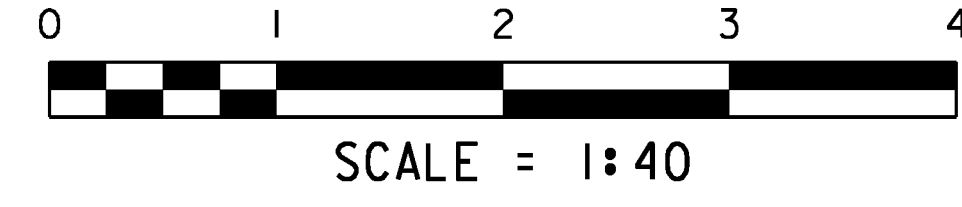

SEE SHEET 49 FOR PILE LOCATIONS.

PORTION OF FOOTINGS ELIMINATED DUE TO LACK OF NEED, PILES USED! SEE SHEET 49

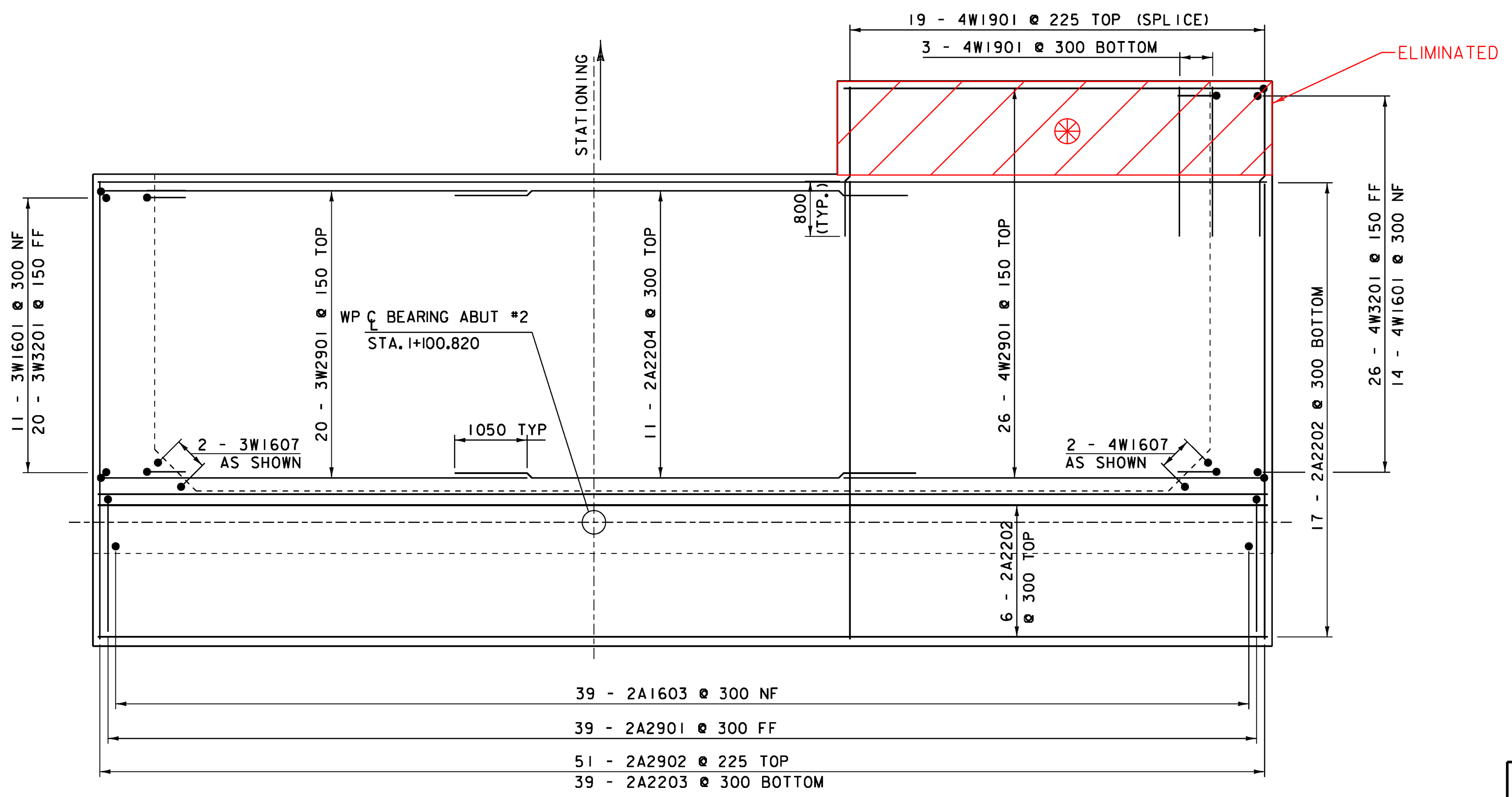

ABUTMENT #2 FOOTING REINFORCING PLAN



NF = NEAR FACE  
 FF = FAR FACE  
 EF = EACH FACE  
 ▲ = CUT TO FIT IN FIELD  
 ~~~~~ = HORIZONTAL JOINT INTENTIONALLY ROUGHENED  
 75 CLEAR, UNLESS OTHERWISE SPECIFIED ON THE PLANS  
 660 BAR LAP UNLESS OTHERWISE SPECIFIED ON THE PLANS

|                                      |                          |
|--------------------------------------|--------------------------|
| PROJECT NAME: READSBORO              | PLOT DATE: 07-MAR-2012   |
| PROJECT NUMBER: BRFO105 (3)          | DRAWN BY: G. ROKES       |
| FILE NAME: 89J088/STR/s89J088sub.dgn | CHECKED BY: W. PELLETIER |
| PROJECT LEADER: J. LACROIX           | SHEET 48 OF 90           |
| DESIGNED BY: W. PELLETIER            |                          |
| ABUTMENT FOOTING DETAILS             |                          |