

**INDEX OF SHEETS**

1. TITLE SHEET
2. PRELIMINARY INFORMATION
3. QUANTITY SHEET 1
4. QUANTITY SHEET 2
5. TIE SHEET
6. LAYOUT SHEET 1
7. LAYOUT SHEET 2
8. LAYOUT SHEET 3
9. PROFILE SHEET
10. TRAFFIC CONTROL
11. PLAN AND ELEVATION SHEET
12. GENERAL NOTES
13. DECK DETAILS SHEET 1
14. DECK DETAILS SHEET 2
15. TRUSS DETAILS
16. PLATE AND FLOOR BEAM DETAILS
17. GUSSET DETAILS
18. FLOOR BEAM CONNECTION DETAILS
19. FRAMING PLAN & CONNECTION DETAILS
20. LATERAL BRACING DETAILS
21. BEARING DETAILS
22. BEARING NOTES / MISC. DETAILS
23. EXPANSION JOINT DETAILS
24. EXPANSION JOINT PLAN
25. DOWN SPOUT DETAILS
26. ABUTMENT #1 DETAILS
27. ABUTMENT #2 DETAILS
28. BRIDGE RAIL DETAILS
29. LATTICE RAIL DETAILS
30. APPROACH RAIL DETAILS
31. TRAFFIC SIGN SHEET
32. TRAFFIC SIGN SUMMARY SHEET
33. R. O. W. PLAN
34. R. O. W. DETAILS
35. REINFORCING STEEL SCHEDULE
36. MAINLINE CROSS SECTIONS
37. MAINLINE CROSS SECTIONS
38. MAINLINE CROSS SECTIONS
39. MAINLINE CROSS SECTIONS
40. CHANNEL CROSS SECTIONS
41. CHANNEL CROSS SECTIONS
42. CHANNEL CROSS SECTIONS
43. CHANNEL CROSS SECTIONS
44. CHANNEL CROSS SECTIONS
45. CHANNEL CROSS SECTIONS
46. EROSION NARRATIVE
47. EROSION NOTES
48. EXISTING CONDITIONS
49. EROSION PREVENTION AND SEDIMENT CONTROL PLAN
50. FINAL CONDITIONS
51. EPSC1 (SILT FENCE)
52. EPSC5 (DITCH AND SLOPE PROTECTION)
53. EPSC7 (FILTER CURTAIN)

**LIST OF STANDARDS**

B-5	6/1/94
B-71	7/8/05
E-100	1/2/04
E-101	5/30/03
E-102	6/30/03
E-102A	5/1/04
E-107	6/30/03
E-107A	8/8/95
E-120	8/8/95
E-121	8/8/95
E-124	8/8/95
E-142	9/20/95
E-152	5/1/04
E-155	5/1/04
E-160	5/20/99
E-164	5/20/99
G-1	1/3/2000
G-1d	1/3/2000

# STATE OF VERMONT AGENCY OF TRANSPORTATION

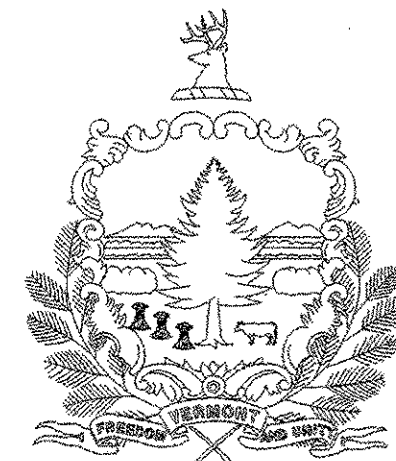

## PROPOSED IMPROVEMENT

TOWNS OF NEW HAVEN & WEYBRIDGE  
COUNTY OF ADDISON

ROUTE NO : TH 7/11, CL 3 BRIDGE NO : 26

PROJECT LOCATION : LOCATED IN THE COUNTY OF ADDISON, TOWN OF NEW HAVEN & WEYBRIDGE, ON TH 7/11,  
BR 26 OVER THE OTTER CREEK, AT THE NEW HAVEN - WEYBRIDGE TOWN LINE.

PROJECT DESCRIPTION : THE PROJECT CONSISTS OF REHABILITATING THE EXISTING STRUCTURE  
INCLUDING ONE NEW ABUTMENT WITH RELATED CHANNEL AND APPROACH WORK.

LENGTH OF STRUCTURE :	151.42 FEET
LENGTH OF ROADWAY :	3.58 FEET
LENGTH OF PROJECT :	155.00 FEET

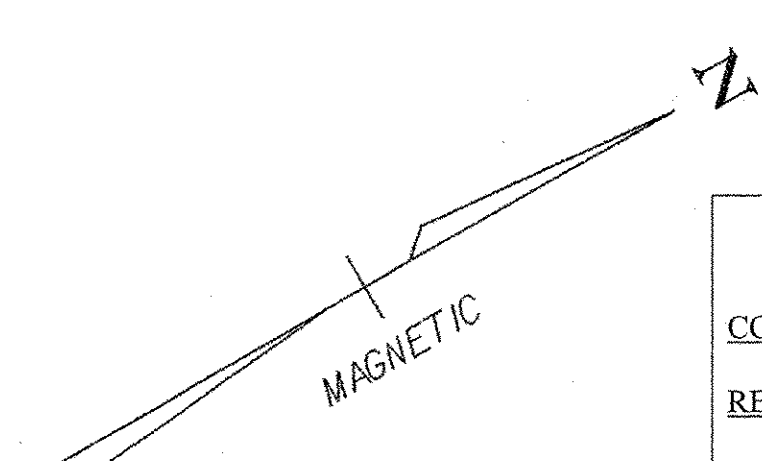
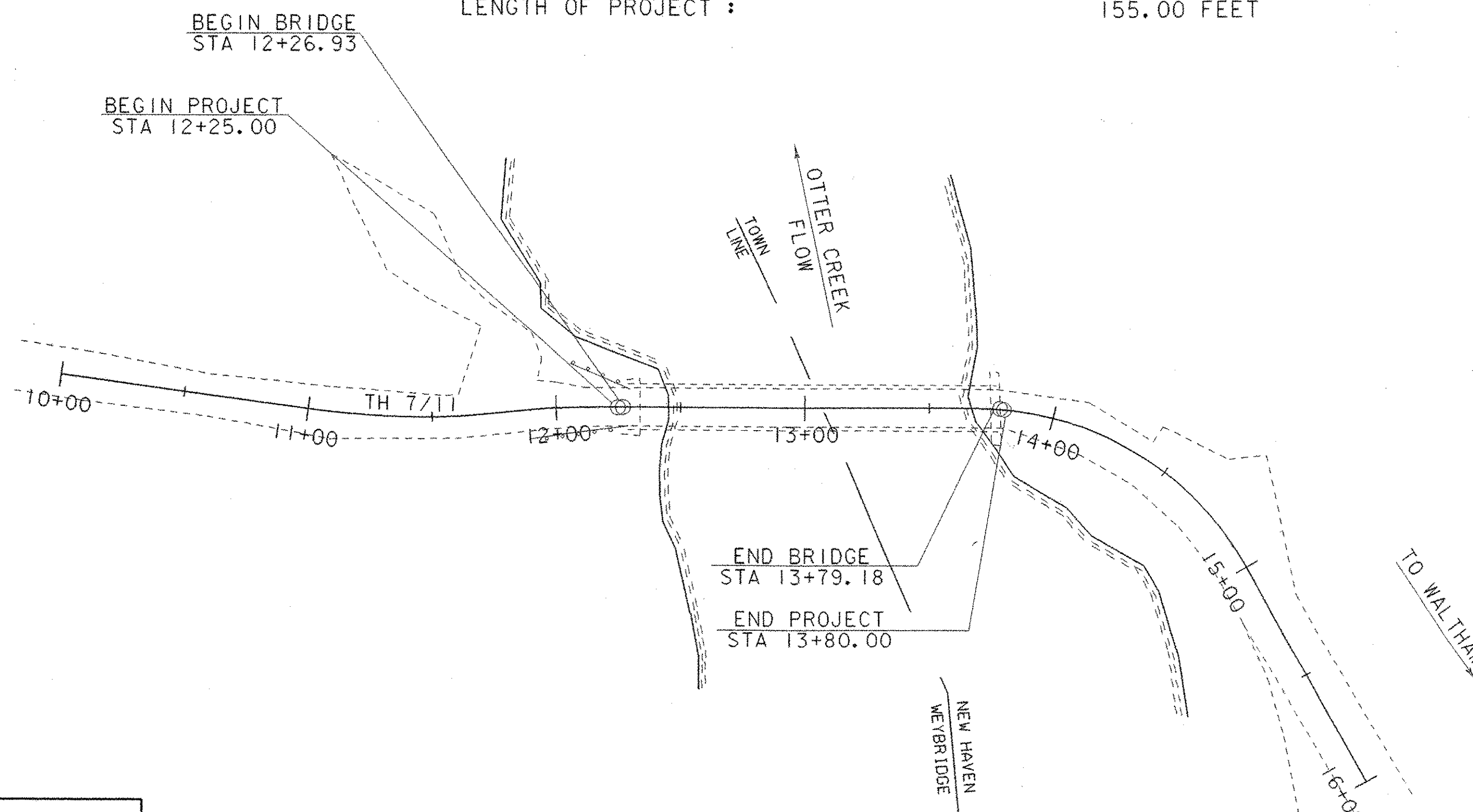
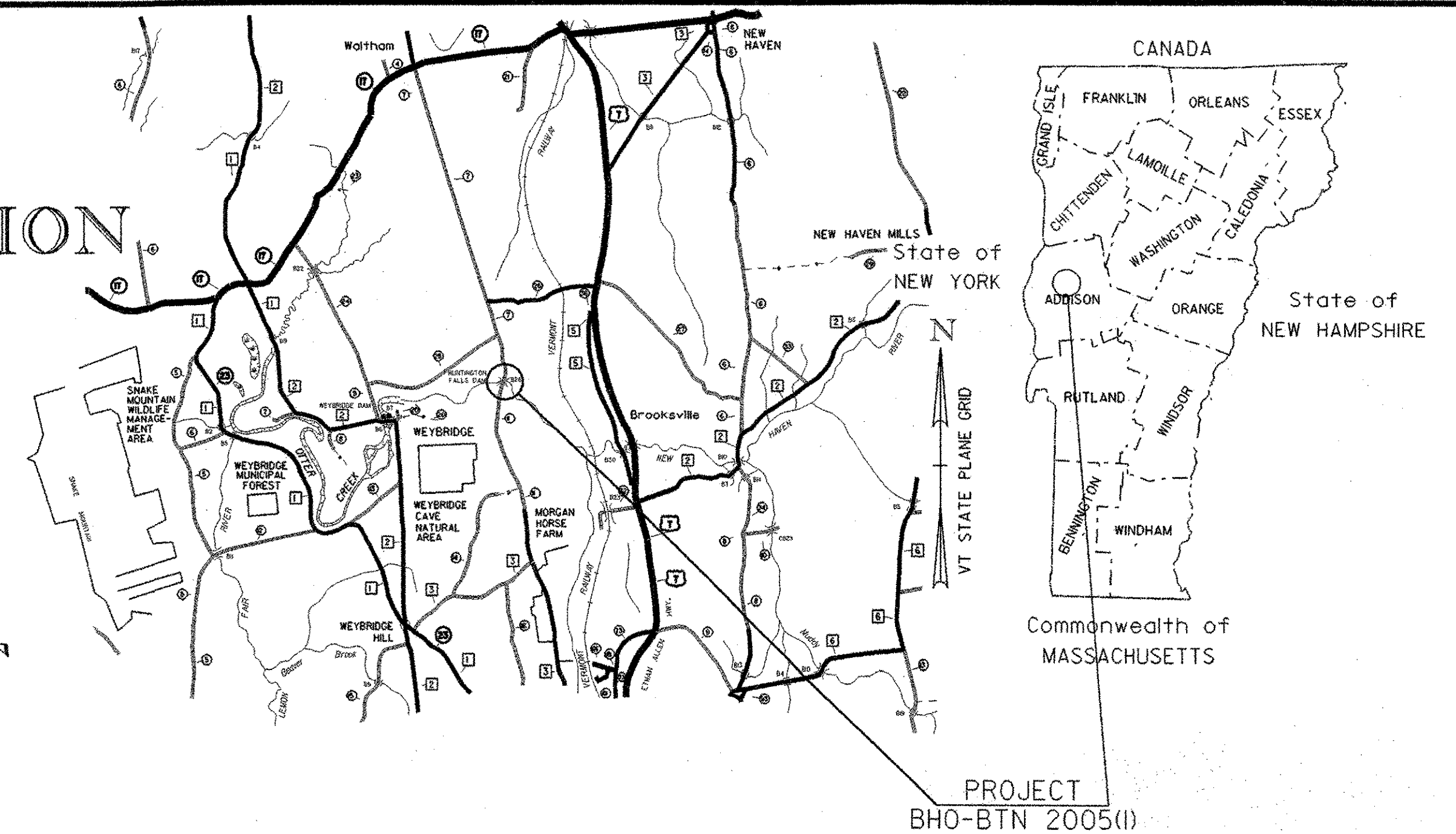

RECORD PLANS	
CONTRACTOR:	CCS CONSTRUCTORS LLC - MORRISVILLE, VT
RESIDENT ENGINEER:	DALE NORTON
CONSTRUCTION BEGAN:	MAY 17, 2007
CONSTRUCTION COMPLETE:	SEPTEMBER 18, 2008
RECORD PLANS BY:	DALE NORTON & BEN LOGAN
I HEREBY CERTIFY THAT ALL THE CONSTRUCTION REQUIRED BY THIS SET OF DRAWINGS HAS BEEN ACCOMPLISHED AS INDICATED HEREIN.	
BY	<i>Dale R. Norton</i> RESIDENT ENGINEER
DATE	6/3/2009
NOTE: Any further information concerning final quantities, amounts or other details relative to this project may be found at Central Files in the electronic archives.	

**CONVENTIONAL SYMBOLS**

COUNTY LINE	
TOWN LINE	
LIMITS OF ACCESS	
POINT OF ACCESS	
FENCE LINE	
STONE WALL	
TRAVELED WAY	
GUARD RAIL	
RAILROAD	
SURVEY LINE	
CULVERT	
POWER POLE	
TELEPHONE POLE	
TREES	
CONTROL OF ACCESS	
PROPERTY LINE	
R.O.W. TAKING LINE	
SLOPE RIGHTS	
TOP OF CUT	
TOE OF SLOPE	

SURVEYED BY : R. MOREAU  
SURVEYED DATE : 7/90

DATUM  
VERTICAL NGVD 1929  
HORIZONTAL ASSUMED

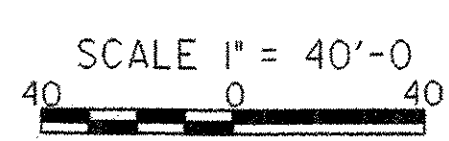

THESE PLANS ARE SUBJECT TO SUCH ENGINEERING CHANGES AS MAY BE REQUIRED BY THE FEDERAL HIGHWAY ADMINISTRATION OR THE DIRECTOR OF PROGRAM DEVELOPMENT.

CONSTRUCTION IS TO BE CARRIED ON IN ACCORDANCE WITH THESE PLANS AND THE STANDARD SPECIFICATIONS FOR CONSTRUCTION DATED 2006, AS APPROVED BY THE FEDERAL HIGHWAY ADMINISTRATION ON JUNE 15, 2006 FOR USE ON THIS PROJECT, INCLUDING ALL SUBSEQUENT REVISIONS AND SUCH REVISED SPECIFICATIONS AND SPECIAL PROVISIONS AS ARE INCORPORATED IN THESE PLANS.

DIRECTOR OF PROGRAM DEVELOPMENT	
APPROVED <i>Richard J. Stearns</i>	DATE 1-30-07
PROJECT MANAGER : C. P. WILLIAMS	
PROJECT NAME : NEW HAVEN - WEYBRIDGE	
PROJECT NUMBER : BHO-BTN 2005 (1)	
SHEET 1 OF 53 SHEETS	