

GENERAL NOTES

1 CONSTRUCTION SPECIFICATIONS:

ALL MATERIALS AND CONSTRUCTION SHALL CONFORM TO STATE OF VERMONT, AGENCY OF TRANSPORTATION STANDARD SPECIFICATIONS FOR CONSTRUCTION, DATED 2001, AND ITS LATEST REVISIONS, AND THE AMERICAN ASSOCIATION OF STATE HIGHWAY AND TRANSPORTATION OFFICIALS (A.A.S.H.T.O.) STANDARD SPECIFICATIONS FOR HIGHWAY BRIDGES, DATED 1996, AND ITS LATEST REVISIONS.

2 MATERIAL SPECIFICATIONS:

UNLESS NOTED, ALL STEEL TO BE AASHTO M270 GRADE 50W (ASTM A709-50W) STEEL FOR GIRDER BOTTOM FLANGES TO BE ASTM A709-HPS70W

MATERIAL NOTED "CVN" ON DETAIL DRAWINGS SHALL BE CHARPY V-NOTCH TESTED IN ACCORDANCE WITH THE REQUIREMENTS OF VERMONT STANDARD SPECIFICATIONS.

HIGH STRENGTH BOLTS: AASHTO M164 (ASTM A325) 7/8" DIA. IN 15/16" DIAMETER HOLES (U.N). TYPE 3 SHALL BE USED FOR UNPAINTED CONNECTIONS. TYPE 1 (GALV.) SHALL BE USED FOR PAINTED CONNECTIONS.

3. FABRICATION:

ALL HOLES SHALL BE PUNCHED OR DRILLED FULL SIZE. STUDS ARE FURNISHED AND FIELD APPLIED BY OTHERS.

4 WELDING:

THE CONFIGURATION OF THE WELD JOINTS AND ALL WELDING PROCEDURES SHALL BE IN ACCORDANCE WITH AASHTO/AWS D.1.5-02 BRIDGE WELDING CODE AND WITH THE SPECIFICATIONS SHOWN BESIDE. ALL WELDING WILL BE DETAILED TO PRE-QUALIFIED JOINTS, UNLESS PROHIBITED BY THE DESIGNER.

WELDING OF MAIN LOAD CARRYING MEMBERS AND ATTACHMENTS SHALL BE PERFORMED USING THE AUTOMATIC SUBMERGED ARC & SHIELDED METAL ARC PROCESS. ALL WELDS ARE CONTINUOUS U.N.

NON DESTRUCTIVE TESTING OF WELDS SHALL BE IN ACCORDANCE WITH THE REFERENCED SPECIFICATION.

5 CLEANING:

ALL STEEL THAT WILL REMAIN UNPAINTED SHALL BE BLAST CLEANED AS PER SSPC SP-10 PER SPEC. 506.14(a)

ALL STEEL THAT WILL BE PAINTED SHALL BE BLAST CLEANED AS PER SSPC SP-6 PER SPEC. 513.04(a)

△ 6 PAINT:

ALL STEEL COMPONENTS WITHIN A DISTANCE OF 8'-0" (END DIAPHRAGMS INCLUDED) FROM THE EXPANSION END OF GIRDERS (PIER #1) SHALL BE COATED WITH THE PROTECTIVE SYSTEM ACCORDING TO SECTION 513 OF THE SPECIFICATION. PAINT SYSTEM MUST BE LISTED ON THE QUALIFIED PRODUCT LIST. THE PAINT SHALL BE BROWN COLOR CHIP NO.20059 PER SECTION 513.02. PROTECTIVE GREASE SHALL BE APPLIED IN THE FIELD BY OTHERS PER SUPPLEMENTAL SPECIFICATION 513.

PAINT MANUFACTURER: CARBOLINE COMPANY.

PRODUCT SYSTEM: ³⁻⁶
PRIMER COAT: CARBOLINE 859 ORGANIC ZINC RICH EPOXY PRIMER, 3-5 MILS DFT
INTERMEDIATE COAT: CARBOLINE 888 EPOXY, 3-5 MILS DFT
TOP COAT: CARBOLINE 133HB ALIPHATIC POLYURETHANE, 3-5 MILS DFT

THE FAYING SURFACES ON THE CONNECTION PLATES SHALL BE PREPARED AS CLASS "C" THESE SURFACES SHALL BE PROTECTED FROM DAMAGE AND CORROSION PRIOR TO THE CONNECTION.

7 FIELD CONNECTIONS:

ALL FIELD CONNECTIONS SHALL BE MADE WITH 7/8" DIAMETER HIGH STRENGTH A-325 BOLTS TYPE 3 OR 1 AS NOTED, IN 15/16" DIAMETER HOLES UNLESS OTHERWISE NOTED. INSTALLED PER 506.19(c) AND SPECIAL PROVISIONS.

BOLTS SHALL HAVE HEAVY HEX. NUT, HEX. HEAD & ONE FLAT WASHER EACH (WASHER TO BE PLACED UNDER TURNED ELEMENT).

PIECE MARKS WILL BE LOCATED AS SHOWN ON ERECTION DRAWING.

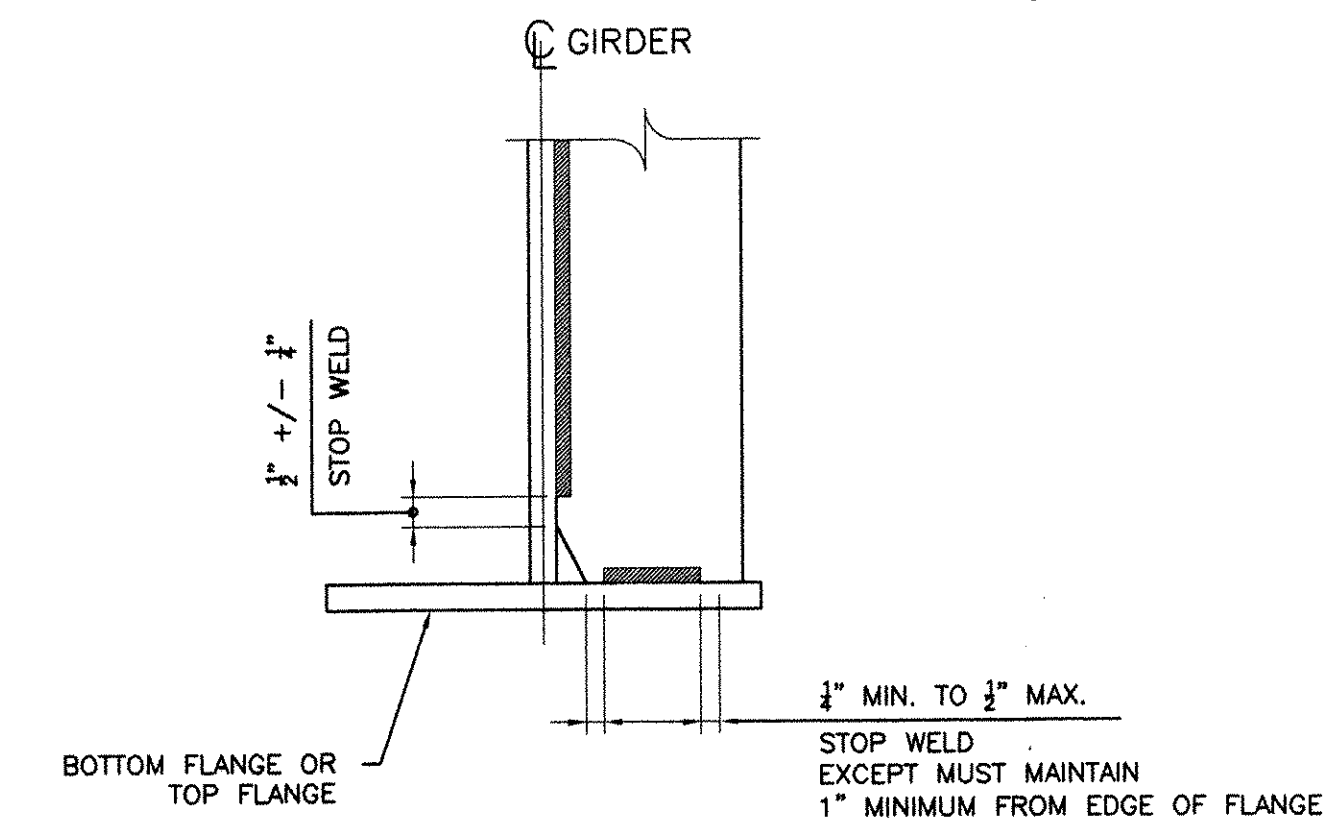

TYPICAL WELD DETAIL

**Structures
COPY**

RECEIVED
 CK'D BY: _____ ON'D BY: _____
 SEP 20 2005
 RESUBMIT: _____ APPROVED: *As Noted*
 BY: *CPW* DATE: *10/31/05*
 RESERVED FOR STAMPS

8	9/16/05	FW Whitcomb	Approval
8	07/14/05	FW WHITCOMB	APPROVAL
REV	DATE	DESCRIPTION	FOR

NOTICE
 This drawing shall not be used or reproduced in any manner, nor shall any similar drawings or structures be made therefrom, nor shall the information thereon be used for any purpose other than that for which it is released without the written consent of an officer of EASTERN BRIDGE LLC.



EASTERN BRIDGE LLC
 RURAL RTE 2, BOX 302
 CLAREMONT, NH 03743
 603-542-5202

PROJECT: BRIDGE 8 OVER THE WHITE RIVER, PROJECT NO BRO-BTN 2004(1)
 LOCATION: TOWN OF HARTFORD, COUNTY OF WINDSOR, VERMONT
 ENGINEER: STATE OF VERMONT, AGENCY OF TRANSPORTATION
 CUSTOMER: FW WHITCOMB CONSTRUCTION CO.
 DRAWING TITLE: GENERAL NOTES
 DRAWN BY: YT 06/02/05 JOB
 CHECKED BY: GG 06/06/05 NUMBER: 6005 SHEET NUMBER: GN1