

* MEASURED ALONG FASCIA
 ** MEASURED ALONG FACE OF RAIL

HEAVY DUTY STEEL BEAM GUARDRAIL

TH5 Sta 5+46.20 RT	-	TH5 Sta 6+34.00 RT	30
ML Sta 31+41.30 RT	-	DRIVE Sta 11+09.00 LT	11
ML Sta 34+34.50 LT	-	VT14 Sta 209+27.50 LT	25
ML Sta 34+33.30 RT	-	VT14 Sta 207+62.00 LT	64

ALUMINUM APPROACH RAILING

TH5 Sta 5+46.20 RT	-	ML Sta 31+65.23 LT
ML Sta 31+41.30 RT	-	ML Sta 31+66.25 RT
ML Sta 34+09.75 LT	-	ML Sta 34+34.50 LT
ML Sta 34+09.75 RT	-	ML Sta 34+33.30 RT

ALUMINUM BRIDGE RAILING

ML Sta 31+65.25 LT	-	Sta 34+09.75 LT
ML Sta 31+66.25 RT	-	Sta 34+09.75 RT

ANCHOR FOR STEEL BEAM GUARDRAIL

TH5 Sta 6+22.00 RT	5+60
DRIVE Sta 10+98.00 LT	31
VT14 Sta 209+18.00 LT	12
VT14 Sta 207+75.00 LT	72

ANCHOR FOR CABLE DRILL
 Sta 6+30.00 RT (APPROXIMATE)

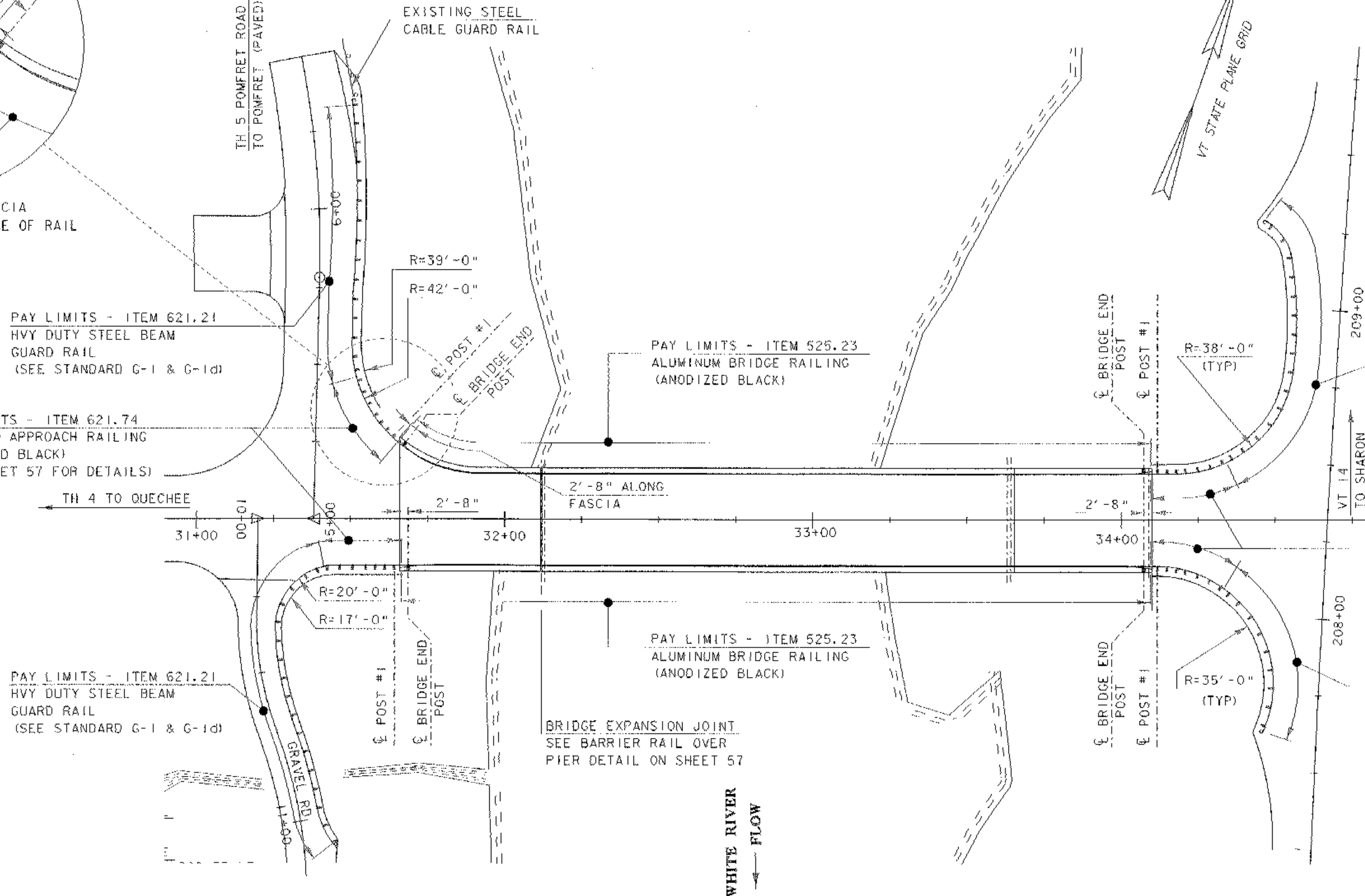

PAY LIMITS - ITEM 621.21
 HVY DUTY STEEL BEAM
 GUARD RAIL
 (SEE STANDARD G-1 & G-1d)

PAY LIMITS - ITEM 621.74
 ALUMINUM APPROACH RAILING
 (ANODIZED BLACK)
 (SEE SHEET 57 FOR DETAILS)

PAY LIMITS - ITEM 621.21
 HVY DUTY STEEL BEAM
 GUARD RAIL
 (SEE STANDARD G-1 & G-1d)

PAY LIMITS - ITEM 525.23
 ALUMINUM BRIDGE RAILING
 (ANODIZED BLACK)

PAY LIMITS - ITEM 621.21
 HVY DUTY STEEL BEAM
 GUARD RAIL
 (SEE STANDARD G-1 & G-1d)

PAY LIMITS - ITEM 621.74
 ALUMINUM APPROACH RAILING
 (ANODIZED BLACK)
 (SEE SHEET 57 FOR DETAILS)

PAY LIMITS - ITEM 525.23
 ALUMINUM BRIDGE RAILING
 (ANODIZED BLACK)

PAY LIMITS - ITEM 621.21
 HVY DUTY STEEL BEAM
 GUARD RAIL
 (SEE STANDARD G-1 & G-1d)

RAILING LAYOUT PLAN

SCALE 1" = 20'-0"
 20 0 20

PROJECT: HARTFORD	PROJECT NO.: BRO-BTN 2004 (I)
DESIGN FILE NAME: 89j045/structures/sj045rail.dgn	PLOT DATE: 11-FEB-2005
IPARM FILE NAME: sj045railplan.d	SURVEY DATE: 5/93
DESIGN BY: K.M. HIGGINS	DRAWN BY: M.LONGSTREET
SQUAD LEADER: C.P. WILLIAMS	SHEET: 56 OF 97
RAILING LAYOUT PLAN	