

WINGWALL #2 ELEVATION
SCALE 1/4" = 1'-0"

WINGWALL #1 ELEVATION
SCALE 1/4" = 1'-0"

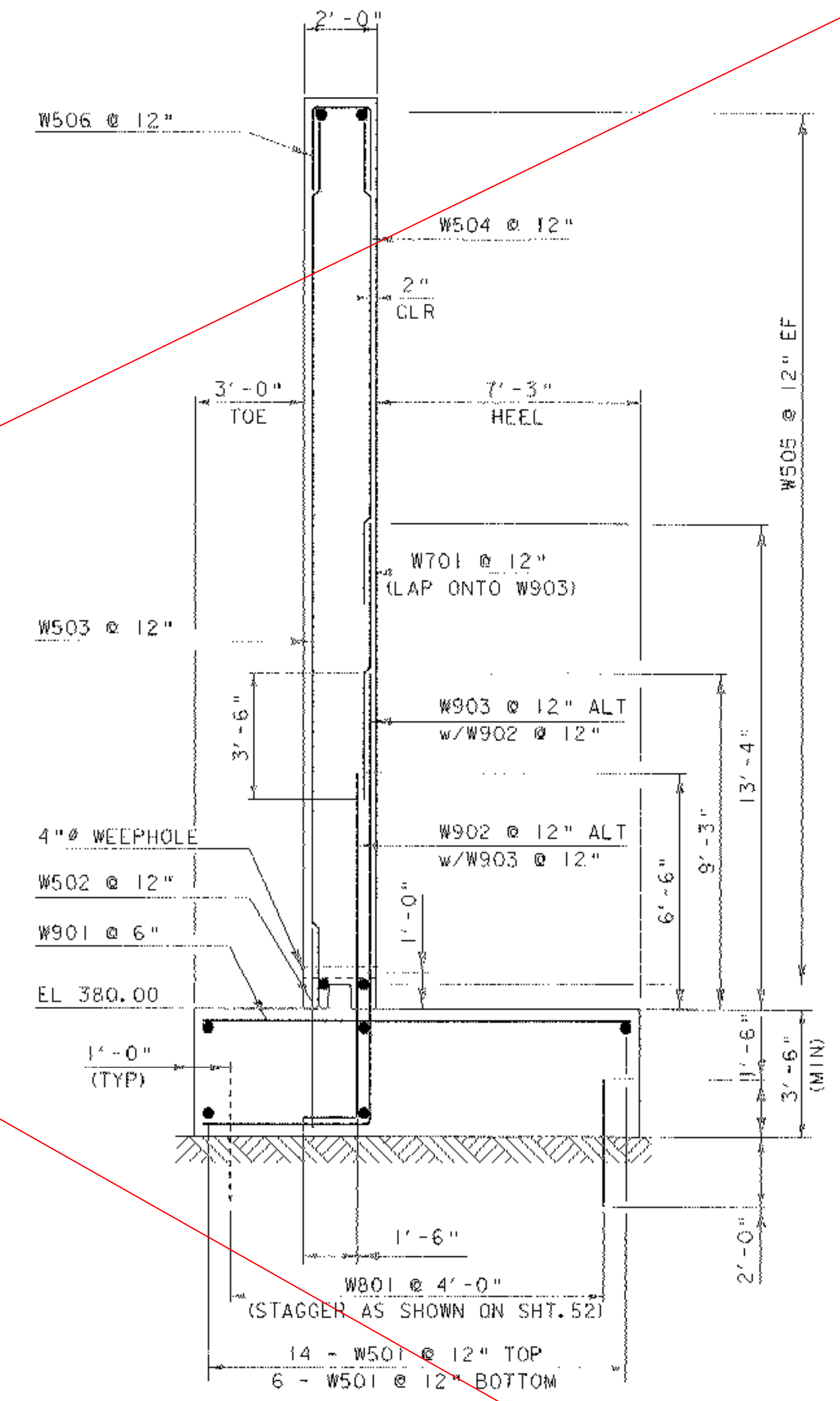

WINGWALL #1 & #2 TYPICAL SECTION
SCALE 3/8" = 1'-0"

SEE REVISED SHEET 50A

NOTE:
THE TOP OF THE FOOTING ELEVATION FOR ABUTMENT #1 WAS SET BASED ON THE LEDGE ELEVATION DETERMINED FROM B-04. ADJUSTMENTS IN FOOTING ELEVATION AND GEOMETRY ARE EXPECTED AS ACTUAL LEDGE ELEVATION AND CONDITION IS DETERMINED THROUGH EXCAVATION. THE ELEVATION AND GEOMETRY SHOWN REPRESENT THE LOWEST LEDGE ELEVATION EXPECTED.

NOTES:
NF = NEAR FACE
FF = FAR FACE
EF = EACH FACE
▲ = CUT TO FIT IN FIELD
3" CLEAR UNLESS OTHERWISE SPECIFIED ON PLANS
ALL LAPS ARE 2'-2" UNLESS OTHERWISE SPECIFIED ON PLANS

PROJECT: HARTFORD	PROJECT NO. # BR0-BTN 2004 (1)
DESIGN FILE NAME: s\j045\structures\s\j045sub.dgn	PLOT DATE: 11-FEB-2005
IPARM FILE NAME: s\j045ww1x2.f	DRAWN BY: M LONGSTREET
DESIGNED BY: K. M. HIGGINS	CHECKED BY: K. M. HIGGINS
SQUAD LEADER: C. P. WILLIAMS	SHEET: 50 OF 97
WINGWALL 1 & 2 DETAILS	