

STATE OF VERMONT AGENCY OF TRANSPORTATION



PROPOSED IMPROVEMENT BRIDGE PROJECT

TOWN OF HARTFORD
COUNTY OF WINDSOR

ROUTE NO : TH 4 FAS 166 BRIDGE NO : 8

PROJECT LOCATION : LOCATED IN THE COUNTY OF WINDSOR, TOWN OF HARTFORD, ON
TH 4; BRIDGE 8 OVER THE WHITE RIVER, APPROXIMATELY 0.1
MILE WEST OF THE JUNCTION WITH VT ROUTE 14.

PROJECT DESCRIPTION : THE REPLACEMENT OF THE EXISTING STRUCTURE ALONG
WITH RELATED CHANNEL AND ROADWAY WORK.

LENGTH OF STRUCTURE : 244.00 FEET.
LENGTH OF ROADWAY : 356.00 FEET.
LENGTH OF PROJECT : 600.00 FEET.

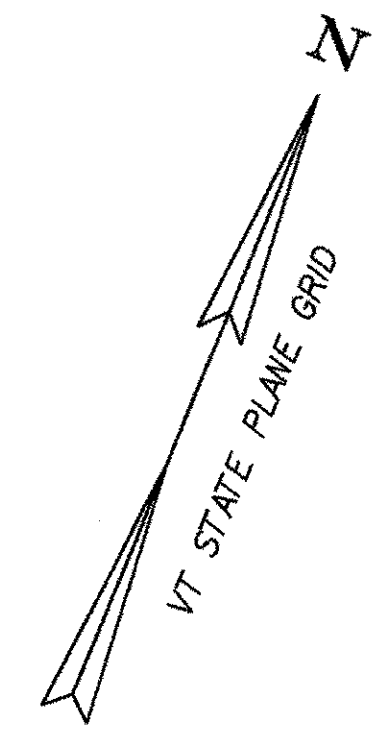
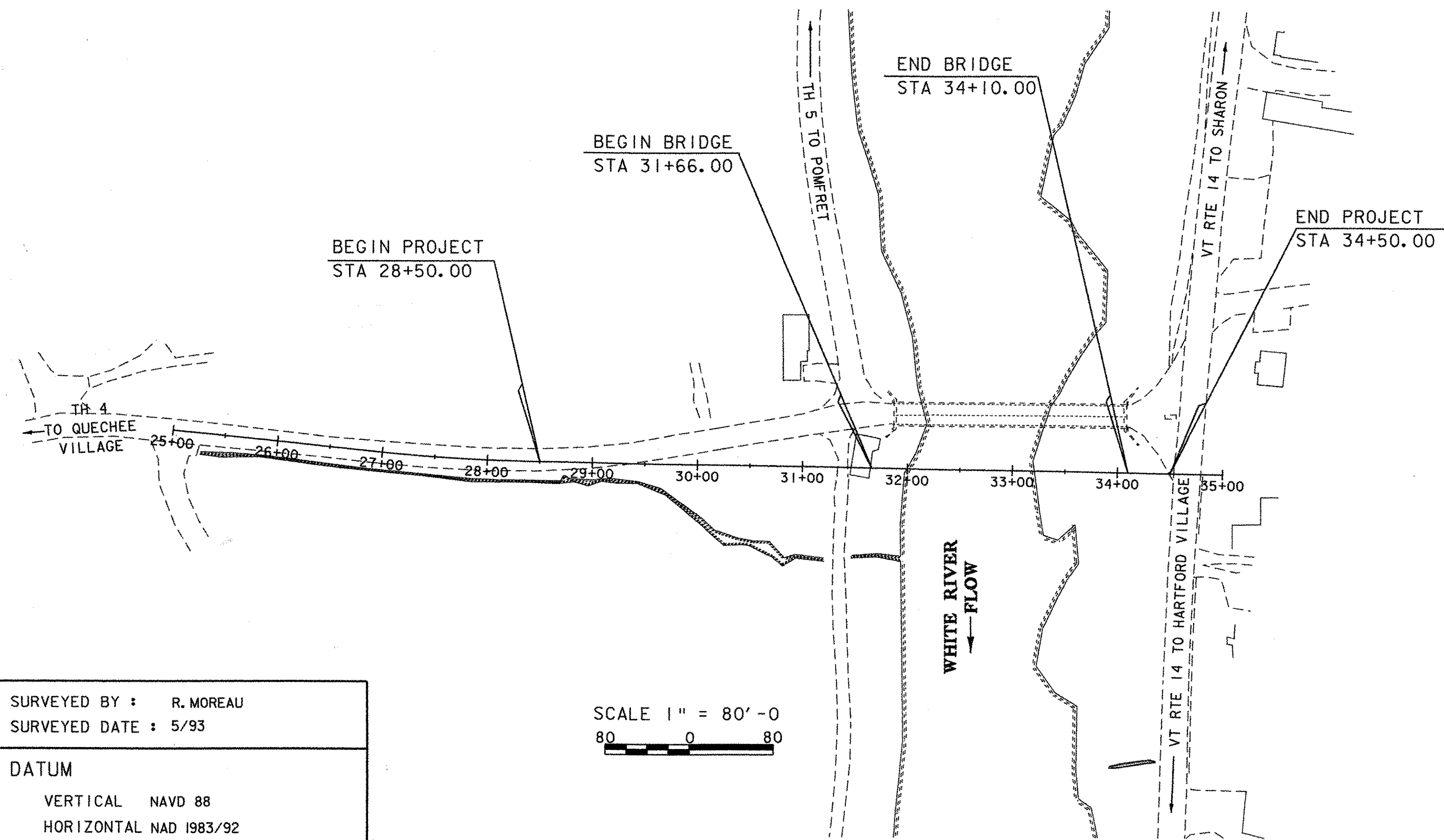
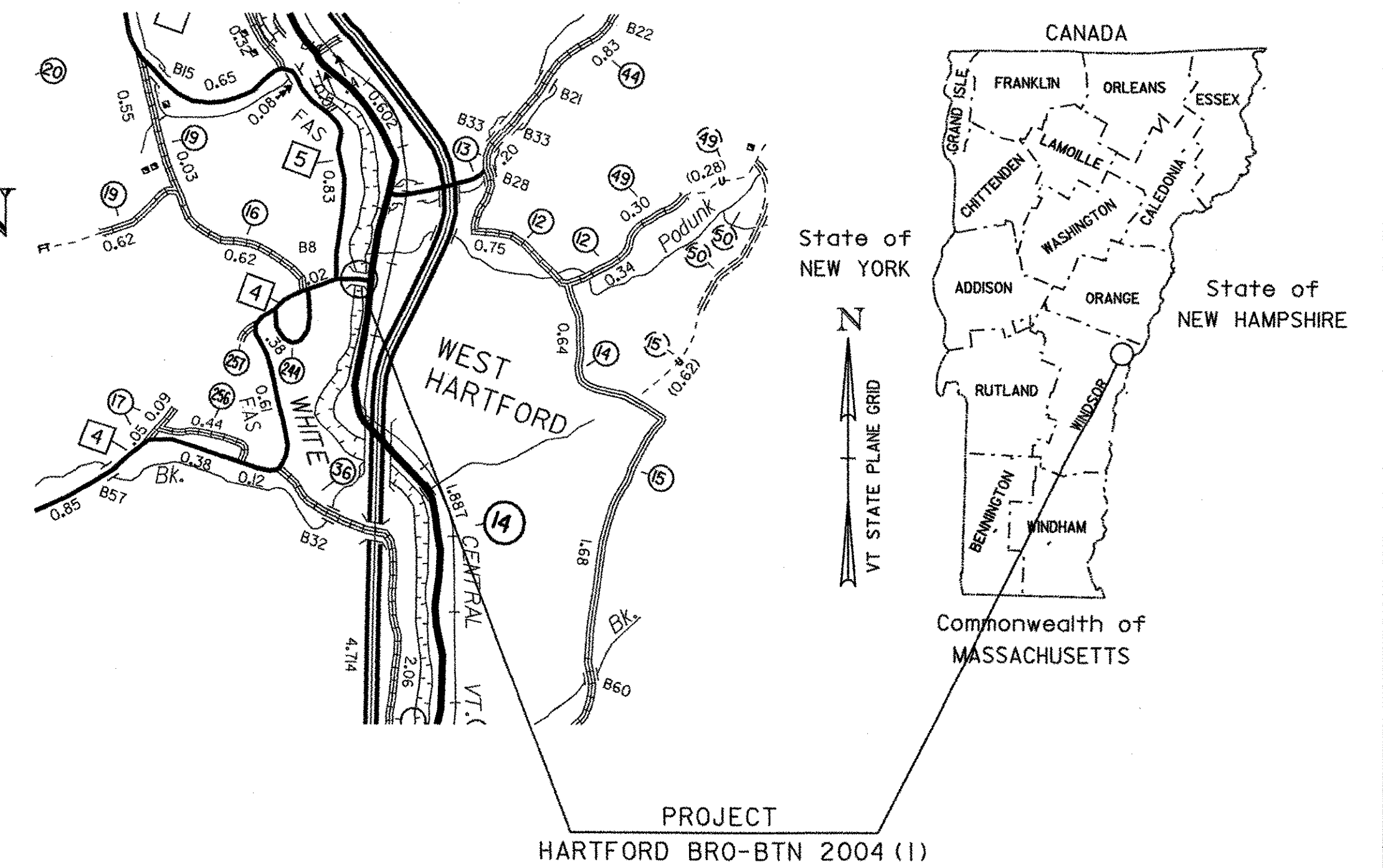

RECORD PLANS	
CONTRACTOR:	FW WHITCOMB CONSTRUCTION CORP. - WALPOLE, NH
RESIDENT ENGINEER:	CHRIS BARKER
CONSTRUCTION BEGAN:	MAY 13, 2005
CONSTRUCTION COMPLETE:	2007
RECORD PLANS BY:	CHRIS BARKER & JUDY GILMORE
I HEREBY CERTIFY THAT ALL THE CONSTRUCTION REQUIRED BY THIS SET OF DRAWINGS HAS BEEN ACCOMPLISHED AS INDICATED HEREIN.	
BY:	<i>Chris Barker</i> RESIDENT ENGINEER
DATE:	04/18/07
NOTE: Any further information concerning final quantities, amounts or other details relative to this project may be found at Central Files in the electronic archives.	

CONVENTIONAL SYMBOLS	
COUNTY LINE	
TOWN LINE	
LIMITS OF ACCESS	
POINT OF ACCESS	
FENCE LINE	
STONE WALL	
TRAVELED WAY	
GUARD RAIL	
RAILROAD	
SURVEY LINE	
CULVERT	
POWER POLE	
TELEPHONE POLE	
TREES	
CONTROL OF ACCESS	
PROPERTY LINE	
R.O.W. TAKING LINE	
SLOPE RIGHTS	
TOP OF CUT	
TOE OF SLOPE	

SURVEYED BY : R. MOREAU
SURVEYED DATE : 5/93

DATUM
VERTICAL NAVD 88
HORIZONTAL NAD 1983/92

SCALE 1" = 80' - 0
80 0 80

THESE PLANS ARE SUBJECT TO SUCH ENGINEERING
CHANGES AS MAY BE REQUIRED BY THE FEDERAL HIGHWAY
ADMINISTRATION OR THE DIRECTOR OF PROGRAM
DEVELOPMENT.
CONSTRUCTION IS TO BE CARRIED ON IN ACCORDANCE
WITH THESE PLANS AND THE STANDARD SPECIFICATIONS
FOR CONSTRUCTION DATED 2001, AS APPROVED BY THE
FEDERAL HIGHWAY ADMINISTRATION ON JANUARY 4, 2001
FOR USE ON THIS PROJECT, INCLUDING ALL SUBSEQUENT
REVISIONS AND SUCH REVISED SPECIFICATIONS AND
SPECIAL PROVISIONS AS ARE INCORPORATED IN THESE
PLANS.
89j045/structures/sj045bdr.dgn sj045tit.i

DIRECTOR OF PROGRAM DEVELOPMENT	
APPROVED:	<i>Signature</i> DATE 11/13/05
PROJECT MANAGER : C. P. WILLIAMS	
PROJECT NAME : HARTFORD	
PROJECT NUMBER : BR0-BTN 2004 (1)	
SHEET 1 OF 97 SHEETS	