

REMOVING AND RESETTING FENCE
 REV. 38+92 RT. ~ REV. 39+82 RT.
 REV. 42+45 RT. ~ REV. 44+48 RT.
 REV. 41+86 LT. ~ REV. 44+30 LT.
 REV. 46+00 LT. ~ REV. 46+56 LT.

CONSTRUCT STONE-LINED DITCH
 SURV. 39+00 RT. ~ REV. 42+84 RT.
 REV. 44+42 LT. ~ REV. 46+94 LT.

STEEL BEAM GUARD RAIL
 REV. 38+88 LT. ~ REV. 44+09 LT.
 REV. 41+87 RT. ~ REV. 46+12 RT.

CONSTRUCT FIELD DRIVE (R.O.W. AGREEMENT)
 REV. 44+25 LT.

ANCHOR FOR STEEL BEAM RAIL
 REV. 41+95 RT.
 REV. 46+06 RT.
 SURV. 38+95 LT.
 REV. 44+03 LT.

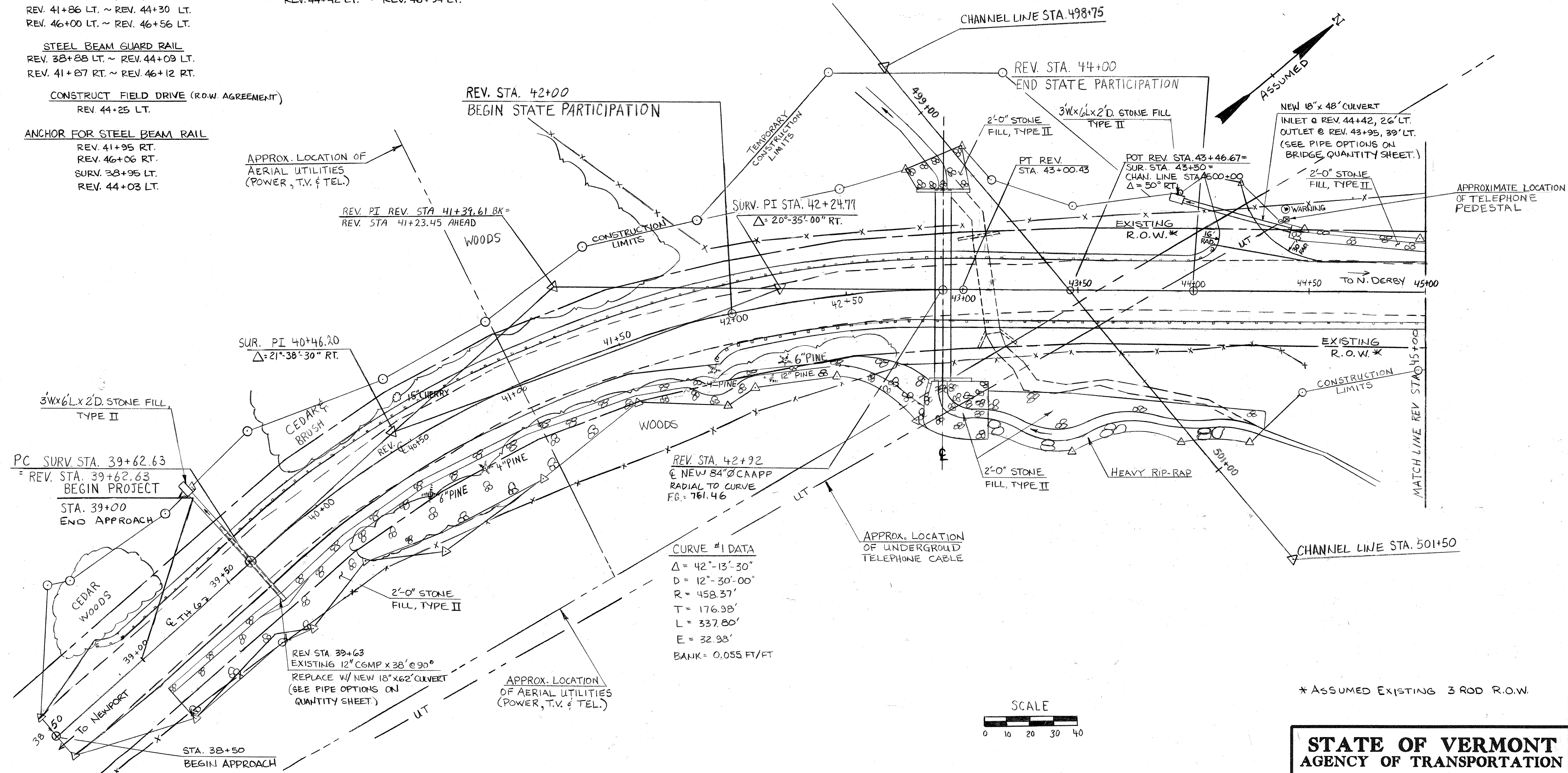

CURVE #1 DATA
 $\Delta = 42^\circ - 13' - 30''$
 $D = 12^\circ - 30' - 00''$
 $R = 458.37'$
 $T = 176.98'$
 $L = 337.80'$
 $E = 32.93'$
 $BANK = 0.055 \text{ FT/FT}$

* ASSUMED EXISTING 3 ROD R.O.W.

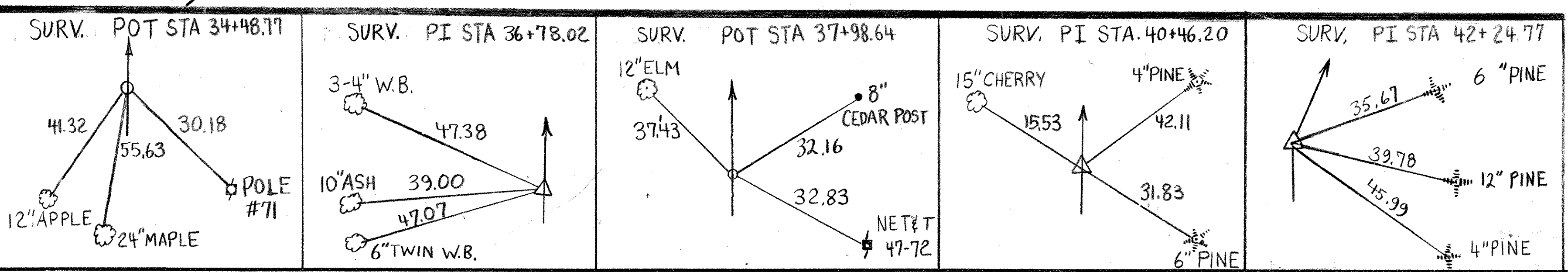

PROJECT BENCHMARK LOCATION

STATION	OFFSET	ELEVATION**	DESCRIPTION
34+21	13' RT.	800.00	POLE # 71
44+00	0'	757.31	☉ NAIL
51+75	15' RT.	812.94	POLE # 47/76

** ASSUMED

**STATE OF VERMONT
 AGENCY OF TRANSPORTATION**

Town Of DERBY	Bridge No. B13
Highway No. TH 6	Log Sta. Surv. Sta.
TH6, BR13 OVER UNNAMED BROOK	
PLAN VIEW	
Designed By B. DONALD	Drawn By S. FUGERE
Checked By M. EVANS-MONGEON	Bridge Design Supervisor
Date 10/92	Date 10/92
PROJECT DERBY	PROJECT NO. TH2 8910
I.G.C. Info.	
Bridge Sheet No.	Sheet 2 of 29

BRIDGING 44-232 73216

BR-6