

ABUTMENT #1 PLAN

SCALE 3/8" = 1'-0"

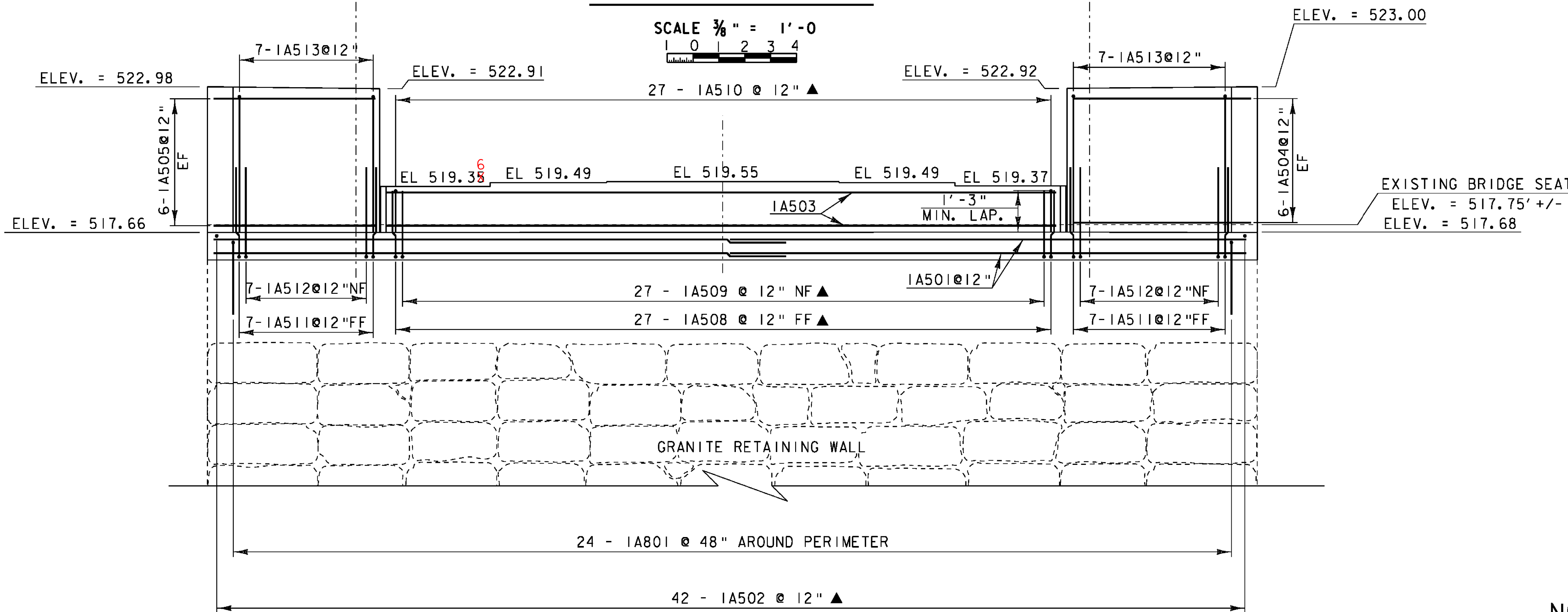

ABUTMENT #1 ELEVATION

SCALE 3/8" = 1'-0"

NOTE:  
REINFORCING STEEL SHALL BE ORIENTED PARALLEL WITH  
CL LANGDON STREET, NOT PERPENDICULAR TO CL BEARINGS.

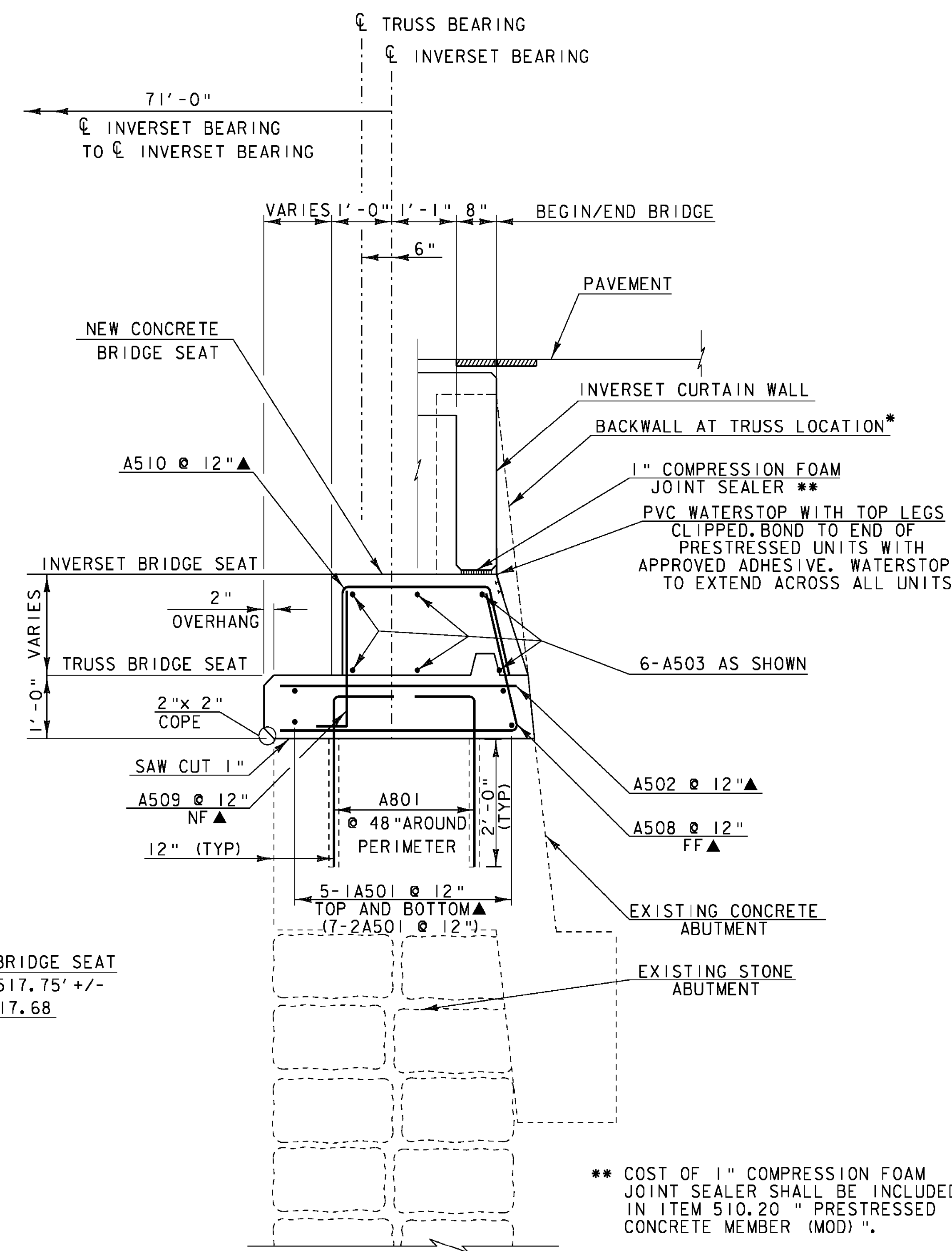

SECTION A-A  
ABUTMENT #1 AND #2  
INVERSE TYPICAL SECTION

\*(SEE B-B NEXT PAGE)

NOTE:

NF = NEAR FACE  
FF = FAR FACE  
EF = EACH FACE  
▲ = CUT TO FIT IN FIELD  
3" CLR. UNLESS OTHERWISE  
SPECIFIED ON THE PLANS.  
ALL LAPS 2'-2" UNLESS  
NOTED OTHERWISE.

SCALE 3/4" = 1'-0"

PROJECT:	MONTPELIER	PROJECT NO.:	BRM 6400 (25)
DESIGN FILE NAME:	88j100/structures/sj100Sub.dgn	PLOT DATE:	29-SEP-2010
IPARM FILE NAME:	sj100abuti.i	DRAWN BY:	M. LONGSTREET
DESIGNED BY:	R.S. YOUNG	CHECKED BY:	R.S. YOUNG
SQUAD LEADER:	C.P. WILLIAMS	SHEET:	21 OF 49
ABUTMENT #1 DETAILS			

AS BUILT REVISION  
BRIDGE SEAT LAYOUT  
SEAT ELEVATION

\*\* COST OF 1" COMPRESSION FOAM JOINT SEALER SHALL BE INCLUDED IN ITEM 510.20 "PRESTRESSED CONCRETE MEMBER (MOD)".