

TRAFFIC NOTES

1. ALL ON AND OFF PROJECT SIGNS AND BARRICADES SHALL BE THE RESPONSIBILITY OF THE CONTRACTOR AND PAID FOR UNDER THE ITEM 641.10 "TRAFFIC CONTROL", EXCEPT PEDESTRIAN BRIDGE SIGNS SHALL BE PAID FOR UNDER ITEM 528.12 "TEMPORARY PEDESTRIAN BRIDGE"(MOD.).
2. THE EAST END OF LANGDON STREET SHALL BE CONVERTED TO A TWO WAY STREET WHEN THE BRIDGE IS CLOSED. THE BRIDGE MAY BE CLOSED AT TWO SEPARATE TIMES DURING CONSTRUCTION. SIGNS UNDER ITEM 641.10 SHALL BE IN PLACE DURING THE BRIDGE CLOSURES. EXISTING SIGNS REMOVED SHALL BE REPLACED WHEN THE BRIDGE IS OPEN TO TRAFFIC. PAYMENT FOR MOVING/REMOVING AND REPLACING EXISTING SIGNS FOR TRAFFIC CONTROL SHALL BE INCLUDED UNDER ITEM 641.10 "TRAFFIC CONTROL".
3. THE CONTRACTOR SHALL NOTIFY THE CITY OF MONTPELIER AND THE WASHINGTON COUNTY COURT HOUSE IN WRITING TWO WEEKS PRIOR TO THE BEGINNING OF CONSTRUCTION. SEE CONTACTS BELOW.
4. THE PARKING LOT AT STA 13+80 LEFT SHALL BE CLOSED BY WASHINGTON COUNTY TO VEHICULAR TRAFFIC DURING CONSTRUCTION. THERE WILL BE NO USE ALLOWED WITHOUT PERMISSION.
5. VEHICULAR TRAFFIC SHALL BE ALLOWED ACCESS TO THE BACK OF THE BUILDING AT STA 12+00 LEFT. ACCESS TO THE "TRUCKS ONLY" PARKING SPACE AT 11+75 RIGHT SHALL BE MAINTAINED AT ALL TIMES DURING CONSTRUCTION.

6. PEDESTRIAN TRAFFIC SHALL BE ALLOWED ACCESS TO THE FRONT OF THE BUILDINGS FROM STA 12+00 LEFT TO 12+50 LEFT AND FROM STA 11+62 RIGHT TO 12+76 RIGHT. ACCESS TO THE PORCH AND STAIRS AT STA 13+49 RIGHT AND THE MAIN ENTRANCE AT 13+69 RIGHT SHALL BE MAINTAINED AT ALL TIMES DURING CONSTRUCTION.
7. A TEMPORARY PEDESTRIAN BRIDGE SHALL BE CONSTRUCTED DOWNSTREAM FROM THE LANGDON STREET TRUSS, AND SHALL BE PAID FOR UNDER THE ITEM 528.12 "TEMPORARY PEDESTRIAN BRIDGE"(MOD.). THE BRIDGE SHALL REMAIN IN PLACE UNTIL THE COMPLETION OF THE PROJECT. THE BID PRICE FOR THE TEMPORARY PEDESTRIAN BRIDGE SHALL INCLUDE CONSTRUCTION OF ABUTMENTS, BEARINGS, AND APPROACHES AS WELL AS MAINTAINING, AND REMOVING THE BRIDGE AND APPROACHES. THE BID PRICE SHALL ALSO INCLUDE REMOVAL AND REPLACEMENT OF THE GUARDRAIL ON THE WESTERN END OF THE PEDESTRIAN BRIDGE AND ANY WORK NECESSARY TO RETURN THE SITE BACK TO ITS ORIGINAL CONDITION.
8. PAVEMENT MARKINGS IN THE SHAPE OF A FOOT SHALL BE PAINTED ALONG THE PATH TO THE TEMPORARY BRIDGE AS SHOWN. THE FOOT PRINTS SHALL BE AT LEAST 15 INCHES LONG WITH FOUR FOOT SPACING. A CROSSWALK SHALL BE PAINTED ON THE WEST SIDE OF THE PROJECT WITH SIGNS AS SHOWN. THE PAINT FOR THE FOOT PRINTS AND CROSSWALK SHALL BE WHITE TEMPORARY PAINT. PLACEMENT AND REMOVAL OF THE PAINT SHALL BE PAID FOR UNDER ITEM 528.12 "TEMPORARY PEDESTRIAN BRIDGE"(MOD.).
9. THE PAVEMENT MARKINGS FOR THE EXISTING PARKING SPACES FROM STA 10+50RT-11+15RT SHALL BE REMOVED DURING BRIDGE CLOSURE. PAYMENT SHALL BE INCLUDED UNDER ITEM 528.12 "TEMPORARY PEDESTRIAN BRIDGE"(MOD.).

10. TEMPORARY TRAFFIC BARRIER SHALL BE PAID FOR UNDER ITEM 621.90 "TEMPORARY TRAFFIC BARRIER".
11. THE CONTRACTOR SHALL COORDINATE WITH THE CITY OF MONTPELIER TO HAVE THE PARKING METER HEADS REMOVED DURING BRIDGE CLOSURES AT STATIONS 10+70, 11+10, 11+94, 12+17, 12+44, 13+55 RIGHT AND AT STATIONS 12+16, 12+61 LEFT.

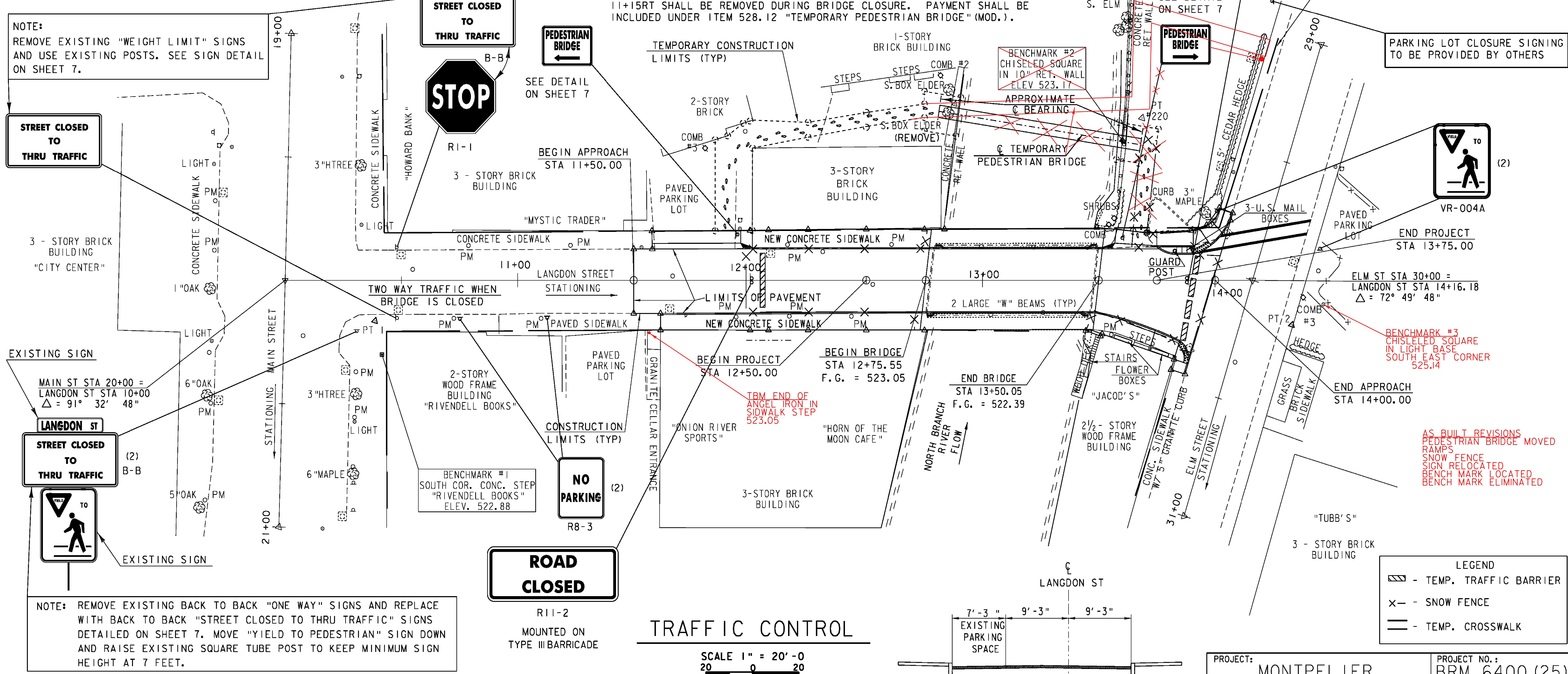

DATUM
 VERTICAL NGVD 1929
 HORIZONTAL ASSUMED

CONTACTS:
 CITY OF MONTPELIER - STEVE GRAY, DIRECTOR OF PUBLIC WORKS 802-223-9508
 WASHINGTON COUNTY SUPERIOR COURT - ASSISTANT JUDGE K.D. (BARNEY) BLOOM 802-828-2091