

GIRDER ELEVATION
NOT TO SCALE

- NOTES:**
- REFER TO SD-601.00 "STRUCTURAL STEEL DETAILS AND NOTES" AND SD-602.00 "STRUCTURAL STEEL PLATE GIRDER DETAILS AND NOTES" FOR ADDITIONAL STRUCTURAL STEEL PLATE GIRDER DETAILS AND NOTES.
 - SEE STRUCTURAL STEEL NOTE 36 ON PROJECT NOTES SHEET FOR PLATES TO BE CHARPY V-NOTCH TESTED.

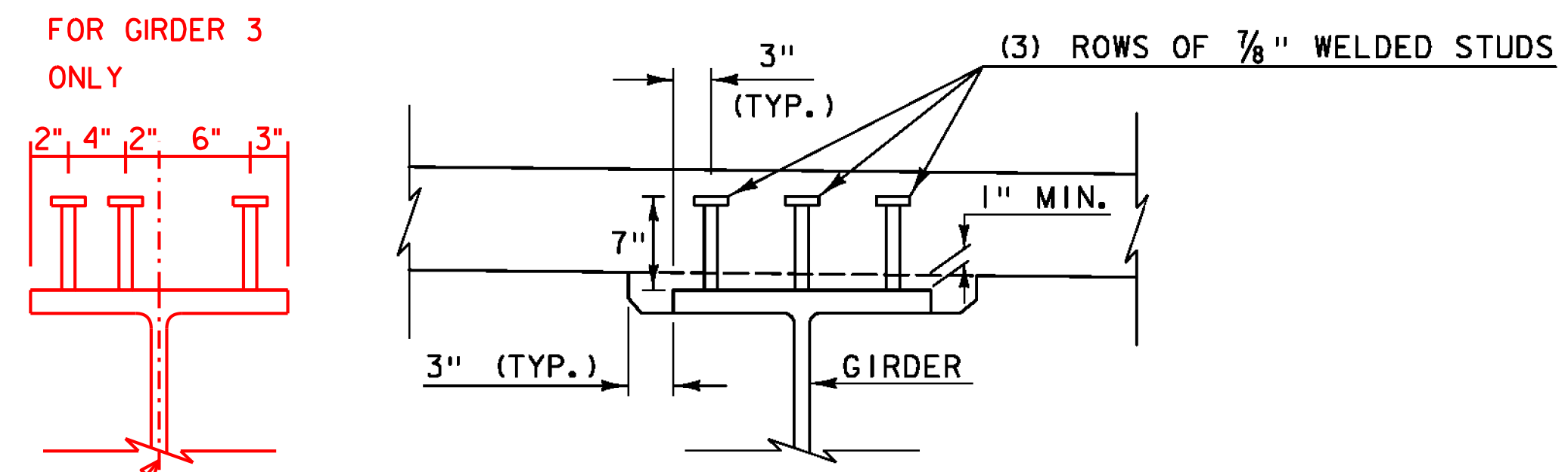

NOTE: STUDS SHALL PROJECT A MINIMUM OF 2" ABOVE THE BOTTOM OF THE SLAB. SHEAR CONNECTORS SHALL NOT BE WELDED TO FIELD SPLICE PLATES. SHEAR CONNECTORS DETAILED OVER FIELD SPLICE PLATES SHALL BE RELOCATED ADJACENT TO THE FIELD SPLICE PLATES. PROVIDE A MINIMUM OF 4" BETWEEN ADJACENT SHEAR CONNECTORS AND/OR SHEAR CONNECTORS AND FIELD SPLICE PLATES.

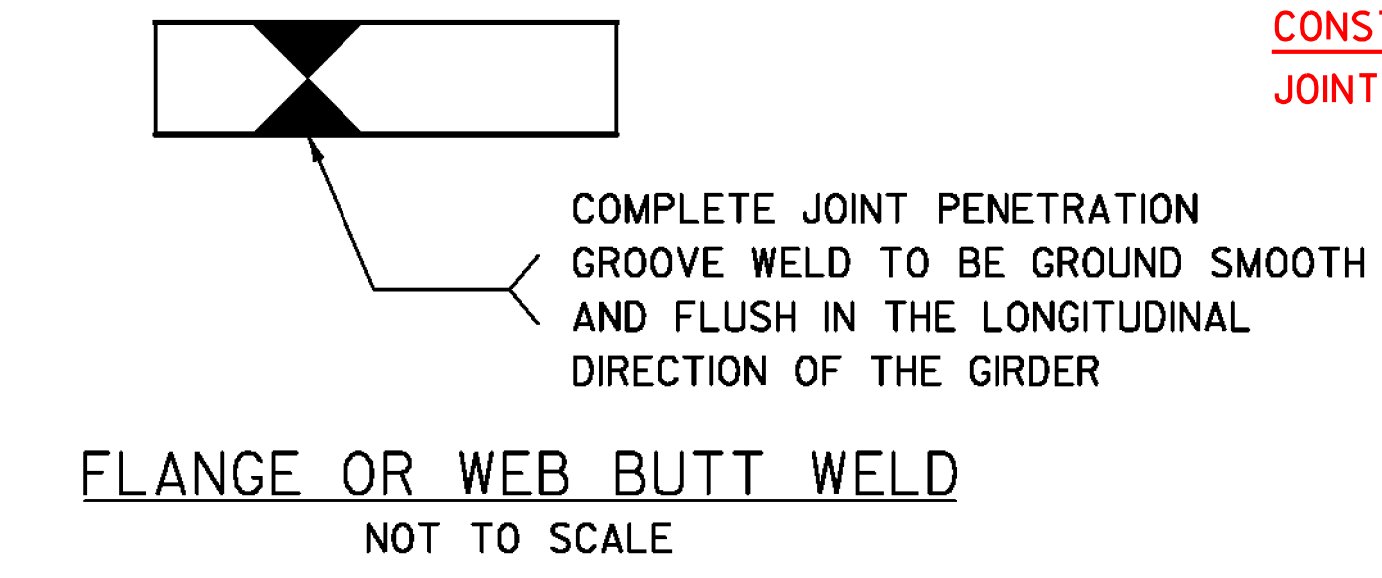
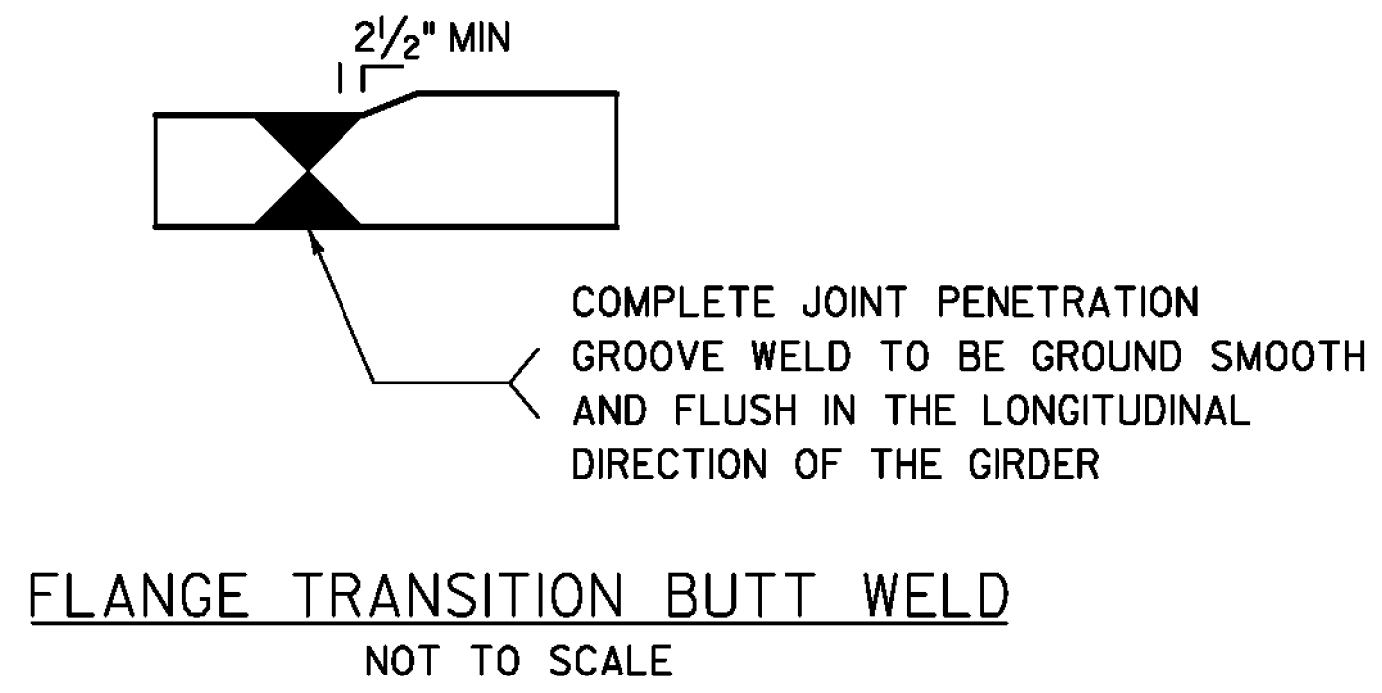
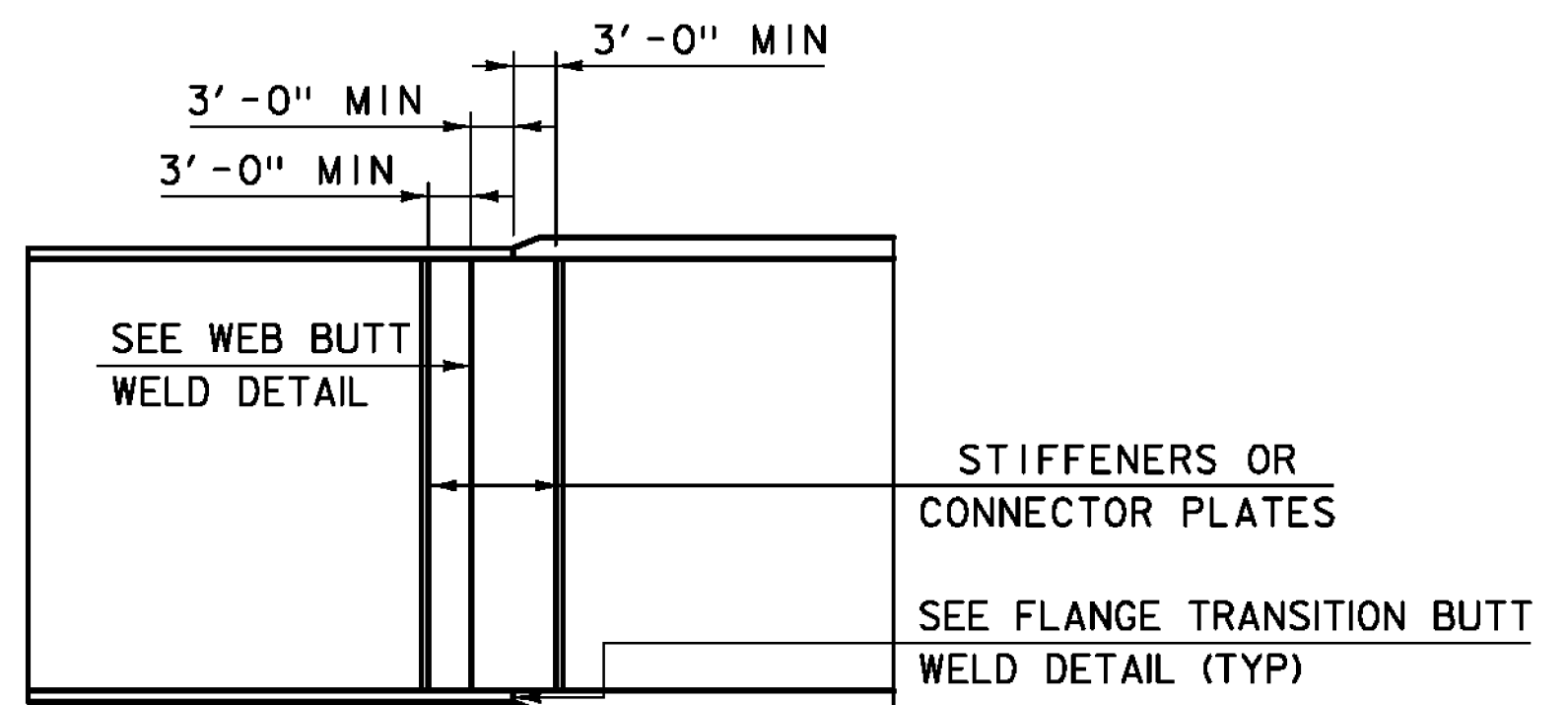

PROJECT NAME:	BENNINGTON
PROJECT NUMBER:	BRF 1000(16)
FILE NAME:	z88J087bdr_glrder.dgn
PROJECT LEADER:	R. HEBERT
DESIGNED BY:	D. MYERS
GIRDER ELEVATION	
PLOT DATE:	8/29/2014
DRAWN BY:	S. MORGAN
CHECKED BY:	R. HEBERT
SHEET	40 OF 75