

T.H. 3 TRAVERSE PI #2

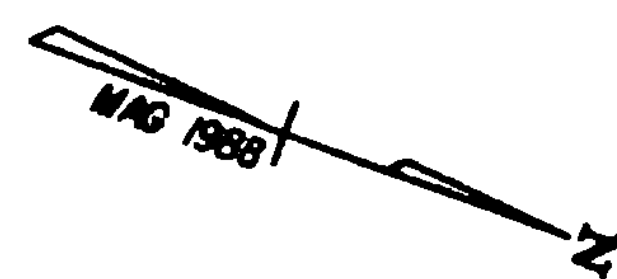
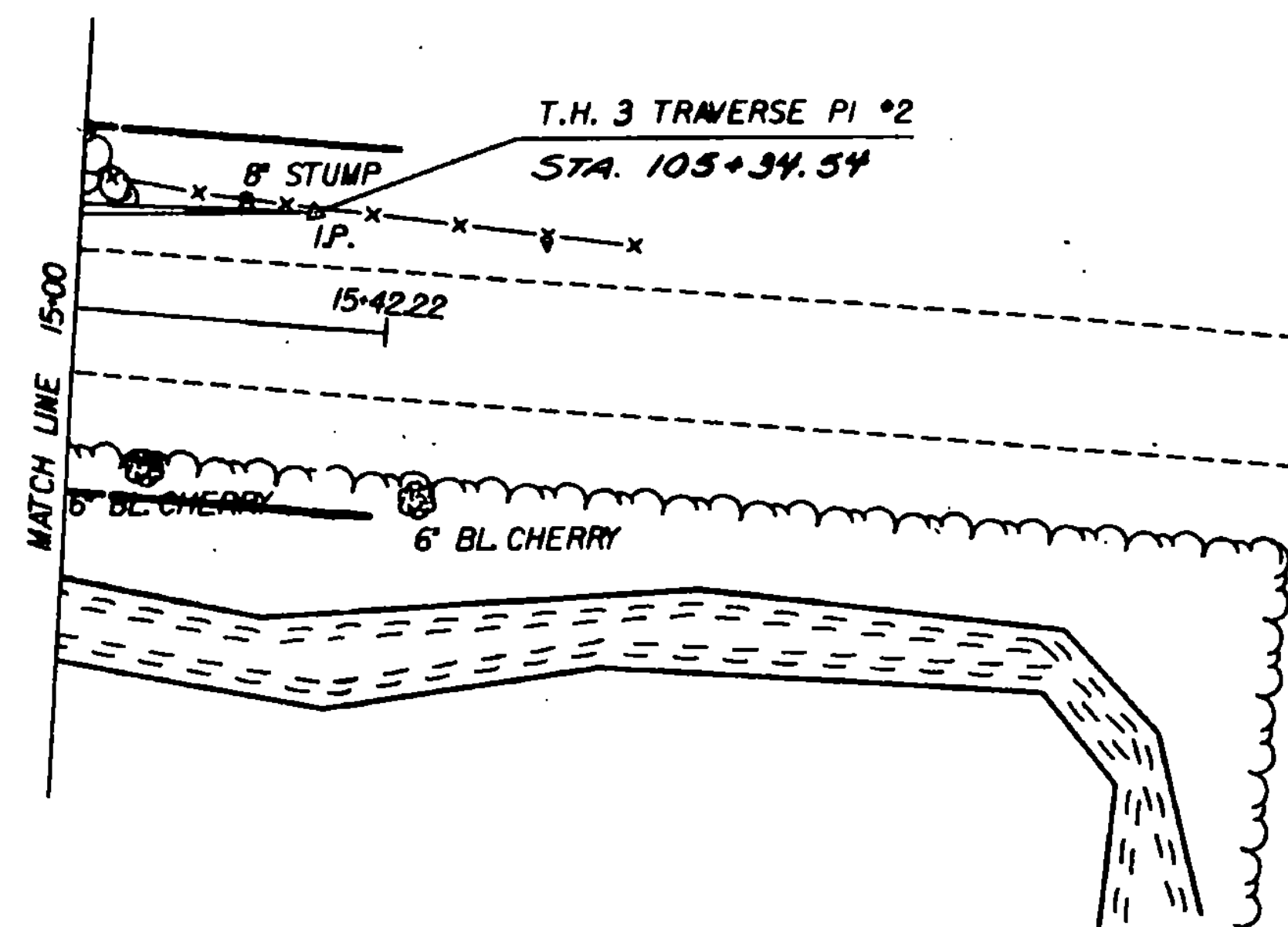
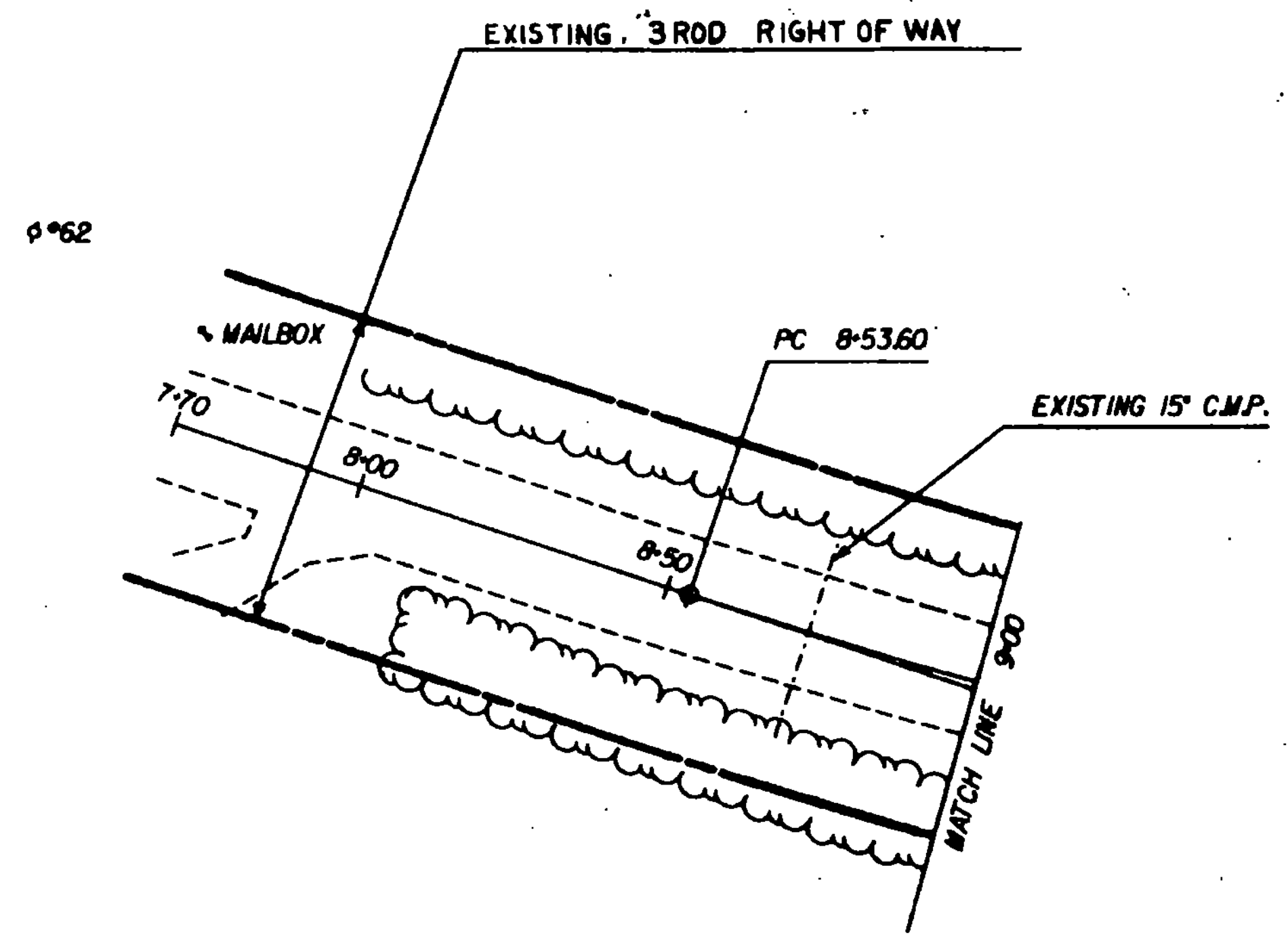

STATE OF VERMONT			
AGENCY OF TRANSPORTATION			
Town Of	CHELSEA	Bridge No.	30
Highway No.	T.H. 3	Loc. Sta.	
		Surv. Sta.	11+83 1/2
LAYOUT			
T.H. 3 OVER CRAM BROOK			
Designed By	R.E. SUCKERT	Drawn By	J. CLARK
Checked By	Y.S.P.	Date	8/89
		Bridge Design Supervisor	F.W. BOLKUM Date 2/92
PROJECT	CHELSEA	PROJECT NO.	T H 3806
L.C. Info.	ZFA1130.571 BTJ149.DGN		
Bridge Sheet No.	Sheet 3 of 19		