

**HEAVY DUTY STEEL BEAM GUARD RAIL**  
 LT. 11+37-11+67 11+99-12+35  
 RT. 11+31-11+67 11+99-12+28

**ANCHOR FOR STEEL BEAM RAIL**  
 11+50 LT 11+43 RT  
 12+24 LT 12+18 RT

**BRIDGE RAILING - STANDARD STEEL BEAM/FASCIA MOUNTED /STEEL TUBING**  
 LT. & RT. 11+67-11+99

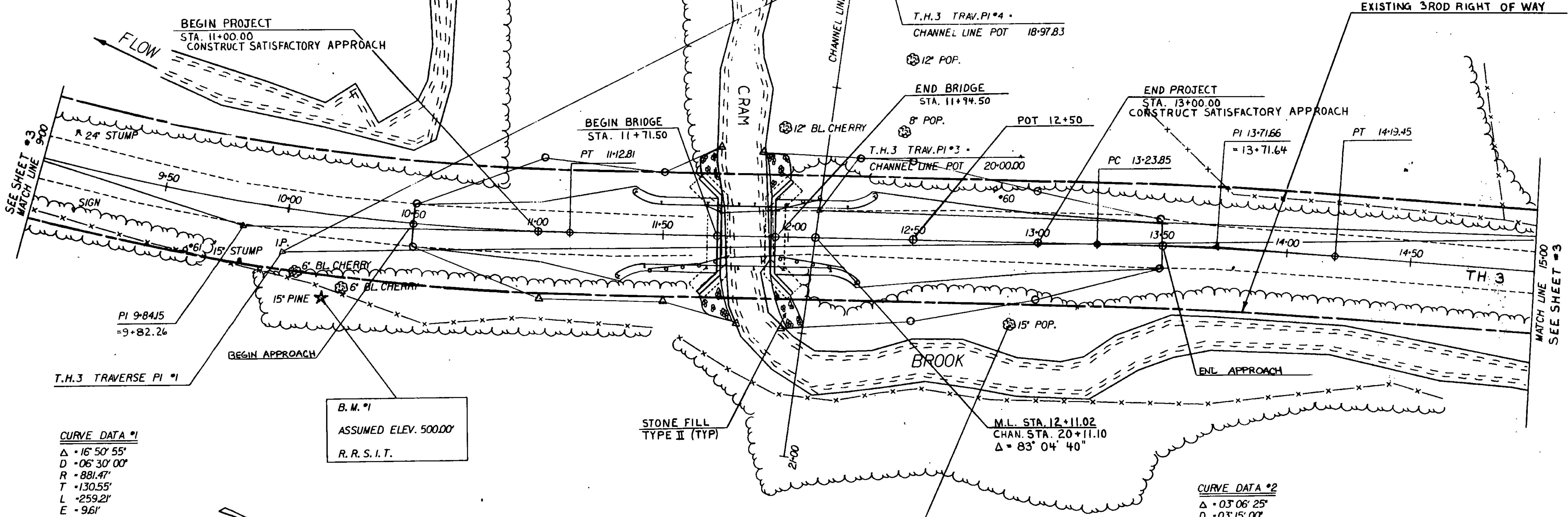
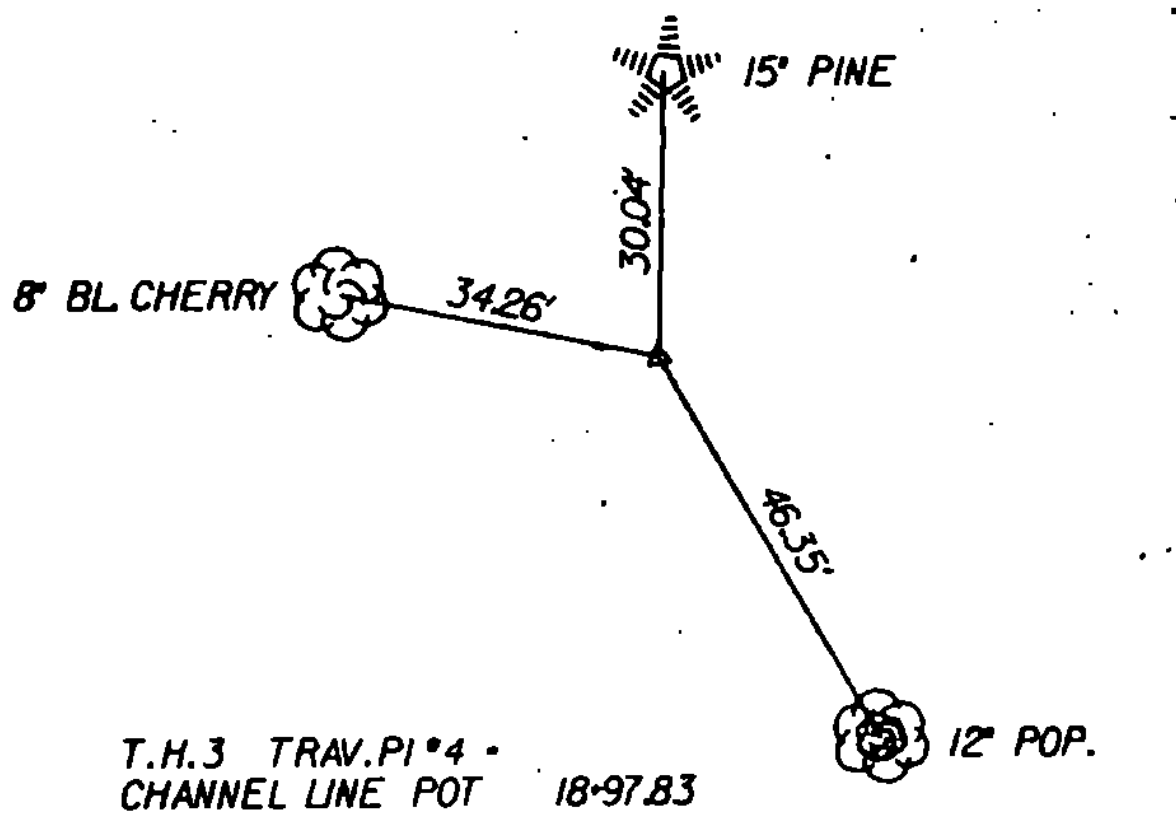
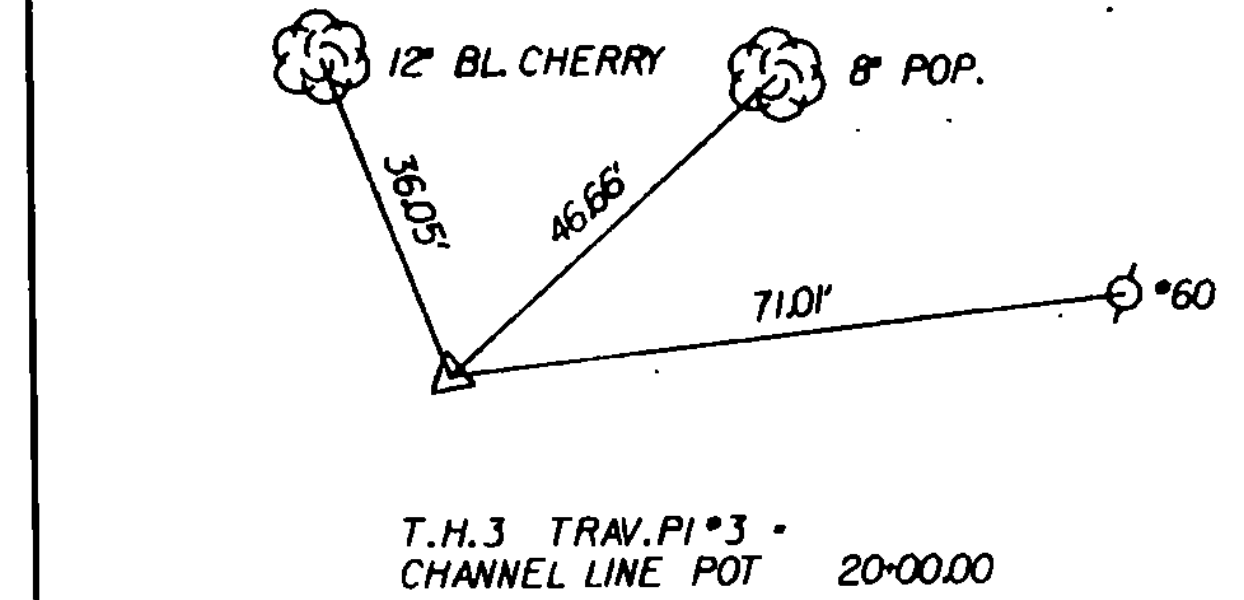

**CURVE DATA #1**  
 $\Delta = 16^\circ 50' 55''$   
 $D = 06^\circ 30' 00''$   
 $R = 881.47'$   
 $T = 130.55'$   
 $L = 259.21'$   
 $E = 9.61'$

B. M. #1  
 ASSUMED ELEV. 500.00'  
 R. R. S. I. T.

STONE FILL TYPE II (TYP)

M.L. STA. 12+11.02  
 CHAN. STA. 20+11.10  
 $\Delta = 83^\circ 04' 40''$

**CURVE DATA #2**  
 $\Delta = 03^\circ 06' 25''$   
 $D = 03^\circ 15' 00''$   
 $R = 1762.95'$   
 $T = 47.81'$   
 $L = 95.60'$   
 $E = 0.65'$

B. M. #2  
 ASSUMED ELEV. 488.50'  
 R. R. S. I. T.

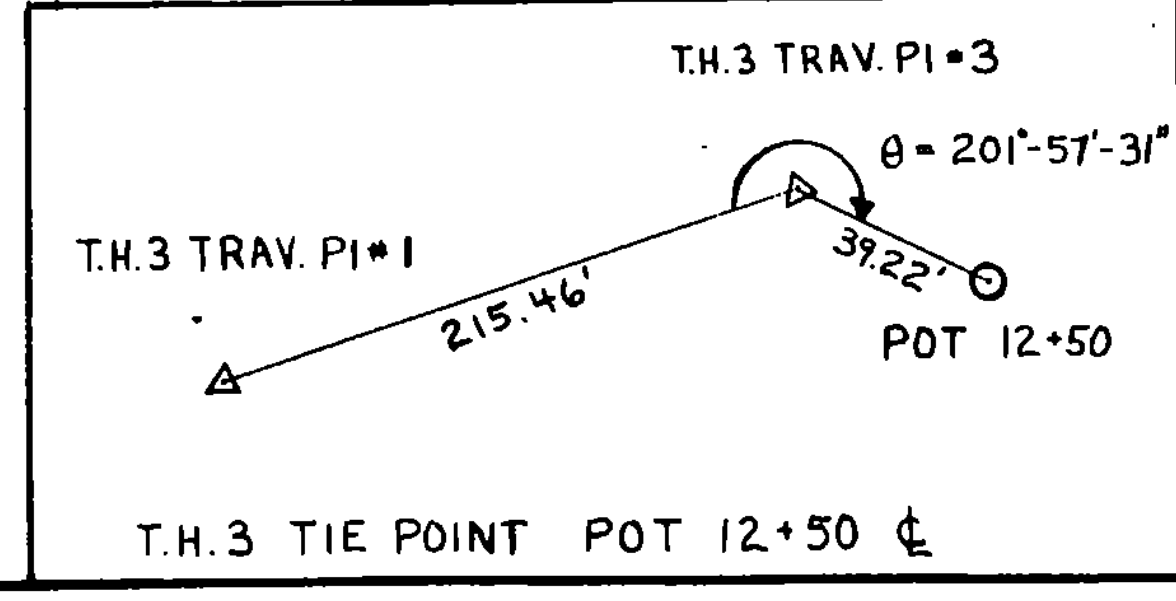
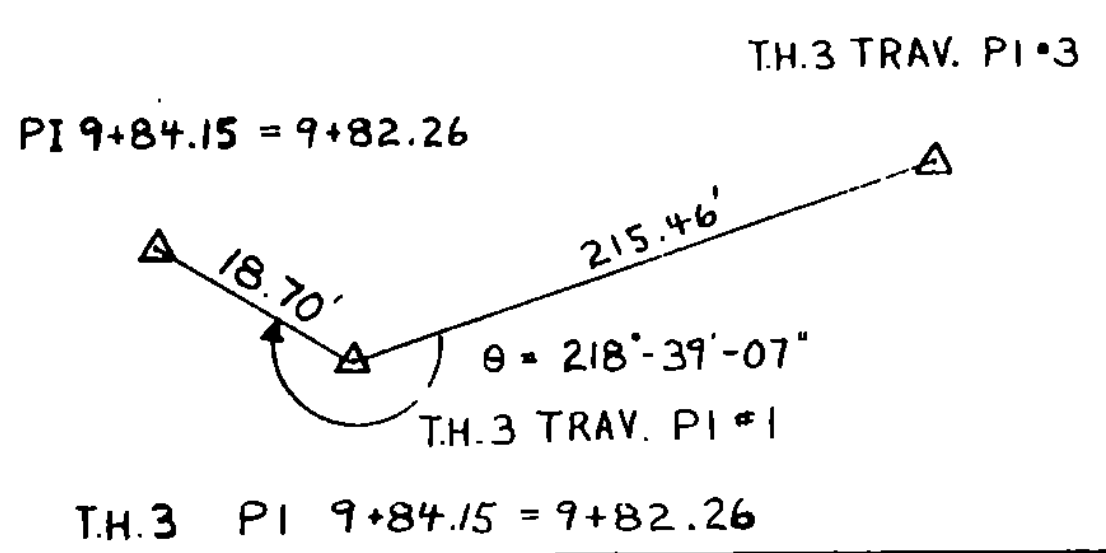
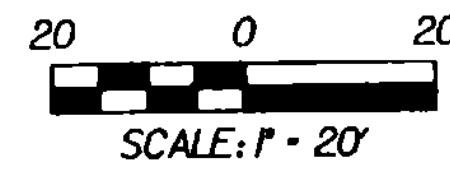
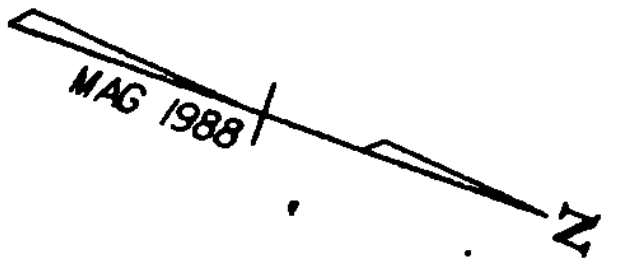

<b>STATE OF VERMONT</b>	
<b>AGENCY OF TRANSPORTATION</b>	
Town Of <b>CHELSEA</b>	Bridge No. <b>30</b>
Highway No. <b>T. H. 3</b>	Log Sta. <b>11+83 1/2</b>
LAYOUT	
<b>T. H. 3 OVER CRAM BROOK</b>	
Designed By <b>R.E. SUCKERT</b>	Drawn By <b>J. CLARK</b>
Checked By <b>C.P. WILLIAMS</b>	Bridge Design Supervisor <b>F.W. BOLKUM</b>
Date <b>2/92</b>	Date <b>2/92</b>
PROJECT <b>CHELSEA</b>	PROJECT NO. <b>TH 3806</b>
I.G.C. info. <b>ZFAH(3057) 87J149.DGN</b>	
Bridge Sheet No.	Sheet <b>2</b> of <b>19</b>