

INDEX OF SHEETS

- 1. TITLE
- 2.-3. LAYOUTS
- 4. PROFILE
- 5. QUANTITIES
- 6. GEN. NOTES & MISC. DETAILS
- 7. PRELIMINARY INFORMATION
- 8. SLAB DETAILS
- 9. ABUTMENT DETAILS
- 10. WINGWALL DETAILS
- 11. REINFORCING STEEL SCHEDULE
- 12. R.O.W. PLAN SHEET
- 13.-15. ROADWAY SECTIONS
- 16.-19. CHANNEL SECTIONS

# STATE OF VERMONT AGENCY OF TRANSPORTATION

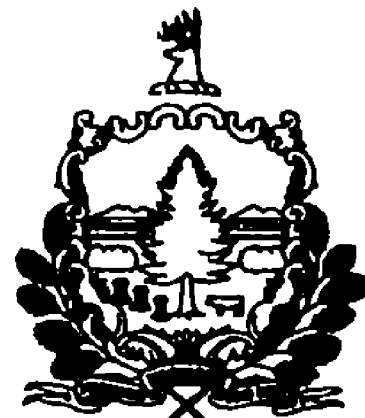

## PROPOSED IMPROVEMENT BRIDGE PROJECT TOWN OF CHELSEA COUNTY OF ORANGE

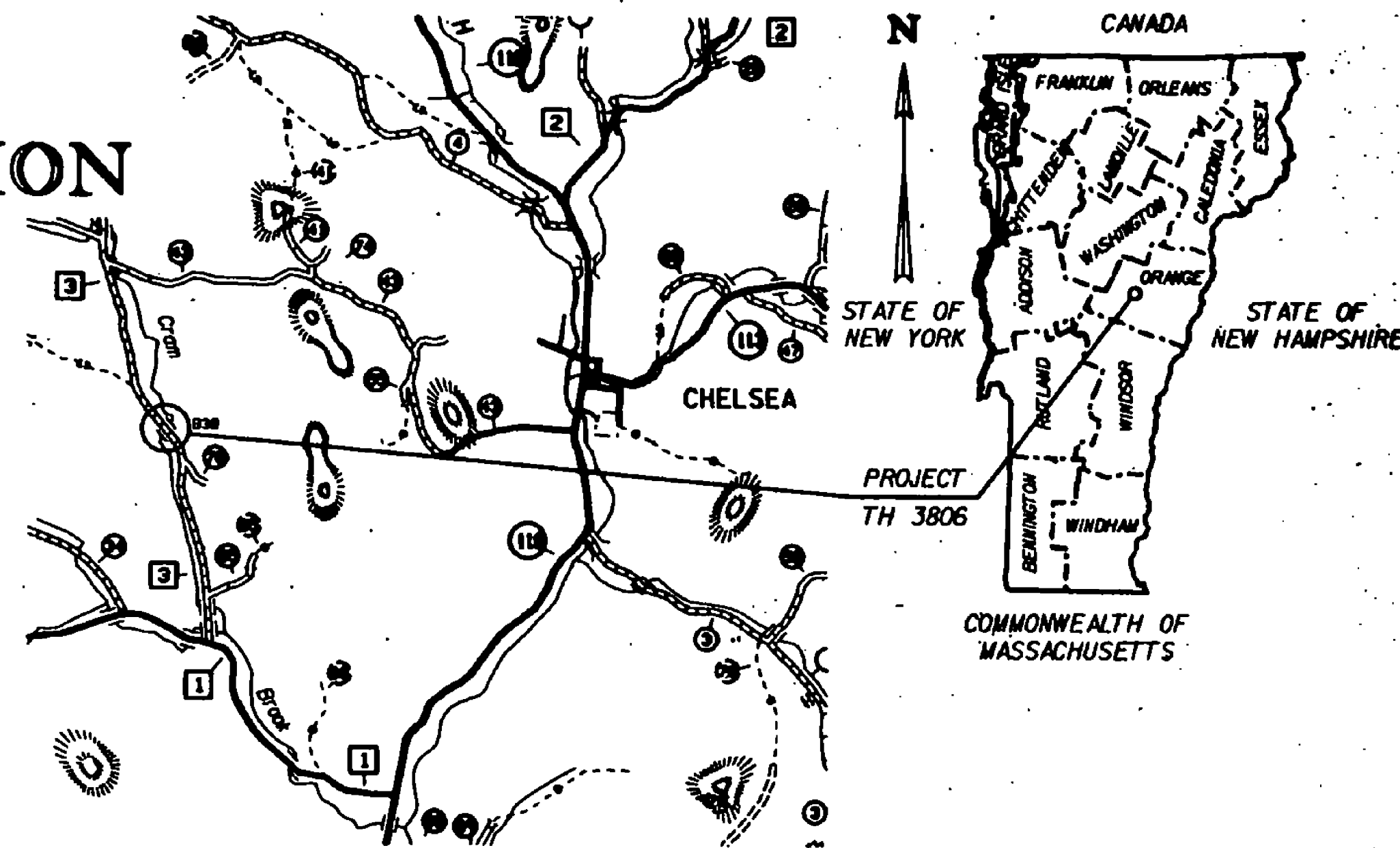

Dated: APR 5 1993

G. EASTMAN, INC.  
Contractor  
 *Gordon Eastman*   
Signature  
PRESIDENT  
Title

*W. J. ...*  
Transportation Secretary's Signature

LIST OF STANDARDS

E-100	10-21-92 R
E-101	10-21-92 R
E-106	1-23-87 R
E-107a	9-10-87
G-1	10-31-85 R
G-1d	10-31-85 R
SB-R6-82	11-13-91 R
SB-R7-90	3-10-92 R

CONTRACT PLANS

THESE PLANS DO NOT REFLECT  
CHANGES MADE ON THE PROJECT.

ROUTE NO. T.H.3 (CLASS 2)

BRIDGE NO. 30

PROJECT LOCATION: BEGINNING AT A POINT ON TH \*3 APPROXIMATELY 0.95 MILES FROM THE INTERSECTION OF TH \*1 AND TH \*3 AND EXTENDING APPROXIMATELY 0.04 MILES IN A NORTHWESTERLY DIRECTION

PROJECT DESCRIPTION: WORK TO CONSIST OF THE REMOVAL AND REPLACEMENT OF THE EXISTING STRUCTURE WITH RELATED CHANNEL AND ROADWAY WORK

LENGTH OF BRIDGE: 23.00'  
LENGTH OF ROADWAY: 177.00'  
LENGTH OF PROJECT: 200.00'

BRIDGE RAILING-  
STANDARD STEEL BEAM /  
FASCIA MOUNTED /  
STEEL TUBING (TYP)

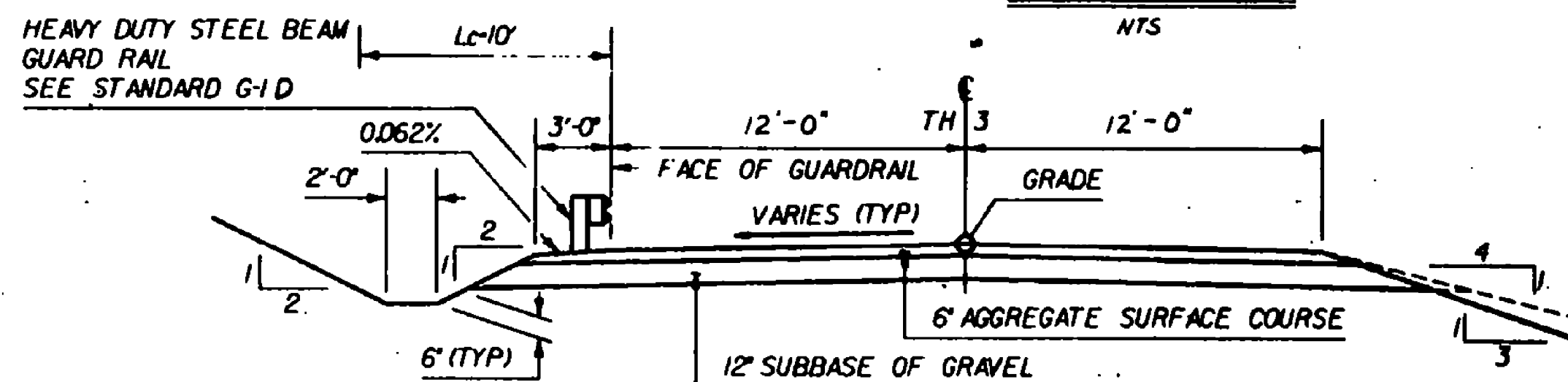
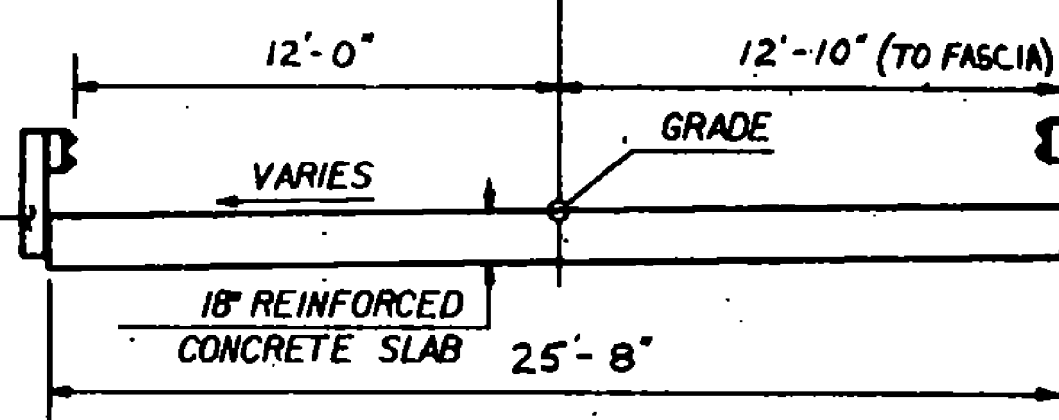

CONVENTIONAL SIGNS

CONTROL OF ACCESS	---
COUNTY LINE	---
CULVERT	---
FENCE LINE	-x-x-
GUARD RAIL	o-o-o-o
LIMITS OF ACCESS	o-o-o-o
POINT OF ACCESS	x
POWER POLE	□
PROPERTY LINE	---
RAILROAD	---
R. O. W. TAKING LINE	SR
SLOPE RIGHTS	o-△
STONE WALL	o-o-o-o
SURVEY LINE	+
TELEPHONE POLE	◇
TOE OF SLOPE	o-o-o-o
TOP OF CUT	△-△-△
TOWN LINE	---
TRAVELED WAY	---
TREES	⊗

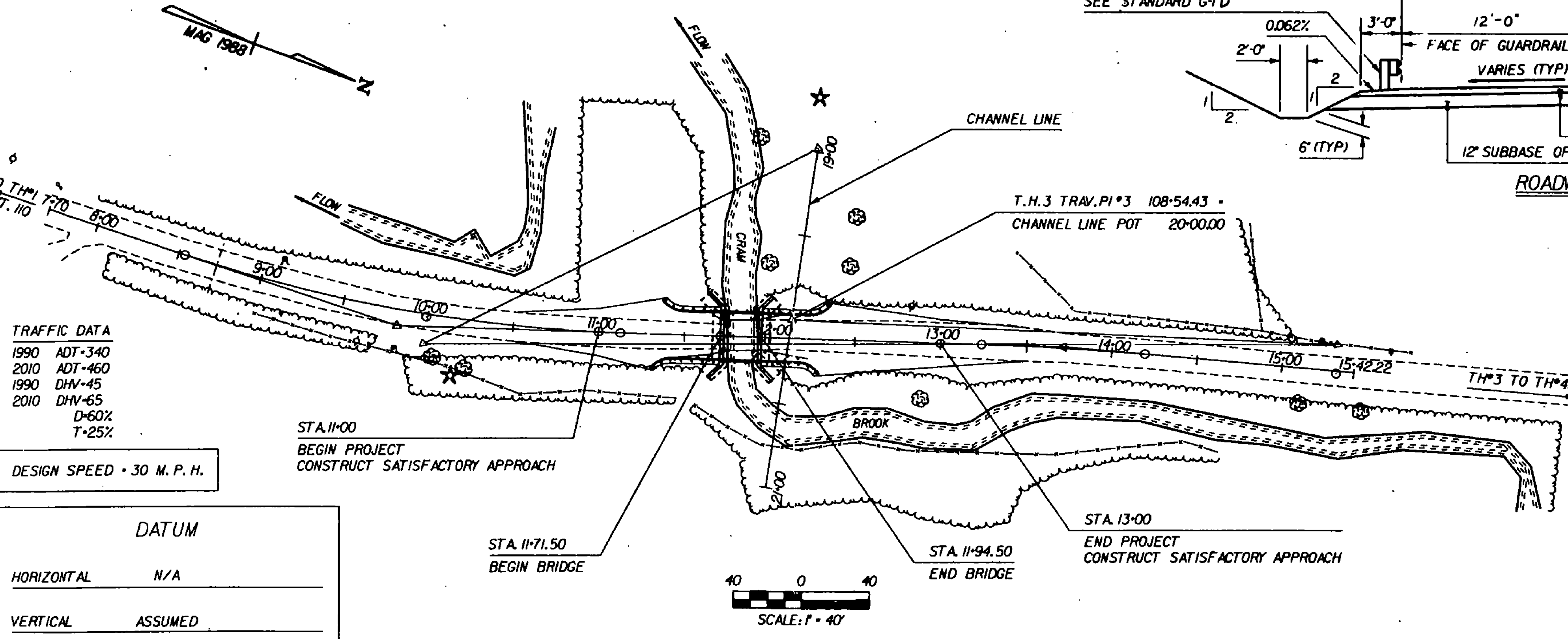

TRAFFIC DATA

1990	ADT-340
2010	ADT-460
1990	DHV-45
2010	DHV-65
D=60%	
T=25%	

DESIGN SPEED - 30 M. P. H.

DATUM

HORIZONTAL	N/A
VERTICAL	ASSUMED

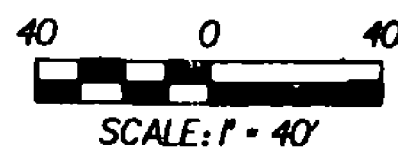

THESE PLANS ARE SUBJECT TO SUCH ENGINEERING CHANGES AS MAY BE REQUIRED BY THE FEDERAL HIGHWAY ADMINISTRATION OR THE CHIEF ENGINEER. CONSTRUCTION IS TO BE CARRIED ON IN ACCORDANCE WITH THESE PLANS AND THE STANDARD SPECIFICATIONS FOR CONSTRUCTION DATED 1990, AS APPROVED BY THE FEDERAL HIGHWAY ADMINISTRATION ON MARCH 15, 1990 FOR USE ON THIS PROJECT, INCLUDING ALL SUBSEQUENT REVISIONS AND SUCH REVISED SPECIFICATIONS AND SPECIAL PROVISIONS AS ARE INCORPORATED IN THESE PLANS.

SUBMITTED BY ORDER OF THE STATE TRANSPORTATION BOARD  
APPROVED *Robert F. ...* DATE 12/1/93  
Acting DIRECTOR OF ENGINEERING

PROJECT - CHELSEA  
PROJECT NUMBER - T H 3806  
SHEET 1 OF 19 SHEETS

By: J. CLARK ZFA: [30,57] 87J149.DGN:1