

75+00 Lt. ~ 77+37 Lt.
Removal of Existing Fence (Nonpart.)
Barb Wire Fence - Four Strand

Note: Contractor Shall Remove Electrical Stand-Off
From Existing Fence and Reset on New Barb Wire
Fence. Contractor Shall Contact Mr. Henry Perrin
(Property Owner) Prior to Doing This Work.
This Work Shall Be Subsidiary to The Item Barb
Wire Fence - Four Strand.

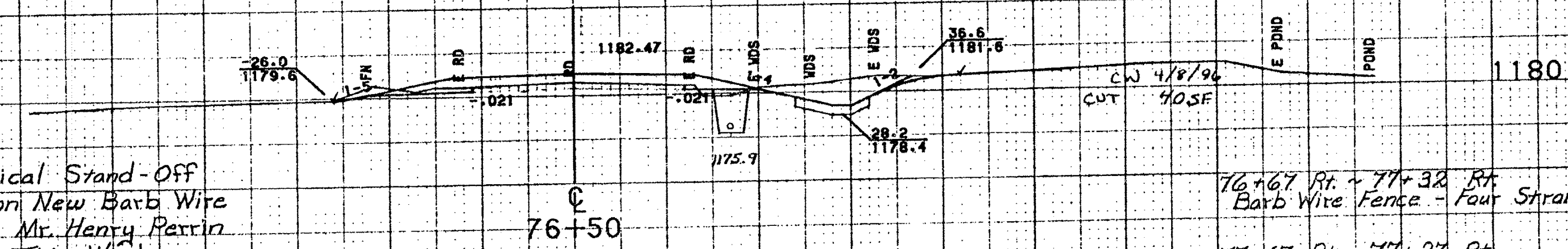

76+67 Rt. ~ 77+32 Rt.
Barb Wire Fence - Four Strand

77+67 Rt. ~ 77+27 Rt.
Removal of Existing Fence

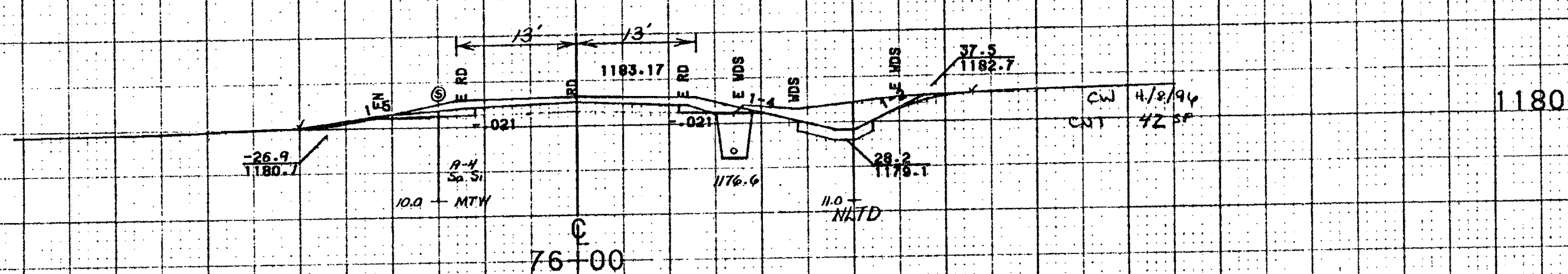

END APPROACH
BEGIN PROJECT MEGC-M6200(2) S
Begin Subbase Shim Course

75+50 Rt.
Begin New 6" x 500' Underdrain w/ F.B

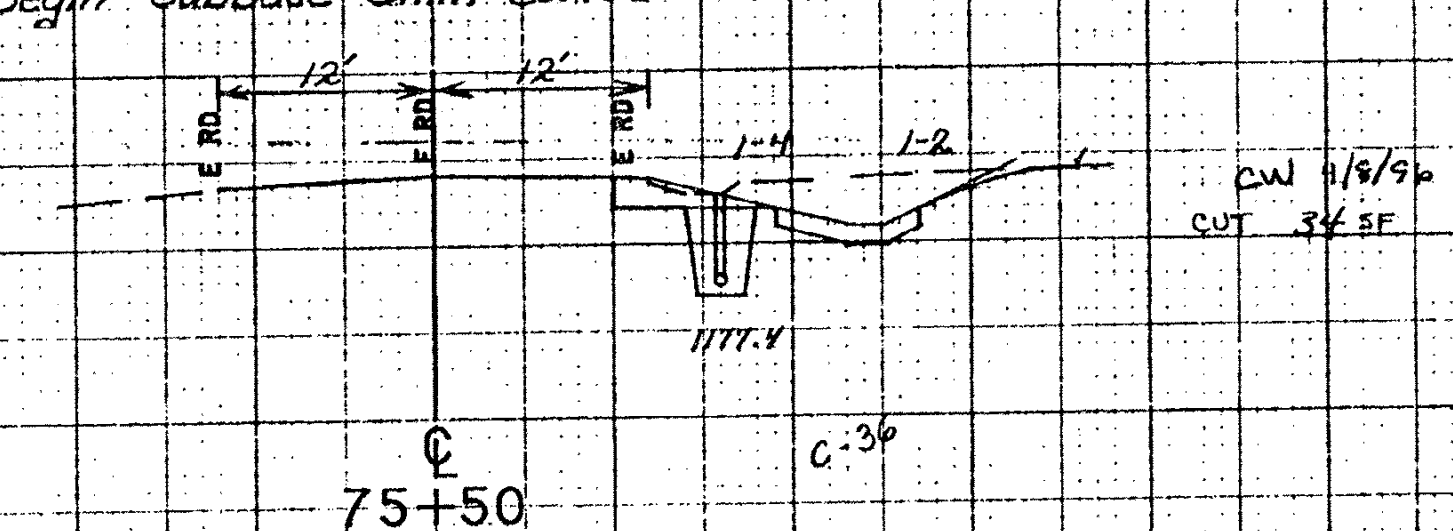

75+50 Rt.
Begin Special Ditch w/ Stone Fill, Type I

75+18 Rt.
Construct Mailbox Turnout
Relocate Mailbox, Single Support

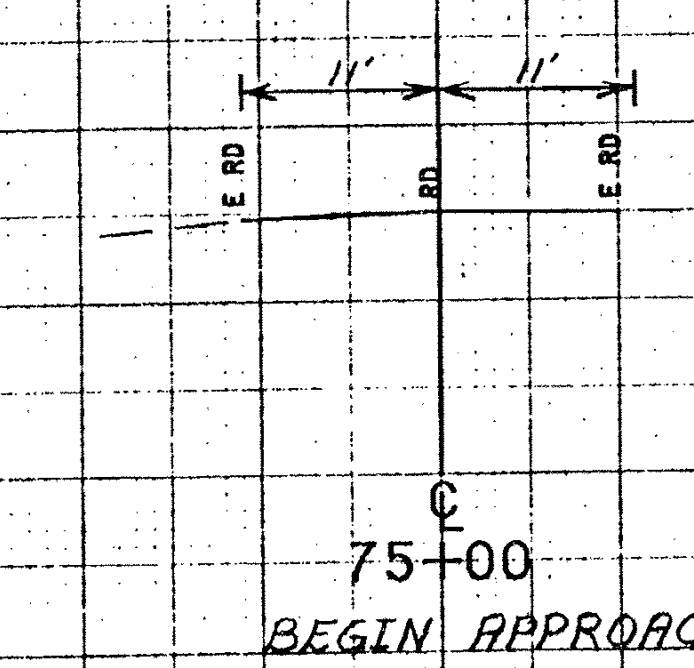

74+98 Rt.
Construct Gravel Drive (13 Ft.)
(Grade & Shape w/ Aggregate Shoulders, In Place)

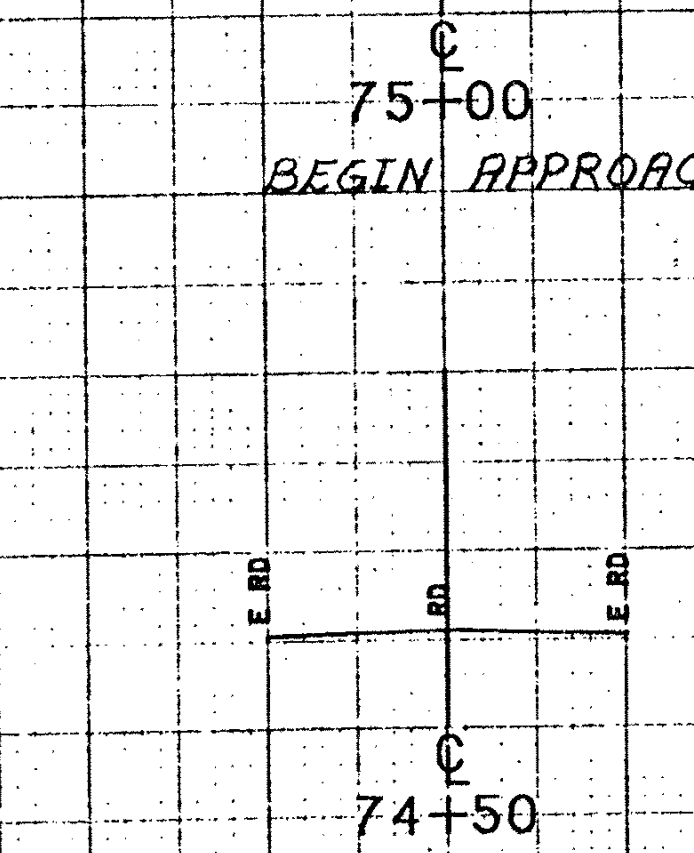

FROM STA. 74+50		TO STA. 76+50	
PROJECT NAME BERLIN		PLOTTED 06/05/90	
NO. MEGC-M6200(2) S		09/87 0076	
SURVEYED BY REED			
SHEET 52 OF 73 SHEETS			

SCALE 1" = 50 FEET