

# UTILITY SHEET

REV. CURVE #4  
 $\Delta = 10^{\circ}-45'-00.0''$  LT.  
 $D = 5^{\circ}-00'-00''$   
 $R = 1145.916$   
 $T = 107.82$   
 $L = 215.00$   
 $E = 5.06$   
 BANK = 0.055 FT/FT

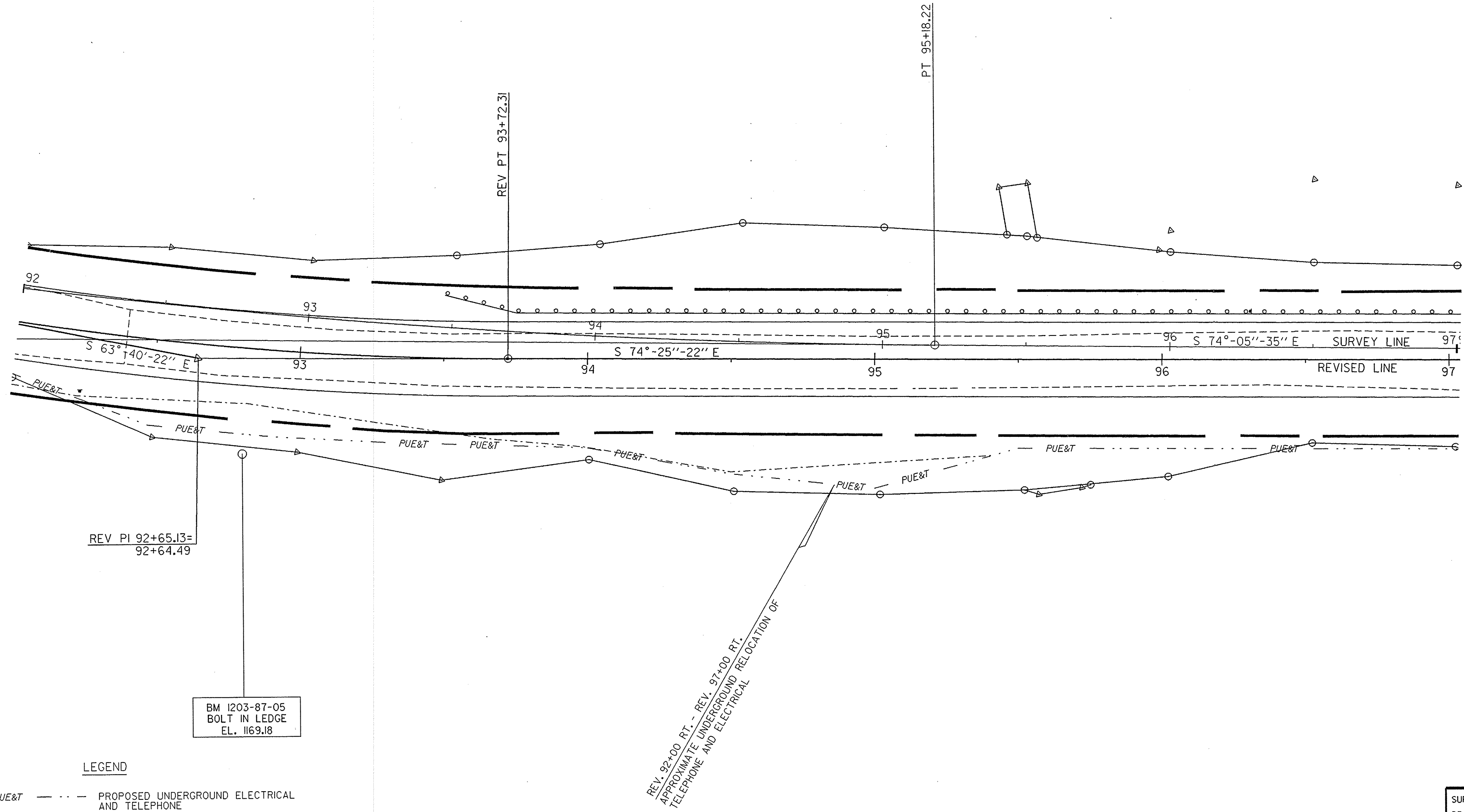
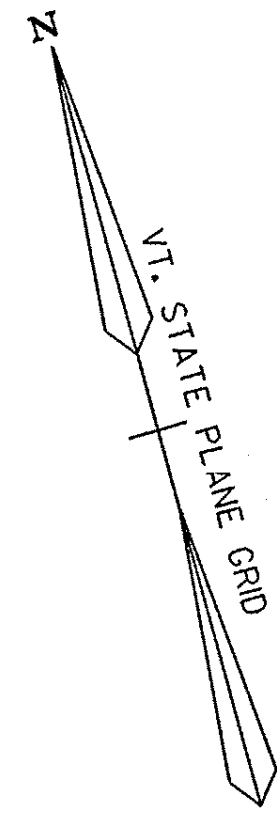

**LEGEND**

— PUE&T — — — PROPOSED UNDERGROUND ELECTRICAL AND TELEPHONE

REV. 92+00 RT. - REV. 97+00 RT.  
 APPROXIMATE UNDERGROUND RELOCATION OF  
 TELEPHONE AND ELECTRICAL

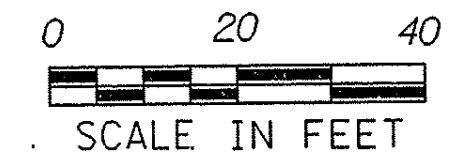

**DATUM**  
 VERTICAL NGVD 1929  
 HORIZONTAL NAD 1927

SURVEYED BY	<u>C. REED</u>	DATE	<u>9-87</u>
DRAWN BY	<u>D. WILLEY</u>	DATE	<u>10-87</u>
SQUAD LEADER	<u>T. BOHL</u>		
DESIGN FILE NO.	<u>/sqdd/87e055/de055bor.dgn</u>		
IPARM FILE	<u>de055u+4.i</u>	DATE PLOTTED	<u>17-JUL-1997</u>
PROJ. NAME	<u>BERLIN</u>		
PROJ. NO.	<u>MEGC-M6200(2)S</u>		
SHEET	<u>48</u>	OF	<u>73</u> SHEETS