

# UTILITY SHEET

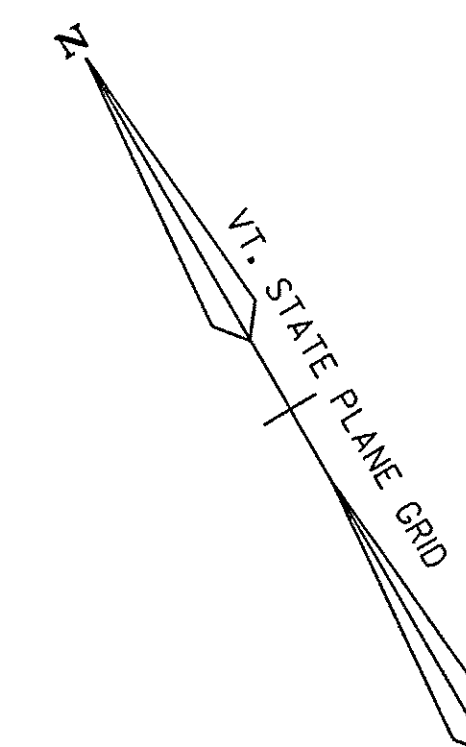

REV. CURVE #3  
 $\Delta = 6^\circ - 15' - 00.0''$  LT.  
 $D = 2^\circ - 00' - 00''$   
 $R = 2864.790$   
 $T = 156.41$   
 $L = 312.50$   
 $E = 4.27$   
 $BANK = 0.027$  FT/FT

CURVE DATA #3  
 $\Delta = 17^\circ - 36' - 50''$  LT.  
 $D = 2^\circ$   
 $R = 2864.79'$   
 $T = 443.85'$   
 $L = 880.69'$   
 $E = 34.18'$

NOTE: 3' X 3' NAVIGATION BOX AT  
 REV 87+92± LT. WILL BE  
 REMOVED PRIOR TO CONSTRUCTION.

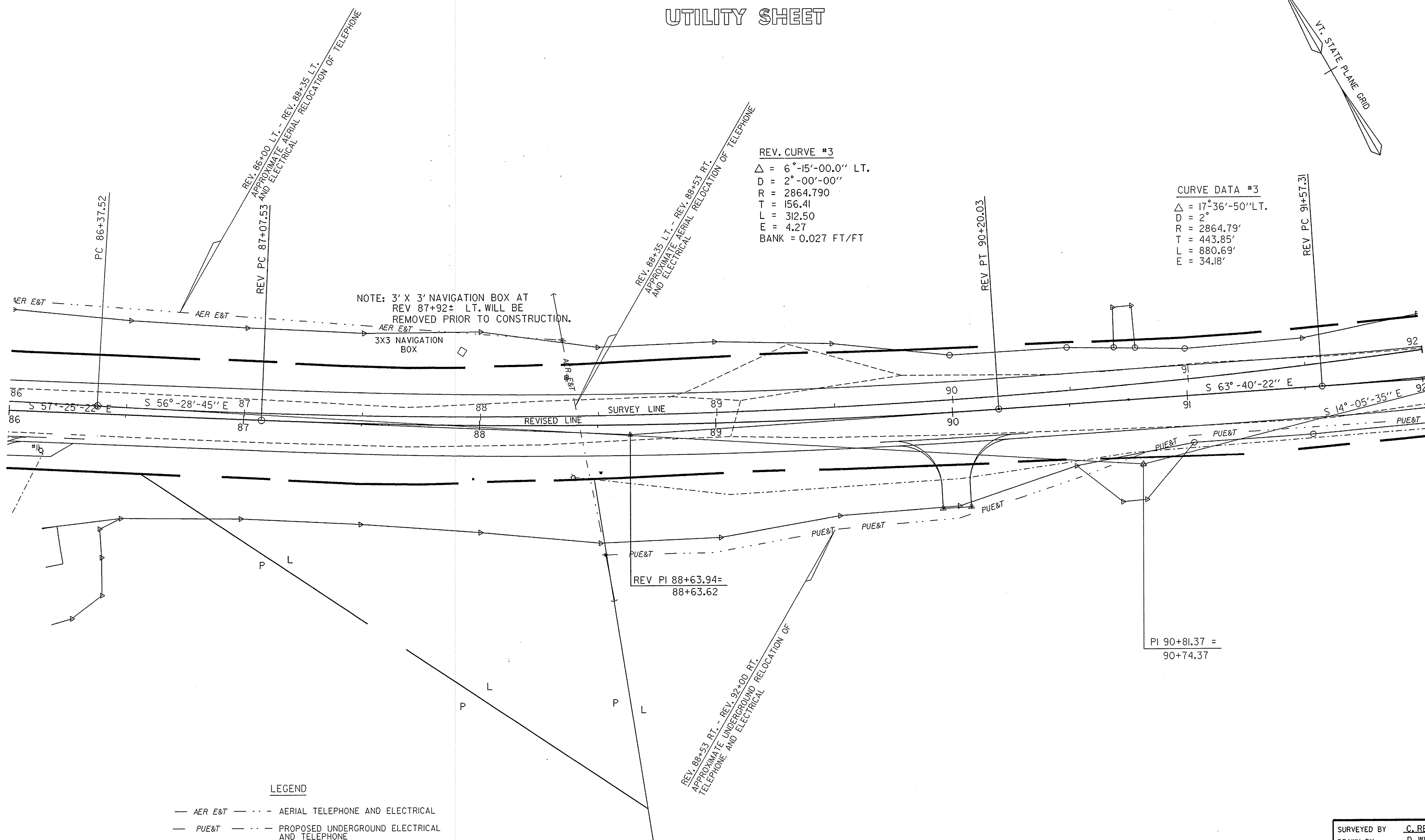

**LEGEND**

- AER E&T --- AERIAL TELEPHONE AND ELECTRICAL
- PUE&T --- PROPOSED UNDERGROUND ELECTRICAL AND TELEPHONE

**DATUM**  
 VERTICAL NGVD 1929  
 HORIZONTAL NAD 1927

0 20 40  
 SCALE IN FEET

SURVEYED BY	C. REED	DATE	9-87
DRAWN BY	D. WILLEY	DATE	10-87
SQUAD LEADER	T. BOHL		
DESIGN FILE NO.	/sqdd/87e055/de055bor.dgn		
IPARM FILE	de055ut3.1	DATE PLOTTED	17-JUL-1997
PROJ. NAME	BERLIN		
PROJ. NO.	MEGC-M6200(2)S		
SHEET	47	OF	73 SHEETS