

STATE OF VERMONT

REV. CURVE #3  
Δ = 6°-15'-00.0" LT.  
D = 2°-00'-00"  
R = 2864.790  
T = 156.41  
L = 312.50  
E = 4.27  
BANK = 0.027 FT/FT

CURVE DATA #3  
Δ = 17°-36'-50" LT.  
D = 2°  
R = 2864.79'  
T = 443.85'  
L = 880.69'  
E = 34.8'

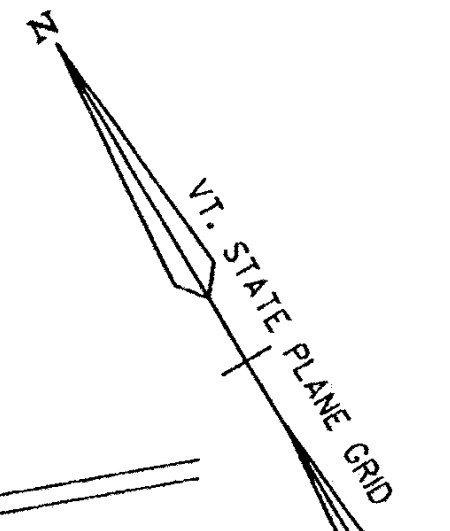

TO SHEET 12 OF 17

6B

TO SHEET 14 OF 17

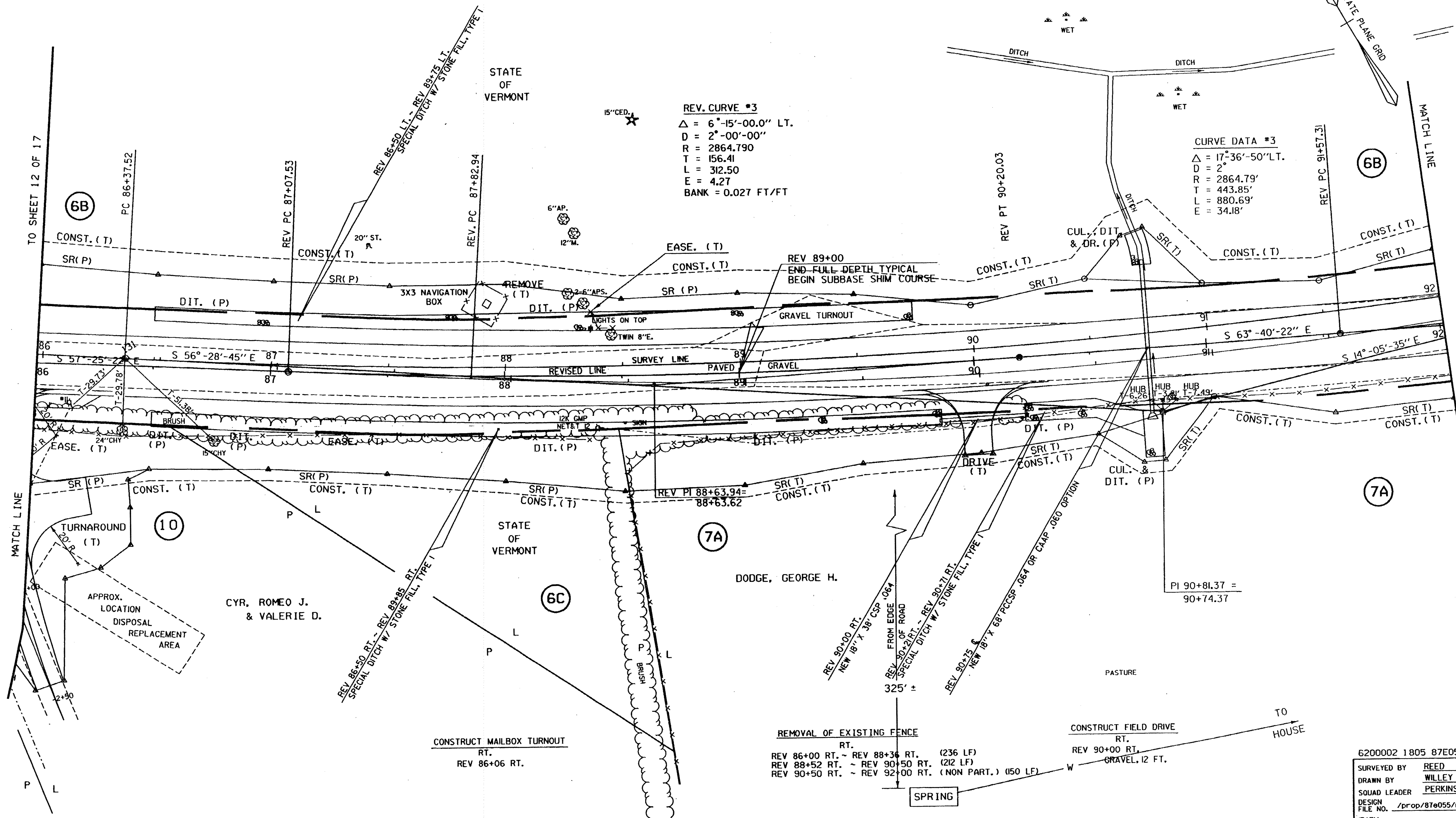

DATUM  
VERTICAL \_\_\_\_\_  
HORIZONTAL \_\_\_\_\_

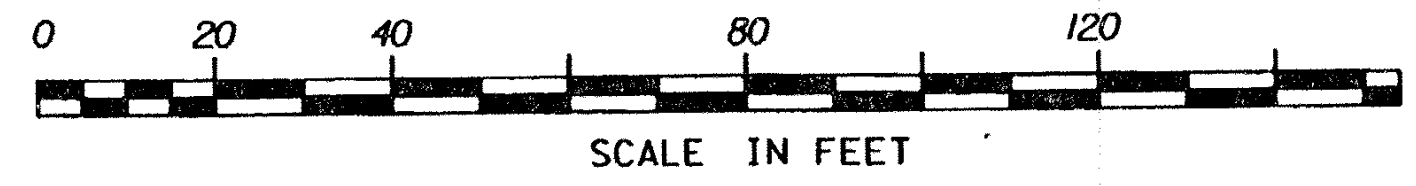

REMOVAL OF EXISTING FENCE  
RT.  
REV 86+00 RT. ~ REV 88+34 RT. (236 LF)  
REV 88+52 RT. ~ REV 90+50 RT. (212 LF)  
REV 90+50 RT. ~ REV 92+00 RT. (NON PART.) (150 LF)

CONSTRUCT FIELD DRIVE  
RT.  
REV 90+00 RT. ~ REV 92+00 RT. (NON PART.) (150 LF)

06-13-94	REVISION 28
08-23-93	REVISION 26
05-24-93	REVISION 22
04-30-93	REVISION 16

6200002 1805 87E055 FJM  
SURVEYED BY REED DATE 09-87  
DRAWN BY WILLEY DATE 10-87  
SQUAD LEADER PERKINS  
DESIGN FILE NO. /prop/87e055/ra055zzz.dgn  
IPARM FILE 87e0553r.1 DATE PLOTTED 12-JUN-1994

BERLIN  
MEGC M 6200 (2) S  
R. O. W. SHEET 13 OF 17  
SHEET 13 OF 17