

BENT BARS												
MARK	QTY	LENGTH	TYPE	A	B	C	D	E	H	J	K	LOCATION/COMMENTS
ABUTMENT NO. 1												
A1601	14	1160	S10		450	300	450					WINGWALL END
A1602	26	6100	STR.									BREASTWALL HORIZONTAL
A1603	13	1610	S10		450	750	450					WINGWALL END
A1604	15	1660	S10		700	300	700					WINGWALL TOP
A1605	103	2700	STR.									WING & BREASTWALL VERT.
A1606	10	2630	STR.									WINGWALL VERTICAL
A1607	10	2150	STR.									WINGWALL VERTICAL
A1608	10	2110	S10		700	750	700					BREASTWALL TOP
A1609	2	2135	S10		700	775	700					BREASTWALL TOP
A1610	25	1740	14	700	460	600	--	--	320		330	BREASTWALL & BOTTOM OF SLAB STEEL
A1611	24	1250	12	--	475	280	495		350		350	APPROACH SLAB SEAT REINFORCEMENT
A1612	19	1200	STR.									FAR FACE CORNER REINFORCING HORIZ.
A1613	144	1025	S10		150	750	150					BREASTWALL TIES BEND AROUND 65mm PIN
A1614	2	2220	12	--	--	1530	705		270	--	650	WING TOP
A1615	1	1745	12	--	--	1100	650		590	--	270	WING TOP
A1616	1	1875	12	--	--	1100	780		710	--	325	WING TOP
A1617	10	1670	STR.									WINGWALL VERTICAL
A1618	1	2775	--	SEE SKETCH								TOP OF BREASTWALL
A1619	1	1580	12	--	--	610	985		340	--	925	TOP OF BREASTWALL
A1620	1	1210	12	--	--	610	610		425	--	435	TOP OF BREASTWALL
A1621	1	2450	S10		--	1490	980					BREASTWALL TO TOP OF SLAB
A1622	4	6950	STR.									APPROACH SLAB SEAT HORIZONTAL
A1901	10	3610	STR.									WING HORIZONTAL
A1902	10	3135	12	--	--	2160	1000		340	--	940	WING HORIZONTAL
A2201	13	4800	STR.									WING HORIZONTAL N.F.
A2202	13	4200	STR.									WING HORIZONTAL F.F.
A2203	1	4840	12	--	--	3900	945		935	--	140	TOP OF WING HORIZONTAL
A2204	1	4200	12	--	--	3900	305		300	--	45	TOP OF WING HORIZONTAL
A2205	26	4375	12	--	--	2400	1000		340	--	940	BREASTWALL HORIZONTAL
A2206	2	4385	12	--	--	2400	1010		340	--	950	BREASTWALL HORIZONTAL BTM
A2207	30	3850	STR.									WINGWALL HORIZONTAL
DECK SLAB REINFORCEMENT												
S1601	232	4250	STR.									BOTTOM MAT TRANSVERSE
S1602	116	5960	STR.									TOP MAT TRANSVERSE
S1603	88	12100	STR.									TOP & BTM MAT LONGITUDINAL
S1604	48	8330	STR.									CURB & SLAB ADDITIONAL LONGIT. REINF.
S1605	153	1425	--	SEE SKETCH								CURB STIRRUPS
S1901	232	1755	12	180	1500	--	--		--	153	--	TOP MAT OVERHANG TRANSVERSE

BENT BARS												
MARK	QTY	LENGTH	TYPE	A	B	C	D	E	H	J	K	LOCATION/COMMENTS
ABUTMENT NO. 2												
B1601	14	1160	S10		450	300	450					WINGWALL END
B1602	26	6100	STR.									BREASTWALL HORIZONTAL
B1603	13	1610	S10		450	750	450					WINGWALL END
B1604	18	1660	S10		700	300	700					WINGWALL TOP
B1605	100	2850	STR.									WING & BREASTWALL VERT.
B1606	10	2250	STR.									WINGWALL VERTICAL
B1607	10	1675	STR.									WINGWALL VERTICAL
B1608	10	2310	S10		800	750	800					BREASTWALL TOP
B1609	1	2390	S10		800	830	800					BREASTWALL TOP
B1610	26	1795	14	700	480	635	--	--	320		355	BREASTWALL & BOTTOM OF SLAB STEEL
B1611	25	1250	12	--	475	280	495		350		350	APPROACH SLAB SEAT REINFORCEMENT
B1612	19	1200	STR.									FAR FACE CORNER REINFORCING HORIZ.
B1613	144	1025	S10		150	750	150					BREASTWALL TIES BEND AROUND 65mm PIN
B1614	2	1970	12	--	--	1280	705		270	--	650	WING TOP
B1615	1	1495	12	--	--	1100	400		370	--	150	WING TOP
B1616	1	1720	12	--	--	1100	625		580	--	235	WING TOP
B1617	1	1185	12	--	--	600	600		290	--	530	TOP OF BREASTWALL
B1618	1	1185	12	--	--	600	600		435	--	415	TOP OF BREASTWALL
B1619	1	3020	--	SEE SKETCH								TOP OF BREASTWALL
B1620	49	2450	S10		--	1490	980					BREASTWALL TO TOP OF SLAB
B1621	1	2105	S10		900	345	900					TOP OF WINGWALL
B1622	4	7250	STR.									APPROACH SLAB HORIZONTAL
B1623	5	2600	STR.									BREASTWALL NEAR FACE VERTICAL
B1901	10	2900	STR.									WING TOP HORIZONTAL
B1902	5	5185	12	--	--	3200	2005		960	--	1760	WING HORIZONTAL N.F.
B1903	5	4515	12	--	--	3200	1335		640	--	1170	WING HORIZONTAL F.F.
B2201	14	3450	STR.									WING HORIZONTAL CUT TO FIT AS REQ.
B2202	13	5460	12	--	--	3400	2085		960	--	1850	WING HORIZONTAL N.F.
B2203	14	3250	STR.									TOP OF WING HORIZONTAL
B2204	13	4860	12	--	--	3500	1385		640	--	1230	WING HORIZONTAL F.F.
B2205	1	5485	12	--	--	3400	2110		960	--	1880	WING HORIZONTAL BTM
B2206	1	4385	12	--	--	3500	1410		640	--	1255	WING HORIZONTAL BTM
B2207	30	3200	STR.									WINGWALL HORIZONTAL
APPROACH SLAB REINFORCEMENT												
AS1601	29	6580	STR.									APPROACH SLAB TRANSVERSE BTM
AS1602	29	7140	STR.									APPROACH SLAB TRANSVERSE BTM
AS2901	29	7695	12	375	7210	--	--		--	300	--	APPROACH SLAB LONGITUDINAL BTM
AS2902	29	7660	12	375	7175	--	--		--	300	--	APPROACH SLAB LONGITUDINAL BTM

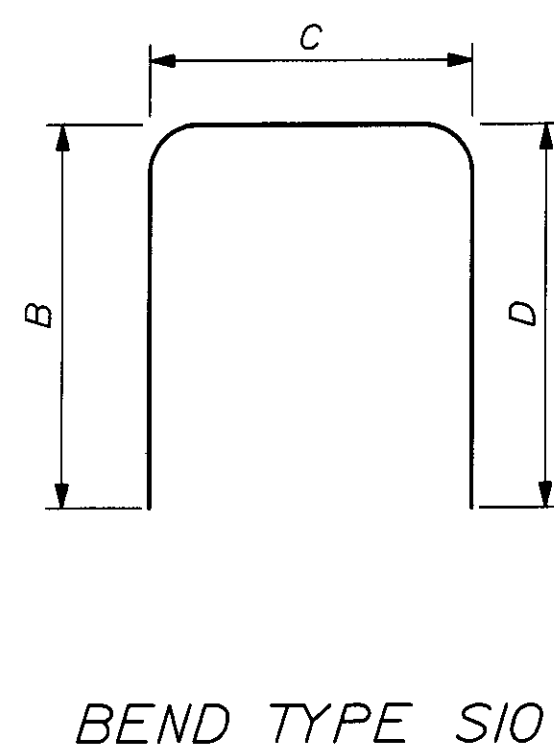
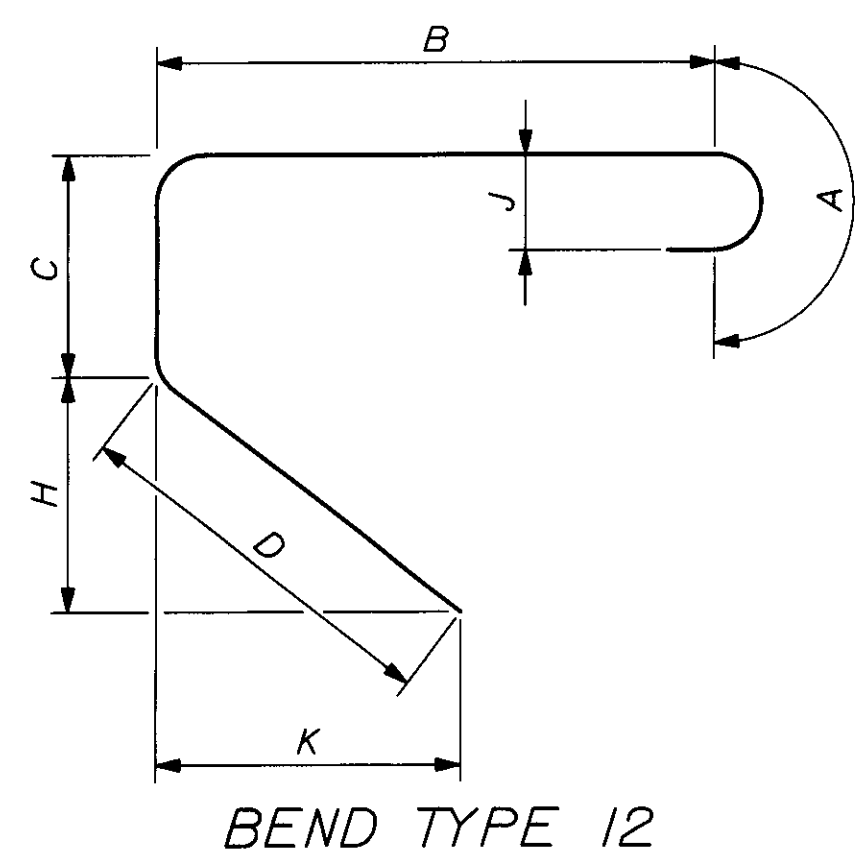

GENERAL NOTES

ALL DIMENSIONS ARE OUT-TO-OUT OF BAR.

BENDING DETAILS AND HOOKS SHALL CONFORM TO THE RECOMMENDATIONS OF THE CURRENT REVISION OF ACI STANDARD 315 AND ACI STANDARD 318.

REINFORCING BAR: ASTM A615M GR. 420 EPOXY COATED

THE FIRST TWO DIGITS FOLLOWING THE LETTER OF THE MARK INDICATE THE SIZE OF THE BAR:

MARK "A1602" = BAR SIZE #16
 MARK "P2505" = BAR SIZE #25
 MARK "S1950" = BAR SIZE #19

CALDERWOOD ENGINEERING, ETC.
 STRUCTURAL ENGINEERING • DETAILING SERVICES
 222 RIVER ROAD, RICHMOND, NE 06877 PH/FX (603) 757-4801
PREPARED FOR AUSTIN CONST., INC
 BURKE - VALUE ENGINEERING
 PROJ. BRZ 1447 (16)

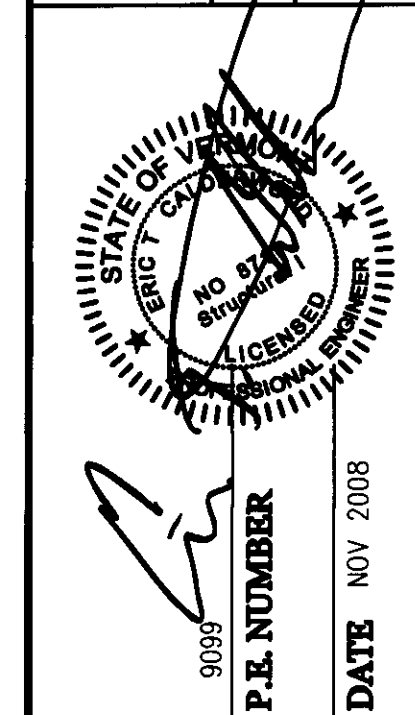

DATE	NOV 08	JAN 09	MAR 09	APR 09
BY	ETC			
DESIGN-DETAILED				
CHECKED-REVIEWED				
REVISIONS 1	ADDRESS NOT COMMENTS			
REVISIONS 2	NO CHANGES THIS SHIT			
REVISIONS 3	NO CHANGES THIS SHIT			
REVISIONS 4				
FIELD CHANGES				

BURKE
 VALUE ENGINEERED DESIGN
 REINFORCING STEEL SCHEDULE

SHEET NUMBER
 R1