

**SNOW FENCE**  
 REV STA 8+339.723 TO REV STA 8+350 LT  
 REV STA 8+355 TO REV STA 8+372 LT  
 STA 8+581 TO STA 8+578 LT  
 STA 8+580 TO STA 8+631 LT

**TREE PROTECTION ZONE**  
 STA 8+561 TO STA 8+579 LT  
 STA 8+590 TO STA 8+631 LT  
 TO INCLUDE:  
 STA 8+572 LT, 750 MAPLE  
 STA 8+593 LT, 750 MAPLE  
 STA 8+598 LT, 750 MAPLE  
 STA 8+608 LT, 2-100 MAPLES  
 STA 8+620 LT, 750 MAPLE  
 SEE NOTES ON SHEET 190 OF 450,  
 TREE PROTECTION DETAIL ON SHEET 192 OF 450,  
 AND SPECIAL PROVISIONS.

**TREE PROTECTION ZONE**  
 REV STA 8+339.723 TO REV STA 8+350 LT  
 REV STA 8+355 TO REV STA 8+372 LT  
 TO INCLUDE: ALL TREES  
 SEE NOTES ON SHEET 190 OF 450,  
 TREE PROTECTION DETAIL ON SHEET 192 OF 450,  
 AND SPECIAL PROVISIONS.

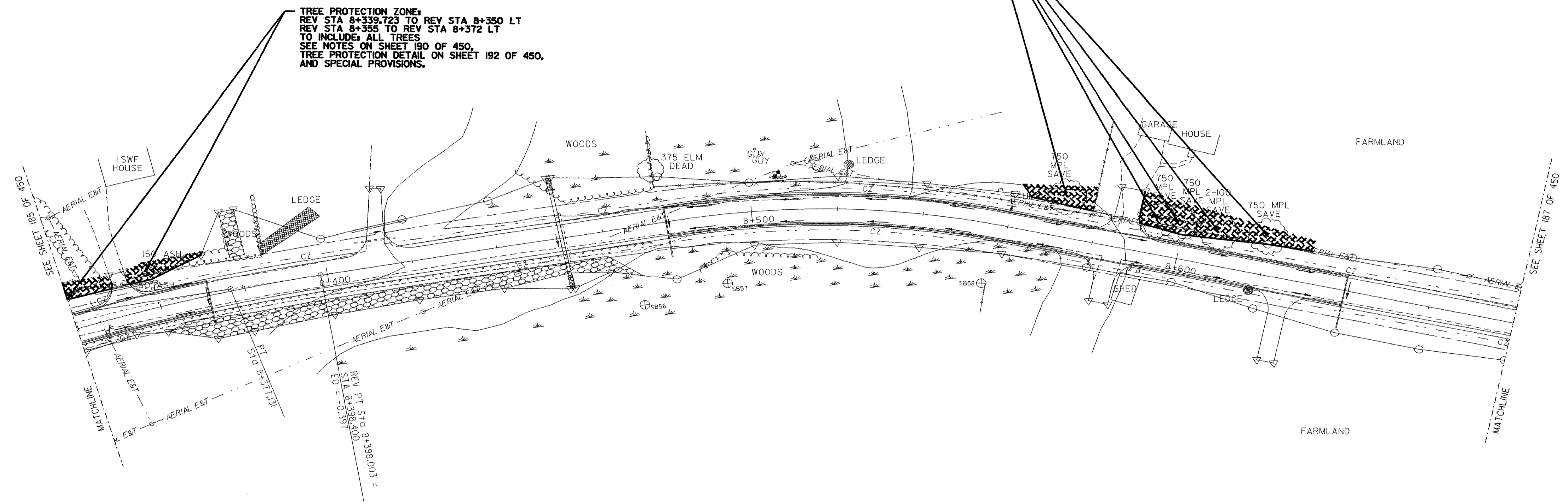

**LEGEND**

- DIRECTION OF DITCH FLOW
- PROPOSED TREE
- EXISTING TREES
- PROPOSED SHRUB
- PROPOSED GROUND COVER
- NEW LOCATION FOR TRANSPLANTED MATERIAL
- EXISTING PLANT MATERIAL TO BE TRANSPLANTED
- TREE PROTECTION ZONE WITH FENCING
- LIMIT OF CUT
- LIMIT OF FILL

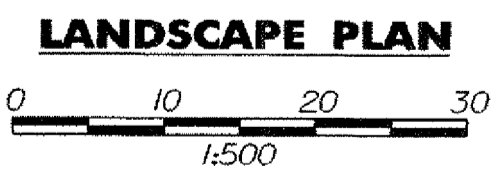

PROJECT NAME:	HIGHGATE - FRANKLIN
PROJECT NUMBER:	STP RS 030(I) SA
FILE NAME: 85c060/design/dc060landbdr.dgn	PLOT DATE: 09-MAY-2005
PROJECT LEADER: DELLASANTA	DRAWN BY: SQUAD B
DESIGNED BY: SQUAD B	CHECKED BY: SQUAD B
IPARM FILE NAME: dc060land23.1	SHEET 186 OF 450