

SNOW FENCE
 STA 23+016 TO 23+040 LT
 STA 6+636 TO STA 6+656 LT
 STA 6+661 TO STA 6+678 LT
 STA 6+626 TO STA 6+656 LT

EXISTING PLANT MATERIAL (SHRUBS (MOD)) TO BE TRANSPLANTED
 ** STA 6+688 TO 6+716 RT (DAYLILIES)
 ** STA 23+021 TO 23+045 RT (DAYLILIES)
PLANT MATERIAL (SHRUBS)
 STA 6+662 TO STA 6+672 RT IIEA AC (SERVICE BERRY)

DECIDUOUS TREES SEE BELOW
 STA 6+600 RT (1 GR)
 STA 6+608 RT (1 GR)
 STA 6+618 RT (1 GR)
 STA 6+641 RT (1 GR)
 STA 6+648 RT (1 FP)
 STA 6+655 RT (1 FP)
 STA 6+664 RT (1 FP)
 STA 6+673 RT (1 FP)
 STA 6+682 RT (1 FP)
 STA 6+690 RT (1 FP)
 STA 6+700 RT (1 FP)
 STA 6+709 RT (1 FP)
 STA 6+718 RT (1 FP)
 STA 23+020 LT (1 GR)

GROUND COVER AND VINES
 STA 6+577 TO STA 6+621 RT
 STA 6+640 TO STA 6+680 RT IIO HH
 STA 6+645 TO STA 6+660 RT 88 HF

TREE PROTECTION ZONE:
 STA 6+636 TO STA 6+656 LT
 STA 6+661 TO STA 6+678 LT
 TO INCLUDE:
 STA 6+647 LT, 600 MAPLE
 STA 6+667 LT, 600 MAPLE
 SEE NOTES ON SHEET 190 OF 450,
 TREE PROTECTION DETAIL ON SHEET 192 OF 450,
 AND SPECIAL PROVISIONS.

STA 6+662 TO STA 6+672 RT
 II SERVICE BERRY SHRUBS

9 FP
 STA 6+676 TO STA 6+720 RT
 8 EA FP (GREEN ASH)

** EXISTING DAYLILIES LOCATED AT:
 STA 6+688 RT TO 6+716 RT
 SHALL BE TRANSPLANTED TO:
 PLANTING AREAS ALONG ROUTE 78
 SEE SHEET 164 OF 450

STA 6+645 TO STA 6+670 RT
 6 EA OV (AMERICAN HOPHORNBEAM)

250 HF
 STA 6+573 TO STA 6+619 RT
 7 EA OV (AMERICAN HOPHORNBEAM)

** EXISTING DAYLILIES LOCATED AT:
 STA 23+021 RT TO 23+045 RT
 SHALL BE TRANSPLANTED TO:
 PLANTING AREAS ALONG ROUTE 78
 SEE SHEET 164 OF 450

TREE PROTECTION ZONE:
 STA 23+018 TO STA 23+040 LT
 TO INCLUDE:
 STA 23+029 LT, ELM
 SEE NOTES ON SHEET 190 OF 450,
 TREE PROTECTION DETAIL ON SHEET 192 OF 450,
 AND SPECIAL PROVISIONS.

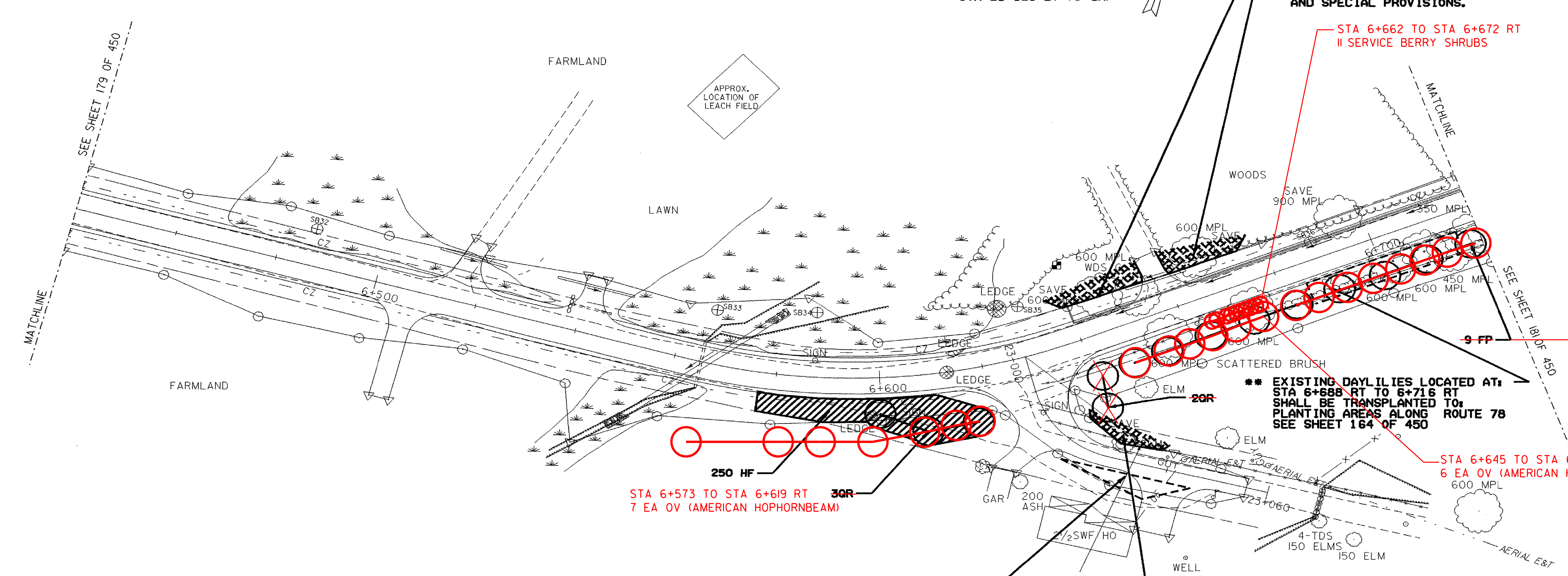

- DECIDUOUS TREES**
- STA 6+573 RT (1OV)
 - STA 6+580 RT (1OV)
 - STA 6+587 RT (1OV)
 - STA 6+595 RT (1OV)
 - STA 6+603 RT (1OV)
 - STA 6+611 RT (1OV)
 - STA 6+619 RT (1OV)
 - STA 6+645 RT (1OV)
 - STA 6+649 RT (1OV)
 - STA 6+653 RT (1OV)
 - STA 6+657 RT (1OV)
 - STA 6+661 RT (1OV)
 - STA 6+670 RT (1OV)
 - STA 6+676 RT (1FP)
 - STA 6+682 RT (1FP)
 - STA 6+687 RT (1FP)
 - STA 6+692 RT (1FP)
 - STA 6+699 RT (1FP)
 - STA 6+706 RT (1FP)
 - STA 6+712 RT (1FP)
 - STA 6+718 RT (1FP)

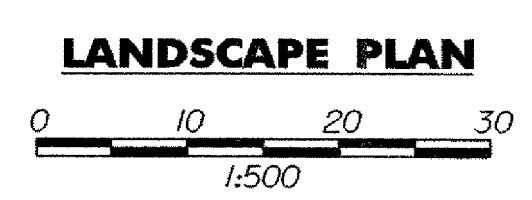

LEGEND

- DIRECTION OF DITCH FLOW
- PROPOSED TREE
- EXISTING TREES
- PROPOSED SHRUB
- PROPOSED GROUND COVER
- NEW LOCATION FOR TRANSPLANTED MATERIAL
- EXISTING PLANT MATERIAL TO BE TRANSPLANTED
- TREE PROTECTION ZONE WITH FENCING
- LIMIT OF CUT
- LIMIT OF FILL

PROJECT NAME:	HIGHGATE - FRANKLIN
PROJECT NUMBER:	STP RS 0301(I) SA
FILE NAME:	85c060/design/dc060landbdr.dgn
PROJECT LEADER:	DELLASANTA
DESIGNED BY:	SQUAD B
IPARM FILE NAME:	dc060land17.I
PLOT DATE:	09-MAY-2005
DRAWN BY:	SQUAD B
CHECKED BY:	SQUAD B
SHEET	180 OF 450