

EXISTING PLANT MATERIAL (SHRUBS(MOD)) TO BE TRANSPLANTED
 STA 5+527 TO 5+570 LT (DAYLILIES)

SNOW FENCE
 STA 5+574 TO STA 5+596 LT
 STA 21+035 LT TO STA 5+543 RT
 STA 5+578 RT TO STA 5+596 RT

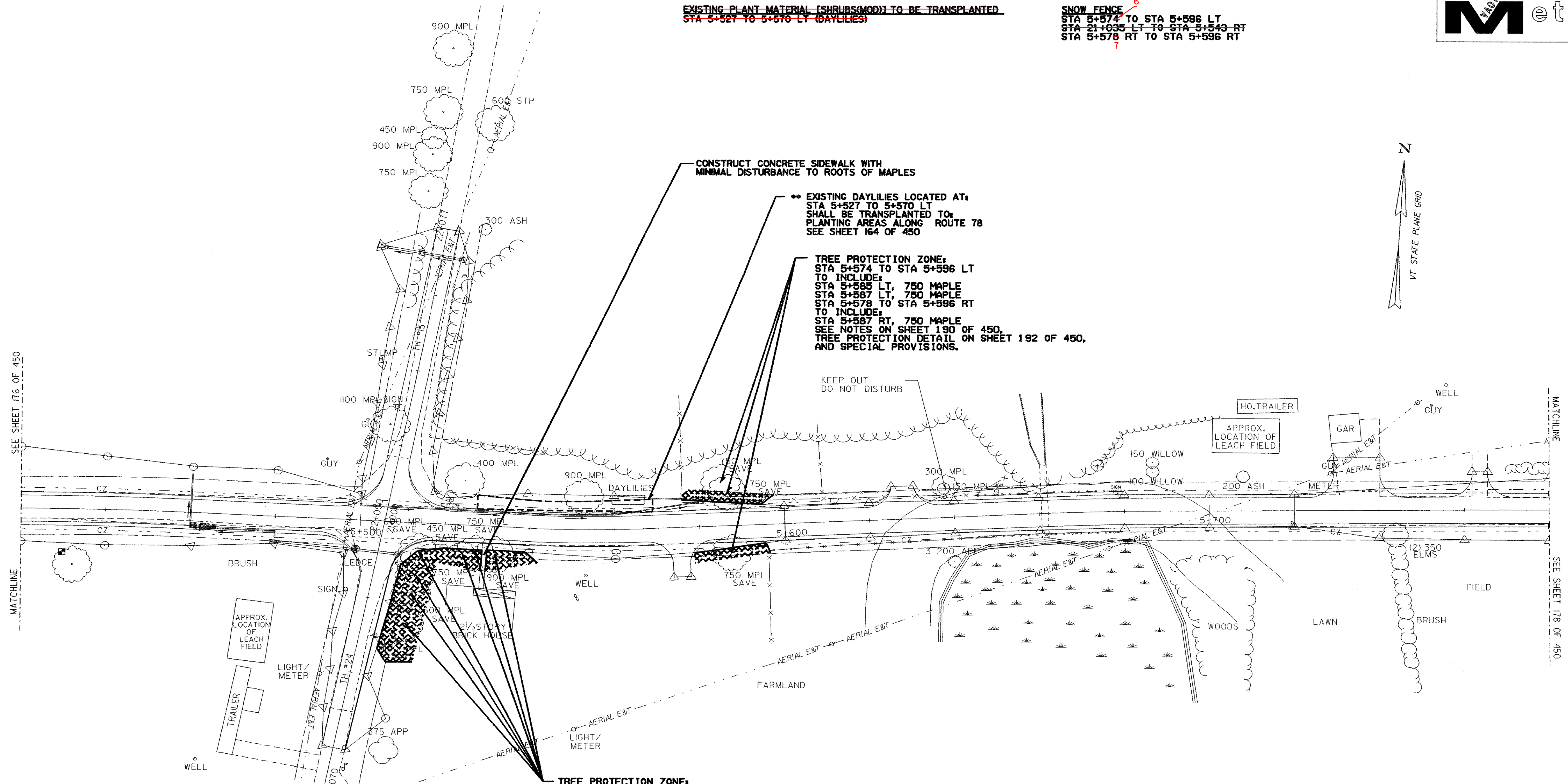
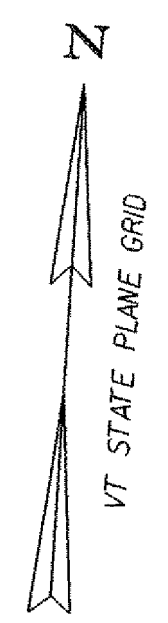

**** EXISTING DAYLILIES LOCATED AT:**
 STA 5+527 TO 5+570 LT
 SHALL BE TRANSPLANTED TO
 PLANTING AREAS ALONG ROUTE 78
 SEE SHEET 164 OF 450

TREE PROTECTION ZONE:
 STA 5+574 TO STA 5+596 LT
 TO INCLUDE:
 STA 5+585 LT, 750 MAPLE
 STA 5+587 LT, 750 MAPLE
 STA 5+578 TO STA 5+596 RT
 TO INCLUDE:
 STA 5+587 RT, 750 MAPLE
 SEE NOTES ON SHEET 190 OF 450.
 TREE PROTECTION DETAIL ON SHEET 192 OF 450,
 AND SPECIAL PROVISIONS.

TREE PROTECTION ZONE:
 STA 21+035 LT TO STA 5+543 RT
 TO INCLUDE:
 STA 21+006 LT, 600 MAPLE
 STA 21+012 LT, 750 MAPLE
 STA 21+017 LT, 600 MAPLE
 STA 21+025 LT, 1100 MAPLE
 STA 5+524 RT, 450 MAPLE
 STA 5+527 RT, 750 MAPLE
 STA 5+532 RT, 900 MAPLE
 SEE NOTES ON SHEET 190 OF 450.
 TREE PROTECTION DETAIL ON SHEET 192 OF 450,
 AND SPECIAL PROVISIONS.

LEGEND

- DIRECTION OF DITCH FLOW
- PROPOSED TREE - AERIAL E&T
- EXISTING TREES
- PROPOSED SHRUB
- PROPOSED GROUND COVER
- NEW LOCATION FOR TRANSPLANTED MATERIAL
- EXISTING PLANT MATERIAL TO BE TRANSPLANTED
- TREE PROTECTION ZONE WITH FENCING
- LIMIT OF CUT
- LIMIT OF FILL

LANDSCAPE PLAN

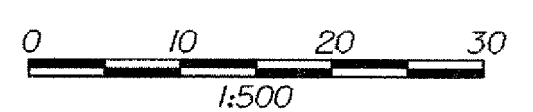

PROJECT NAME:	HIGHGATE - FRANKLIN
PROJECT NUMBER:	STP RS 030(I) SA
FILE NAME:	85c060/design/dc060landbdr.dgn
DATE:	09-MAY-2005
PROJECT LEADER:	DELLASANTA
DRAWN BY:	SQUAD B
DESIGNED BY:	SQUAD B
CHECKED BY:	SQUAD B
IPARM FILE NAME:	dc060land4.i
SHEET	177 OF 450