

**SILT FENCE**  
 STA 6+834.6 TO STA 6+839.9 RT  
 STA 7+020.0 TO STA 7+080.0 RT

**PROJECT DEMARCATION FENCE**  
 STA 6+856.8 TO STA 7+027.9 LT  
 STA 7+031.9 TO STA 7+048.6 LT  
 STA 7+060.9 TO STA 7+080.0 LT  
 STA 6+720.0 TO STA 6+782.5 RT  
 STA 6+834.5 TO STA 7+080.0 RT

**ROCK CHECK DAM**  
 STA 6+721 LT  
 STA 6+732 LT  
 STA 6+743 LT  
 STA 6+754 LT  
 STA 6+760 LT  
 STA 6+786 LT  
 STA 6+794 LT  
 STA 6+802 LT  
 STA 6+813 LT  
 STA 6+825 LT  
 STA 6+836 LT  
 STA 6+847 LT  
 STA 6+858 LT  
 STA 6+871 LT  
 STA 6+884 LT  
 STA 6+900 LT  
 STA 6+923 LT  
 STA 6+946 LT  
 STA 7+012 LT

**EROSION MATTING**  
 STA 7+057.000 TO STA 7+070.000 LT

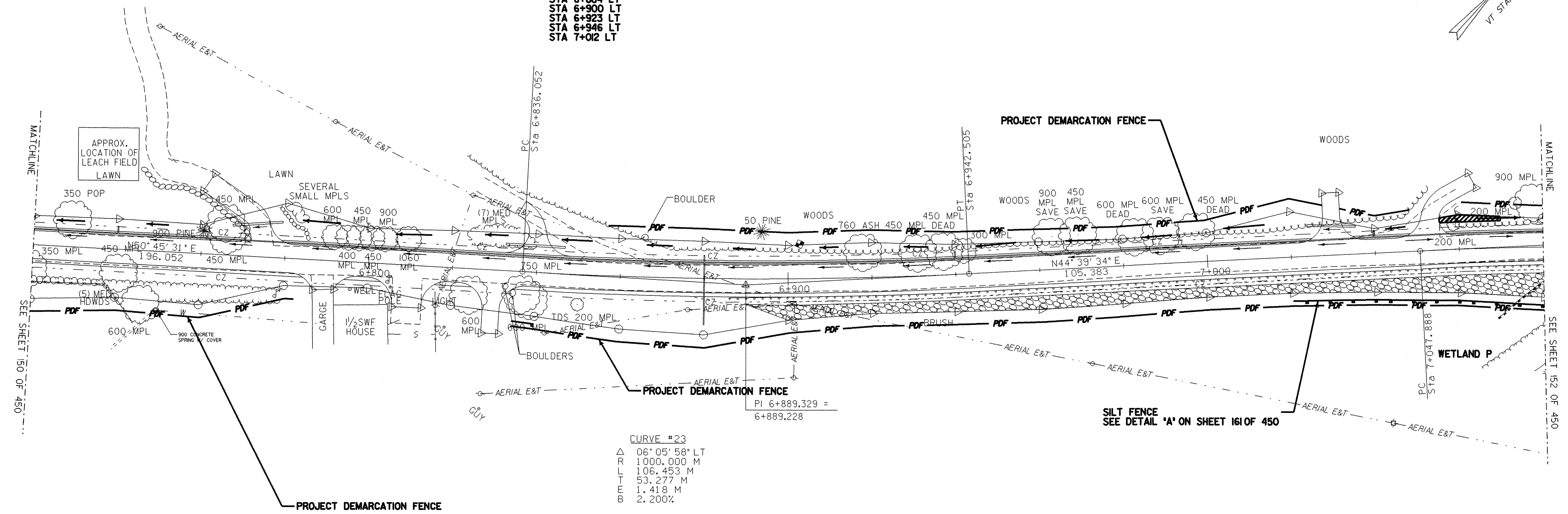

**CURVE #23**  
 Δ 06° 05' 58" LT  
 R L 1000.000 M  
 L 106.453 M  
 T 53.277 M  
 E 1.418 M  
 B 2.200%

**EROSION CONTROL PLAN**



- LEGEND**
- SILT FENCE
  - SNOW FENCE
  - DIRECTION OF DITCH FLOW
  - PROJECT DEMARCATION FENCE
  - WETLAND BUFFER
  - STABILIZED CONSTRUCTION ENTRANCE
  - EROSION MATTING

- NOTES:**
1. CONSTRUCTION SHALL TAKE PLACE BETWEEN MAY 1 AND OCTOBER 15. CONSTRUCTION IN A WATERCOURSE CHANNEL SHALL TAKE PLACE BETWEEN JUNE 1 AND OCTOBER 1. THE CONTRACTOR SHALL SUBMIT ANY CHANGES TO THIS SCHEDULE TO THE RESIDENT ENGINEER FOR APPROVAL AT OR BEFORE THE PRE-CONSTRUCTION MEETING.
  2. THE LIMIT OF DISTURBANCE FOR THIS PROJECT SHALL BE THE LIMIT OF RIGHT-OF-WAY AS SHOWN ON THE EASEMENTS RIGHT-OF-WAY PLANS, UNLESS OTHERWISE SPECIFIED IN THE PLANS. CONSTRUCTION FENCE SHALL BE USED TO DELINEATE THE LIMIT OF DISTURBANCE IN AND AROUND WATERCOURSES AND WETLANDS. THE CONTRACTOR SHALL NOT IMPACT AREAS OUTSIDE THE LIMIT OF DISTURBANCE.

3. SEE THE EROSION CONTROL DETAIL SHEET FOR SEEDING FORMULAS AND ROCK CHECK DAM DETAIL.
4. CONTRACTOR TO STABILIZE ANY TEMPORARY CHANNELS AND DITCHES WITH STONE.
5. SILT FENCE LOCATIONS ARE APPROXIMATE ONLY. SILT FENCE TO BE INSTALLED ALONG THE CONTOURS.
6. MULCH SHALL BE APPLIED TO EXPOSED SOIL AT THE END OF EACH WORK DAY. SEED AND MULCH SHALL BE APPLIED TO SOIL WITHIN 48 HOURS OF FINAL DISTURBANCE. SEED AND MULCH SHALL ALSO BE APPLIED TO ANY TOPSOIL STOCKPILES. SEE APPLICATION RATES ON SHEET 3 OF 450.

	PROJECT NAME: HIGHGATE - FRANKLIN
	PROJECT NUMBER: STP RS 0301(I)SA
	FILE NAME: ...85c060/design/dc060ero.dgn PLOT DATE: 09-MAY-2005
PROJECT LEADER: DELLASANTA	DRAWN BY: SQUAD B
DESIGNED BY: SQUAD B	CHECKED BY: SQUAD B
IPARM FILE NAME: dc060er18.1	SHEET 151 OF 450