

**SILT FENCE**  
 STA 4+471.7 TO STA 4+480.0 RT  
 STA 4+471.7 TO STA 4+480.0 RT

**EROSION MATTING**  
 STA 4+230.000 TO STA 4+288.000 RT  
 STA 4+350.000 TO STA 4+410.000 RT

**ROCK CHECK DAM**  
 STA 4+232 RT  
 STA 4+242 RT  
 STA 4+259 RT  
 STA 4+302 LT  
 STA 4+318 LT  
 STA 4+334 LT  
 STA 4+338 RT  
 STA 4+350 LT  
 STA 4+366 LT  
 STA 4+372 RT  
 STA 4+380 LT  
 STA 4+383 RT  
 STA 4+396 RT  
 STA 4+398 LT  
 STA 4+404 RT  
 STA 4+411 LT  
 STA 4+411 RT  
 STA 4+425 LT  
 STA 4+439 LT  
 STA 4+440 RT  
 STA 4+449 RT  
 STA 4+459 LT  
 STA 4+466 LT  
 STA 4+472 LT  
 STA 4+479 LT

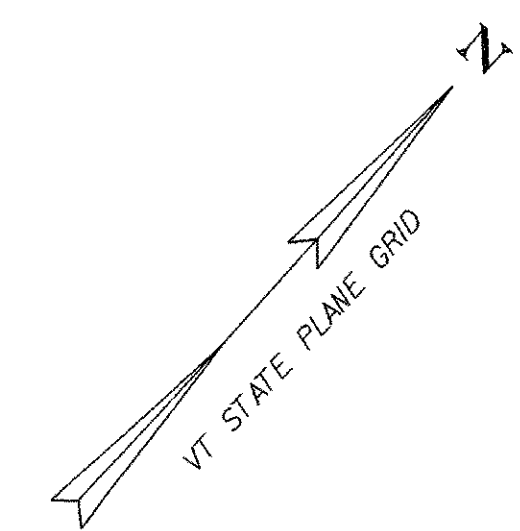

**CURVE #14**  
 Δ 05° 17' 41" RT  
 R 1000.00 M  
 L 92.412 M  
 T 46.239 M  
 E 1.068 M  
 B 2.200%

PI 4+445.411 =  
 4+445.344

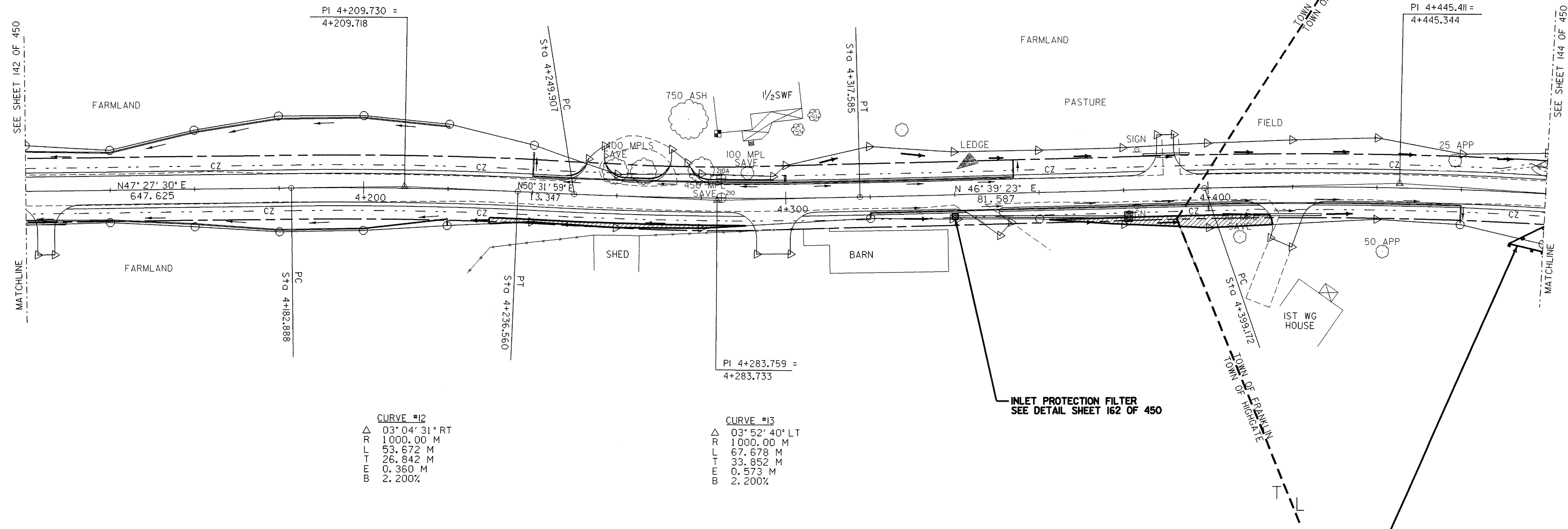

**CURVE #12**  
 Δ 03° 04' 31" RT  
 R 1000.00 M  
 L 53.672 M  
 T 26.842 M  
 E 0.360 M  
 B 2.200%

**CURVE #13**  
 Δ 03° 52' 40" LT  
 R 1000.00 M  
 L 67.678 M  
 T 33.852 M  
 E 0.573 M  
 B 2.200%

**EROSION CONTROL PLAN**



- LEGEND**
- SILT FENCE
  - SNOW FENCE
  - DIRECTION OF DITCH FLOW
  - PROJECT DEMARCATION FENCE
  - WETLAND BUFFER
  - STABILIZED CONSTRUCTION ENTRANCE
  - EROSION MATTING

**NOTES:**

1. CONSTRUCTION SHALL TAKE PLACE BETWEEN MAY 1 AND OCTOBER 15. CONSTRUCTION IN A WATERCOURSE CHANNEL SHALL TAKE PLACE BETWEEN JUNE 1 AND OCTOBER 1. THE CONTRACTOR SHALL SUBMIT ANY CHANGES TO THIS SCHEDULE TO THE RESIDENT ENGINEER FOR APPROVAL AT OR BEFORE THE PRE-CONSTRUCTION MEETING.
2. THE LIMIT OF DISTURBANCE FOR THIS PROJECT SHALL BE THE LIMIT OF RIGHT-OF-WAY AS SHOWN ON THE EASEMENTS RIGHT-OF-WAY PLANS. UNLESS OTHERWISE SPECIFIED IN THE PLANS, CONSTRUCTION FENCE SHALL BE USED TO DELINEATE THE LIMIT OF DISTURBANCE IN AND AROUND WATERCOURSES AND WETLANDS. THE CONTRACTOR SHALL NOT IMPACT AREAS OUTSIDE THE LIMIT OF DISTURBANCE.
3. SEE THE EROSION CONTROL DETAIL SHEET FOR SEEDING FORMULAS AND ROCK CHECK DAM DETAIL.
4. CONTRACTOR TO STABILIZE ANY TEMPORARY CHANNELS AND DITCHES WITH STONE.
5. SILT FENCE LOCATIONS ARE APPROXIMATE ONLY. SILT FENCE TO BE INSTALLED ALONG THE CONTOURS.
6. MULCH SHALL BE APPLIED TO EXPOSED SOIL AT THE END OF EACH WORK DAY. SEED AND MULCH SHALL BE APPLIED TO SOIL WITHIN 48 HOURS OF FINAL DISTURBANCE. SEED AND MULCH SHALL ALSO BE APPLIED TO ANY TOPSOIL STOCKPILES. SEE APPLICATION RATES ON SHEET 3 OF 450.



PROJECT NAME: HIGHGATE - FRANKLIN  
 PROJECT NUMBER: STP RS 030(I) SA  
 FILE NAME: ...85c060/design/dc060ero.dgn PLOT DATE: 09-MAY-2005  
 PROJECT LEADER: DELLASANTA DRAWN BY: SQUAD B  
 DESIGNED BY: SQUAD B CHECKED BY: SQUAD B  
 IPARM FILE NAME: dc060er10.i SHEET 143 OF 450