



CONSTRUCT DRIVE
 STA 8+764.000 RT GRAVEL
 STA 8+860.000 LT GRAVEL
 STA 8+814.000 RT GRAVEL

STONE FILL, TYPE II
 8+760.000 STA 8+885.143 TO STA 9+020.000 LT
 STA 8+885.559 TO STA 9+020.000 RT
 8+900.000

EROSION MATTING (JUTE)
 STA 8+885.143 TO STA 9+020.000 LT
 STA 8+885.559 TO STA 9+020.000 RT

GEOTEXTILE UNDER STONE FILL
 STA 8+865.862 TO STA 9+020.000 LT
 8+760.000

STEEL BEAM GUARDRAIL SEE BELOW
 STA 8+688.330 TO STA 8+761.548 RT
 STA 8+706.335 TO STA 8+790.420 LT
 STA 8+903.848 TO STA 9+020.000 RT
 STA 8+900.047 TO STA 9+020.000 LT

GRUBBING MATERIAL
 8+760.000 STA 8+885.143 TO STA 9+020.000 LT
 STA 8+885.559 TO STA 9+020.000 RT
 8+900.000

REMOVING AND RESETTING FENCE
 STA 9+018.810 LT 3M BACK
 STA 9+018.810 TO STA 9+020.000 LT

MANUFACTURED TERMINAL SECTION (TANGENTIAL) SEE BELOW
 STA 8+884.807 TO STA 8+900.047 LT
 STA 8+886.607 TO STA 8+903.048 RT

ANCHOR FOR STEEL BEAM RAIL
 STA 8+688.330 RT STA 8+691.800 RT
 STA 8+706.335 LT STA 8+708.800 LT
 STA 8+761.548 RT STA 8+753.200 RT
 STA 8+790.420 LT STA 8+786.200 LT

CONSTRUCT SPECIAL DITCH
 STA 8+690.000 TO STA 8+750.000 RT
 STA 8+710.000 TO STA 8+764.000 LT
 STA 8+767.000 TO STA 8+790.000 RT

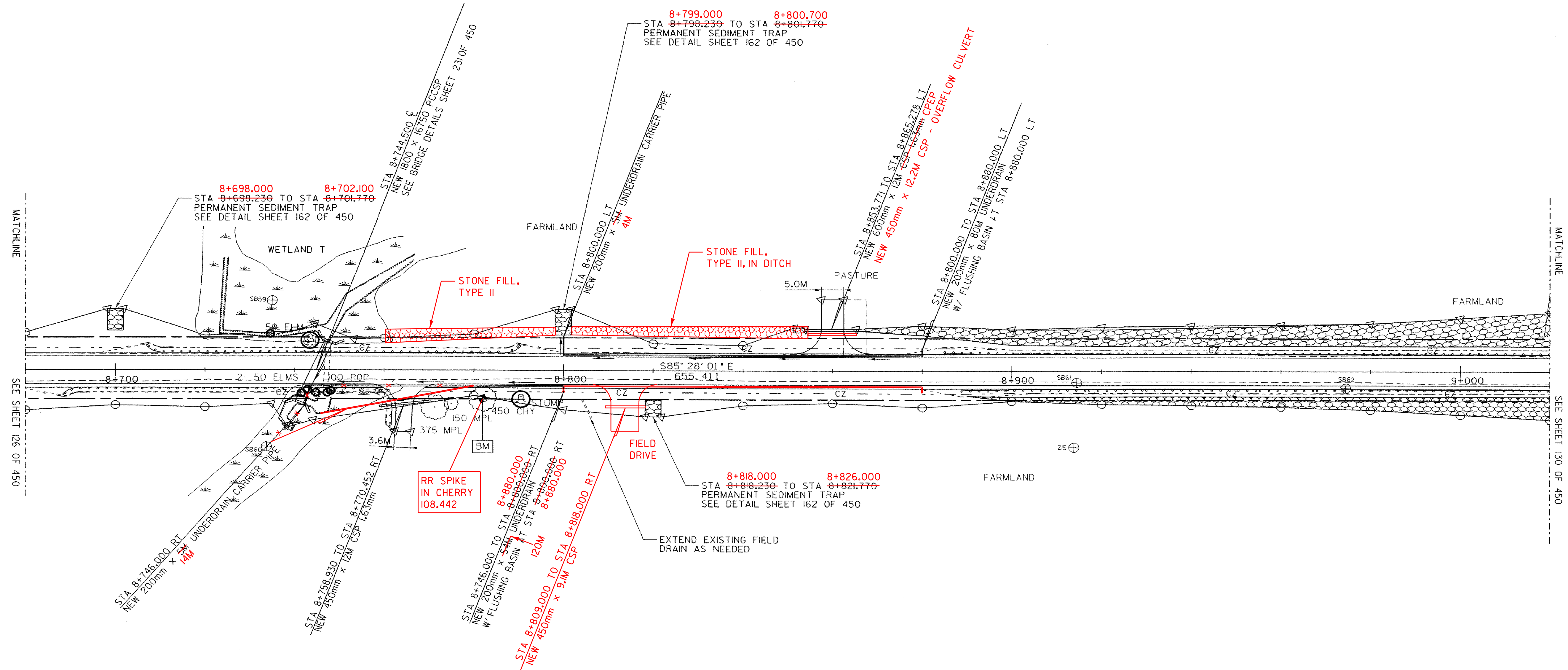

MANUFACTURED TERMINAL SECTION (TANGENTIAL)
 STA 8+884.800 TO STA 8+900.000 LT
 STA 8+887.800 TO STA 8+903.000 RT

STEEL BEAM GUARDRAIL
 STA 8+688.000 TO STA 8+757.000 RT
 STA 8+705.000 TO STA 8+790.420 LT
 STA 8+900.000 TO STA 9+020.000 RT
 STA 8+903.000 TO STA 9+020.000 LT

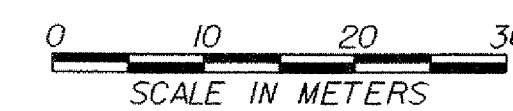

○ DENOTES TREE OR STUMP REMOVAL

- NOTES:
1. ALL SIDE ROAD RADII SHALL BE 11M UNLESS OTHERWISE NOTED. REFER TO STD B-12M
 2. ALL DRIVE RADII SHALL BE 6M UNLESS OTHERWISE NOTED. REFER TO STD B-7M

PROJECT NAME:	HIGHGATE - FRANKLIN
PROJECT NUMBER:	STP RS 030(I) SA
FILE NAME:	...85c060/design/dc060bdr.dgn
PLOT DATE:	09-MAY-2005
PROJECT LEADER:	DELLASANTA
DRAWN BY:	SQUAD B
DESIGNED BY:	SQUAD B
CHECKED BY:	SQUAD B
IPARM FILE NAME:	dc060i24.i
SHEET	128 OF 450