

CONSTRUCT DRIVE
 STA 6+150.000 RT GRAVEL
 STA 6+386.000 LT GRAVEL
 STA 6+386.000 RT GRAVEL
 STA 6+150.000 LT GRAVEL

STEEL BEAM GUARDRAIL
 STA 6+151.067 TO STA 6+230.803 LT
 STA 6+151.957 TO STA 6+229.209 RT
 STA 6+150.500 TO STA 6+219.000 LT
 STA 6+155.400 TO STA 6+208.700 RT

ANCHOR FOR STEEL BEAM RAIL
 STA 6+151.067 LT
 STA 6+151.957 RT
 STA 6+229.209 RT
 STA 6+230.803 LT
 STA 6+154.300 LT
 STA 6+159.200 RT
 STA 6+204.900 RT
 STA 6+215.200 LT

CONSTRUCT SPECIAL DITCH
 STA 6+161.770 TO STA 6+280.000 LT
 STA 6+160.000 TO STA 6+270.000 RT
 STA 6+370.000 TO STA 6+380.000 RT
 STA 6+430.000 TO STA 6+440.000 LT
 STA 6+430.000 TO STA 6+440.000 RT

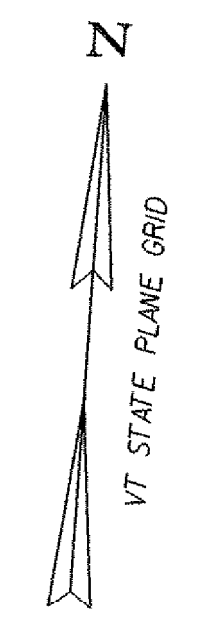
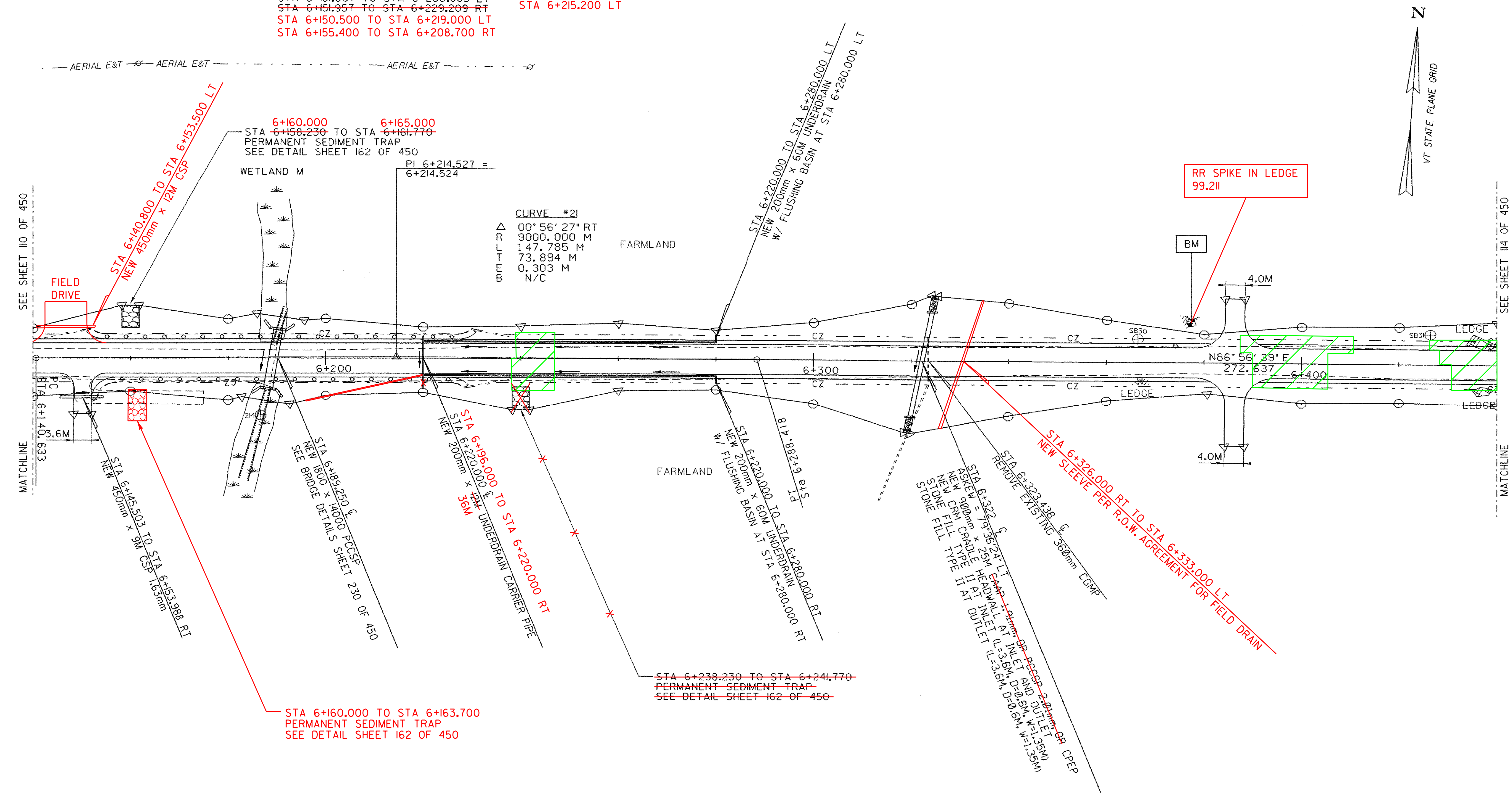

SEE SHEET 110 OF 450
 MATCHLINE

SEE SHEET 114 OF 450
 MATCHLINE



○ DENOTES TREE OR STUMP REMOVAL

- NOTES:
1. ALL SIDE ROAD RADII SHALL BE 11M UNLESS OTHERWISE NOTED. REFER TO STD B-12M
 2. ALL DRIVE RADII SHALL BE 6M UNLESS OTHERWISE NOTED. REFER TO STD B-71M

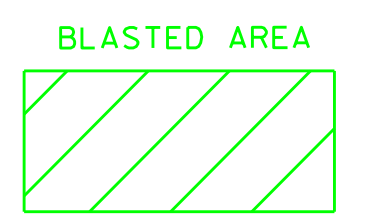

PROJECT NAME: HIGHGATE - FRANKLIN	
PROJECT NUMBER: STP RS 0301(I) SA	
FILE NAME: ...85c060/desIgn/dc060bdr.dgn	PLOT DATE: 09-MAY-2005
PROJECT LEADER: DELLASANTA	DRAWN BY: SQUAD B
DESIGNED BY: SQUAD B	CHECKED BY: SQUAD B
IPARM FILE NAME: dc060116.i	SHEET 112 OF 450