

CONSTRUCT DRIVE
 STA 5+264.000 RT GRAVEL
 STA 5+372.000 RT GRAVEL
 STA 5+300.000 LT GRAVEL

STONE FILL, TYPE II
 STA 5+269.500 TO STA 5+365.500 RT
 STA 5+377.700 TO STA 5+420.000 RT

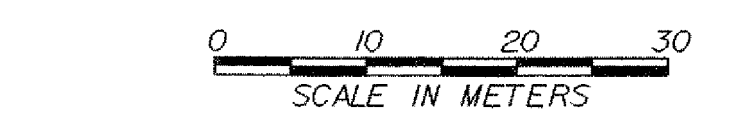
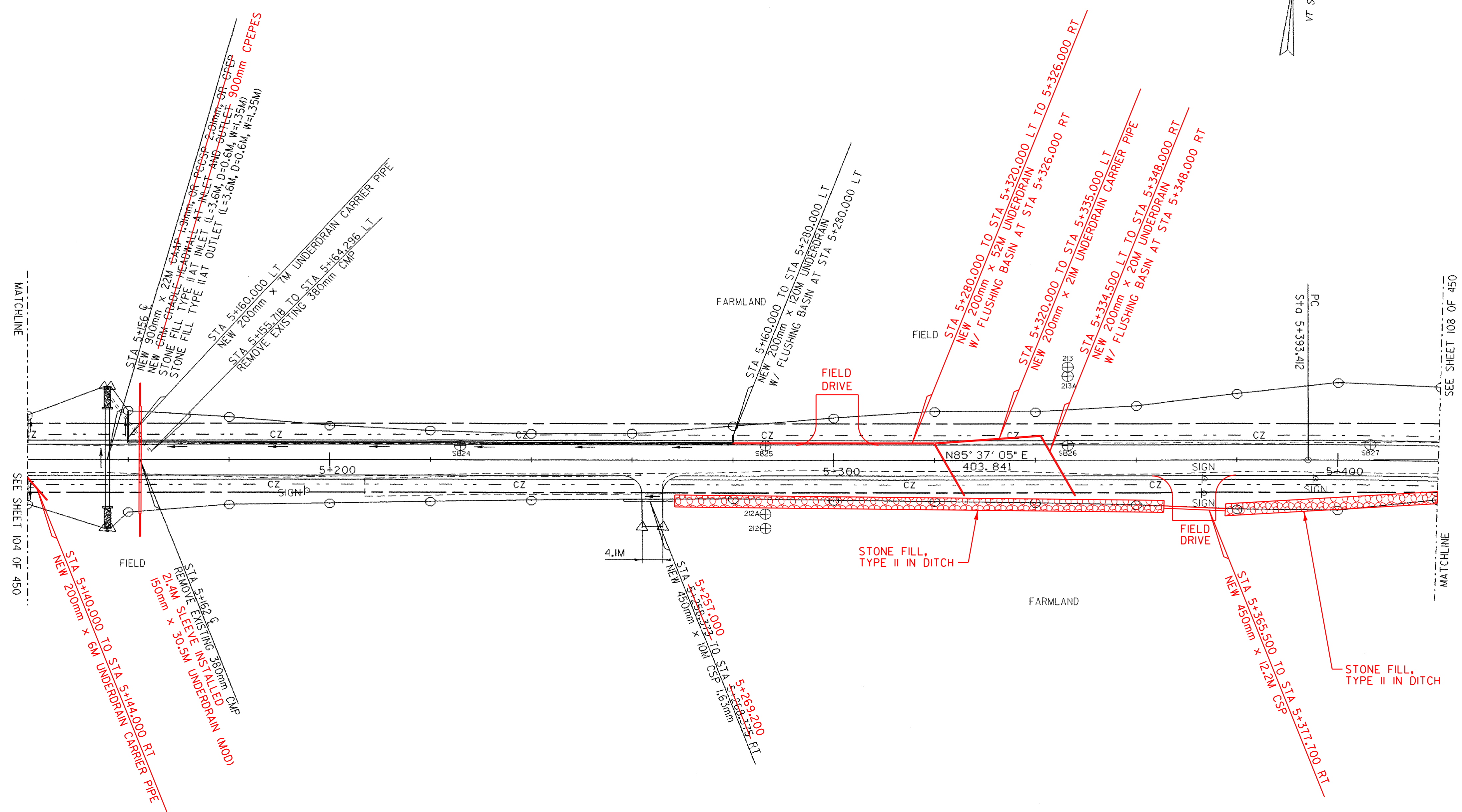
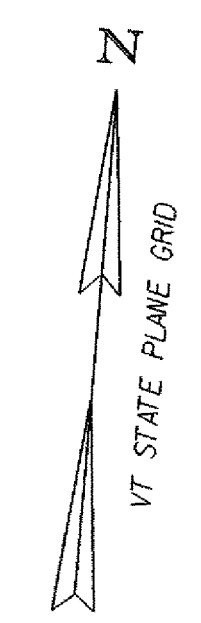

○ DENOTES TREE OR STUMP REMOVAL

- NOTES:
1. ALL SIDE ROAD RADII SHALL BE 1M UNLESS OTHERWISE NOTED. REFER TO STD B-12M
 2. ALL DRIVE RADII SHALL BE 6M UNLESS OTHERWISE NOTED. REFER TO STD B-7M

PROJECT NAME:	HIGHGATE - FRANKLIN
PROJECT NUMBER:	STP RS 030(I) SA
FILE NAME:	...85c060/design/dc060bdr.dgn
PROJECT LEADER:	DELLASANTA
DESIGNED BY:	SQUAD B
IPARM FILE NAME:	dc060i13.1
PLOT DATE:	09-MAY-2005
DRAWN BY:	SQUAD B
CHECKED BY:	SQUAD B
SHEET	106 OF 450