

CONSTRUCT DRIVE
 STA 2+340.000 RT GRAVEL
 STA 2+378.000 LT GRAVEL

MANUFACTURED TERMINAL SECTION (TANGENTIAL)
 STA 2+170.587 TO STA 2+193.827 LT
 STA 2+228.119 TO STA 2+243.358 LT
 STA 2+193.881 TO STA 2+209.121 RT
 STA 2+220.551 TO STA 2+235.791 RT
 STA 2+243.800 TO STA 2+259.000 LT
 STA 2+185.500 TO STA 2+200.700 RT

ANCHOR FOR STEEL BEAM GUARDRAIL
 STA 2+160.000 LT
 STA 2+231.700 RT

STONE FILL, TYPE II
 STA 2+170.000 TO STA 2+245.000 LT
 STA 2+193.903 TO STA 2+235.810 RT
 STA 2+080.000 TO STA 2+180.000 RT
RELOCATE MAIL BOX, SINGLE SUPPORT
 STA 2+379.470 LT

GRUBBING MATERIAL
 STA 2+170.000 TO STA 2+245.000 LT
 STA 2+193.903 TO STA 2+235.810 RT
 STA 2+200.000 TO STA 2+227.000

EROSION MATTING (JUTE)
 STA 2+170.000 TO STA 2+245.000 LT
 STA 2+193.903 TO STA 2+235.810 RT
 STA 2+055.000 TO STA 2+120.000 LT
 STA 2+240.000 TO STA 2+300.000 RT
 STA 2+380.000 RT
 STA 2+168.000 TO STA 2+240.000 LT
 STA 2+200.000 TO STA 2+227.000 RT

STEEL BEAM GUARDRAIL
 STA 2+193.827 TO STA 2+228.119 LT
 STA 2+209.121 TO STA 2+220.551 RT
 STA 2+200.700 TO STA 2+235.500

SNOW FENCE
 STA 2+060.000 TO STA 2+120.000 RT

REMOVING AND RESETTING FENCE
 STA 2+222.000 LT 2.5M BACK

CONSTRUCT SPECIAL DITCH
 STA 2+070.000 TO STA 2+150.000 RT
 STA 2+280.000 TO STA 2+375.000 LT
 STA 2+280.750 TO STA 2+380.000 RT

CURVE #5
 Δ 12° 27' 37" RT
 R 402.000 M
 L 87.425 M
 T 43.686 M
 B 2.388 M
 E 4.700%

PI 2+127.704 =
 2+127.357

NAIL IN HEADWALL
 US ELEV 100.105

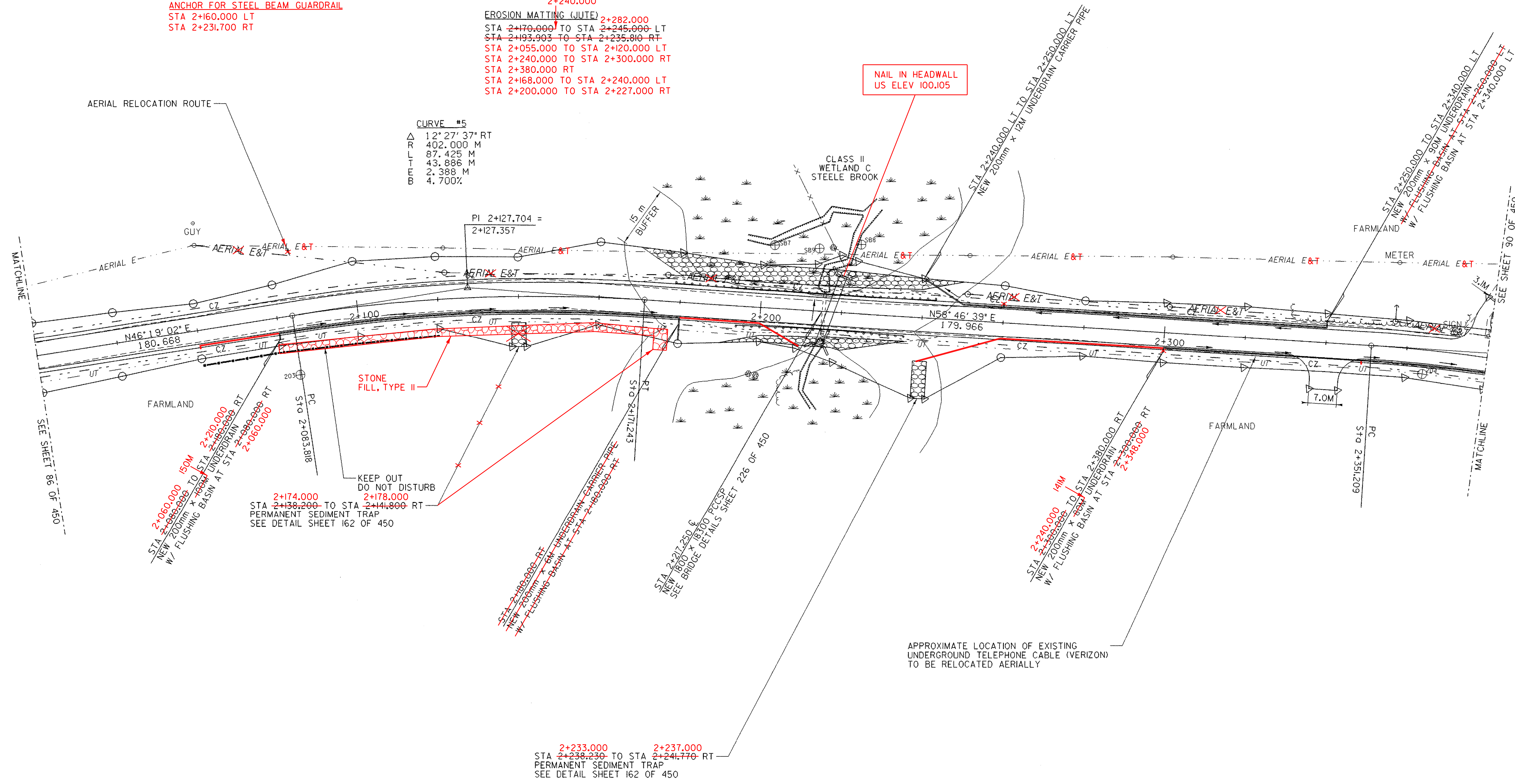

KEEP OUT DO NOT DISTURB
 STA 2+138.200 TO STA 2+144.800 RT
 PERMANENT SEDIMENT TRAP
 SEE DETAIL SHEET 162 OF 450

APPROXIMATE LOCATION OF EXISTING UNDERGROUND TELEPHONE CABLE (VERIZON) TO BE RELOCATED AERIALY

PERMANENT SEDIMENT TRAP
 STA 2+238.230 TO STA 2+241.170 RT
 SEE DETAIL SHEET 162 OF 450



○ DENOTES TREE OR STUMP REMOVAL

- NOTES:**
- ALL SIDE ROAD RADII SHALL BE 11M UNLESS OTHERWISE NOTED. REFER TO STD B-12M
 - ALL DRIVE RADII SHALL BE 6M UNLESS OTHERWISE NOTED. REFER TO STD B-71M

PROJECT NAME:	HIGHGATE - FRANKLIN
PROJECT NUMBER:	STP RS 030(I) SA
FILE NAME: ...85c060/design/dc060bdr.dgn	PLOT DATE: 09-MAY-2005
PROJECT LEADER: DELLASANTA	DRAWN BY: SQUAD B
DESIGNED BY: SQUAD B	CHECKED BY: SQUAD B
IPARM FILE NAME: dc060104.1	SHEET 88 OF 450