

STATE OF VERMONT
 AGENCY OF TRANSPORTATION

Date OCT 28 1985

Richard E Hastings
 Contractor

Richard E Hastings
 Signature

Owner
 Title



CONTRACT PLANS

THESE PLANS DO NOT REFLECT
 CHANGES MADE ON THE PROJECT.

Joe C. Campbell
 Transportation Secretary's Signature

CITY OF: ST. ALBANS
 COUNTY OF: FRANKLIN
 ROUTE NO: ALLEN STREET
 ROUTE CLASS: F.A.U.

PROJECT PROCESSED UNDER
 SECONDARY ROAD PLAN

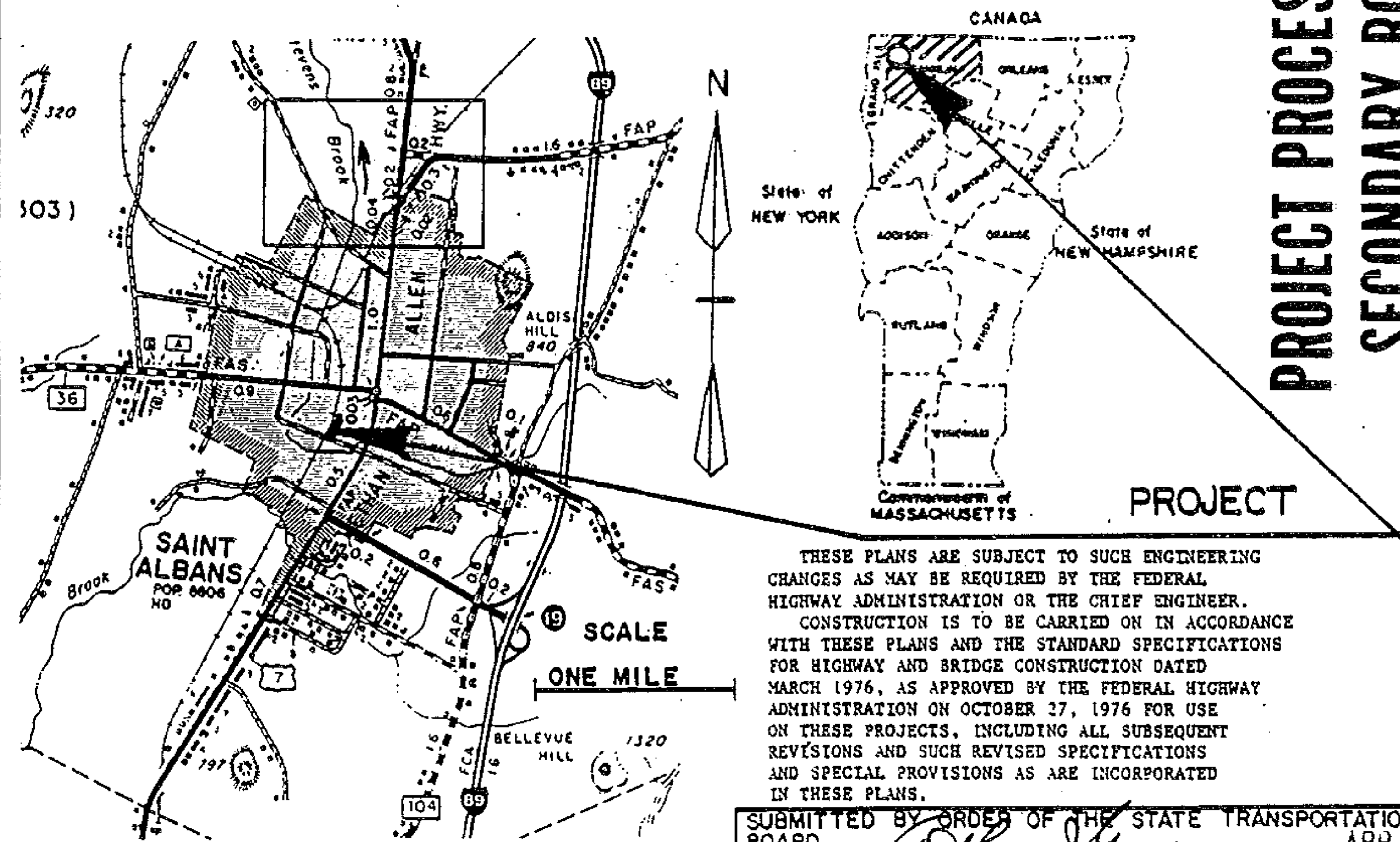

INDEX OF SHEETS
 (SEE SHEET 2 OF 24 SHEETS)

THESE PLANS ARE SUBJECT TO SUCH ENGINEERING
 CHANGES AS MAY BE REQUIRED BY THE FEDERAL
 HIGHWAY ADMINISTRATION OR THE CHIEF ENGINEER.
 CONSTRUCTION IS TO BE CARRIED ON IN ACCORDANCE
 WITH THESE PLANS AND THE STANDARD SPECIFICATIONS
 FOR HIGHWAY AND BRIDGE CONSTRUCTION DATED
 MARCH 1976, AS APPROVED BY THE FEDERAL HIGHWAY
 ADMINISTRATION ON OCTOBER 27, 1976 FOR USE
 ON THESE PROJECTS, INCLUDING ALL SUBSEQUENT
 REVISIONS AND SUCH REVISED SPECIFICATIONS
 AND SPECIAL PROVISIONS AS ARE INCORPORATED
 IN THESE PLANS.

SUBMITTED BY ORDER OF THE STATE TRANSPORTATION
 BOARD
 APPROVED Richard E Hastings DATE APR 24 1985
 DIRECTOR OF ENGINEERING AND CONSTRUCTION
 DEPARTMENT OF TRANSPORTATION
 FEDERAL HIGHWAY ADMINISTRATION
 APPROVED _____ DATE _____
 DIVISION ADMINISTRATOR

PROJECT NO. M8000(11)S
 SHEET 1 OF 24 SHEETS

INDEX OF SHEETS AND SEEDING INFORMATION

1.	TITLE SHEET	
2.	INDEX OF SHEETS AND SEED INFORMATION	
3.	PROJECT DESCRIPTION AND LOCATION	
4.	TYPICAL SECTIONS AND DESIGN DATA	
5-7.	QUANTITY SHEETS	
8.	UTILITIES LAYOUT SHEET (APPROX. LOCATION)	
9.	PAVEMENT MARKING DETAILS & NOTES	
10.	BLANK	
11.A-66	URBAN TYPICAL SECTIONS	11/21/80 R
12.B-71	STD FOR RES AND COM DRIVES	07/23/80 R
13.C-1	CAST IN PLACE CEMENT CONCRETE CURB	12/16/80 R
14.C-2A	PORTLAND CEM CONCRETE SIDEWALK	12/14/71
15.D-8	REINF CONC DI w/GRATE (BOTTOM SECTION)	12/06/71
16.D-9	REINF CONC DI TOP	12/06/71
17.D-11	CAST IRON GRATE TYPE A	08/24/81 R
18.D-20	HIGHWAY CROSSINGS FOR UNDERGROUND UTILITIES	09/09/75 R
19.	BLANK	
20.E-2	ROAD CONST APPROACH SIGNS	03/04/81 R
21.E-6	ON-PROJECT CONST SIGNS	04/01/80 R
22.E-15C	REGULATORY	07/18/84
23.E-29	STANDARD SIGN PLACEMENT	08/25/81 R
24.E-50	PAVEMENT MARKING DETAILS	03/16/82 R

SEEDING FORMULA ITEM 651.10

URBAN AREAS

<u>%WT. LBS/A</u>	<u>NAME</u>	<u>PUR%</u>	<u>GERM%</u>
37.50 30	CREEPING RED FESCUE (VAR. PENNLAWN)	98	85
31.25 25	KENTUCKY BLUEGRASS (COMMON)	85	75
31.25 25	PERENNIAL RYE GRASS (VAR. PENNLAWN)	95	90
100 80			

FERTILIZER. ITEM 651.15
 FORMULA 10-20-10 TO BE USED WITH SEED.
 ITEM 651.10 APPLIED AT THE RATE OF 500LBS/ACRE

AGRICULTURAL LIMESTONE ITEM 651.20
 TO BE APPLIED AT RATE OF 2 TONS/ACRE
 OR AS DIRECTED BY THE ENGINEER

HAY MULCH ITEM 651.25
 TO BE PLACED ON EARTH SLOPES AT THE RATE
 OF 2 TONS/ACRE

TOPSOIL ITEM 653.10
 TO BE USED WITH SEED. ITEM 651.10 IN
 RESIDENTIAL AREAS, AS DIRECTED BY
 THE ENGINEER

PROJECT St. Albans

NO M8000(11)S
 SHEET 2 OF 24 SHEETS

PROJECT DESCRIPTION AND LOCATION

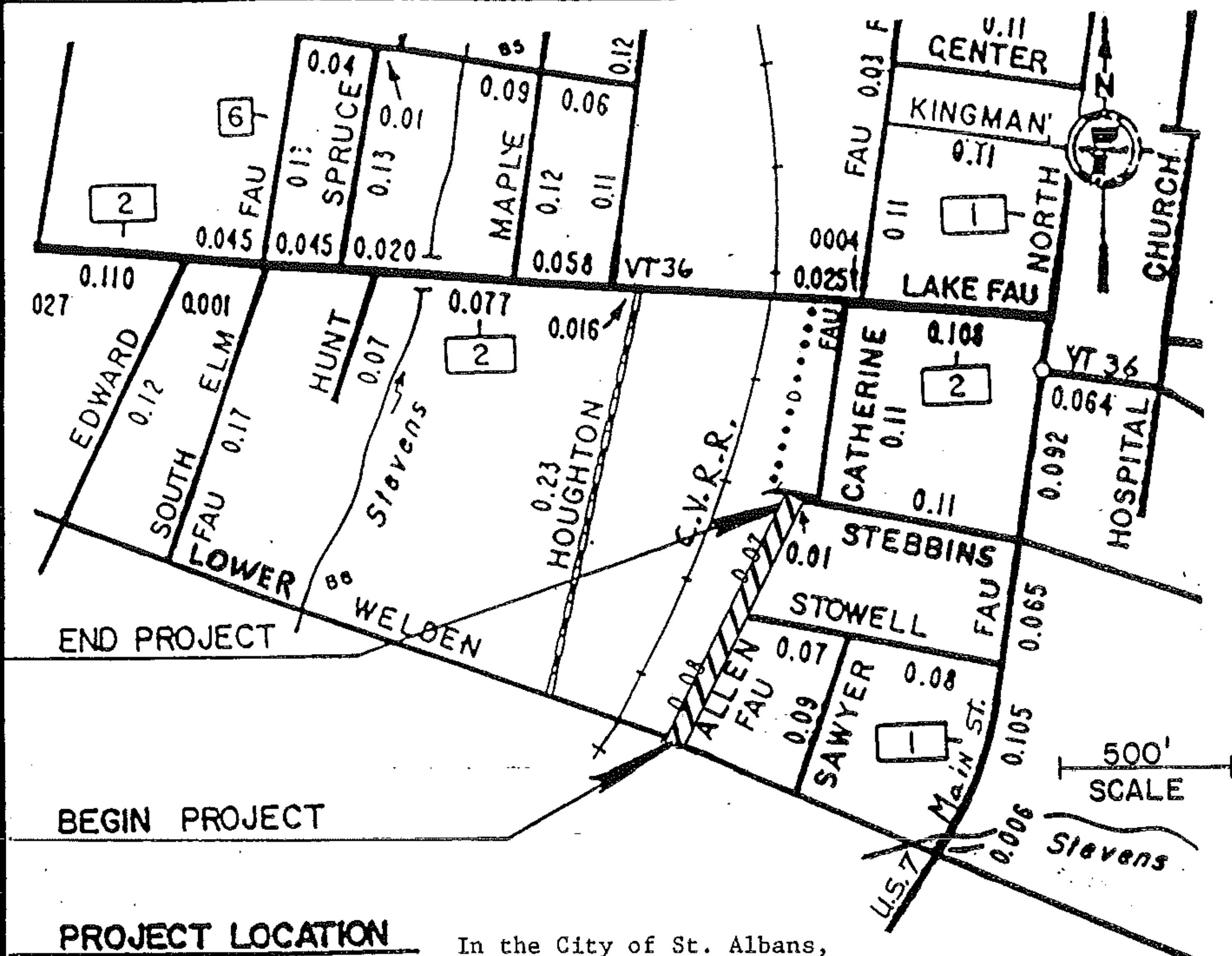

PROJECT LOCATION

In the City of St. Albans, beginning at Lower Welden Street and extending northerly along Allen Street 0.15 miles to Stebbins Street.

PROJECT LENGTH

0.150 miles (792 feet)

PROJECT DESCRIPTION

Work to be performed includes widening roadway, with new base and subbase, new curb both sides, pavement overlay, and new 4' sidewalk where shown.

TRAFFIC DATA

1985	ADT	900	D	58%
2005	ADT	1120	T	1%
2005	DHV	160	V	25 MPH

PROJECT ST. ALBANS

NO. M 8000 (II) S

SHEET 3 OF 24 SHEETS

TYPICAL SECTIONS & DESIGN DATA

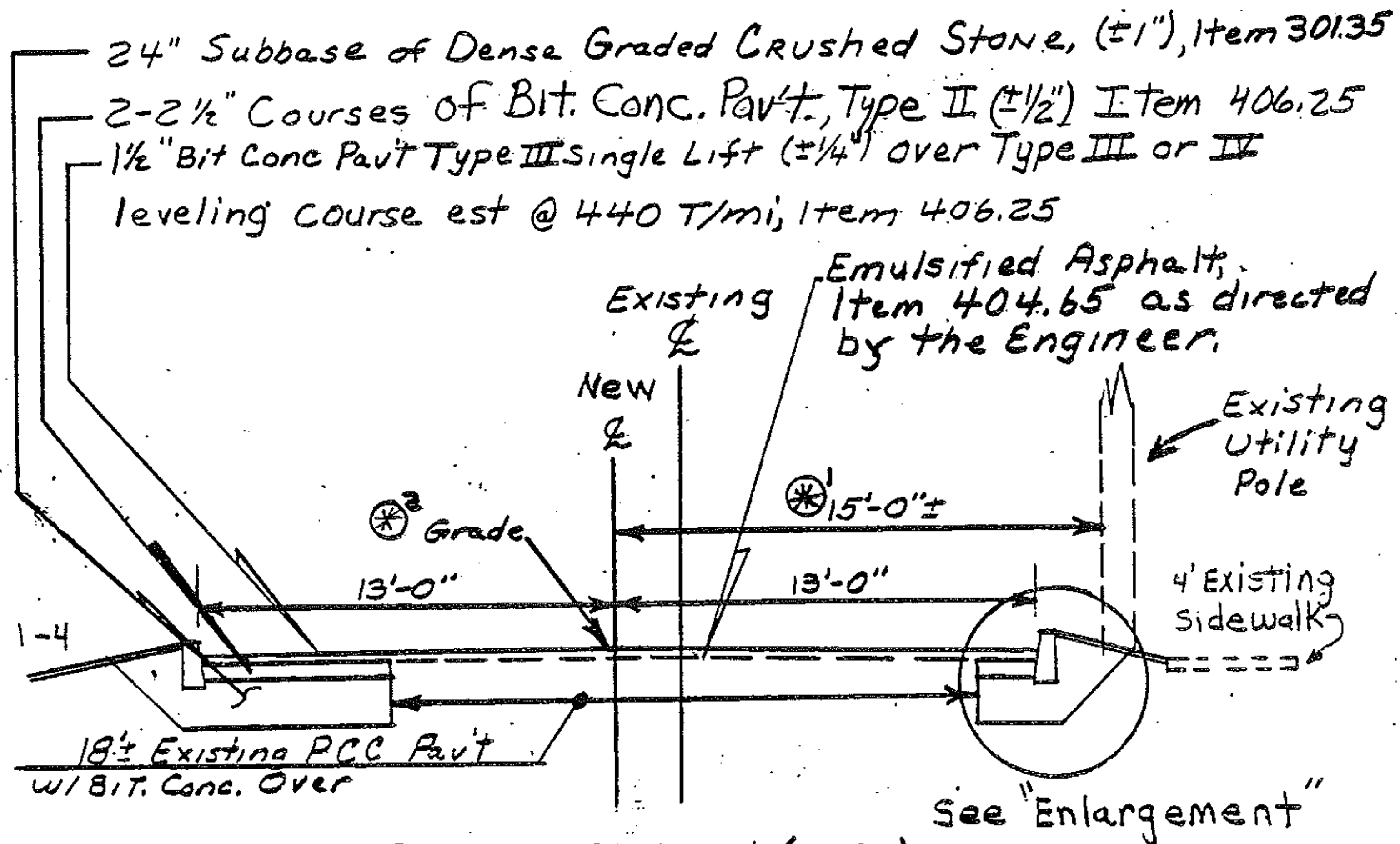

TYPICAL SECTION (NTS)

- $\text{\textcircled{E}}$ As established in field, by Engineer; Strive for 2" (min) from face of curb to face of existing pole line.
- $\text{\textcircled{G}}$ Finish grade to be 1/2" (plus leveling) above existing, or as directed by the Engineer.

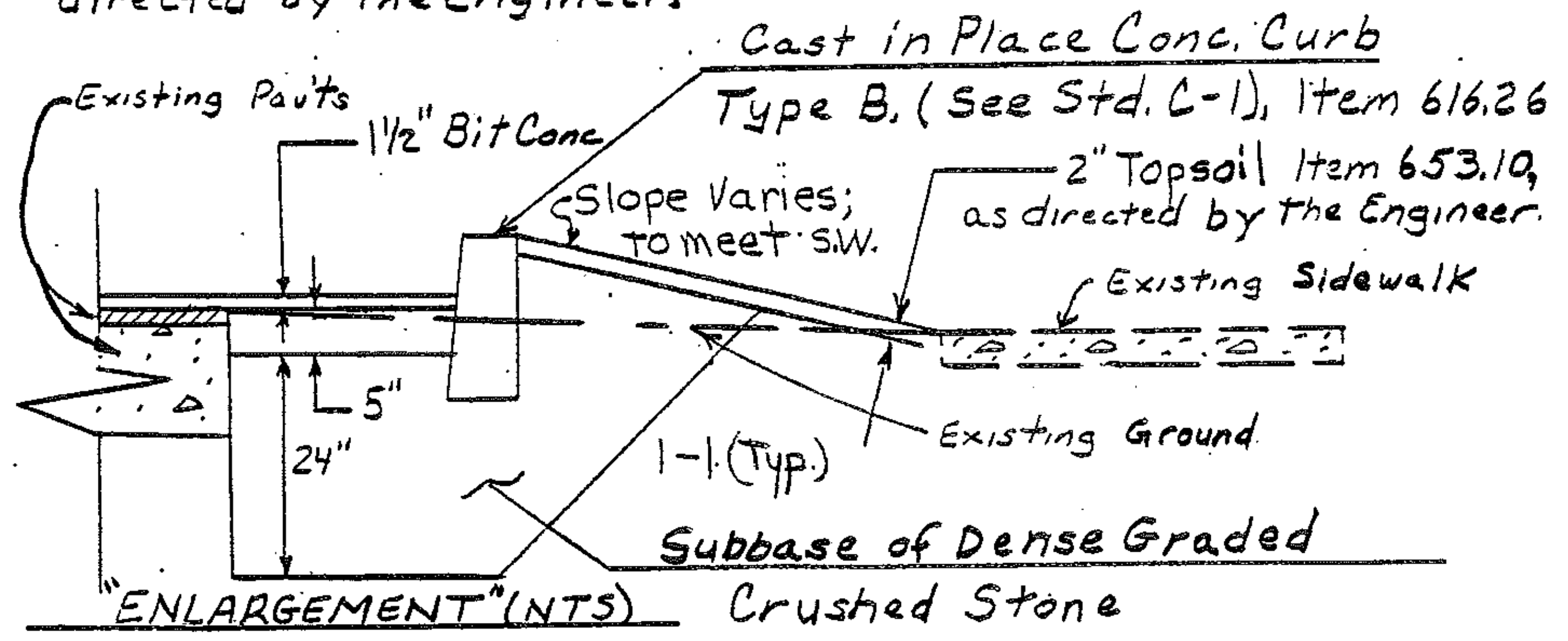

ITEM QUANTITIES

* PCC pav't replacement to be done if and as directed by the Engineer.

COMMON Excavation
 Tr. EXCAV. of Earth
 Tr EXCAV of Rock
 Gran Backfill
 Subbase of Dense Graded Crushed Stone
 Emulsified Asphalt
 Bituminous Conc. Pavement
 Concrete Reinforcing Steel
 18" RCP (class B)
 Relaying Pipe Culvert
 Changing Elev. of DI, CB, M, H

ITEM NO.	203.15	204.20	204.21	204.30	301.35	404.65	406.25	501.25	507.15	601.2623	601.7250	604.40	REMARKS
UNIT	CY	CY	CY	CY	CY	CWT	TON	CY	LB	LF	LF	EA	
LOCATION													
Project	809				740	6						12	
Existing Pipe X-ings		14						9.0					Est* (Std. D-20)
Old R.R. Bed		33						22.6					Est* (Std. D-20)
D.I.'S		9						3.4	350				Est
Sidewalk		14											Est (4' wide)
Pipe Crossing			10										Est
Project				20						24	24		Est
Top Pav't							190						
Leveling Course							66						
Base							205						
Rounding	11				10		4						
Totals	820	70	10	20	750	6	465	35	350	24	24	12	

ITEM QUANTITIES

ITEM NO.	ITEM DESCRIPTION															REMARKS		
	604.45	608.25	608.37	609.10	616.26	618.10	618.11	629.20	630.10	630.15	635.10	646.36	646.77					
UNIT	EA	HR	HR	M/gal.	LF	SY	SY	EA	HR	HR	LS	LF	LF					
LOCATION																		
Project											1							
Project	6	16	16	55	1400	5		7	40	75							Est.	
Sidewalk							34	20										(4'wide) ^{see} sheet # 8
Allen St.												1400	34					
Stowell St.													17					
Rounding																		
Totals	6	16	16	55	1400	40	20	7	40	75	1	1400	51					

Cast Iron Grate w/Frame, Type "A"
 All Purpose Excavator Rental, Type I
 Truck Rental
 Dust Control w/water
 Cast-in-Place Cem. Conc. Curb Type "B"
 Portland Cem. Conc. Sidewalk-5 inch
 Portland Cem. Conc. Sidewalk-8 inch
 Adjust Elev of Valve Box
 Uniformed Traffic Officers
 Flag persons
 Mobilization
 Temporary 4" Reflect, yellow Lines
 Temporary 24" STOP Bar

UTILITIES LAYOUT SHEET
(APPROXIMATE LOCATIONS)

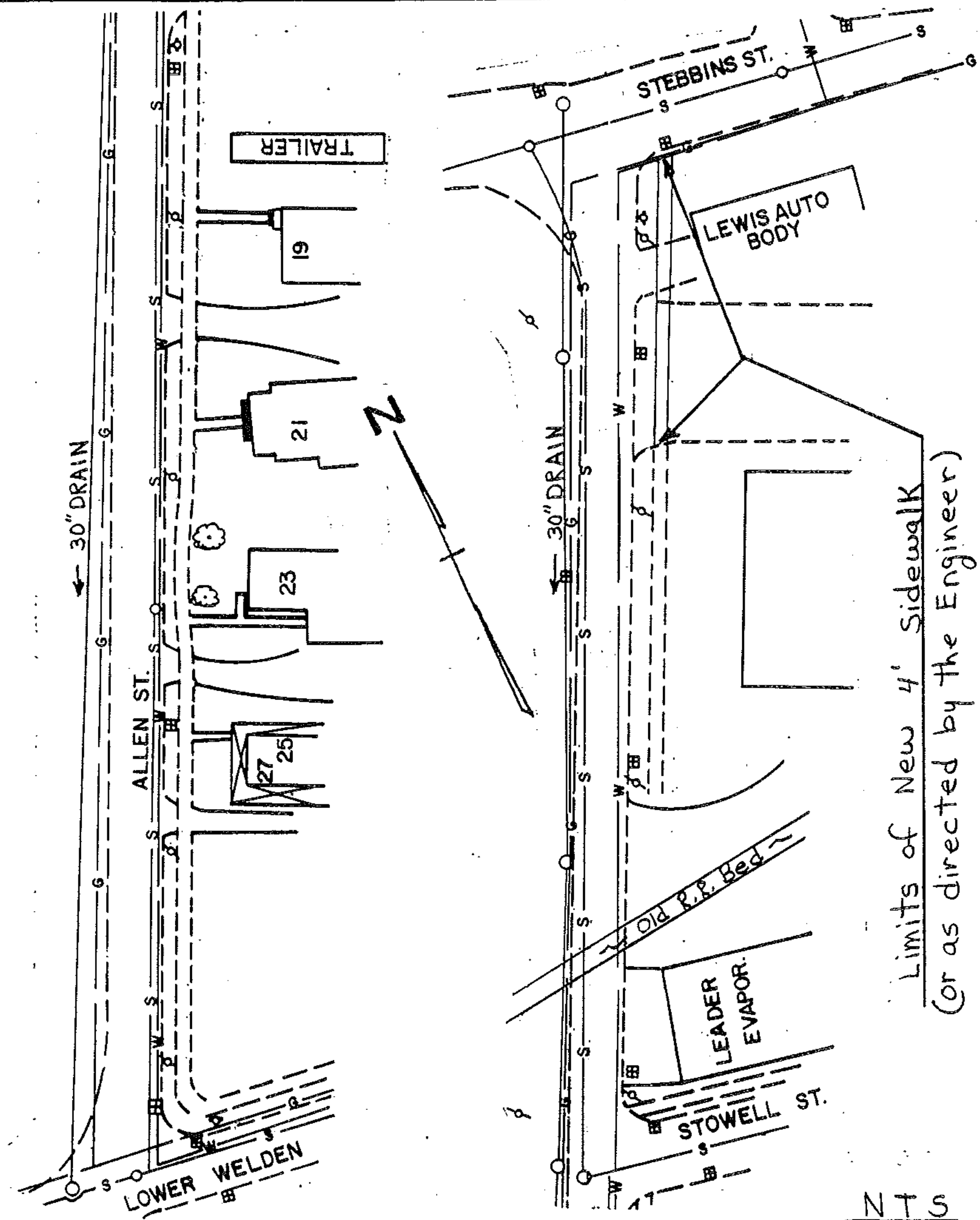

PROJECT St. Albans

NO. M 8000 (11) S

SHEET 8 OF 24 SHEETS

DETAILS

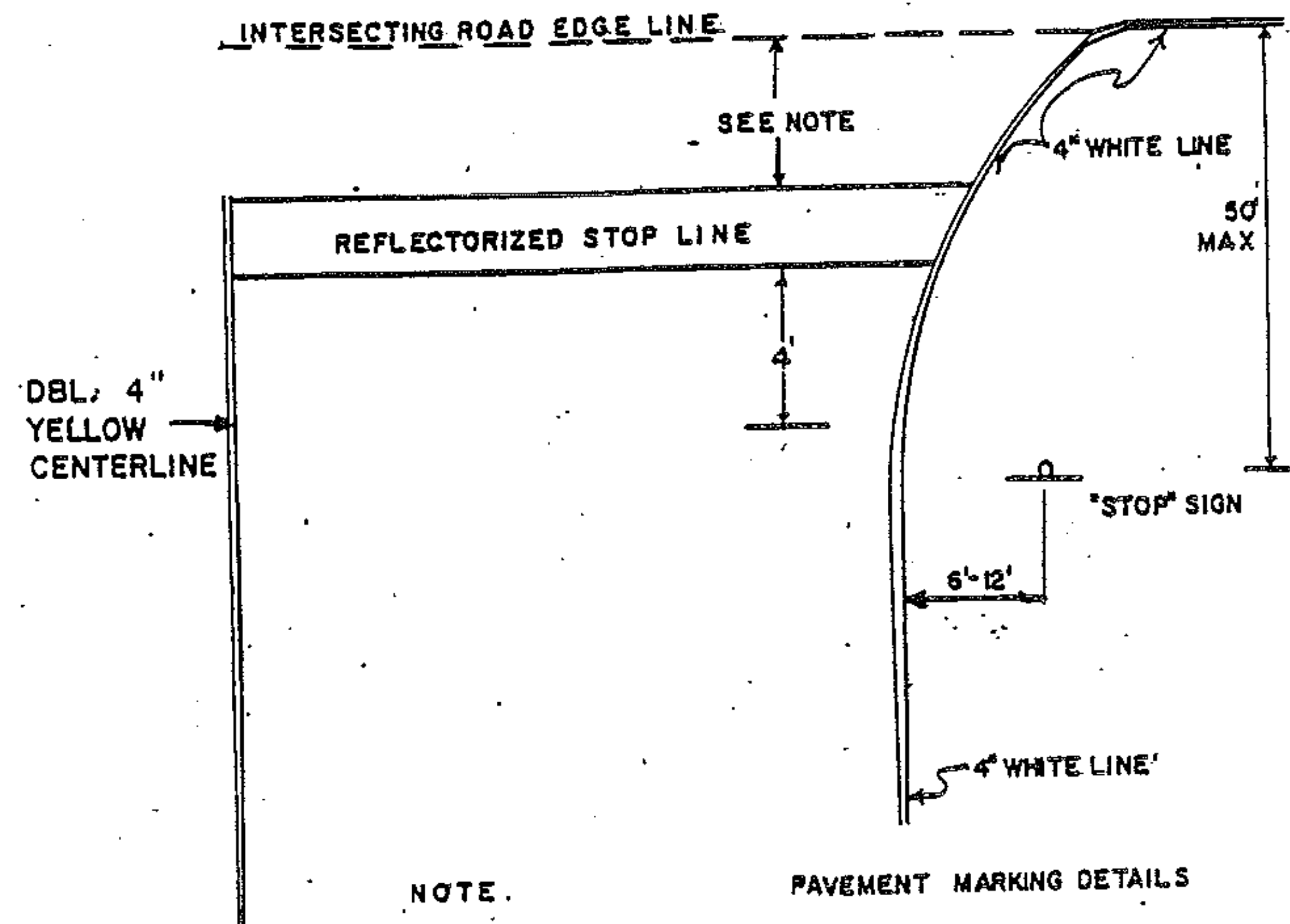

1. THE STOP LINE SHOULD BE PLACED AT THE DESIRED STOPPING POINT, IN NO CASE MORE THAN 30 FEET OR LESS THAN 4' FROM THE NEAREST EDGE OF THE INTERSECTING ROADWAY.

Notes:

- 1) Three Stop Bars at 17 feet each - Two on Allen St.
- One on Stowell St.
- 2) Three Stop Signs - Two on Allen Street
- One on Stowell Street
- 3) Four No Parking Signs each side of Allen Street,
at locations to be determined by the Engineer.