

PROJECT DESCRIPTION AND LOCATION

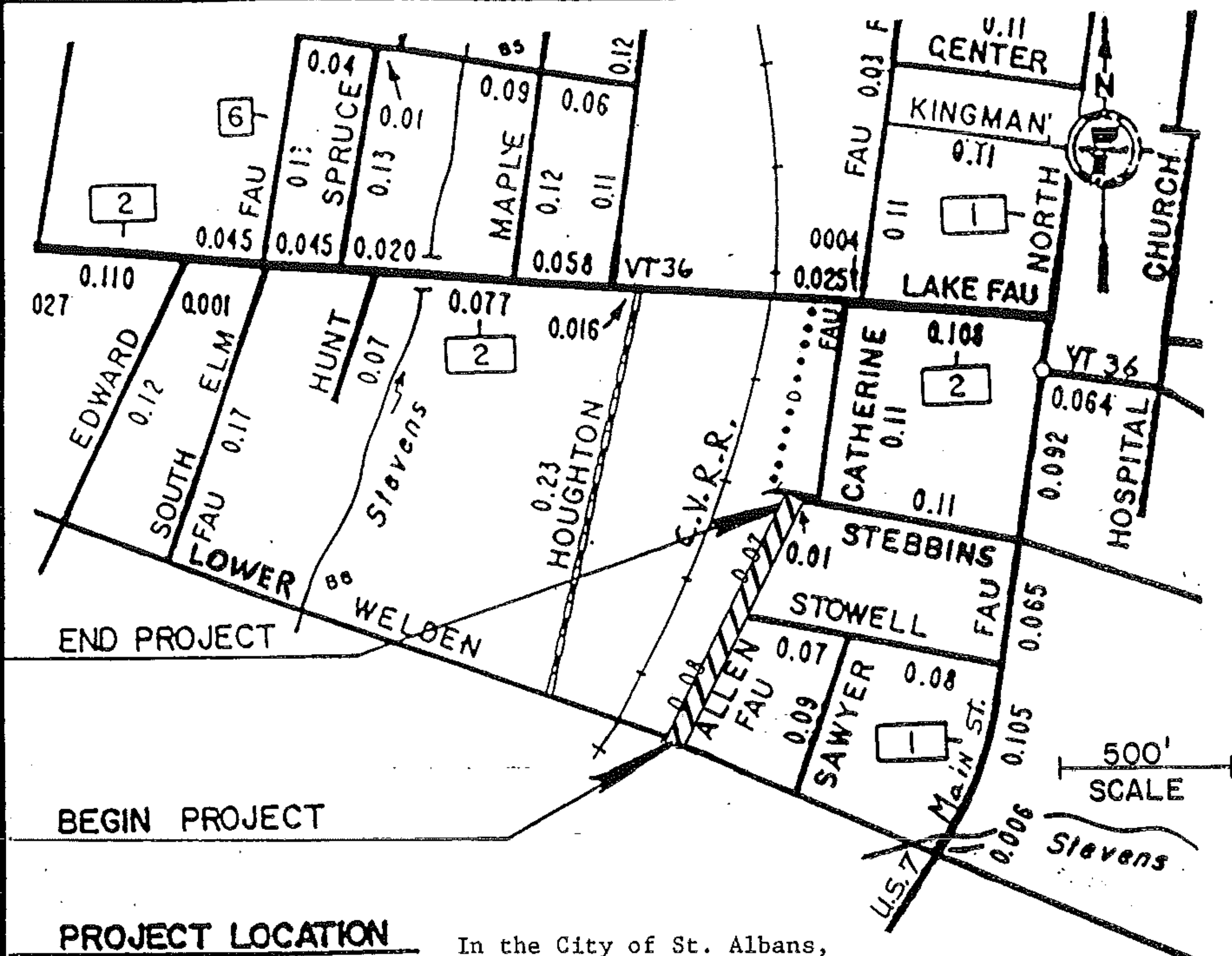

PROJECT LOCATION

In the City of St. Albans, beginning at Lower Welden Street and extending northerly along Allen Street 0.15 miles to Stebbins Street.

PROJECT LENGTH

0.150 miles (792 feet)

PROJECT DESCRIPTION

Work to be performed includes widening roadway, with new base and subbase, new curb both sides, pavement overlay, and new 4' sidewalk where shown.

TRAFFIC DATA

| | | | | |
|------|-----|------|---|--------|
| 1985 | ADT | 900 | D | 58% |
| 2005 | ADT | 1120 | T | 1% |
| 2005 | DHV | 160 | V | 25 MPH |

PROJECT ST. ALBANS

NO. M 8000 (II) S

SHEET 3 OF 24 SHEETS