

DUCT BANK SCHEDULE				
DUCT BANK SECTION NO.	CONDUIT	FUNCTION	FROM	TO
1	A 4"	3# PRIMARY ELECTRIC FIBER OPTIC CABLE CATV SPARE	UTILITY POLE #8	TERMINAL CABINET, TC-1 UNDERGROUND JUNCTION BOX
	G 4"		UTILITY POLE #7	
	H 4"		UTILITY POLE #7	
2	A 4"	3# PRIMARY ELECTRIC TELEPHONE - 'EXPRESS' TELEPHONE - DISTRIBUTION	UTILITY POLE #8	TERMINAL CABINET TC-1 TP-3A (EXISTING) TP-1
	D 4"		UTILITY POLE #6	
	E 4"		UTILITY POLE #6	
	G 4"		UTILITY POLE #7	
	J CIC CABLE		UTILITY POLE #6	
3	A 4"	3# PRIMARY ELECTRIC HOUSE SERVICE ELECTRIC	UTILITY POLE #8	TERMINAL CABINET, TC-1 T-1
	B 3"		UTILITY POLE #6	
	D 4"		UTILITY POLE #6	
	E 4"		UTILITY POLE #6	
	F 2"		UTILITY POLE #6	
	G 4"		UTILITY POLE #7	
	H 4"		UTILITY POLE #7	
J CIC CABLE	UTILITY POLE #6			
4	A 4"	3# PRIMARY ELECTRIC HOUSE SERVICE ELECTRIC TELEPHONE - 'EXPRESS' TELEPHONE - DISTRIBUTION TELEPHONE - HOUSE SERVICE	TERMINAL CABINET, TC-1	TERMINAL CABINET, TC-2 HOUSE NO.2 TP-3A (EXISTING) TP-2 HOUSE NO.2
	B 3"		T-1	
	D 4"		UTILITY POLE #2	
	E 4"		TP-1	
	G 4"		UTILITY POLE #6	
	H 4"		UTILITY POLE #6	
	I 4"		UTILITY POLE #6	
	J CIC CABLE		CP-1	
	K CIC CABLE		CP-1	
	S 2"		SL-2	
12	D 4"	TELEPHONE - 'EXPRESS' TELEPHONE - DISTRIBUTION	UTILITY POLE #6	UTILITY POLE #1 UTILITY POLE #1
	E 4"		UTILITY POLE #6	
13	A 4"	3# PRIMARY ELECTRIC	UTILITY POLE #8	TERMINAL CABINET, TC-1
	B 3"		UTILITY POLE #8	

NOTES TO DUCT BANK SCHEDULE:

- SEE RISER DIAGRAMS, SHEET E6, FOR CONDUIT/CABLE SYSTEMS.
- ELECTRIC PRIMARY CABLES TO BE INSTALLED BY CENTRAL VERMONT PUBLIC SERVICE (CVPS).
- TELEPHONE CABLES TO BE INSTALLED BY BELL ATLANTIC.
- CATV AND FIBER OPTIC CABLES TO BE INSTALLED BY ADDELPHIA CABLE COMMUNICATION CO. CIC CABLE IS A DIRECT BURIAL CABLE.

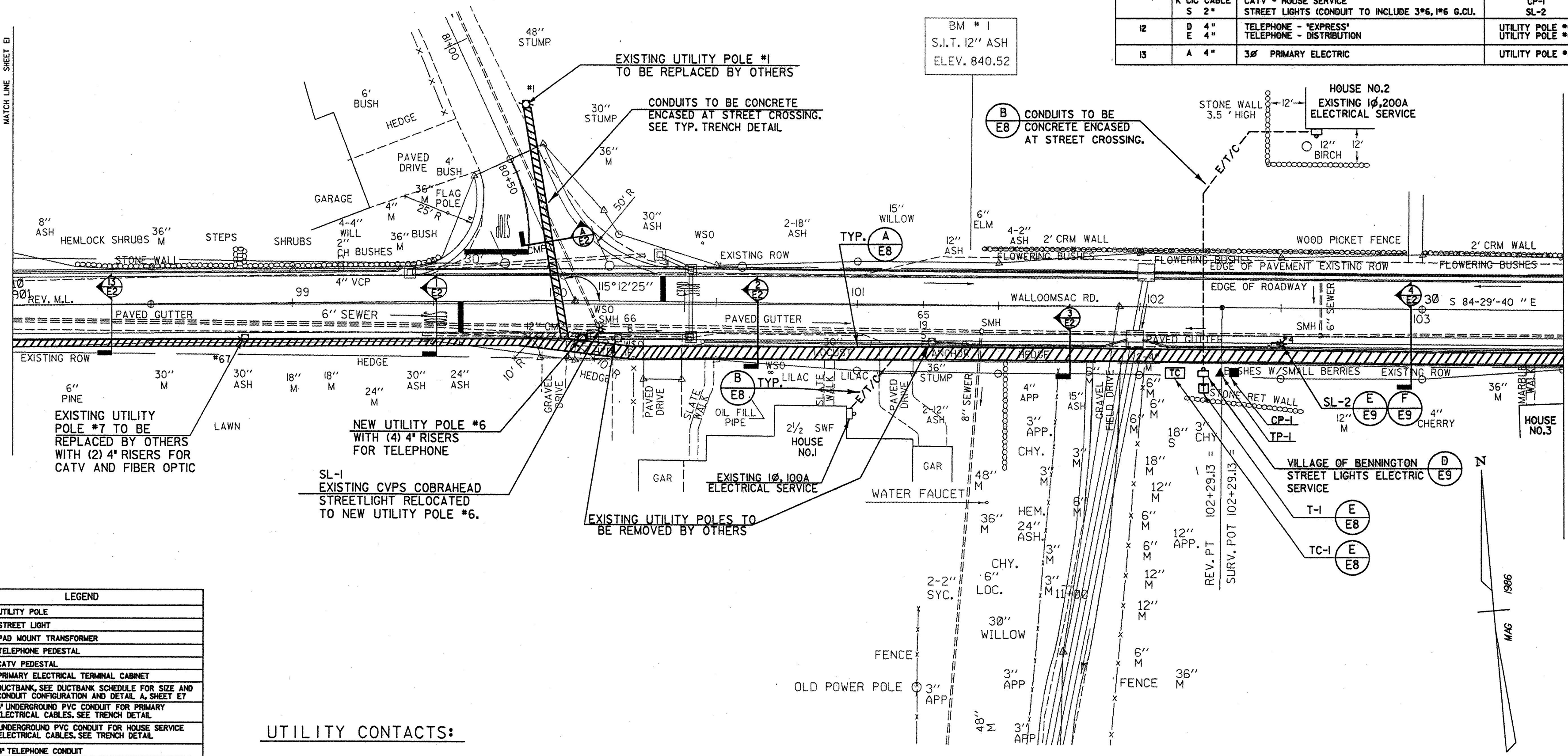

LEGEND	
	UTILITY POLE
	STREET LIGHT
	PAD MOUNT TRANSFORMER
	TELEPHONE PEDESTAL
	CATV PEDESTAL
	PRIMARY ELECTRICAL TERMINAL CABINET
	DUCTBANK, SEE DUCTBANK SCHEDULE FOR SIZE AND CONDUIT CONFIGURATION AND DETAIL A, SHEET E7
	4" UNDERGROUND PVC CONDUIT FOR PRIMARY ELECTRICAL CABLES, SEE TRENCH DETAIL
	2" UNDERGROUND PVC CONDUIT FOR HOUSE SERVICE ELECTRICAL CABLES, SEE TRENCH DETAIL
	4" TELEPHONE CONDUIT
	DIRECT BURIED CATV CABLE, INSTALLED BY ADDELPHIA CABLE
	TRENCH WITH PVC CONDUIT FOR HOUSE SERVICE ELECTRICAL CABLE, 2" TELEPHONE CONDUIT AND CATV CABLE, SEE DETAIL B, SHEET E7.
	2" UNDERGROUND PVC CONDUIT WITH 3/8" AWG CU CONDUCTORS FOR STREETLIGHTING.
	ELECTRICAL SERVICE METER SOCKET. SIZE AS NOTED.

UTILITY CONTACTS:

CENTRAL VERMONT PUBLIC SERVICE:
RANDY SCHRAMM (802) 375-2206

BELL ATLANTIC:
WAYNE PRESCOTT (802) 747-1074

ADDELPHIA CABLE COMMUNICATION:
ERNIE THOMPSON (802) 447-1534

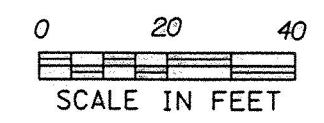

NO.	DATE	BY	DESCRIPTION
1	7/23/98	LAB	ADD DUCT BANK

OLD BENNINGTON
UTILITY PLAN
WALLOMSAC AVENUE
STA. 98+00 TO 103+50

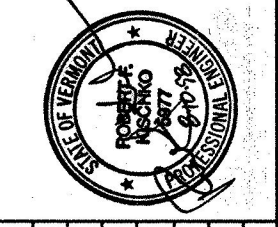

Project No.	28080018
Proj. Manager	R.F. KISCHIKO
Proj. Designer	L.A. BLACK
Drawn By	M. MELLEUR
Checked By	R.F. KISCHIKO
Scale	AS SHOWN
Approved	AS SHOWN
Date	MARCH, 1998