

STATE OF VERMONT AGENCY OF TRANSPORTATION

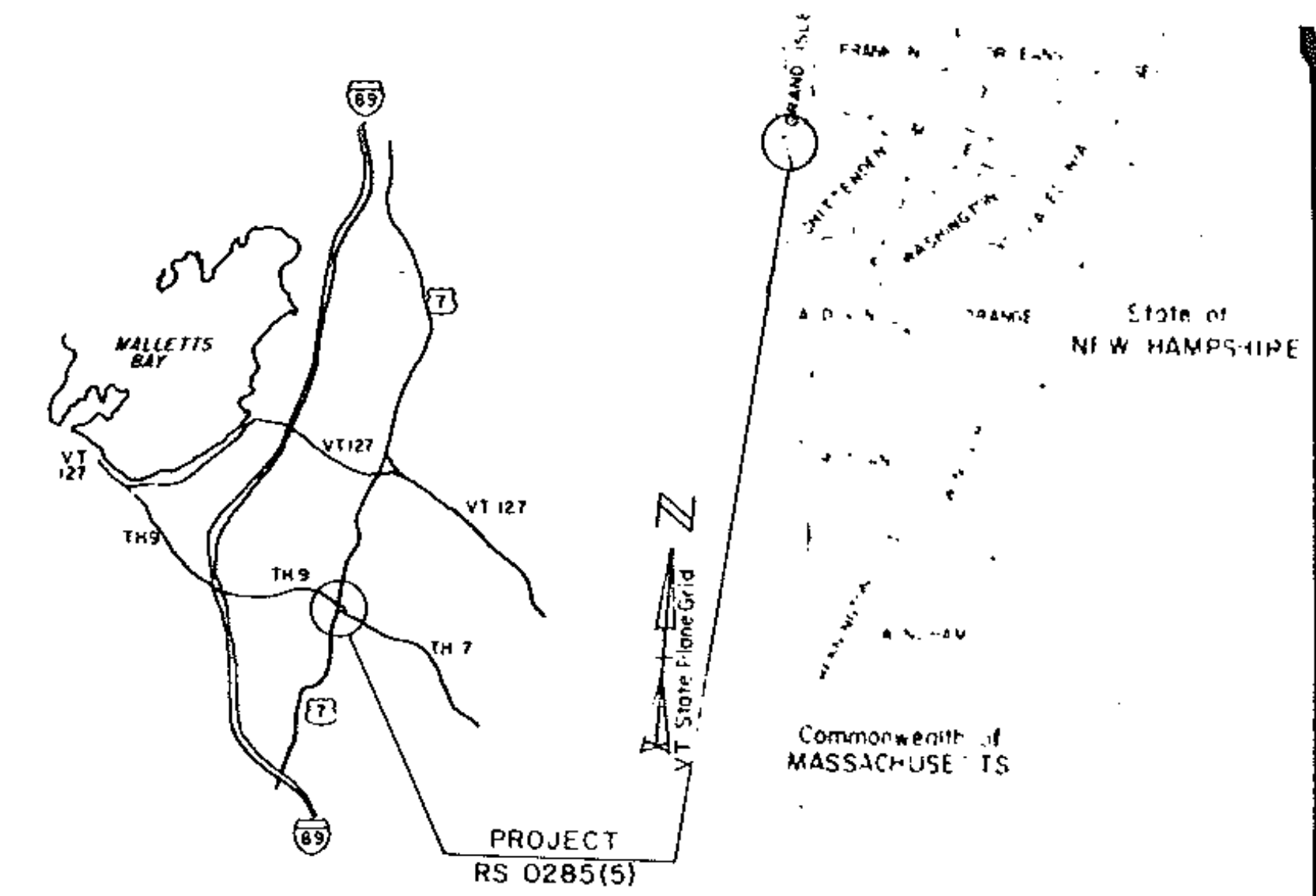

PROPOSED IMPROVEMENT TOWN OF COLCHESTER COUNTY OF CHITTENDEN



VICINITY MAP
0 1 2
Scale in Miles

R.O.W. PLANS

TOWN HIGHWAY 7, CLASS 2

BEGINNING AT THE INTERSECTION OF U.S. ROUTE 7 AND TOWN HIGHWAY 9, AND EXTENDING SOUTHEASTERLY FOR APPROXIMATELY 989 FEET ALONG RELOCATED TOWN HIGHWAY 7.

LENGTH OF PROJECT 989 FEET 0.187 MILES
LENGTH OF R.O.W. PROJECT = 1449 FEET = 0.273 MILES

WORK TO BE PERFORMED UNDER THIS PROJECT INCLUDES GRADING, DRAINAGE, SUB-BASE, AND PAVEMENT FOR A TOWN HIGHWAY ON NEW LOCATION.

BEGIN R.O.W. PROJECT RS 0285(5)
STA. 7+06 RT.

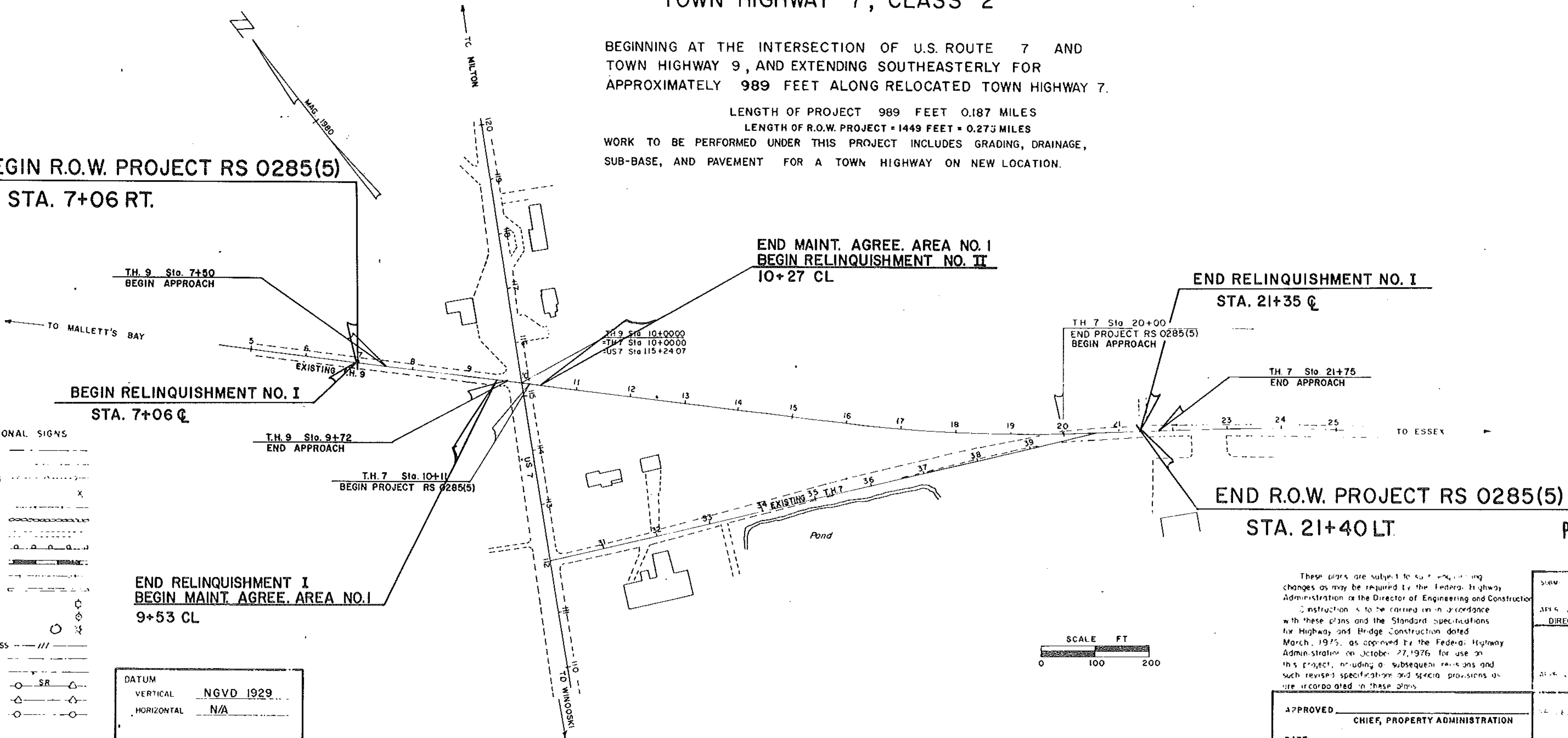

END RELINQUISHMENT I
BEGIN MAINT. AGREE. AREA NO. I
9+53 CL

END RELINQUISHMENT NO. I
STA. 21+35 Q

END R.O.W. PROJECT RS 0285(5)
STA. 21+40 LT.

- CONVENTIONAL SIGNS
- COUNTY LINE
 - TOWN LINE
 - RIGHTS OF ACCESS
 - POINT OF ACCESS
 - ADJACENT LINE
 - STONE WALL
 - PAVELED WAY
 - ROAD RAIL
 - ROAD
 - DRIVE LINE
 - VERT
 - WATER POLE
 - TELEPHONE POLE
 - TREES
 - CONTROL OF ACCESS
 - PROPERTY LINE
 - LOW TAKING LINE
 - EMPHASE RIGHTS
 - OF CUT
 - OF SLOPE

DATUM
VERTICAL NGVD 1929
HORIZONTAL N/A

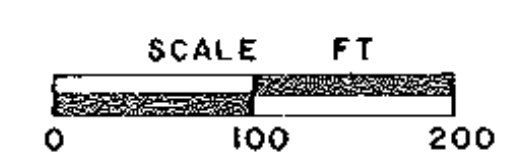

These plans are subject to such engineering changes as may be required by the Federal Highway Administration or the Director of Engineering and Construction. Construction is to be carried on in accordance with these plans and the Standard Specifications for Highway and Bridge Construction dated March, 1975, as approved by the Federal Highway Administration on October 27, 1976, for use on this project, including all subsequent revisions and such revised specifications and special provisions as are incorporated in these plans.

APPROVED _____
CHIEF, PROPERTY ADMINISTRATION
DATE _____

**PROJECT PROCESSED UNDER
SECONDARY ROAD PLAN**

SUBMITTED BY: DEPT. OF STATE TRANSPORTATION
APPROVED BY: _____
DIRECTOR OF ENGINEERING AND CONSTRUCTION
PERMITTED BY: _____
FEDERAL HIGHWAY ADMINISTRATION
APPROVED BY: _____
STATE ADMINISTRATOR

PROJECT: COLCHESTER RS 0285(5)
SHEET 12 OF 93 SHEETS