

STATE OF VERMONT AGENCY OF TRANSPORTATION

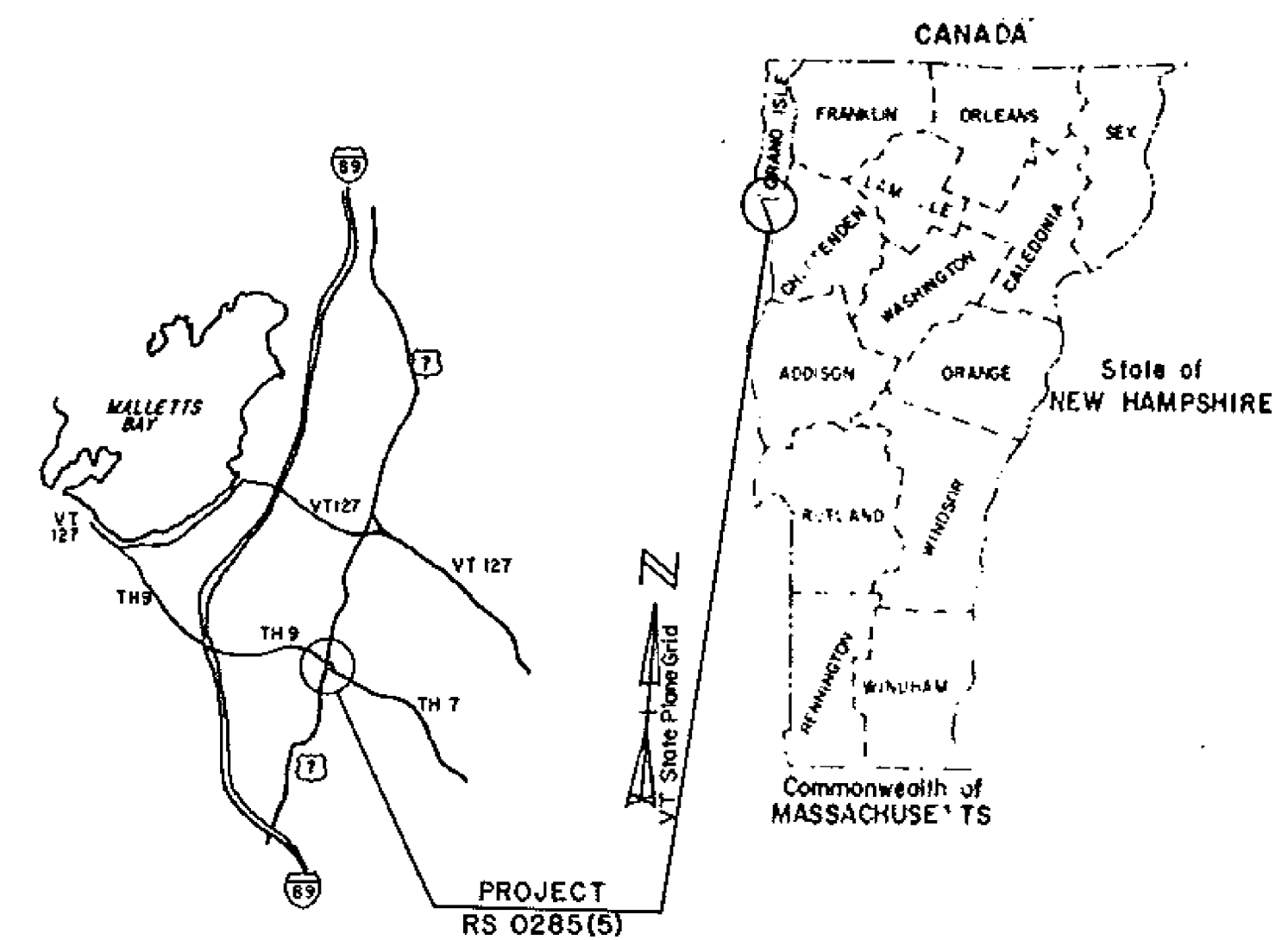

PROPOSED IMPROVEMENT TOWN OF COLCHESTER COUNTY OF CHITTENDEN



CONTRACT PLANS

THESE PLANS DO NOT REFLECT CHANGES MADE ON THE PROJECT AS "RECORD PLANS" WOULD.

- INDEX
- 1- TITLE SHEET
 - 2- INDEX OF SHEETS

Date MAY 17 1988

Munson Earth-Moving Corporation
Contractor

[Signature]
Signature

Donald G. Munson, President/Treasurer
Title

[Signature]
Transportation Secretary's Signature

TOWN HIGHWAY 7, CLASS 2
BEGINNING APPROX. 9515.93 FEET NORTH OF THE WINOOSKI / COLCHESTER TOWN LINE ON U.S. RTE. 7 AND EXTENDING NORTHERLY 1350 FEET, AND ALSO BEGINNING AT THE INTERSECTION OF U.S. ROUTE 7 AND TOWN HIGHWAY 9, AND EXTENDING SOUTHEASTERLY FOR APPROXIMATELY 989 FEET ALONG RELOCATED TOWN HIGHWAY 7.

LENGTH OF PROJECT 2339 FEET 0.443 MILES

WORK TO BE PERFORMED UNDER THIS PROJECT INCLUDES GRADING, DRAINAGE, SUB-BASE, AND PAVEMENT AND TRAFFIC SIGNAL INSTALLATION AT THE INTERSECTION OF TH.9, TH.7 AND U.S.7.

TOWN HIGHWAY 7		
1982	AADT	3470
1992	AADT	4410
1992	DHV	600
	D	58%
	T	2%
	V	40MPH

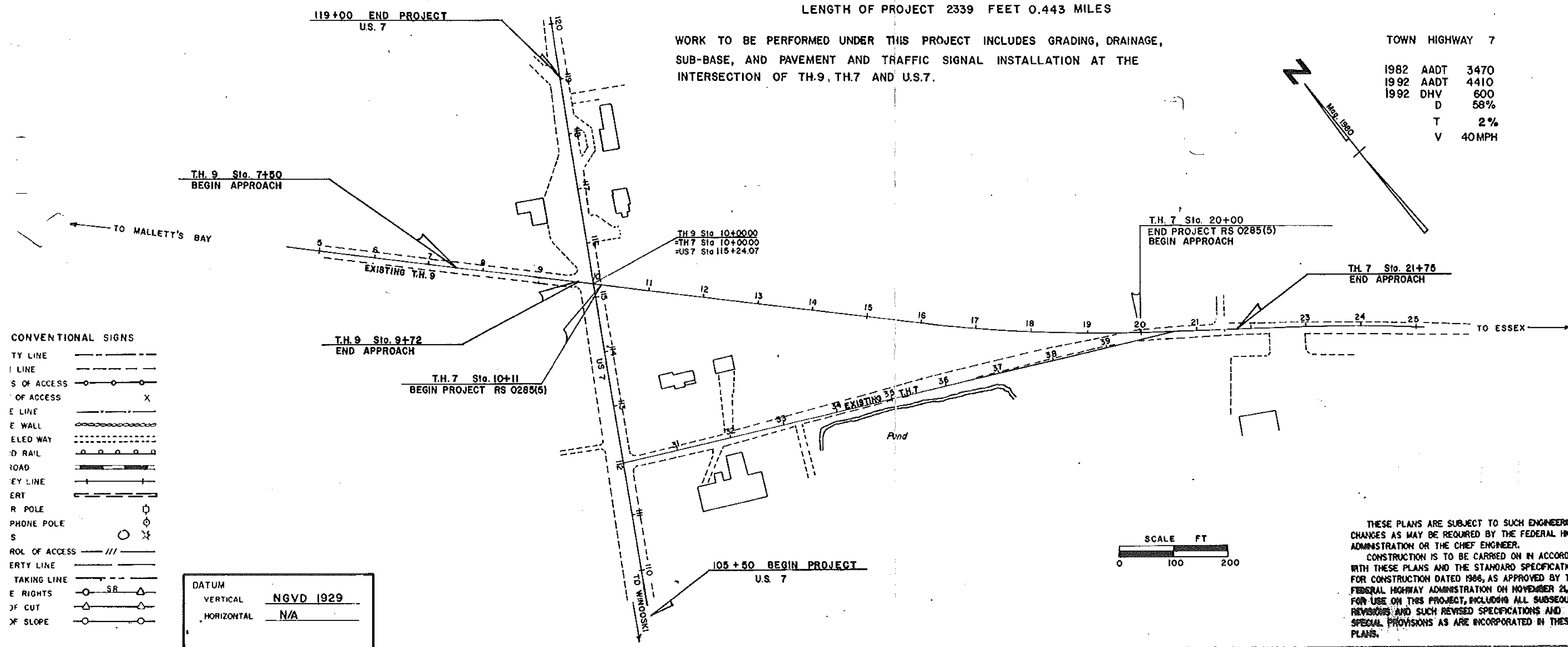

- CONVENTIONAL SIGNS**
- TY LINE
 - I LINE
 - S OF ACCESS
 - OF ACCESS
 - E LINE
 - E WALL
 - ELED WAY
 - D RAIL
 - ROAD
 - EY LINE
 - ERT
 - R POLE
 - PHONE POLE
 - S
 - ROL OF ACCESS
 - ERTY LINE
 - TAKING LINE
 - E RIGHTS
 - OF CUT
 - OF SLOPE

DATUM
VERTICAL NGVD 1929
HORIZONTAL N/A

PROJECT PROCESSED UNDER SECONDARY ROAD PLAN

SUBMITTED BY ORDER OF THE STATE TRANSPORTATION BOARD

APPROVED David B. Kelly DATE 12/2/87
CHIEF ENGINEER

DEPARTMENT OF TRANSPORTATION
FEDERAL HIGHWAY ADMINISTRATION

APPROVED: _____ DATE _____
DIVISION ADMINISTRATOR

PROJECT COLCHESTER HESRS 0285(5)

SHEET 1 OF 93 SHEETS

THESE PLANS ARE SUBJECT TO SUCH ENGINEERING CHANGES AS MAY BE REQUIRED BY THE FEDERAL HIGHWAY ADMINISTRATION OR THE CHIEF ENGINEER. CONSTRUCTION IS TO BE CARRIED ON IN ACCORDANCE WITH THESE PLANS AND THE STANDARD SPECIFICATIONS FOR CONSTRUCTION DATED 1966, AS APPROVED BY THE FEDERAL HIGHWAY ADMINISTRATION ON NOVEMBER 24, 1986 FOR USE ON THIS PROJECT, INCLUDING ALL SUBSEQUENT REVISIONS AND SUCH REVISED SPECIFICATIONS AND SPECIAL PROVISIONS AS ARE INCORPORATED IN THESE PLANS.