

INDEX OF SHEETS

1. TITLE SHEET
2. QUANTITY SHEET
- 3-4. PLAN AND PROFILE SHEETS
5. PLATE PIPE DETAILS
6. BLANK
7. E-3 BRIDGE CONSTRUCTION APPROACH SIGNS 7/20/76
8. E-6 ON PROJECT CONSTRUCTION SIGNS 5/14/74 R
9. BLANK
10. BLANK
11. G-6A GUARD RAIL, THREE CABLE W/ LT. WOOD POSTS 4/17/73 R
12. G-7 ANCHOR FOR THREE CABLE GUARD RAIL 5/28/74 R
- 13-16. CROSS SECTIONS - CHANNEL LINE AT 21-32.23
- 17-24. CROSS SECTIONS - ROADWAY

RECORD PLANS-MATERIALS

NEWBURY SRS 2302 (9)
 CONTRACTOR - EVERETT T. WALLACE INC.
 CONTRACT DATED - 29 MAY 1977
 CONSTRUCTION BEGAN - 3 MAY 1977
 CONSTRUCTION COMPLETED - 27 JUNE 1977
 CONSTRUCTION ACCEPTED - 27 JUNE 1977
 RESIDENT ENGINEER - LEON P. TESSIER
 GRANULAR BORROW - JOHN GEORGE PIT, NEWBURY, VT.
 GRANULAR BACKFILL FOR STRUCTURES & SUB-BASE OF GRAVEL - REED PIT, NEWBURY, VT.
 BITUMINOUS CONCRETE PAVEMENT - COOLEY ASPHALT, BARRE, VT.
 CONCRETE - LAWRENCE SANGRAVCO, ST. JOHNSBURY, VT.
 REINFORCING STEEL - BETHLEHEM STEEL CO., BETHLEHEM, PENNSYLVANIA
 CGMPA - LANE METAL PRODUCTS CO., BALLISTON, NY.
 ACCGMP - LANE METAL PRODUCTS CO., BALLISTON, NY.
 GUARD RAIL, ANCHORS FOR GUARD RAIL, SEED, FERTILIZER, HAY MULCH - LAFAYETTE-SHELDON INC., ESSEX JCT., VT.

NOTE: ANY FURTHER INFORMATION CONCERNING
 FINAL QUANTITIES, AMOUNTS OR OTHER DETAILS
 RELATIVE TO THIS PROJECT MAY BE FOUND IN
 EITHER THE FIELD BOOKS OR THE ESTIMATE

RECORD PLANS - G.J.ABAIR

STATE OF VERMONT
 DEPARTMENT OF HIGHWAYS



PROPOSED IMPROVEMENT

BRIDGE PROJECT
 TOWN OF NEWBURY
 COUNTY OF ORANGE

T.H. 4 (CLASS 2) 20,61,46

PROJECT LOCATION BEGINNING ON T.H. 4, 0.9 MILES WEST OF THE INTERSECTION WITH U.S. 5
 AND PROCEEDING WESTERLY ALONG T.H. 4 FOR 0.3 MILES.

SECTION I - REPLACE B-20 WITH A NEW PLATE PIPE ARCH.
 SECTION II - RELOCATE HARRIMAN BROOK FROM STA. 30+85 TO 36+80, ELIMINATING B-61 & B-46.
 GUARD RAIL PLACEMENT AT BR. 21

SECTION I ROADWAY 150 FEET = 0.028 MILES
 SECTION II CHANNEL 595 FEET = 0.113 MILES

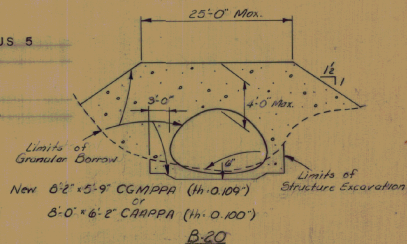
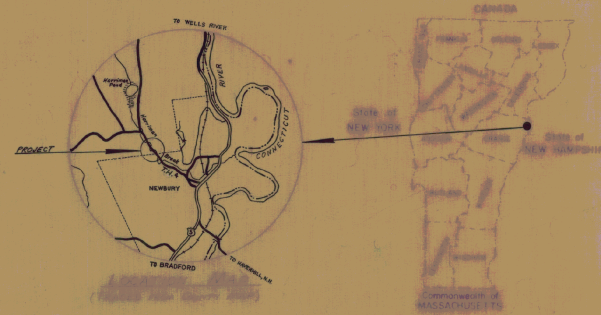

New 6'-2" x 5'-9" CGMPA (1/4" O. 109")
 or
 8'-0" x 6'-2" CAHPA (1/4" O. 100")

B-20

Not to Scale

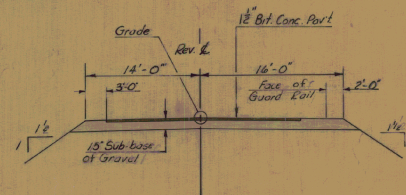
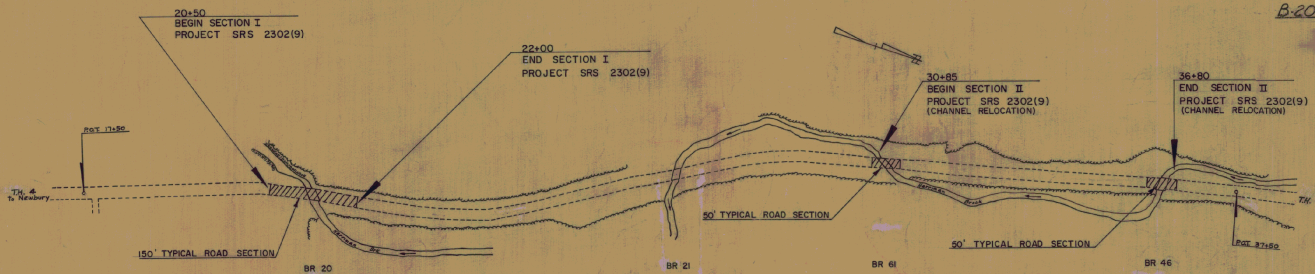

BUILT AS DESIGNED

Not to Scale

CONVENTIONAL SIGNS

TRAFFIC DATA

1975 ADT	115	1985 ADT	145
1975 DHV	25	1985 DHV	35
D%	55		
T%	6		
V	35 MPH		

ACCIDENT DATA, 5 YEAR PERIOD 1

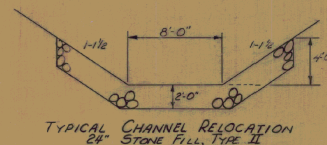
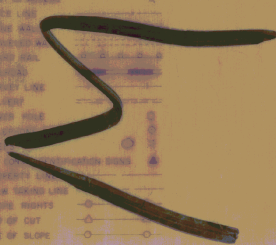

TYPICAL CHANNEL RELOCATION
 24" STONE FILL, TYPE II

APPROVED: _____ DATE: _____
 ROW DIRECTOR
 NEWBURY
 PROJECT: SRS # 2302 (9)
 SHEET 1 OF 24 SHEETS

EARTHWORK

BRIDGE QUANTITY SHEET

STATE OF VERMONT
DEPARTMENT OF HIGHWAYS
BRIDGE DIVISION

V.C.	% GRD	STATION	GRADES		CORR. V.C.	DIST.	AREA	CU. YDS.	UNCLASS. CHANNEL		STONE FILL		AREA	CU. YDS.
			ON TAN.	ON V.C.					AREA	CU. YDS.	AREA	CU. YDS.		
SECTION II														
		30+85						0	14					
		31+00				15		30	197	44	01			
		+50				30		163	255	44	01			
		32+00				100		112	433	44	03			
		33+00				100		182	576	2	05			
		34+00				100		189	869	44	10			
		35+00				100		280	933	44	16			
		36+00				30		224	312	44	01			
		+50				30		113	63		04			
		+80						0			0			
		TOTAL						3632		775				
SECTION I														
		20+50						0						
		+75.5				59.5		38	21					
		+98.5				17.0		42	28					
		21+20.5				30.0		0	23					
		+40.5				20.0		132	108	78	78			
		168.5				20.0		180	09	78	123			
		+99				30.5		80	66	34	34			
		22+50				51.0		0						

NO.	ITEM	UNIT	QUANTITY BREAKDOWN										TOTAL	FINAL	
			CGMPPA	RWDY	CHANNEL										
	8'2"x5'9" CGMPPA @ STA 21+32.23														
203.15	Common Excavation	CY												73	97
203.32	Granular Borrow	CY	340											340	285
203.27	Unclassified Channel Excavation	CY	10											10	8
204.25	Structure Excavation	CY	260											260	211
204.30	Granular Backfill for Structures	CY	30											30	38
301.15	Sub-base of Gravel	CY		450										450	286
406.25	Bituminous Concrete Pavement	ton		61										61	47.73
501.25	Concrete Class B	CY	7											7	3.39
507.15	Reinforcing Steel	LB	70											70	80
511.15	8'2"x5'9" CGMPPA (H=0.109")	LS	1											1	1
613.11	Stone Fill Type II	CY	60											60	57
621.22	Guard Rail, Three Cable w/1 Wood Posts	LF		592										592	600
637.10	Maintenance of Traffic for Bridge Projects	LS	1											1	1
621.66	Anchor For 3 C.G.R. w/1 Steel & Wood Posts	EA		4										4	4
Channel Relocation Sta 30+40 to 36+75															
203.27	Unclassified Channel Excavation	CY			3660									3660	4357
202.20	Removal of Existing Superstructure	LS		2										2	2
406.25	Bituminous Concrete Pavement	ton		12										12	2.78
613.11	Stone Fill Type II	CY			775									775	761
301.15	Sub-base of Gravel @ B-46 & B-61	CY		40										40	126
601.178	18" A.C.G.M.P. (2044)	L.F.		86										86	70
621.66	Anchor For 3 C.G.R. w/1 Steel and Wood Posts	EA		2										2	0
621.22	Guard Rail, Three Cable w/1 Wood Posts	L.F.		656										656	0
651.10	Sand	lb		50										50	69
651.13	Fertilizer	lb		250										250	575
651.25	Hay Mulch	ton		1										1	2.30

CURVE No. 1
 Δ 11° 35' Rt
 D 41'
 R 1432.40
 T 145.29
 L 209.59
 Bank .021 H/H

GUARD RAIL, THREE CABLE w/ LT. WOOD POSTS
 ITEM 621.22
 LT $\frac{21+75}{17+52-22+00}$ RT
 $30+44=32+00$ $21+00-22+50$

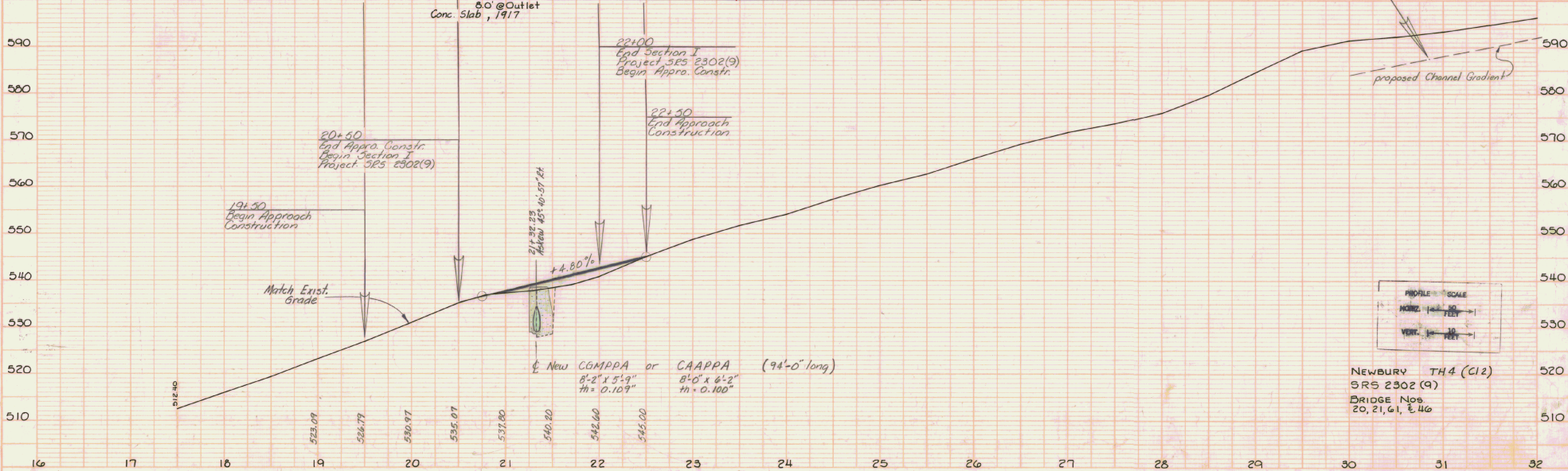
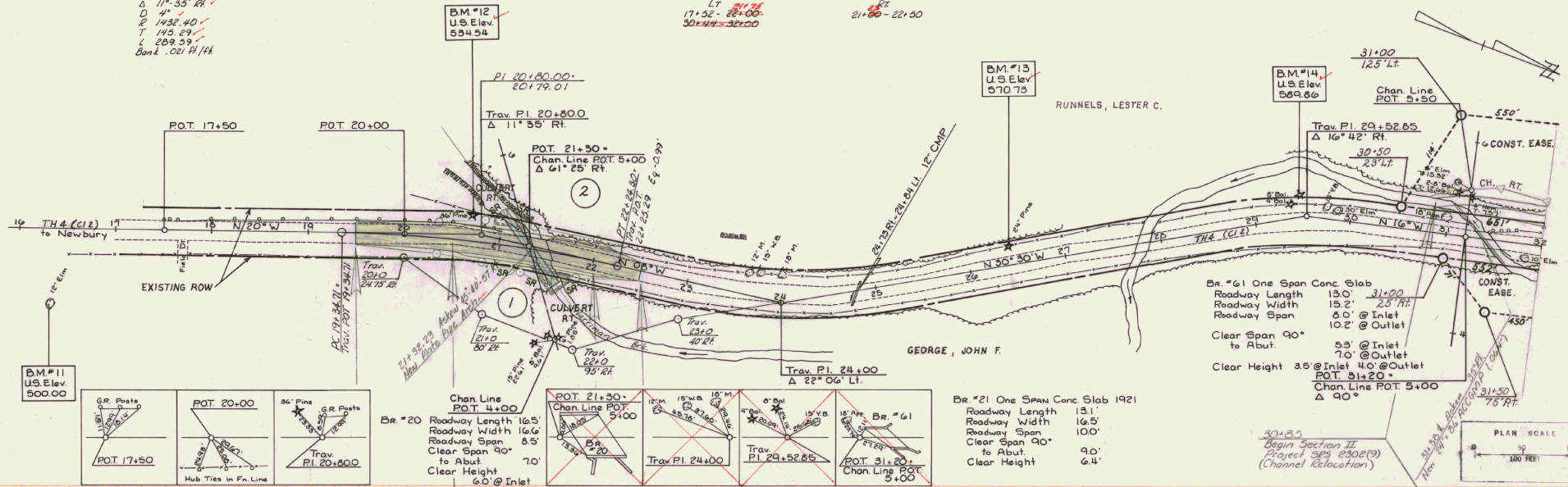

NEWBURY TH4 (C12)
 SRS 2302 (9)
 BRIDGE Nos.
 20, 21, 61, & 46

GUARD RAIL, THREE CABLE w/ LT WOOD POSTS
ITEM 60122 RT
LT
36+00-37+00

RUNNELS, LESTER C. (2)

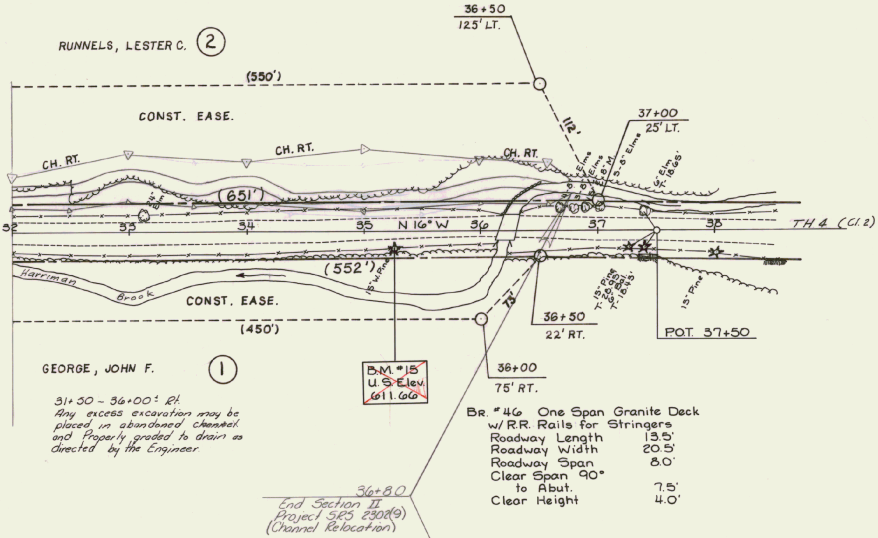

GEORGE, JOHN F. (1)
31+00 - 36+00' RT.
Any excess excavation may be placed in abandoned channel and properly graded to drain as directed by the Engineer.

36+80
End Section II
Project SRS 2302(9)
(Channel Relocation)

BR. #46 One Span Granite Deck
w/ R.R. Rails for Stringers
Roadway Length 13.5'
Roadway Width 20.5'
Roadway Span 6.0'
Clear Span 90'
to Abut.
Clear Height 4.0'

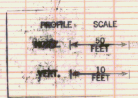
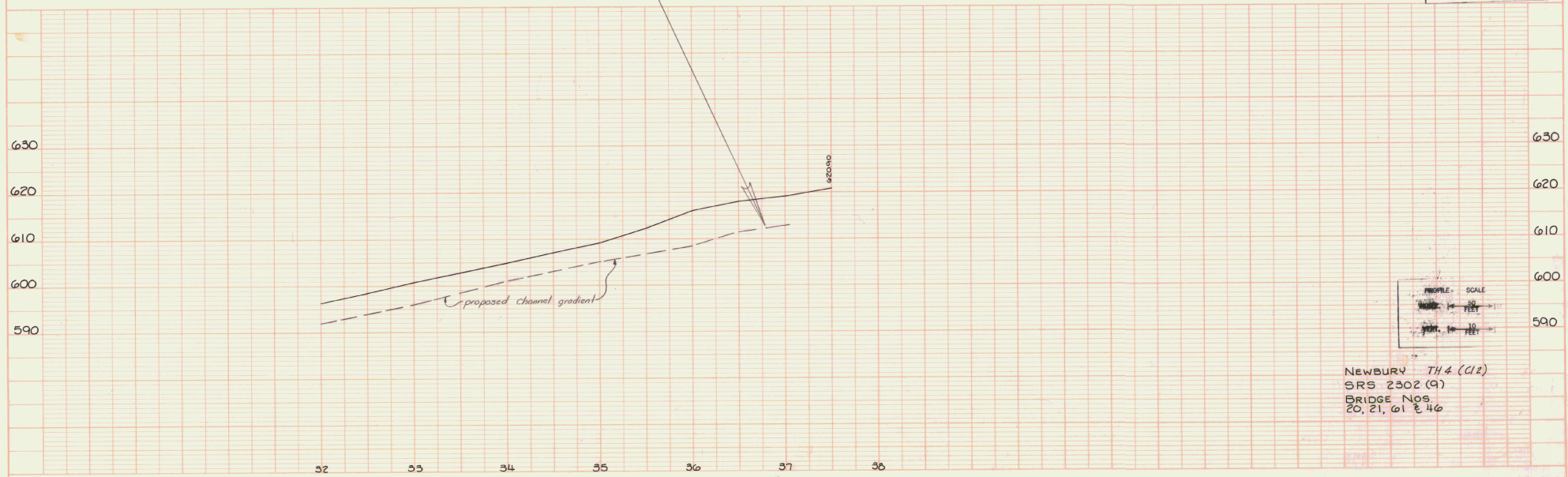
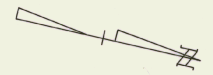

NEWBURY TH. 4 (C12)
SRS 2302 (9)
BRIDGE NOS.
20, 21, 61 & 46

PLAN
NOTE BOOK
10 1/2" x 14 1/2"
1/4" = 100 FEET
1/8" = 50 FEET
1/16" = 25 FEET
1/32" = 12 1/2 FEET
1/64" = 6 1/4 FEET

PROFILE
NOTE BOOK
10 1/2" x 14 1/2"
1/4" = 10 FEET
1/8" = 5 FEET
1/16" = 2 1/2 FEET
1/32" = 1 1/4 FEET
1/64" = 7/8 FEET

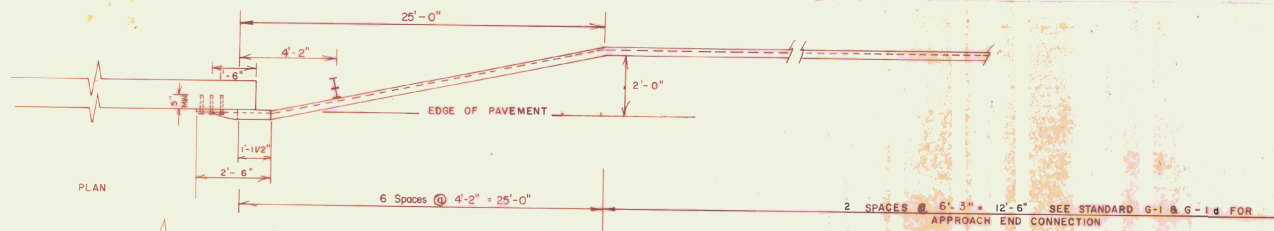

PLAN DETAIL OF GUARD RAIL
SCALE: NTS.

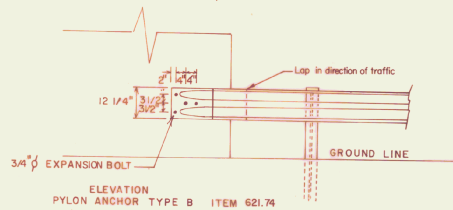

NOTE: STEEL BEAM RAILING TO BE INSTALLED ON EXISTING CONCRETE SURFACES SHALL BE DRILLED TO FIT IN THE FIELD AND ATTACHED WITH 3/4" Ø EXPANSION BOLTS. EXPANSION BOLTS (3/4" Ø) SHALL HAVE 5" (INCH) MINIMUM DEPTH OF EMBEDMENT INTO EXISTING CONCRETE AND SHALL BE CAPABLE OF AN ULTIMATE TENSILE STRENGTH EQUAL TO 18,000 LBS. MINIMUM. ALL BOLTS SHALL BE ASTM A 307 STEEL. SEE STANDARD G-1 POST WASHER A.

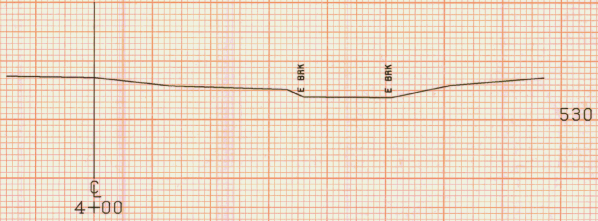
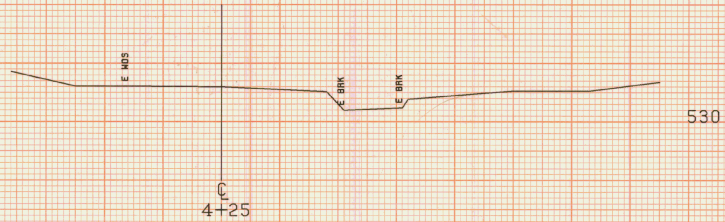
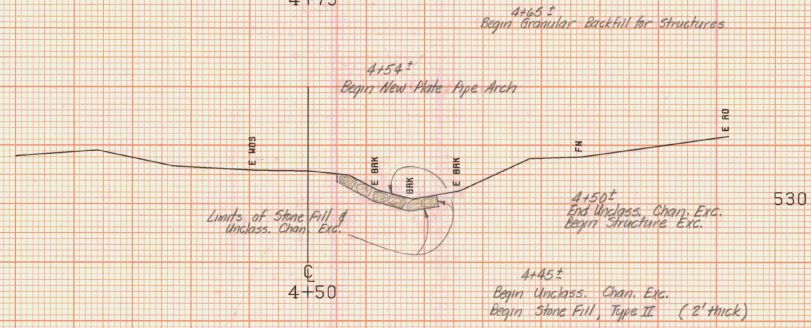
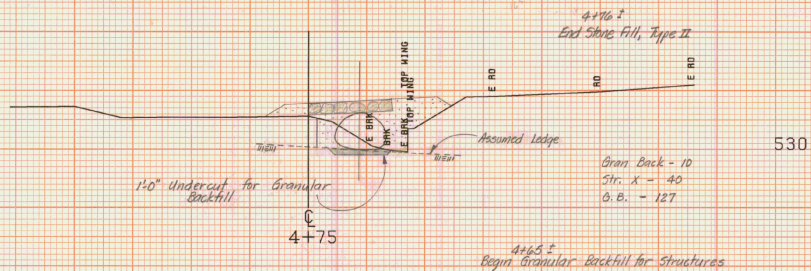

B20 CHANNEL SECTIONS

FROM STA. 4+00	TO STA. 4+75
PROJECT NAME	NEMBURY BR. NO. 30
NO.	SAS2302 (9)
SURVEYED BY	FALL
SHEET 19 OF 24 SHEETS	PLOTTED 04/15/75 APR 75

SCALE 1" = 10 FEET

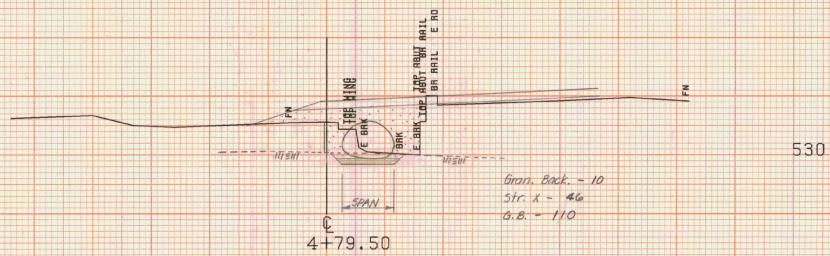
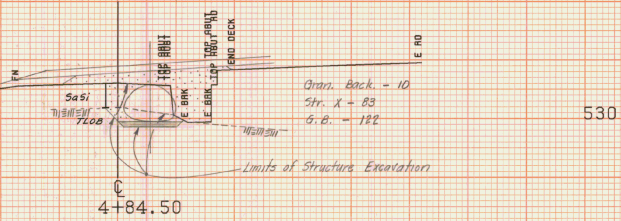
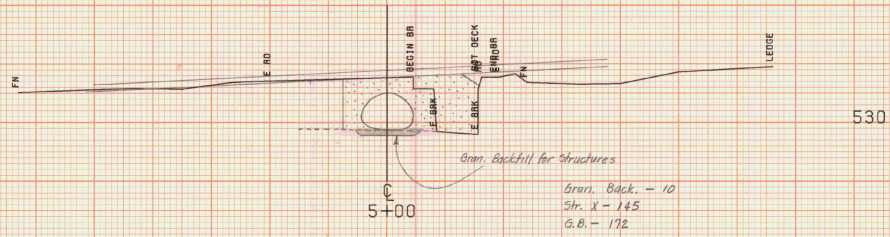
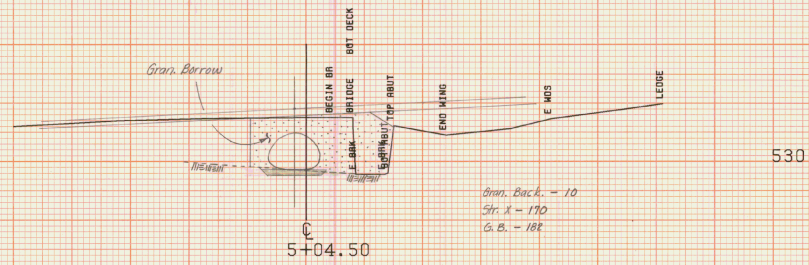

B20 CHANNEL SECTIONS

FROM STA. 4+79.50	TO STA. 5+04.50
PROJECT NAME	NEWBURY BR. NO. 30
NO.	SRS2302 (9)
SURVEYED BY	FALL
SHEET 14 OF 24 SHEETS	APR 75

SCALE 1/8" = 1' 0"

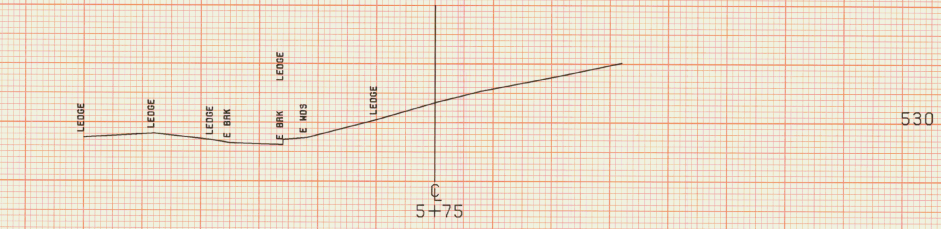

530

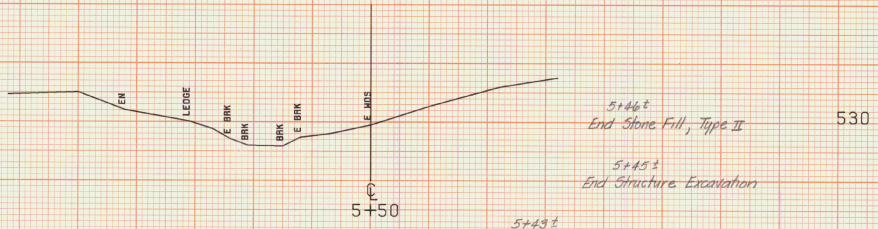

530

5+46±
End Stone Fill, Type II
5+45±
End Structure Excavation

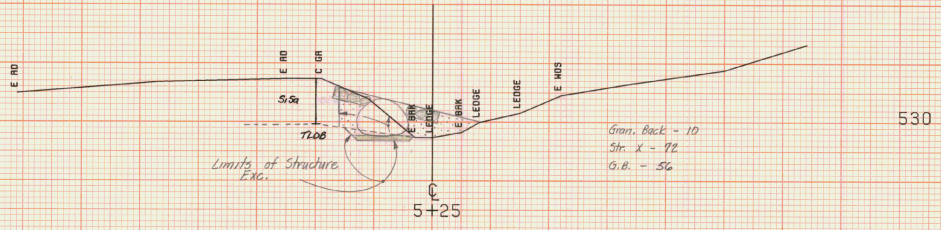

530

5+43±
End Plate Pipe Arch
End Granular Backfill for Structures
End Granular Borrow

Gran. Back - 10
Str. X - 92
G.B. - 56

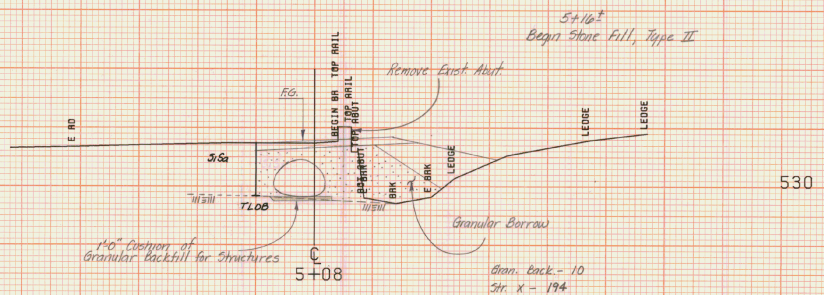

530

5+16±
Begin Stone Fill, Type II

Remove Excess Mast

Granular Borrow

Gran. Back - 10
Str. X - 194
G.B. - 200

140" Diameter of Granular Backfill for Structures

B20 CHANNEL SECTIONS

FROM STA. 5+08	TO STA. 5+75
PROJECT NAME	NEWBURY BR. NO. 20
NO.	SAS2302 (9)
SURVEYED BY	FALL
SHEET 10 OF 24 SHEETS	APR 75

SCALE 1/2" = 1' HORIZONTAL

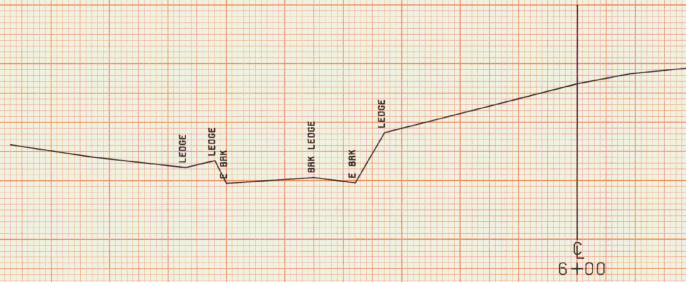

520

6+00

B20 CHANNEL SECTIONS

FROM STA. 6+00	TO STA. 6+00
PROJECT NAME	NEWBURY BR. NO. 20
NO.	SAS2302 (9)
SURVEYED BY	FALL
SHEET 10	OF 24 SHEETS
	PLOTTED 04/15/75
	APR 75

SCALE 1" = 10 FEET

TRAY
L

526.79 match exist grade

19+50

19+50
Begin Approach Construction

523.09
523.09

19+00

519.24

18+50

18+00

17+52
Begin Guard Rail, Three Cable
w/ 2 Wood Posts, Item 6212C

17+50

TRAY
L

520

520

510

510

510

T.H. 4

FROM STA. 17+50	TO STA. 19+50
PROJECT NAME	NEWBURY BR. NO. 20.21.61446
NO.	SAS2302 (9)
SURVEYED BY	FALL
SHEET 17	OF 24 SHEETS
	APR 75

SCALE 1" = 10 FEET

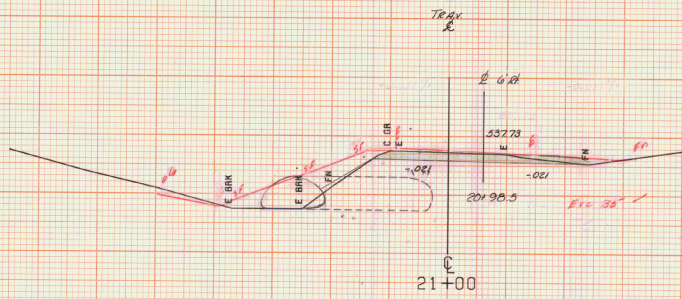

530

21+00 RL
Begin Guard Rail Three Cables w/
4 Wood Posts Item 42122

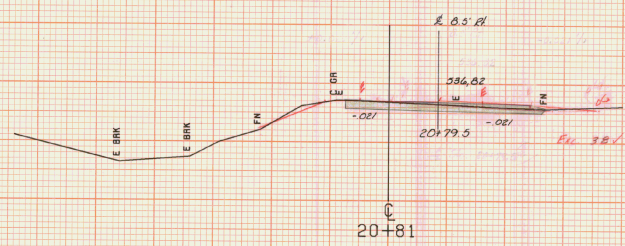

530

Excavation

Station	Dist.	Area	Vol. cu
20+30	20	0	13
20+60	30	36	62
20+81	31	30	26
21+00	19	35	16
21+25	25	0	97

97 cu yds. APR 1975

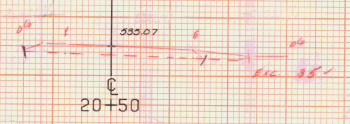

530

20+50
End Approach Construction
Begin Section I
Project 5RS 2302(9)

20+30
End Section

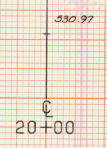

530

T.H. 4

FROM STA. 20+00 TO STA. 21+00
PROJECT NAME NEWBURY BR. NO. 20.21.61448
NO. SAS2902(9) PLOTTED 04/15/75
SURVEYED BY FALL APR 75
SHEET 13 OF 24 SHEETS

SCALE 1" = 10 FEET

PT 22+24.30
 Trk. P.O.T. 22+25.29 Eq. -0.99'
 D. 4° 21'
 Bank .021 H/ft

22+00 Lt.
 End Guard Rail, Three Cable w/
 Lt. Wood Posts, Nov 62/82

22+00
 End Section I
 Begin Approach Construction
 Project 5R5 2302(9)

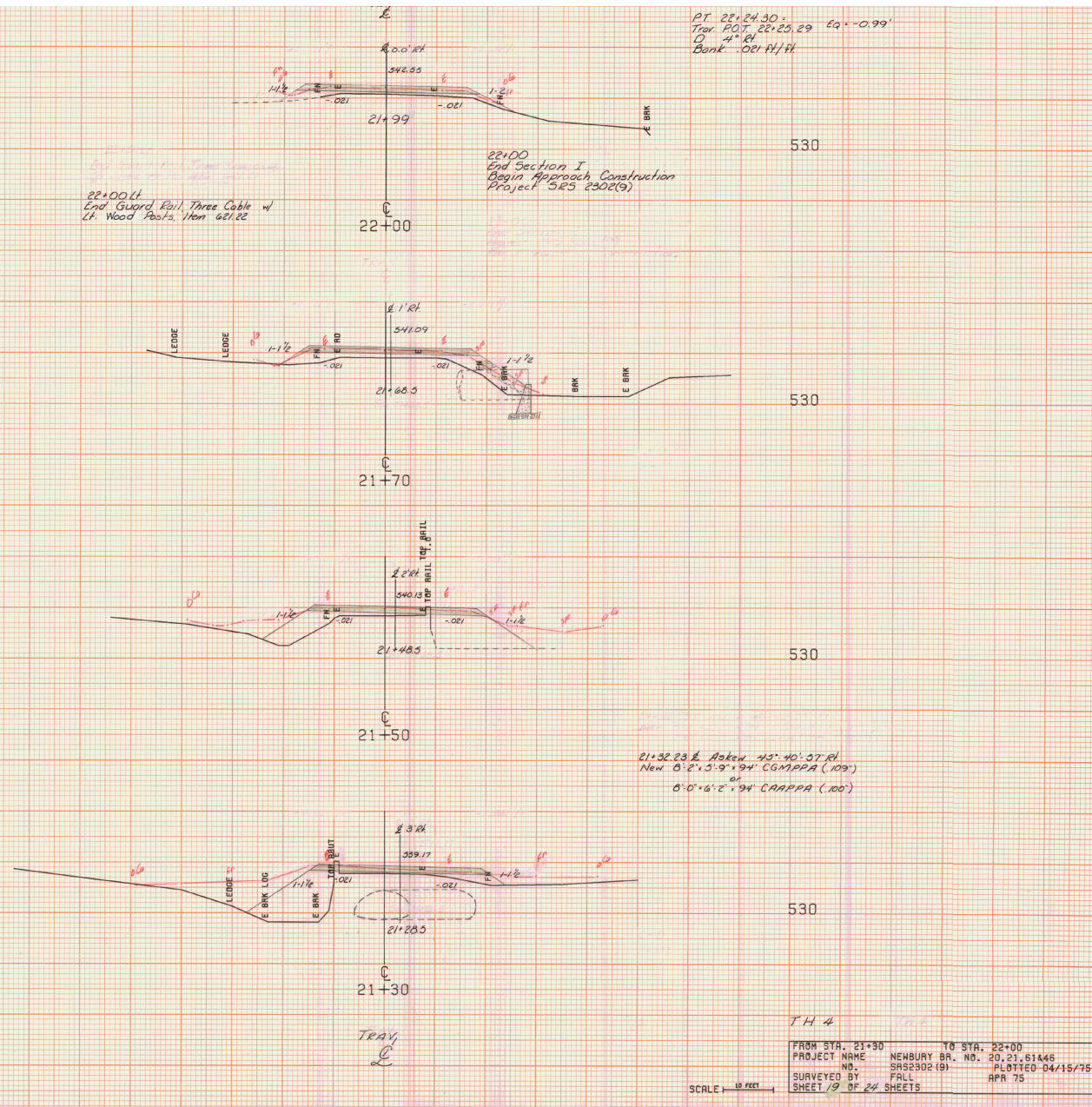

21+32.23 E Azken 45° 40' 37" Rt
 New B. 2' 3.9" 94' CGARPA (109)
 6' 0" 6' 2' 94' CARPA (100')

530

530

530

530

TH 4

FROM STA. 21+30	TO STA. 22+00
PROJECT NAME	NEMBURY BR. NO. 20, 21, 61446
NO.	SAS2302 (9)
SURVEYED BY	FALL APR 75
SHEET 19	OF 24 SHEETS

SCALE 1" = 10 FEET

TRAIL

24+50

550

24+00

550

23+50

550

23+00

540

22+50

540

TRAIL

22+50
End Approach Construction

0.00 match existing Grade

22+44 ft
End Guard Rail Three Cable w/
Lt. Wood Posts, Item 62122

TH 4

FROM STA. 22+50	TO STA. 24+50
PROJECT NAME	NEWBURY BR. NO. 20, 21, 61446
NO.	SRS2302 (9)
SURVEYED BY	FALL
SHEET 20	OF 24 SHEETS
	APR 75

SCALE 1" = 10 FEET

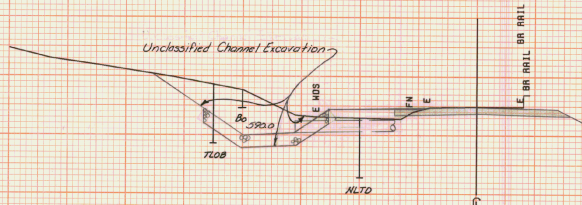

31+50

590

31+38.2 Asken 35° Pt.
New 24' x 06' ACCGMP (.064)

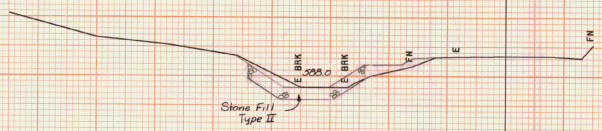

31+00

590

30+85
Begin Section II
Project S85-2302(9)
Channel Relocation

Excavation
Excavation
Excavation

30+44 ft
Begin Guard Rail Three Cable w/
4 Wood Posts, Item 82122

30+50

590

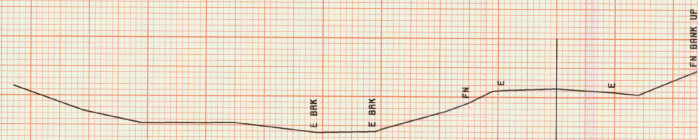

30+00

580

TH 4

FROM STA. 30+00	TO STA. 31+50
PROJECT NAME	NEWBURY BR. NO. 20.21.81446
NO.	S852302(9)
SURVEYED BY	FALL
SHEET 2	OF 24 SHEETS
	PLOTTED 04/15/75
	APR 75

SCALE 1" = 40 FEET

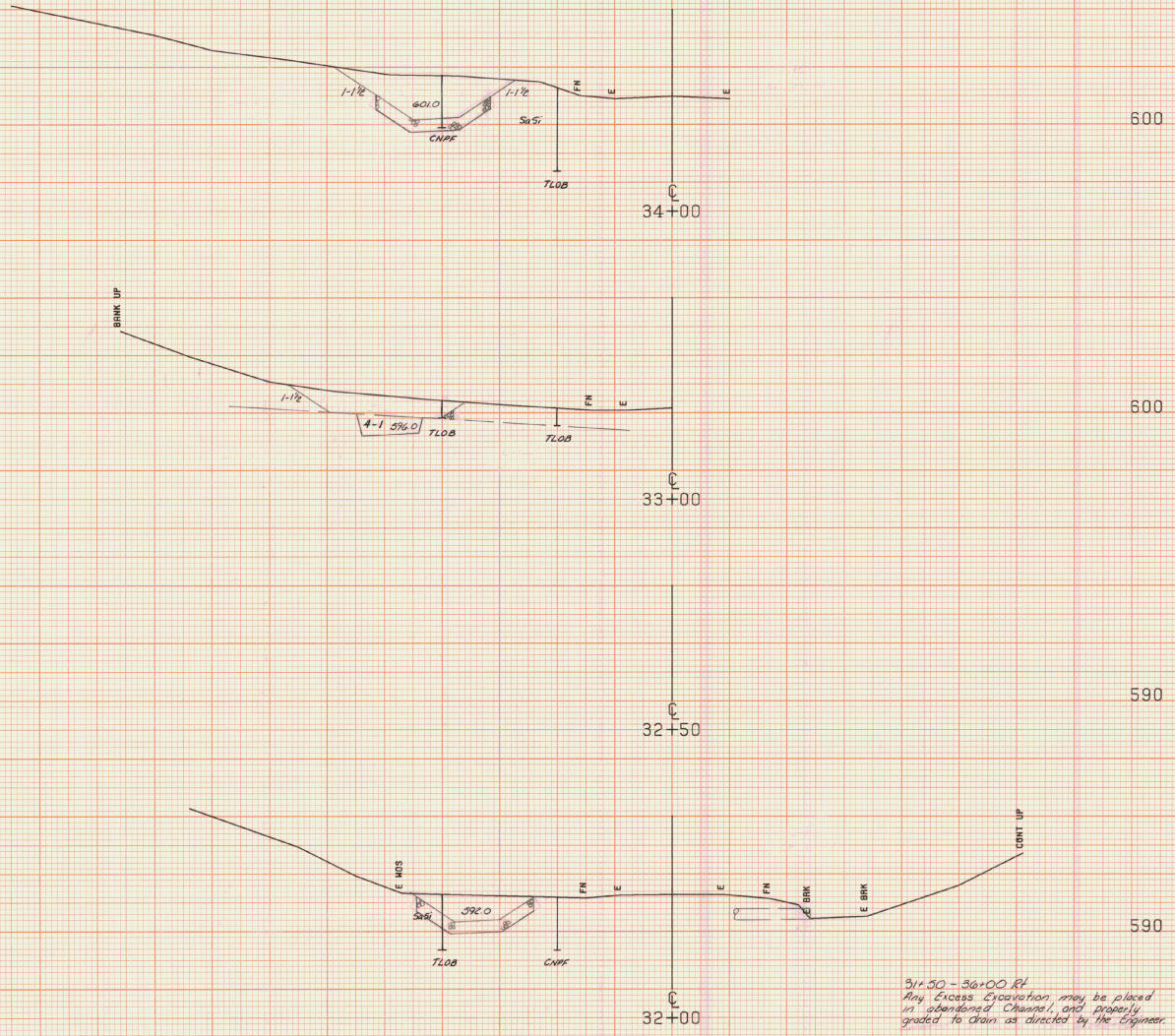

32+50 - 32+00 Rt
 Any Excess Excavation may be placed
 in abandoned Channel, and properly
 graded to drain as directed by the Engineer.

TH 4

FROM STA. 32+00	TO STA. 34+00
PROJECT NAME	NEWBURY BR. NO. 20, 21, 61446
NO.	SRS2902(9)
SURVEYED BY	FALL
SHEET 22	OF 24 SHEETS
	APR 75

SCALE 1" = 10 FEET

37+00 Lt
End Guard Rail, Three Cable w/
Lt. Wood Posts, Item 62122

36+80
End Section II
Project SPS 2302(9)
Channel Relocation

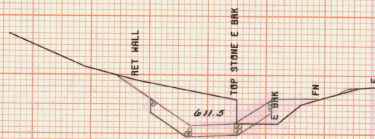

37+50

37+00

36+50

620

610

610

M

TRAY
①
②

TH 4

FROM STA. 36+50	TO STA. 37+50
PROJECT NAME	NEWBURY BR. NO. 20, 21, 61446
NO.	SP62902-10
SURVEYED BY	FALL
SHEET 24 OF 24 SHEETS	PLOTTED 04/15/75 APR 75

SCALE 1" = 10 FEET

- INDEX OF SHEETS
- TITLE SHEET
 - QUANTITY SHEET
 - PLAN AND PROFILE SHEETS
 - PLATE PIPE DETAILS
 - E-3 BRIDGE CONSTRUCTION APPROACH SIGNS
 - E-6 ON PROJECT CONSTRUCTION SIGNS
 - G-1 GUARD RAIL, STD. STEEL BEAM WITH STEEL POSTS, TYPE II
 - 9-12 CROSS SECTIONS-CHANNEL LINE AT 21+32.23
 - 13-20 CROSS SECTIONS-ROADWAY

STATE OF VERMONT DEPARTMENT OF HIGHWAYS



PROPOSED IMPROVEMENT

BRIDGE PROJECT

TOWN OF NEWBURY

COUNTY OF ORANGE

ROUTE NO. TH 4 (CLASS 2) BRIDGES No. 20, 61, 46

PROJECT LOCATION: BEGINNING ON TH 4, 0.9 MILES WEST OF THE INTERSECTION WITH U.S. 6 AND PROCEEDING WESTERLY ALONG TH 4 FOR 0.3 MILES.

PROJECT DESCRIPTION: SECTION I - REPLACE B-20 WITH A NEW PLATE PIPE ARCH.
SECTION II - RELOCATE HARRIMAN BROOK FROM STA. 30+85 TO 36+80, ELIMINATING B-61 & B-46.

SECTION I ROADWAY 150 FEET = 0.028 MILES
SECTION II CHANNEL 595 FEET = 0.113 MILES

R.O.W. PLANS

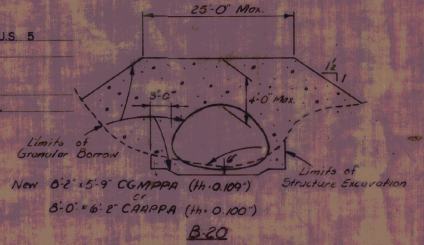
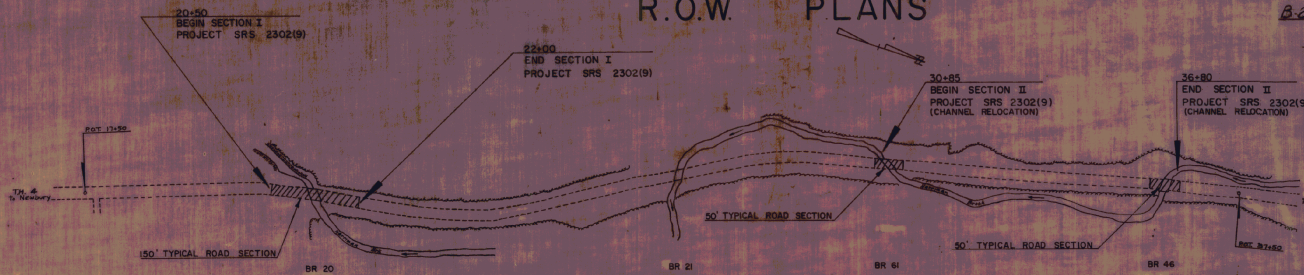

TYPICAL BRIDGE SECTION
Not to Scale

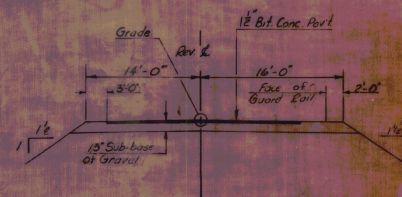

TYPICAL ROADWAY SECTION
Not to Scale

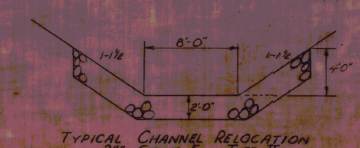

- CONVENTIONAL SIGNS
- COUNTY LINE
 - TOWN LINE
 - LIMITS OF ACCESS
 - POINT OF ACCESS
 - FENCE LINE
 - STONE WALL
 - TRAVELLED WAY
 - GUARD RAIL
 - RAILROAD
 - SURVEY LINE
 - CULVERT
 - POWER POLE
 - TELEPHONE POLE
 - TREES
 - F.A. CONST. IDENTIFICATION SIGNS
 - PROPERTY LINE
 - FLOW TAKING LINE
 - SLOPE RIGHTS LINE
 - TOP OF CUT
 - TOE OF SLOPE

TRAFFIC DATA

1975 ADT	115	1985 ADT	145
1975 DHV	25	1985 DHV	35
D%	55		
T%	6		
V	35 MPH		

ACCIDENT DATA, 5 YEAR PERIOD I

SUBMITTED BY ORDER OF THE STATE HIGHWAY BOARD

APPROVED: *E.H. O'Rourke* DATE 7-1-76
CHIEF ENGINEER

APPROVED: *Wm. J. Bell* DATE 7-1-76
ASSISTING CHIEF ENGINEER

NEWBURY
PROJECT SRS NY 2302(9)

SHEET 1 OF 3 SHEETS

25

POOL QUALITY

CURVE NO. 1
 Δ 11° 35' RT
 D 41'
 P 1432.40
 L 143.29
 T 209.99
 Bcrl. 02' 11.14'

GUARD RAIL, THREE CABLE W/ LT STEEL POSTS
 ITEM 621.21

B.M.#12
 U.S. Elev
 554.54

LT RT
 17+52 - 22+00 21+00 - 22+50
 30+44 - 32+00

PARCEL NO. 1 GEORGE, JOHN F.
 STA. 20+50 RT. - STA. 22+00 RT. (T) (700 S.F.)
 STA. 21+72 RT. CULVERT RT. (P)
 STA. 31+00 RT. - STA. 36+50 RT. CONST. EASE. (T) (0.57A2)
 RECORDED: WDCE DATED 11/2/76 BK. 59, PG. 267-288

B.M.#13
 U.S. Elev
 570.73

PARCEL NO. 2 RUNNELS, LESTER C.
 STA. 20+80 LT. - STA. 21+40 LT. SLOPE RT. (T) (225 S.F.)
 STA. 21+00 LT. CULVERT (P)
 STA. 30+50 LT. - STA. 37+00 LT. CONST. EASE. (T) (1.1A2)
 STA. 30+85 LT. - STA. 36+80 LT. CHANNEL RT (P) (0.5A2)
 RECORDED: WDCE 10/22/76 BK. 59, PG. 279-80

B.M.#14
 U.S. Elev
 559.86

RUNNELS, LESTER C.

31+00
 125' LT.
 Chan Line
 POT 5+50

PLAN
 DATE BOOK
 DRAWN BY
 CHECKED BY
 IN CHARGE

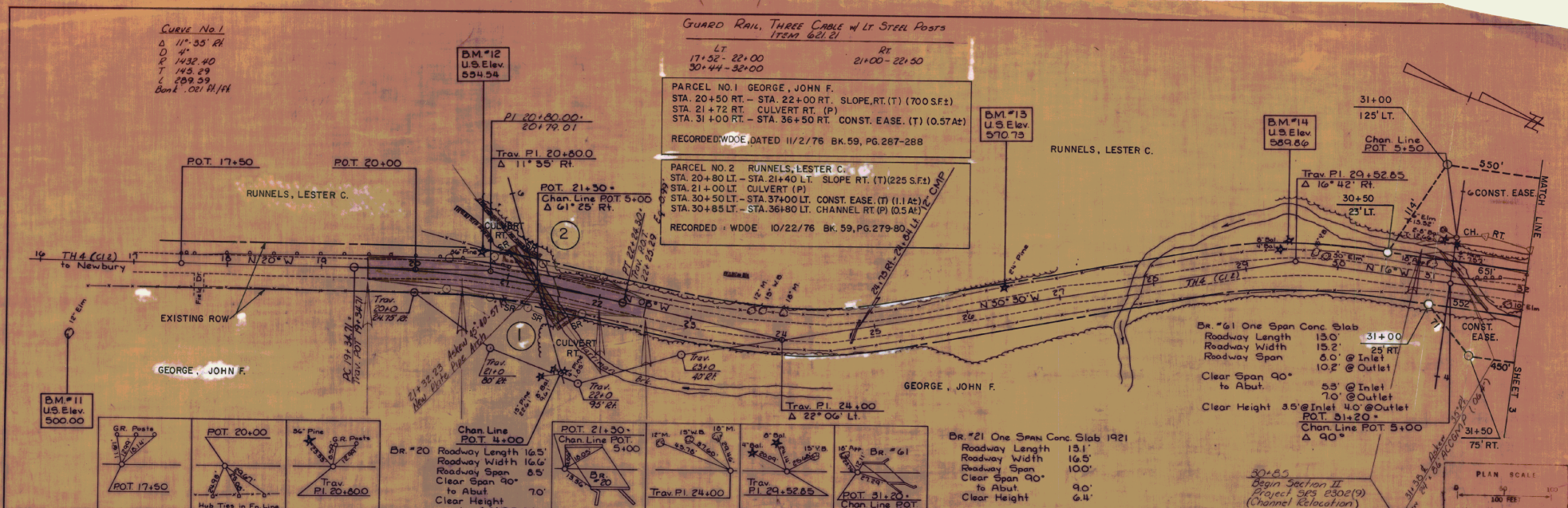

BR #61 One Span Conc Slab
 Roadway Length 150'
 Roadway Width 152' @ 25 RT
 Roadway Span 40' @ Inlet
 Clear Span 90' to Abut.
 Clear Height 53' @ Inlet
 70' @ Outlet
 35' @ Inlet 40' @ Outlet
 POT 31+20
 Chan Line POT 5+00
 Δ 90°

BR #21 One Span Conc Slab 1921
 Roadway Length 131'
 Roadway Width 100'
 Clear Span 90' to Abut.
 90'
 Clear Height 6.4'

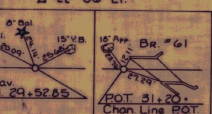
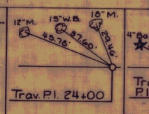
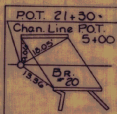

PLAN SCALE
 1" = 100 FEET

PROFILE
 DATE BOOK
 DRAWN BY
 CHECKED BY
 IN CHARGE



26

NEWBURY TH 4 (CL2)
 SRB 2302 (9)
 BRIDGE Nos.
 20, 21, 61, & 46

PLAN
 SHEET NO. 27
 PROJECT NO. SRS 2302(9)
 BRIDGE NOS. 20, 21, 40 & 46
 DATE: 11/25/58
 DRAWN BY: J. B. BROWN
 CHECKED BY: A. B. BROWN
 IN CHARGE: J. B. BROWN

PROFILE
 SHEET NO. 27
 PROJECT NO. SRS 2302(9)
 BRIDGE NOS. 20, 21, 40 & 46
 DATE: 11/25/58
 DRAWN BY: J. B. BROWN
 CHECKED BY: A. B. BROWN
 IN CHARGE: J. B. BROWN

GUARD RAIL, THREE CABLE W/ LT STEEL POSTS
 ITEM 621.21
 Rt
 32+00 - 37+00

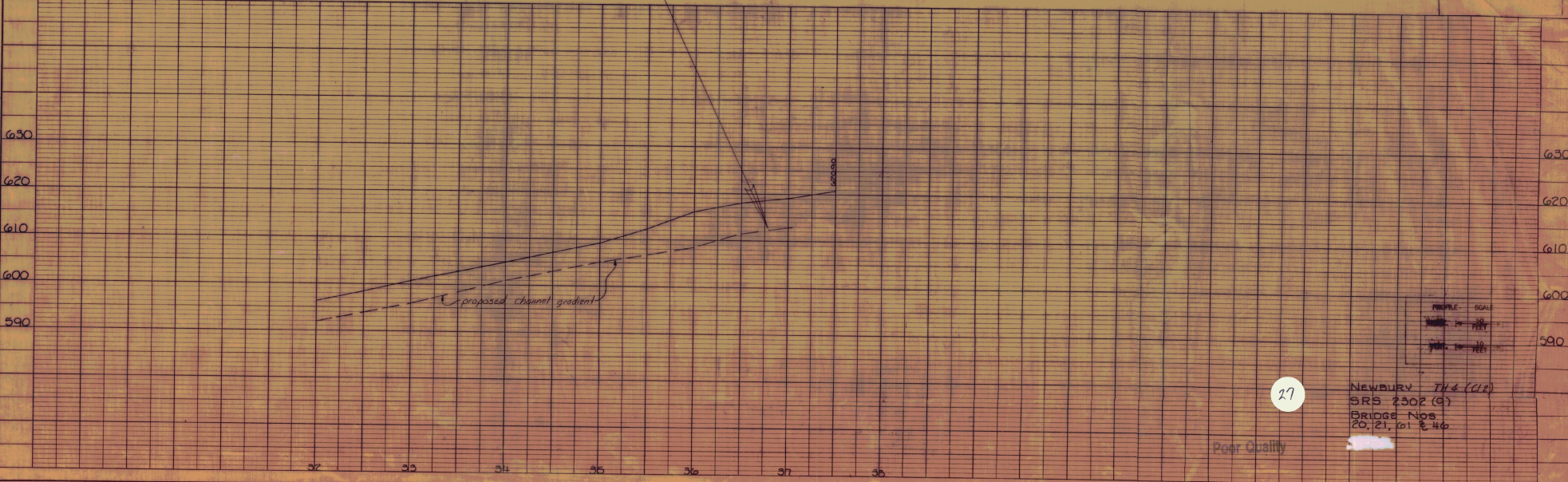
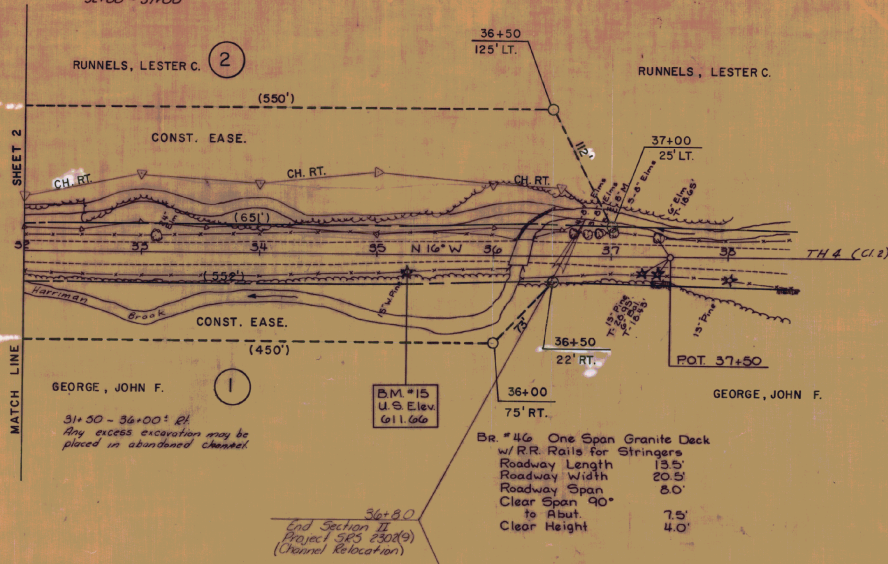

BR. # 46 One Span Granite Deck
 w/ RR Rails for Stringers
 Roadway Length 13.5'
 Roadway Width 20.5'
 Roadway Span 8.0'
 Clear Span 9.0'
 to Abut. 7.5'
 Clear Height 4.0'

GEORGE, JOHN F. (1)
 31+50 - 36+00' Bl.
 Any excess excavation may be
 placed in abandoned channel.

36+80
 End Section II
 Project SRS 2302(9)
 (Channel Relocation)

27

NEWBURY TH & (C12)
 SRS 2302(9)
 BRIDGE NOS.
 20, 21, 40 & 46

Peer Quality