

80+77L ~ 81+02L  
Remove & Reset Guard Rail

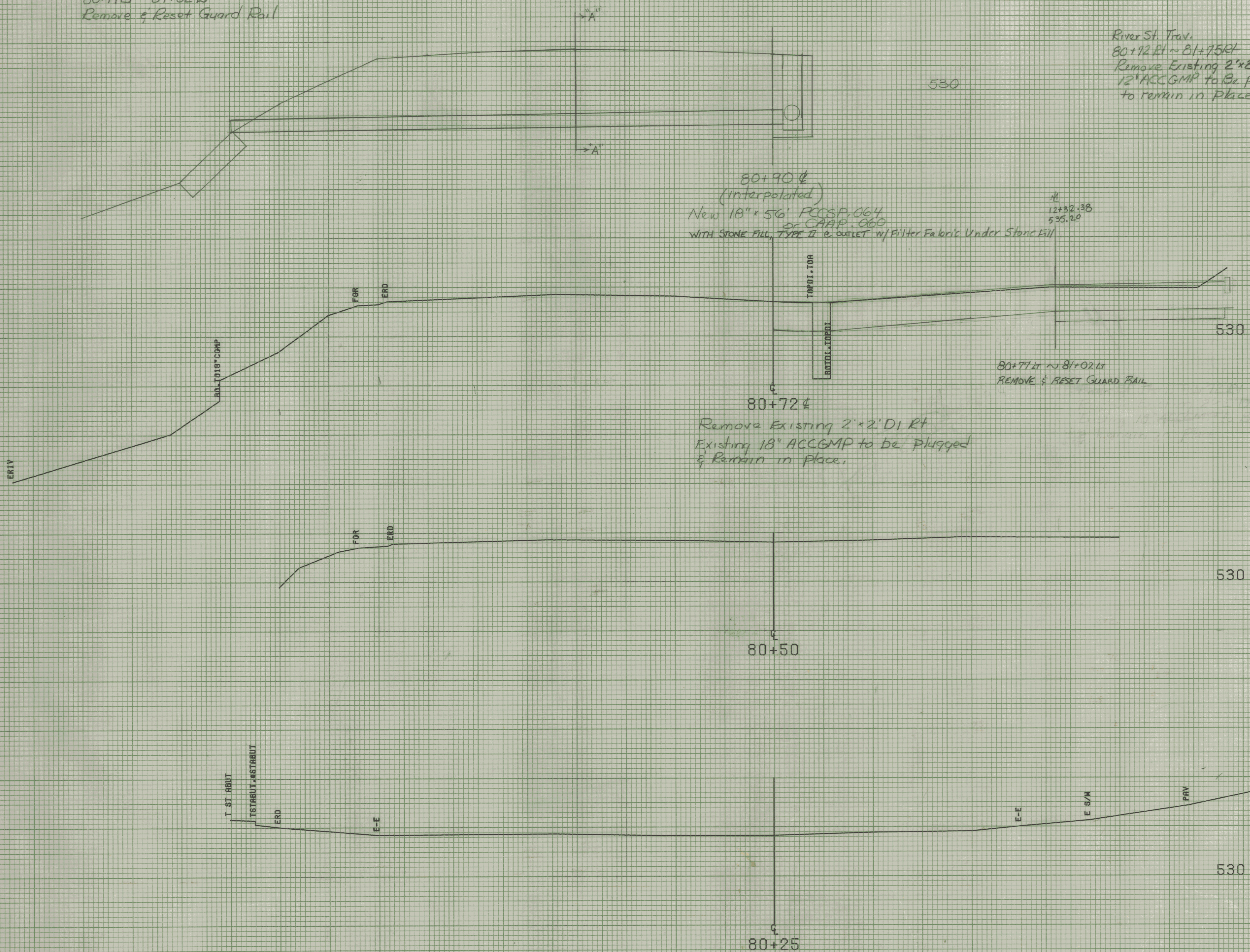

River St. Trav.  
80+72 Rt ~ 81+75 Rt  
Remove Existing 2'x2' DI  
12" ACCGMP to be plugged and  
to remain in place.

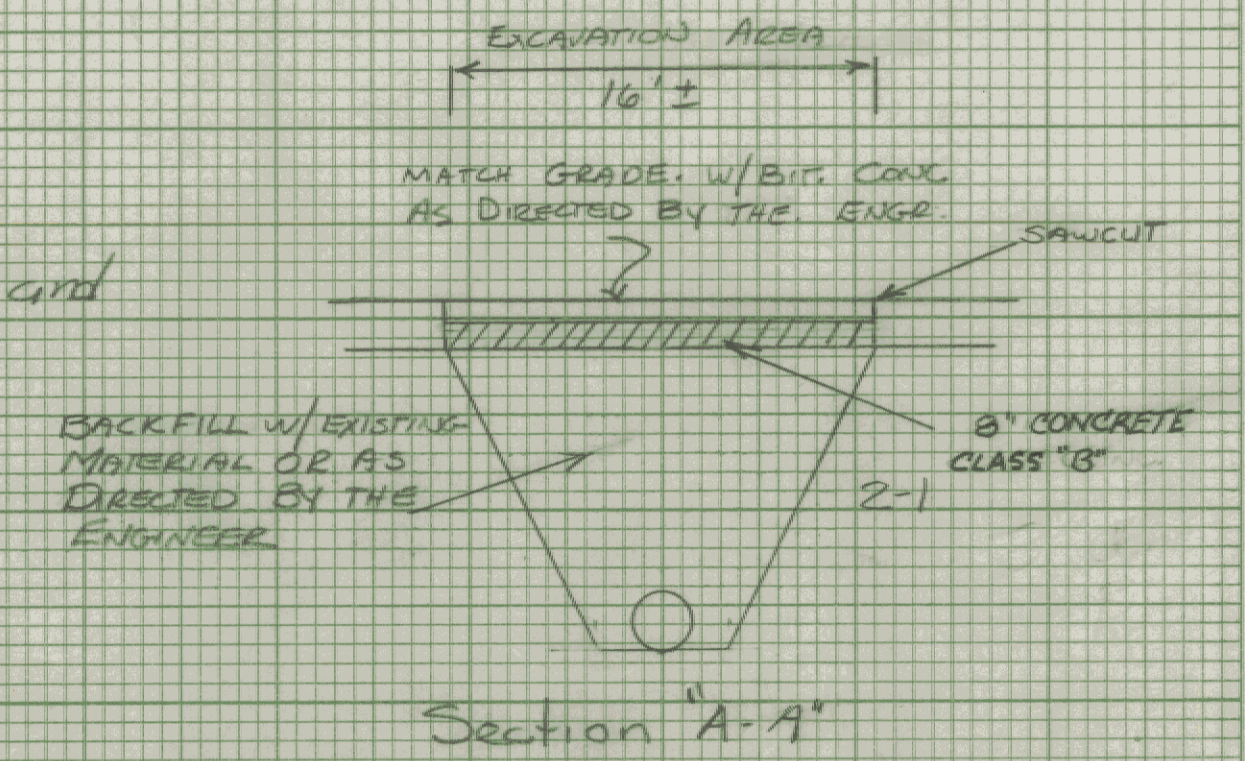

NOTE: PAYMENT FOR REMOVAL OF EXISTING CONCRETE PAVEMENTS WILL BE UNDER ITEM 203-16 SOLID ROCK EXCAVATION. PAYMENT FOR SAWCUTS WILL BE SUBSIDIARY TO THAT ITEM. PAYMENT FOR REPLACEMENT PORTLAND CEMENT CONCRETE WILL BE PAID AS CONCRETE CLASS "B" AND REINFORCING STEEL SEE SHEET 150 FOR DETAILS OF REPAIRING P.C. PAV. AREA IS 4057 E.

River St. Traverse

FROM STA.	80+25	TO STA.	80+72
PROJECT NAME	MONTPELIER		
NO.	M6400(7)		
SURVEYED BY	KASNER-MOREAU JUNE 1985		
SHEET	242	OF	335 SHEETS

SCALE 5 FEET