

Rev 63+90LT  
Construct Paved Walk (5' Wide)  
To Be Paid as Bit. Conc. Sidewalk

Rev. 63+86 Rt.  
Begin Vertical Granite Curb

815

Section "A-A"

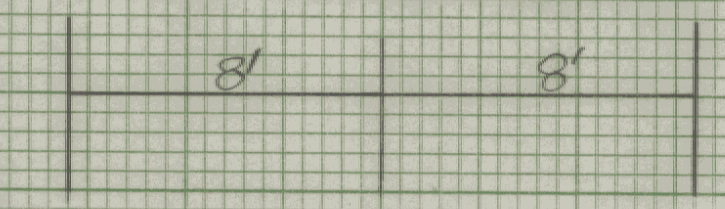

Rev. 63+76 Rt  
CONSTRUCT DRIVE 16' WIDE (GRAVEL)

820

Rev. 63+66 Rt.  
End Vertical Granite Curb

Rev. PC. 63+65.72  
Dc = 12° 18' 00"

No BANKING

63+60 RT  
End New 18" x 12" PCCSP. 064  
or CAPP. 060

Begin New 18" x 12" PCCSP. 064  
or CAPP. 060

Connect Existing 8" Plastic Drain Pipe  
To Drop Inlet @ 63+60 RT

63+68 ~ 64+83 Rt.  
Deciduous Tree  
1/2" to 2" Flowering  
Dogwood

Tree to be planted out-  
side of R.O.W. in a location  
which is mutually agree-  
able with the property  
owner and the resident  
engineer

63+47 Rt  
Begin Vertical Granite Curb

63+31 Rt.

Exist. Sewer Manhole (Retain)  
Adjust Elev. of Manhole  
Non-Gov't. Part.

FROM STA. 63+50	TO STA. 63+89
PROJECT NAME	MONTPELIER MAIN7
NO. M.E.C. H6400(7)	PLOTTED 08/07/85
SURVEYED BY	KASTNER-MOREAU JUNE 1985
SHEET 23	OF 335 SHEETS

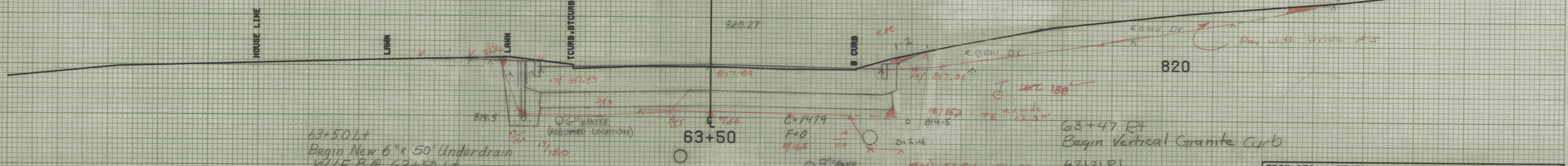
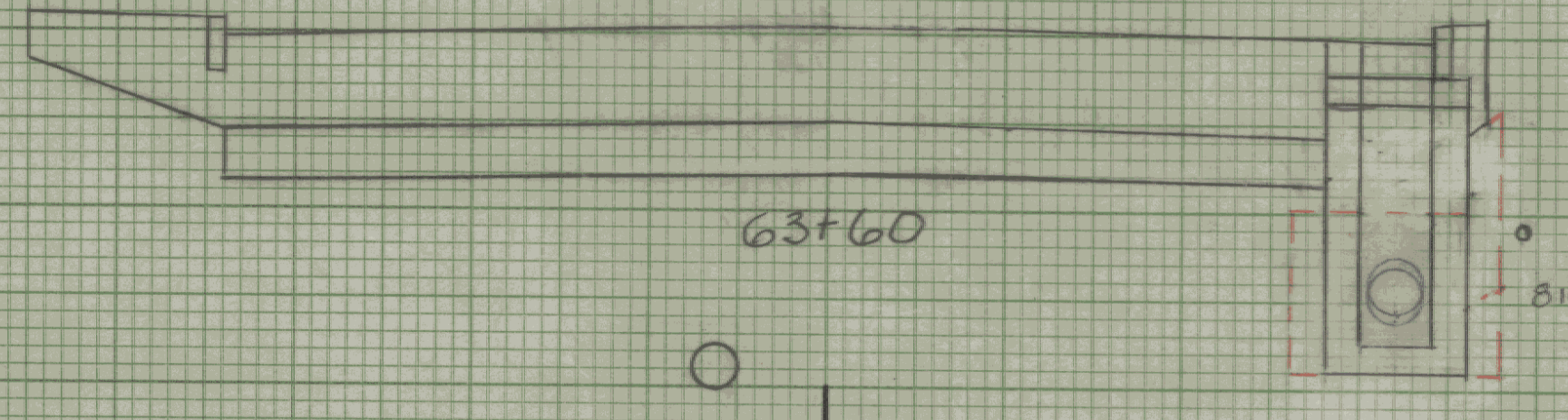
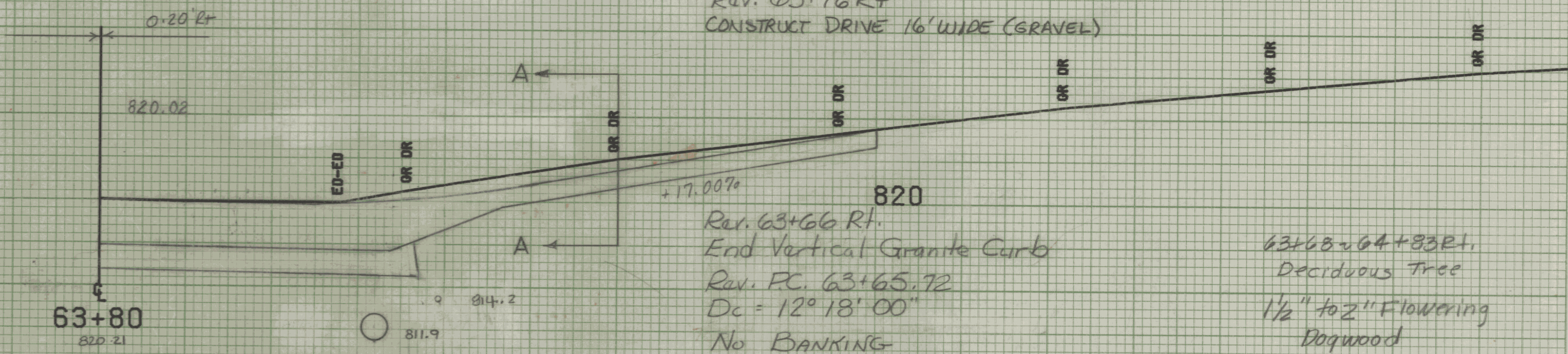
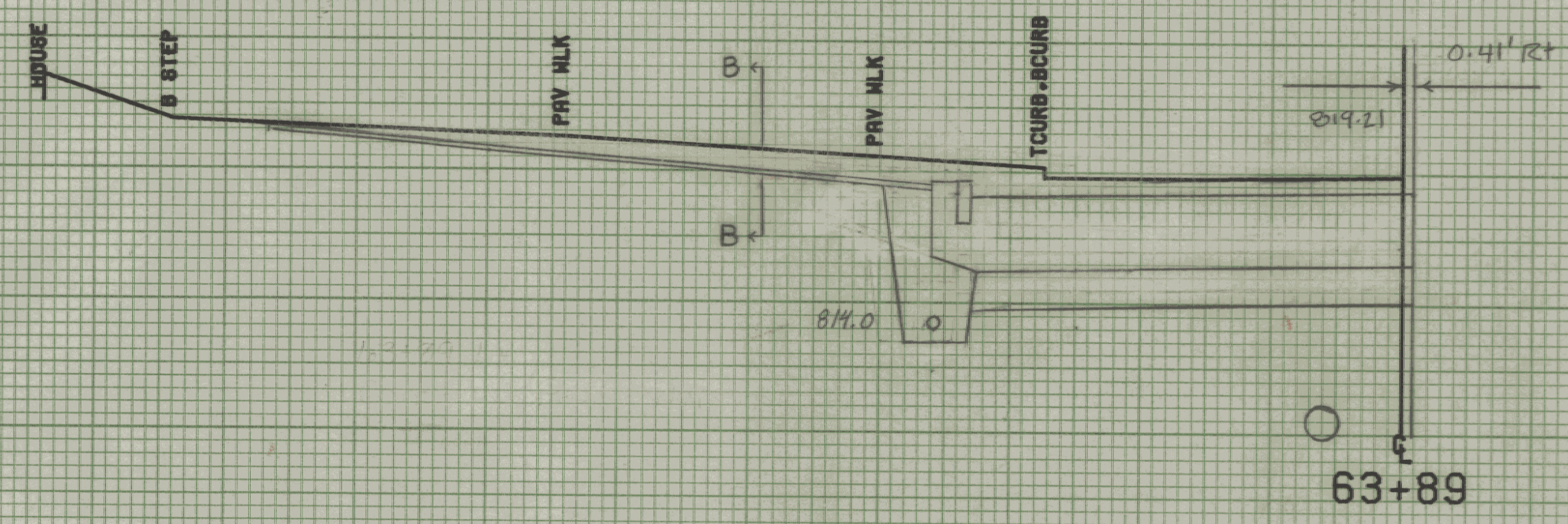
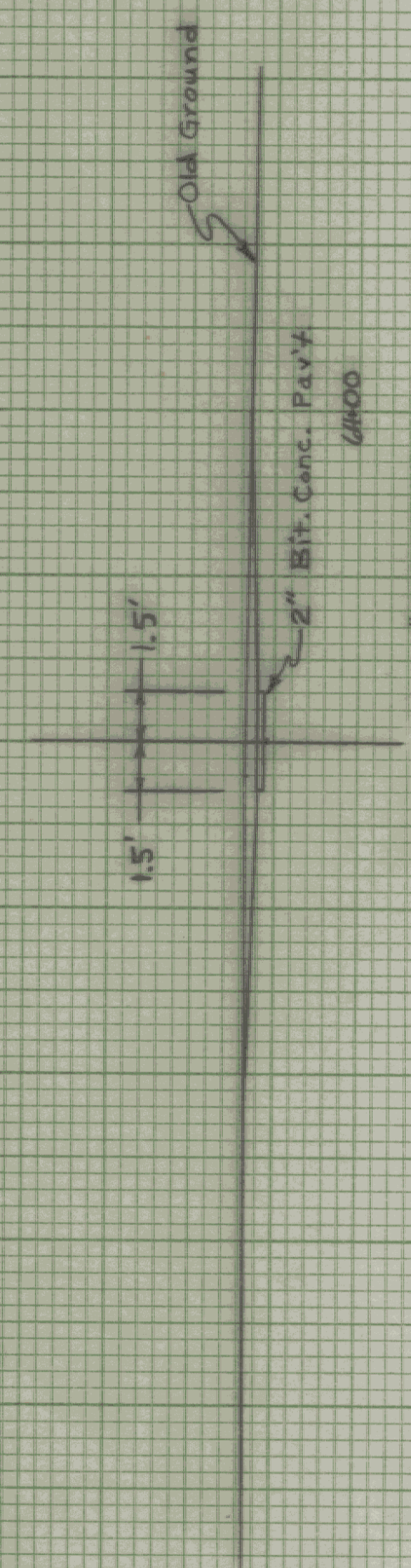

63+50 LT  
Begin New 6" x 50' Underdrain  
W/F.B @ 63+50 Lt.

8" SEWER  
(RESUMED LOC.)

SCALE 1/8" = 1 FOOT