

SECTION 'AA'

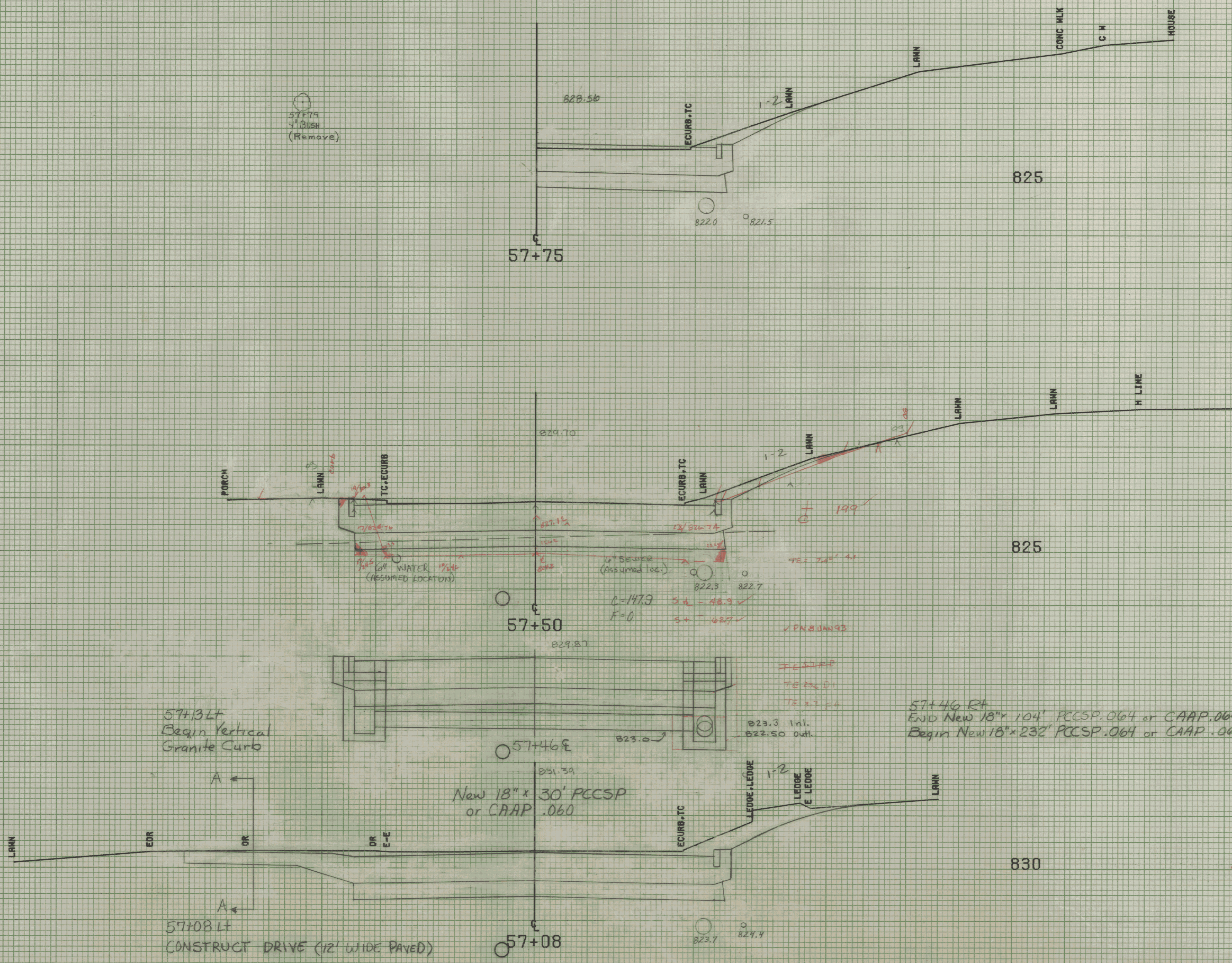
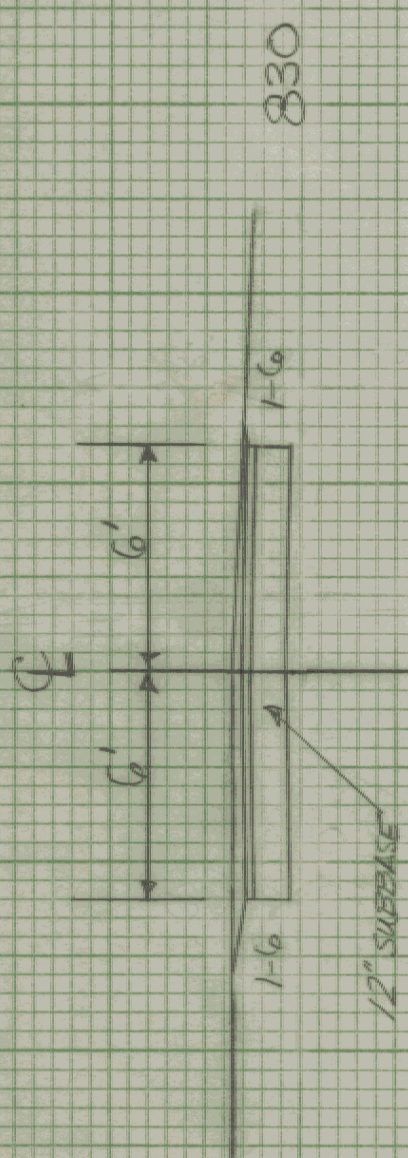

57+75  
4' BRUSH  
(Remove)

57+75

825

57+50

825

57+46 E

57+46 RT  
END New 18" x 104' PCCSP.064 or CAAP.060  
Begin New 18" x 232' PCCSP.064 or CAAP.060

57+08

830

57+08 LT  
CONSTRUCT DRIVE (12' WIDE PAVED)

FINISH - C.P. LARK 11-30-93

FROM STA. 57+08 TO STA. 57+75  
 PROJECT NAME MONTPELIER MAIN7  
 NO. MEGS M6400(7) PLOTTED 08/07/85  
 SURVEYED BY KASTNER-MOREAU JUNE 1985  
 SHEET 226 OF 335 SHEETS

SCALE 1" = 5 FEET

New gully relocated