

Note: The two stone walls located between Sta. 48+45RT± and Sta. 49+45RT± which will be removed during the Construction period are to be reset as follows: The section presently located between 49+27RT± and 49+45RT± will be relocated at approximately the same stations on the westerly edge of the new drive at 49+60RT. The section presently located between sta. 48+45RT± and 49+00RT± will be relocated westerly of the construction limits, between the same stations. Payment for removing and resetting the wall will be under item 602.20, Dry Rubble Masonry, and shall be Non-Gov't. Participating.

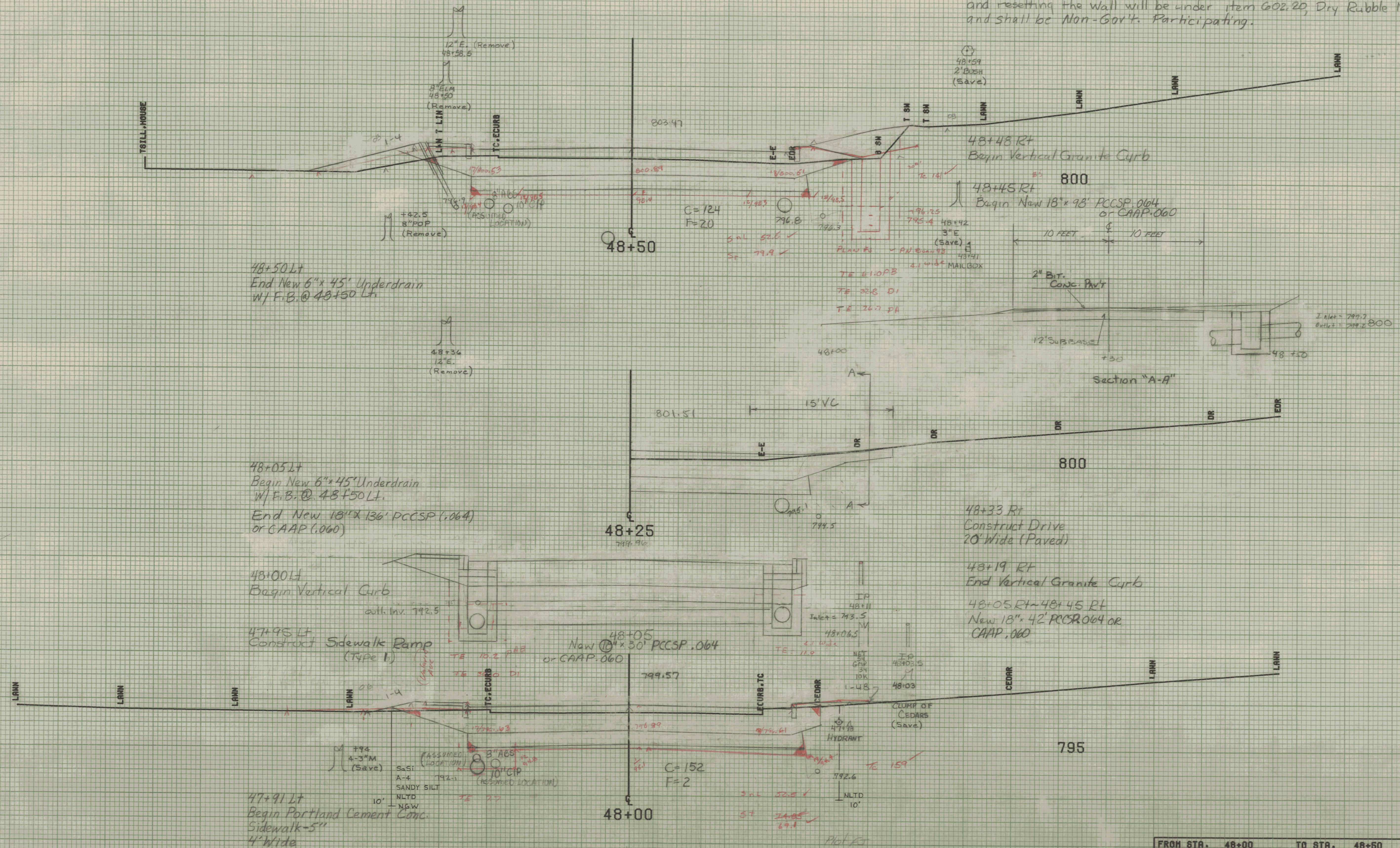

48+50 Lt
End New 6" x 45' Underdrain
w/ F.B. @ 48+50 Lt.

48+05 Lt
Begin New 6" x 45' Underdrain
w/ F.B. @ 48+50 Lt.
End New 18" x 136' PCCSP (.064)
or CAAP (.060)

48+00 Lt
Begin Vertical Curb
with Inv. 792.5
47+95 Lt
Construct Sidewalk Ramp
(Type 1)

47+91 Lt
Begin Portland Cement Conc.
Sidewalk - 5"
4" Wide

48+33 Rt
Construct Drive
20' Wide (Paved)

48+19 Rt
End Vertical Granite Curb
48+05 Rt - 48+45 Rt
New 18" x 42' PCCSP (.064) or
CAAP (.060)

FROM STA. 48+00 TO STA. 48+50
PROJECT NAME MONTPELIER MAINS
NO. MEG-6400(7) PLOTTED 06/07/85
SURVEYED BY KASTNER-MOREAU JUNE 1985
SHEET 213 OF 335 SHEETS

SCALE 5 FEET

Plan of 12/14/83