

TEMPORARY 4" YELLOW LINE

45+00~47+45 CL (DBL.)
47+85~51+00 CL (DBL.)

4" YELLOW LINE

45+00~47+45 CL (DBL.)
47+85~51+00 CL (DBL.)
SL 30+29~30+48 CL (DBL.)

4" WHITE LINE

45+00~51+00, 11' RT.
45+00~47+25, 11' LT.
47+25, 11' LT. ~ 47+45, 16' LT. (25'R)
47+88, 16' LT. ~ 48+03, 11' LT. (25'R)
48+03~51+00, 11' LT.

TEMPORARY LETTER OR SYMBOL

SL 30+33~30+41 LT. "STOP"

DURABLE LETTER OR SYMBOL

✓ SL 30+33~30+41 LT. "STOP"

DURABLE CROSSWALK W/ DIAGONAL LINES (6')

✓ 47+42~47+92, 17' TO 23' LT. (5')

REMOVING SIGNS

7-2-EA.

REMOVING SIGNS (MOD.)

✓ 1EA.

DURABLE 24" STOP BAR

SL 30+27~30+29 CL TO 15' LT. (15')

DURABLE 4" WHITE LINE

45+00 ~ 51+00 LT & RT
VALERIE AVENUE (120')

DURABLE 4" YELLOW LINE

45+00 ~ 51+00 CL
VALERIE AVENUE (88')

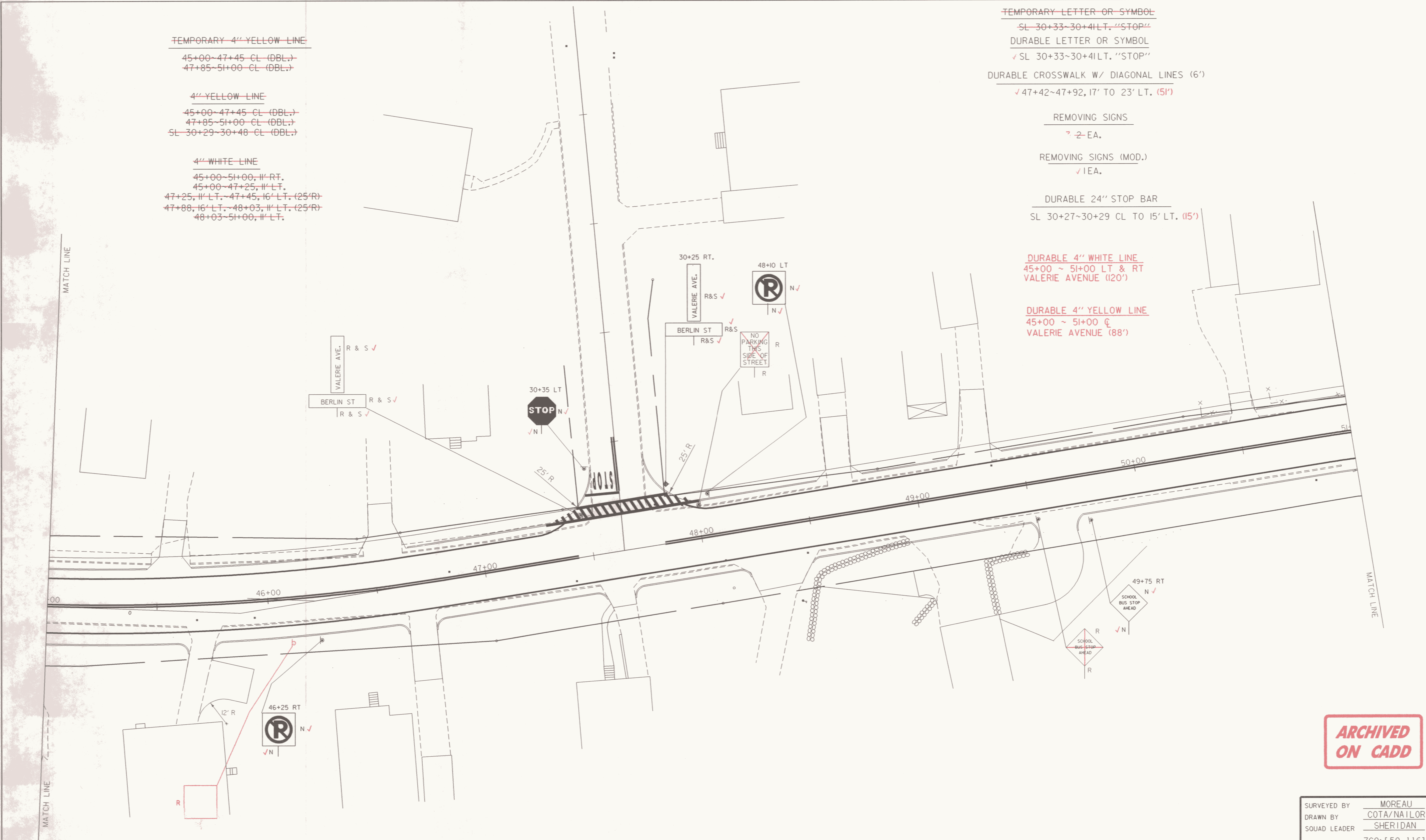

**ARCHIVED
ON CADD**

DATUM
VERTICAL NGVD 1929
HORIZONTAL A

SURVEYED BY	MOREAU	DATE	7-85
DRAWN BY	COTA/NAILOS	DATE	4-88
SQUAD LEADER	SHERIDAN		
DESIGN FILE NO.	ZG0: [50, 116] PETED. DGN; 1		
IPARM FILE	PETEDS7.PRF	DATE PLOTTED	20-FEB-1996
PROJ. NAME	MONTPELIER		
PROJ. NO.	MEGC M 6400(7)		
SHEET	119	OF	355 SHEETS