

Rev.	Description	By	Date
1	HYDRANT 34+85	LBL	1/5/89

CITY OF MONTPELIER  
BERLIN STREET RESTORATION  
WATER MAIN INSTALLATION PLAN  
STA. 33+00 TO STA. 39+00

MONTPELIER, VERMONT

<b>DH</b> Dufresne-Henry Inc. 55 East State Street Montpelier, VT 05602	Client No.	618040	
	Proj. Manager	T.D. NESBITT	
	Proj. Designer	L.B. LACEY	
	Drawn By	K.G. FLAUNDERS	
	Checked By	T.D. NESBITT	
Scale	1" = 20'	Sheet 5 of 19	
Approved	<i>[Signature]</i>	Date	APRIL 14, 1989
			D 618040-05

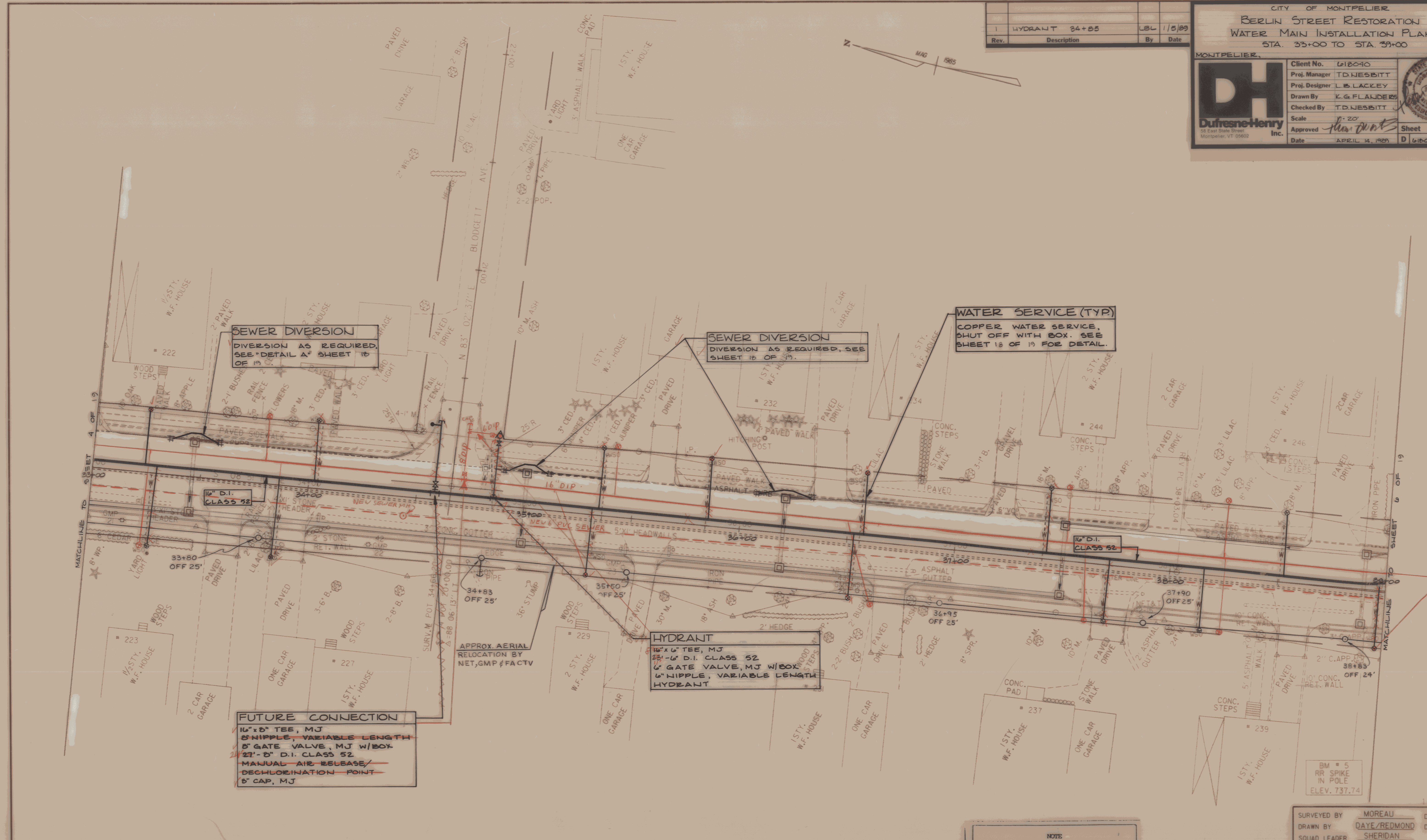

**SEWER DIVERSION**  
DIVERSION AS REQUIRED, SEE "DETAIL A" SHEET 18 OF 19

**SEWER DIVERSION**  
DIVERSION AS REQUIRED, SEE SHEET 18 OF 19.

**WATER SERVICE (TYP)**  
COPPER WATER SERVICE, SHUT OFF WITH BOX. SEE SHEET 18 OF 19 FOR DETAIL.

**HYDRANT**  
16" x 6" TEE, MJ  
22" D.I. CLASS 52  
6" GATE VALVE, MJ W/BOX  
6" NIPPLE, VARIABLE LENGTH  
HYDRANT

**FUTURE CONNECTION**  
16" x 6" TEE, MJ  
6" NIPPLE, VARIABLE LENGTH  
6" GATE VALVE, MJ W/BOX  
22" D.I. CLASS 52  
MANUAL AIR RELEASE/  
DECHLORINATION POINT  
6" CAP, MJ

APPROX. AERIAL RELOCATION BY NET, GMP & FACTV

**NOTE**  
The Owner reserves the right to delete any or all of the above utility relocation work and perform the relocation work with their own forces. The contractor should confirm material and quantities prior to ordering.

**THIS SHEET FOR UTILITIES USE ONLY**

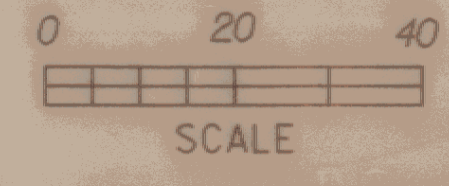

**DATUM**  
VERTICAL NGVD 1929  
HORIZONTAL N/A

15-FEB-1989

SURVEYED BY	MOREAU	DATE	7-85
DRAWN BY	DAYE/REDMOND	DATE	4-88
SQUAD LEADER	SHERIDAN		
DESIGN FILE NO.	76B033	DATE PLOTTED	
PROJ. NAME	MONTPELIER		
PROJ. NO.	MEGC M6400(7)		
SHEET	88 OF 325 SHEETS		