

DATE: \_\_\_\_\_  
 BY: \_\_\_\_\_  
 SURVEYED: \_\_\_\_\_  
 PLOTTED: \_\_\_\_\_  
 AREAS: \_\_\_\_\_  
 AREAS CHECKED: \_\_\_\_\_  
**FINAL SURVEY NOTE BOOK**  
 No. \_\_\_\_\_

DATE: \_\_\_\_\_  
 BY: \_\_\_\_\_  
 SURVEYED: \_\_\_\_\_  
 PLOTTED: \_\_\_\_\_  
 AREAS: \_\_\_\_\_  
 AREAS CHECKED: \_\_\_\_\_  
**ORIGINAL SURVEY NOTE BOOK**  
 No. \_\_\_\_\_

183+70 Pay Endoraa 1/2 183+50 - Estimated 190<sup>th</sup> v R.Lom

GRADES FOR 100+105 Carry over to lower limits - grade change only attributed final grade - Per additional dense grade of stone R.Lom

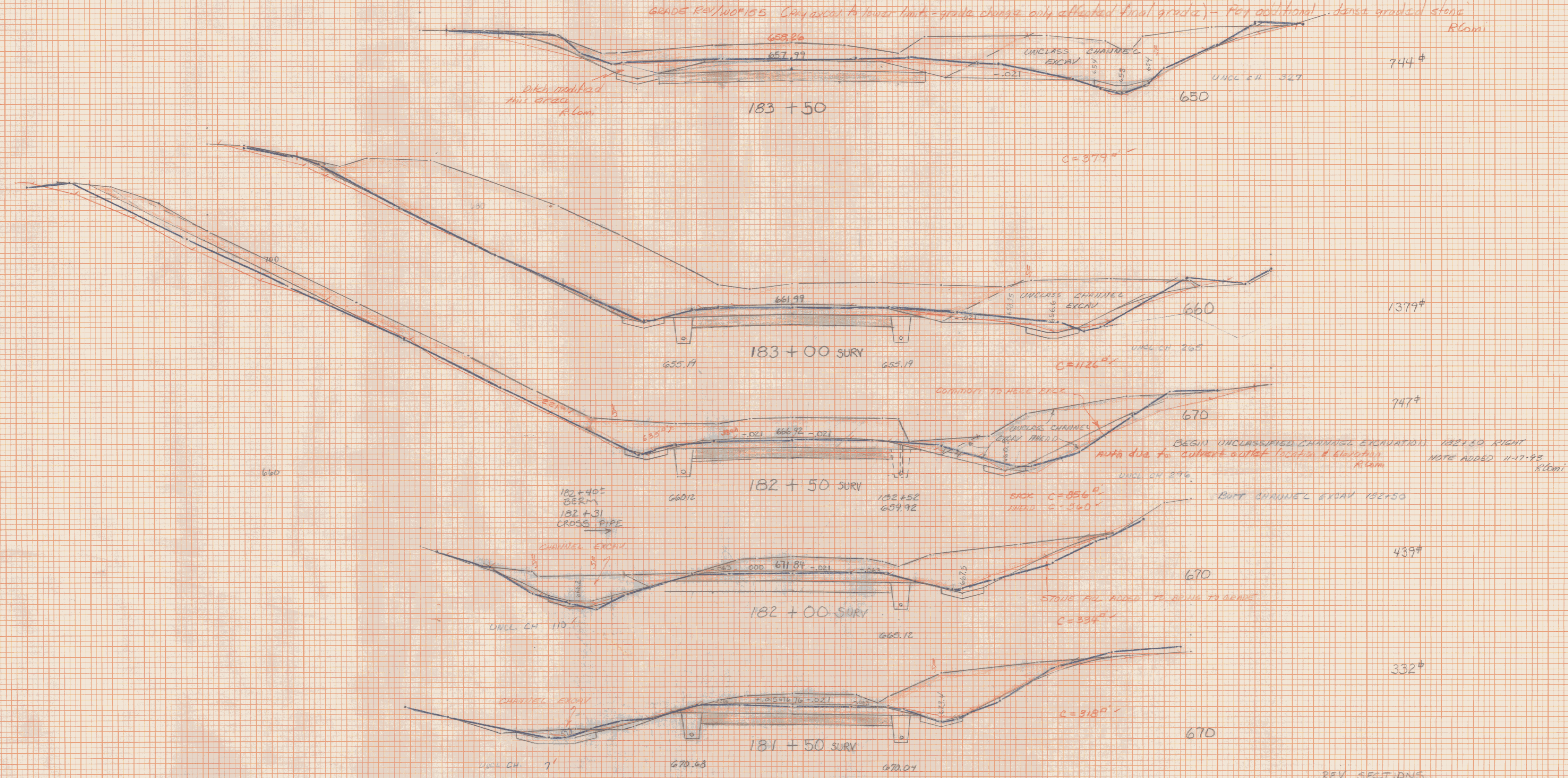

Plan Plot by V.S. Survey - Started May 1993 - Record Book # 676

FIGURE PLOTTED BY R.Lom 11-17-93  
 UNCLASSIFIED PLOTTED BY R.Lom 12-7-93  
 UNCLASSIFIED PLOTTED BY R.Lom 12-7-93  
 PLANS BY C.S. LOM 2-3-94  
 CHECKED R.Lom 2-4-94

REV SECTIONS  
 STA 181+50 SURV ~ 183+50 SURV  
 EAST MONTPELIER  
 RS EGG RS 0246 (1)  
 SHEET 17A OF 17A