

DATE
BY
SURVEYED
PLOTTED
TEMPERATURE
AREAS CHECKED
NO.

DATE
BY
SURVEYED
PLOTTED
TEMPERATURE
AREAS CHECKED
NO.

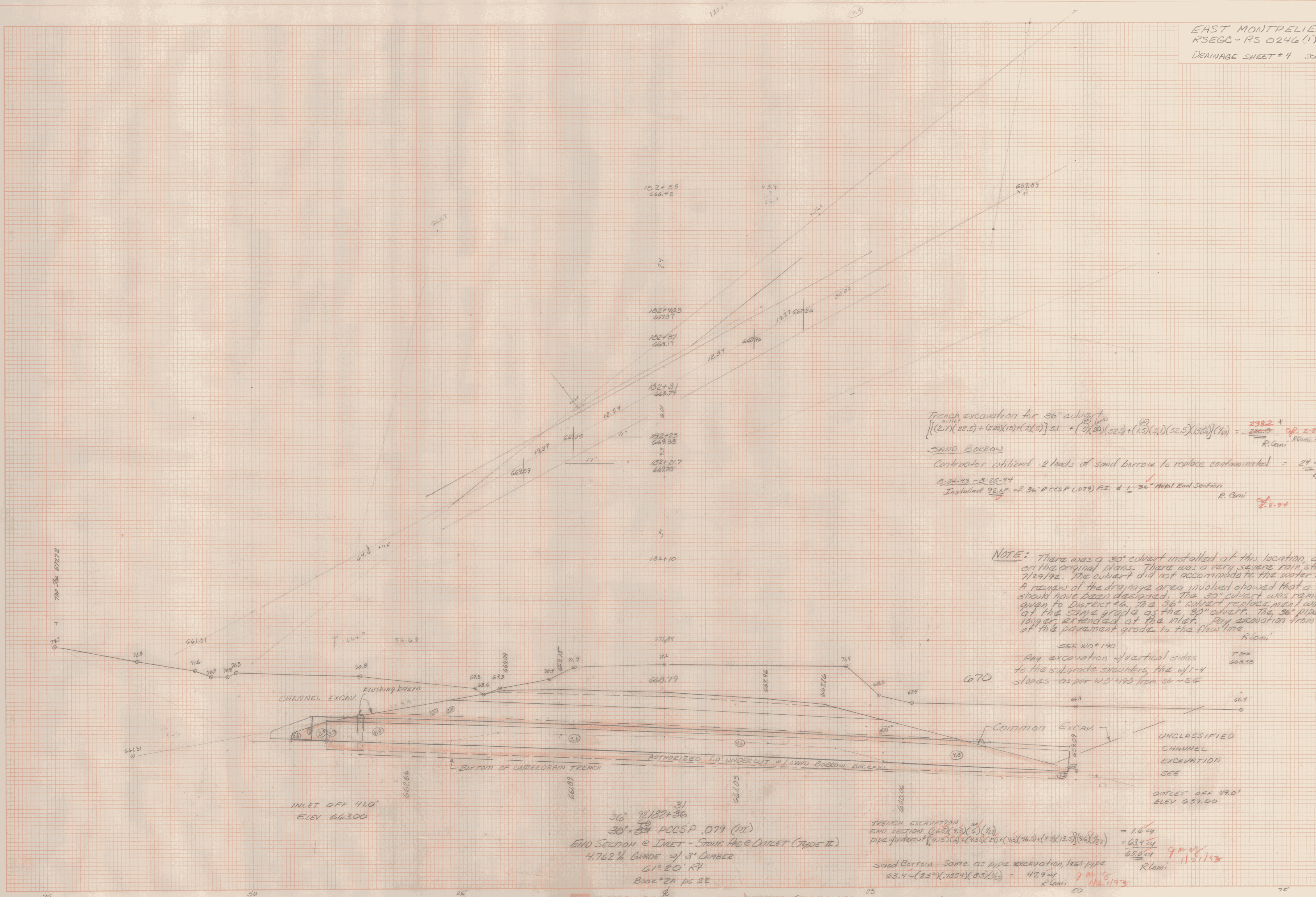

Trench excavation for 36" culvert

$$\left[(2.7)(22.5) + (2.0)(19) + (2)(5) \right] 5.1 + \left[(3)(30)(52.5) + (1.5)(5.1)(52.5)(150)(1.2) \right] (1.2) = \frac{2382}{246.5} \times \frac{1.2}{1.2} = 29.2 \text{ cu yd}$$
 R. Cerri 2-11-94

SAND BORROW
 Contractor utilized 2 loads of sand borrow to replace contaminated = 24 cu yd
 R. Cerri 2-11-94

Installed 92 LF of 36" PCCSP (079) PE & 1-36" Metal End Section
 R. Cerri 2-11-94

NOTE: There was a 30" culvert installed at this location, as indicated on the original plans. There was a very severe rain storm on 7/29/92. The culvert did not accommodate the water runoff. A review of the drainage area involved showed that a 36" culvert should have been designed. The 30" culvert was removed and given to District #6. The 36" culvert replacement was installed at the same grade as the 30" culvert. The 36" pipe was 2' longer, extended at the inlet. Pay excavation from the bottom of the pavement grade to the flowline.
 R. Cerri

SEE WD # 190
 Pay excavation of vertical sides to the subgrade shoulders the w/ 1-4 slopes as per WD # 190 from st - 56
 670

UNCLASSIFIED CHANNEL EXCAVATION SEE

OUTLET OFF 49.0' ELEV 659.00

36" PCCSP .079 (PI)
 END SECTION @ INLET - Stone Pad @ Outlet (Type II)
 4.762% GRADE w/ 3" CHAMBER
 61' 20" RT
 Book # 2A ps 22

TRENCH EXCAVATION
 END SECTION $(1.5)(4.5)(6)(1.2) = 5.4 \text{ cu yd}$
 PIPE UNDERCUT $(4.5)(6) + (4.5)(24) + (4.5)(46.5) + (2.5)(13.5)(4.5)(1.2) = 63.4 \text{ cu yd}$
 SAND BORROW - Same as pipe excavation, less pipe
 $63.4 - (2.5^2)(.7854)(.85)(16) = 47.9 \text{ cu yd}$
 R. Cerri 11-21-93