

REV. 120+25 LT.
End 6"x125' Underdrain
Begin 6"x30' Carrier Pipe

REV. 120+25 LT.
End 6"x625' Underdrain
Begin 6"x30' Carrier Pipe

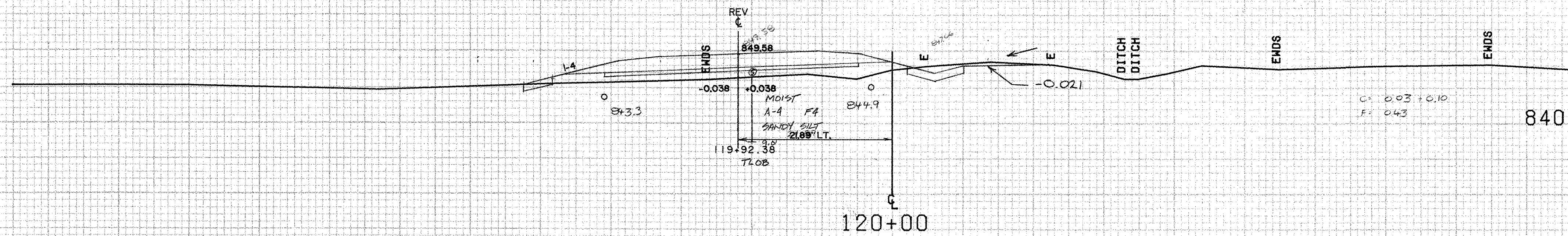

+66
10' POP

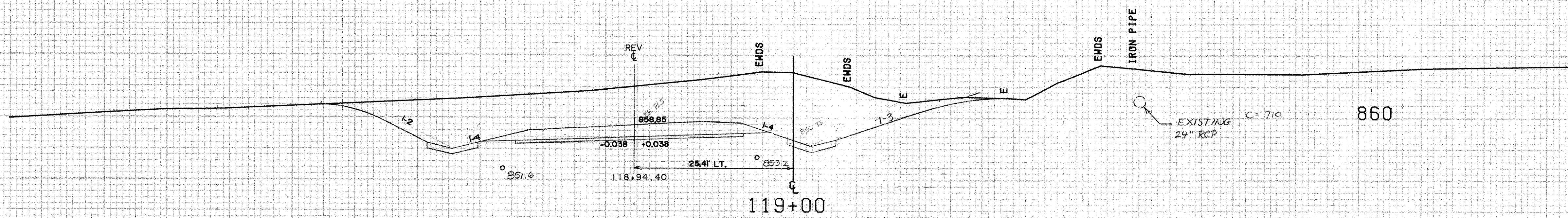
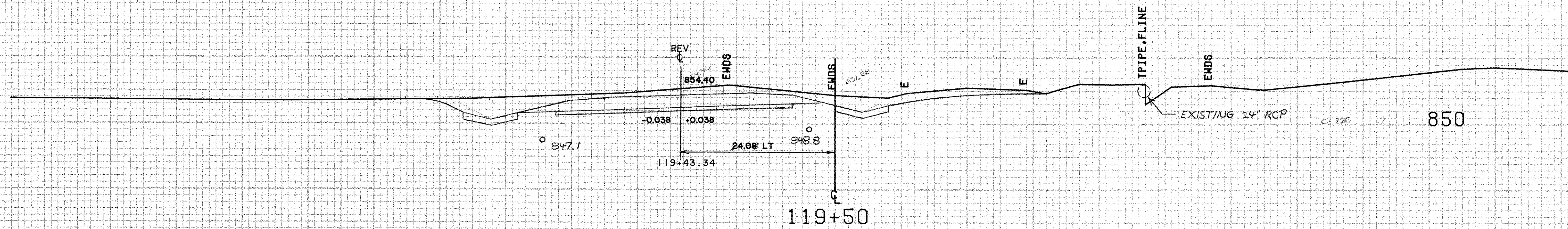

SCALE 10 FEET

FROM STA.	119+00	TO STA.	120+00
PROJECT NAME	EAST MONTPELIER MAIN		
NO.	RS0246(1)	PLOTTED	02/24/83
SURVEYED BY	LAVALLEE	JAN82	
SHEET	41	OF 128	SHEETS