

* Outlet Drip Notches
3' from Face of
Abutments

TYPICAL SECTION

Scale $\frac{3}{8}'' = 1'-0''$

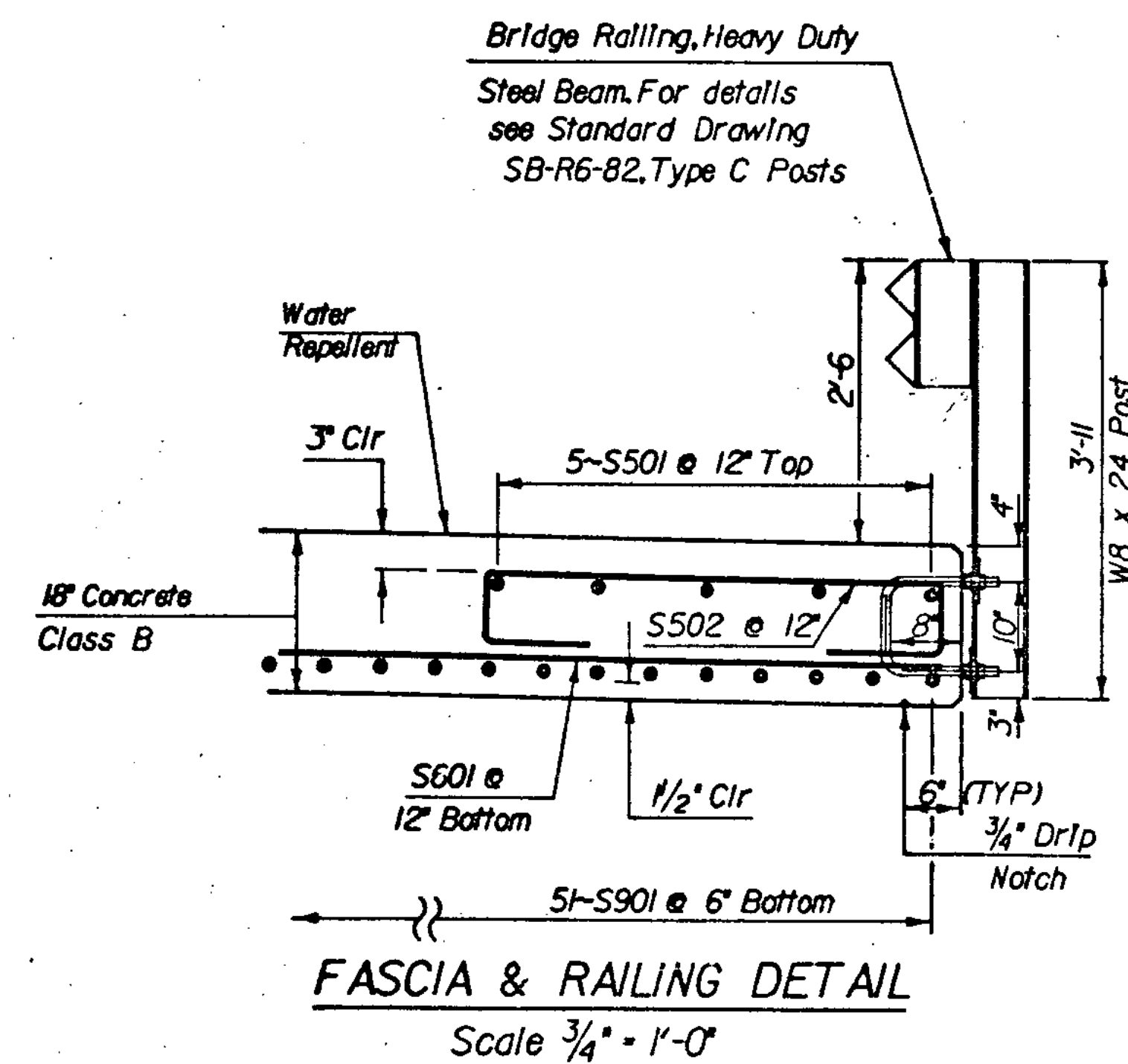
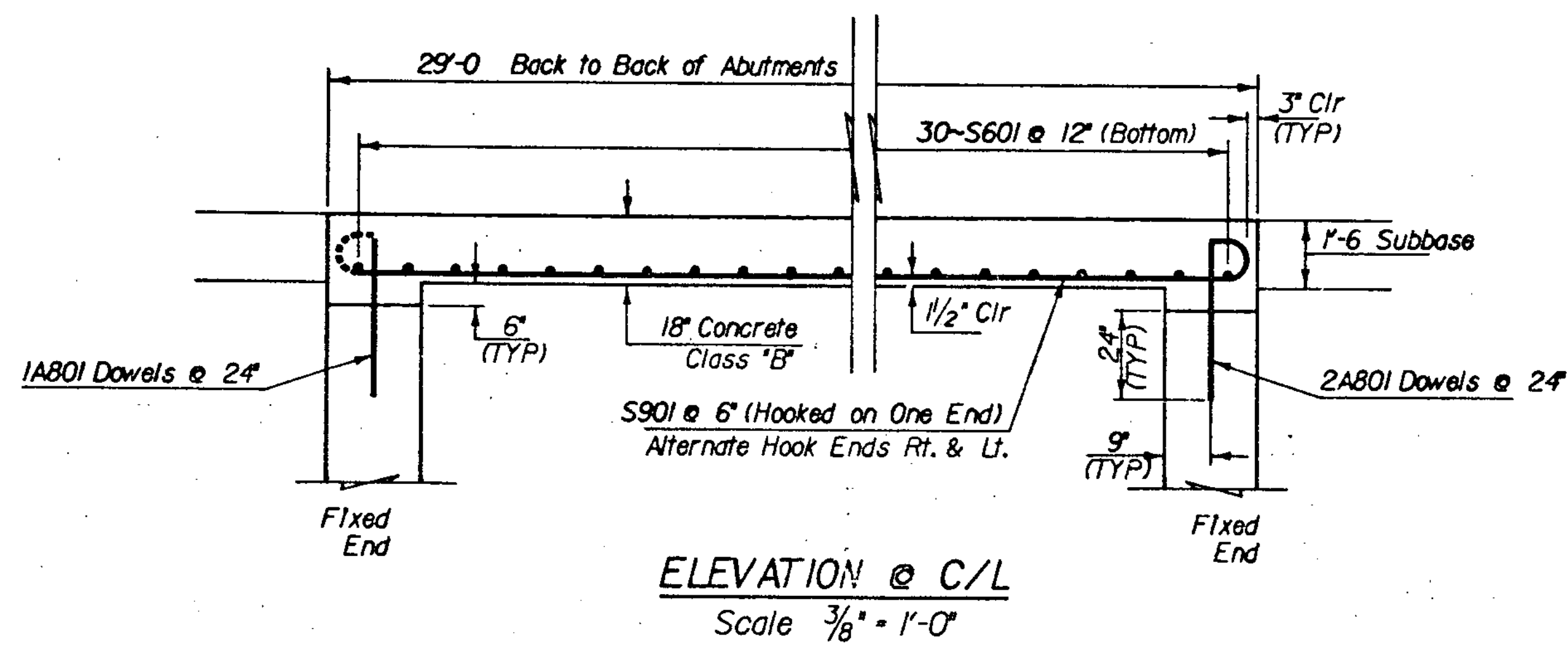

**STATE OF VERMONT
AGENCY OF TRANSPORTATION**

Town Of	MORRISTOWN	Bridge No.	35
Highway No.	TH 64	Log Sta.	
		Surv. Sta.	8+60.50
Town Highway No. 64 over Sterling Brook			

SLAB DETAIL SHEET

Designed By	C. P. Williams	Drawn By	E. Blodgett
Checked By	D. W. Newton	Bridge Design Supervisor	F. W. Balkum
Date	8/84	Date	9/84

PROJECT	MORRISTOWN	PROJECT NO.	FTH 3531
---------	------------	-------------	----------

LG.C. info. Q544(30,23)FTH3531/SL.DGN
Bridge Sheet No. Sheet 5 of 23