

**REV. CURVE DATA**  
 $\Delta = 14^{\circ}00'00''$  RT  
 $D = 20^{\circ}00'00''$   
 $R = 286.48$   
 $T = 35.18$   
 $L = 70$  FT  
 $E = 2.15$   
 $2T-L = 0.36$

BM #1  
 ELEV 1160.58  
 CH. SQ @ SE  
 CORNER OF ABUT

BRIDGE RAIL - HEAVY DUTY  
 STEEL BEAM TYPE E  
 51+77 RT - 52+60 RT  
 51+77 LT - 52+60 LT

GUARD RAIL - HEAVY DUTY  
 STEEL BEAM W/ WOOD POSTS  
 TYPE II

SUR 50+59.5 RT - 51+77 RT  
 CRK 52+60 RT - 53+29 RT  
 SUR 50+53 LT - 51+77 LT  
 CRK 52+60 LT - 53+78 LT  
 54+09 LT - 55+10 LT

END R.O.W. PROJECT  
 BRZ 1449(14) REV. STA. 56+00 22' LT.  
 END PROJECT STA 58+00

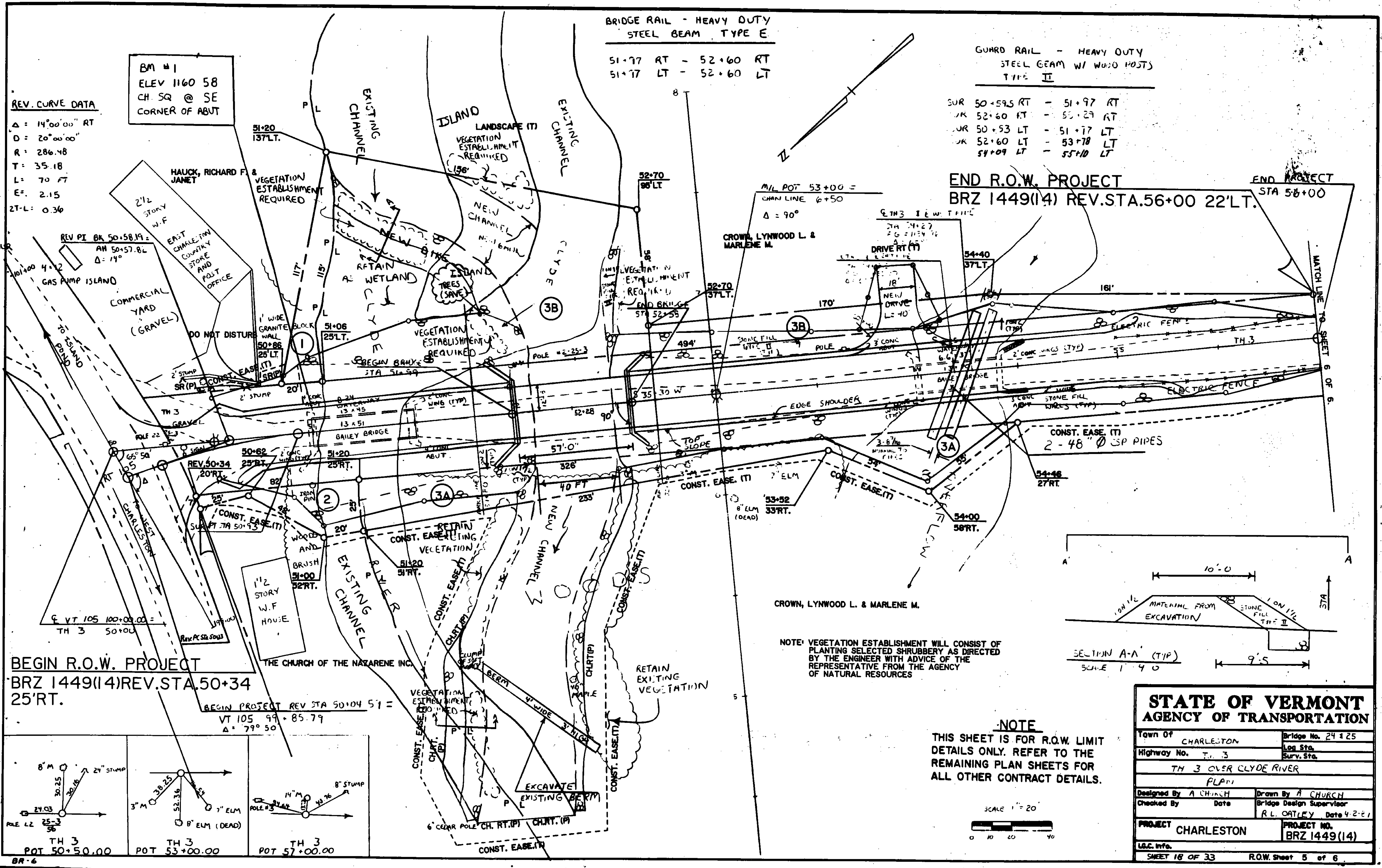

BEGIN R.O.W. PROJECT  
 BRZ 1449(14) REV. STA. 50+34  
 25' RT.

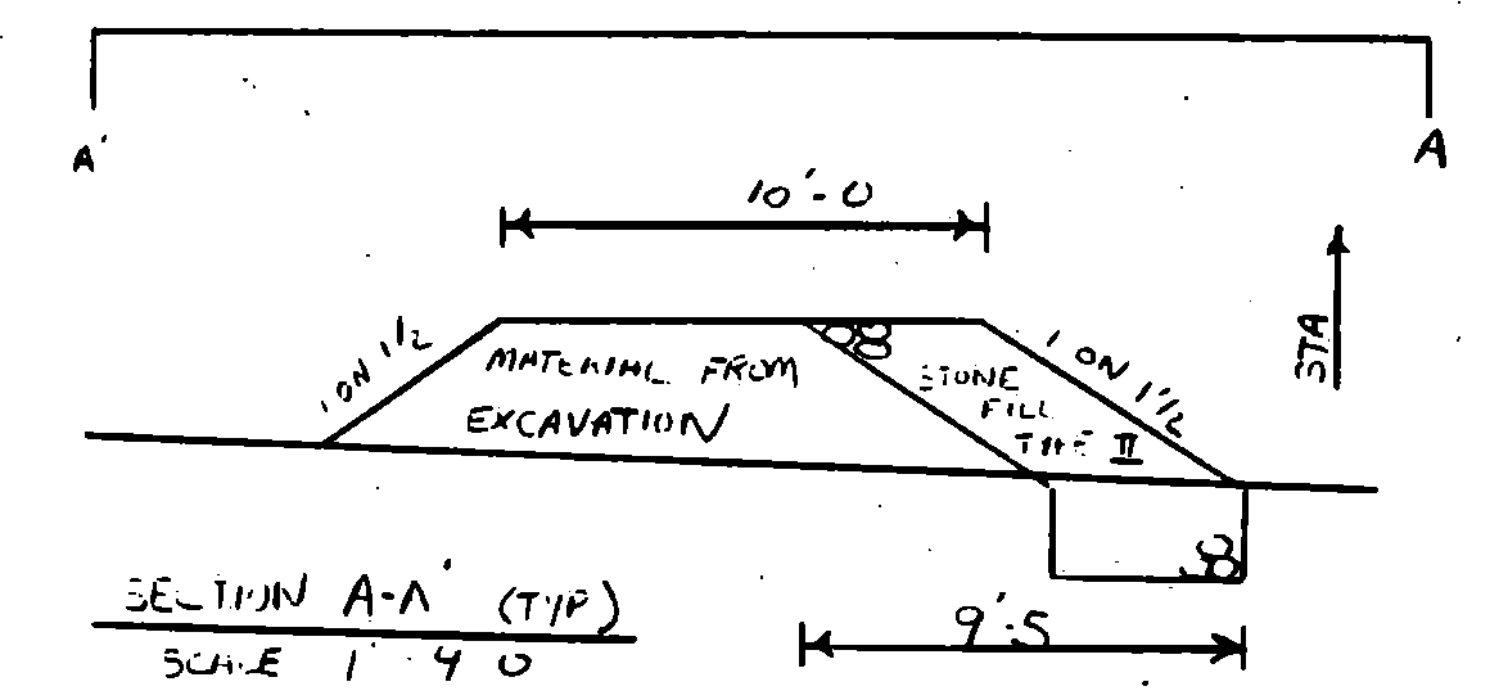
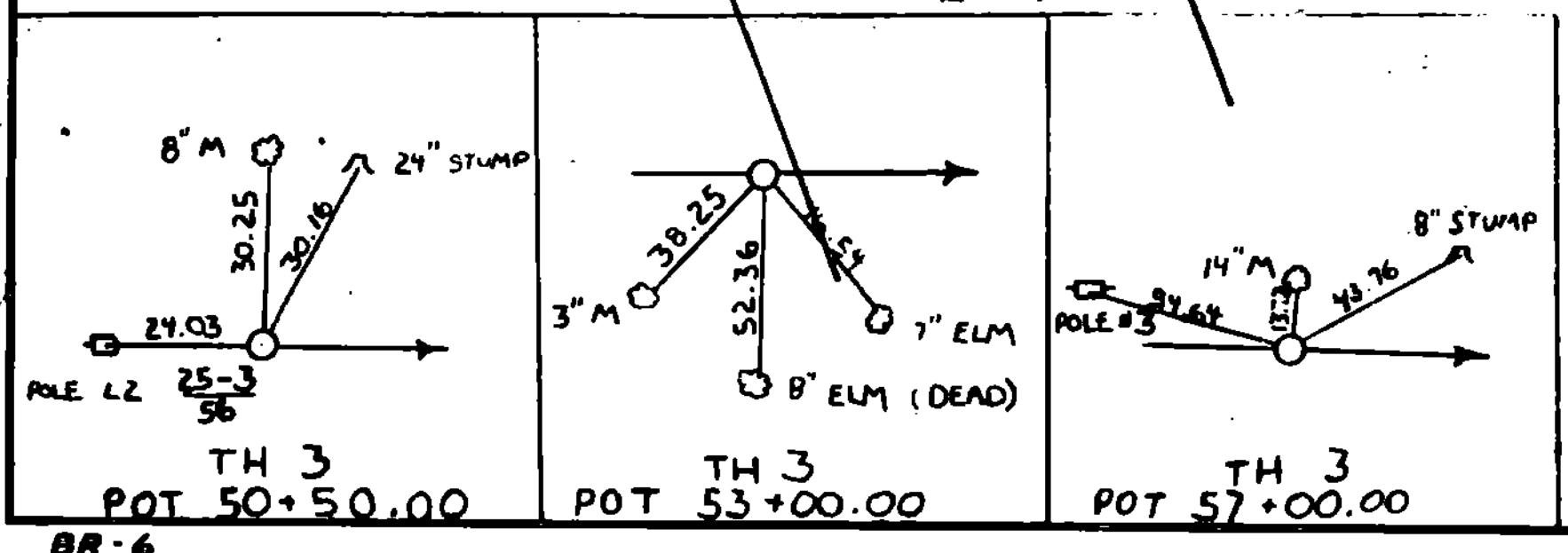

NOTE: VEGETATION ESTABLISHMENT WILL CONSIST OF PLANTING SELECTED SHRUBBERY AS DIRECTED BY THE ENGINEER WITH ADVICE OF THE REPRESENTATIVE FROM THE AGENCY OF NATURAL RESOURCES

**NOTE**  
 THIS SHEET IS FOR R.O.W. LIMIT DETAILS ONLY. REFER TO THE REMAINING PLAN SHEETS FOR ALL OTHER CONTRACT DETAILS.

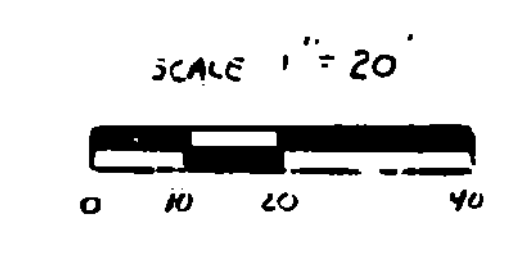

<b>STATE OF VERMONT AGENCY OF TRANSPORTATION</b>	
Town Of CHARLESTON	Bridge No. 24 & 25
Highway No. TH 3	Log Sta. Surv. Sta.
TH 3 OVER CLYDE RIVER	
PLAN	
Designed By A CHURCH	Drawn By A CHURCH
Checked By Date	Bridge Design Supervisor R.L. OATLEY Date 4-2-81
PROJECT CHARLESTON	PROJECT NO. BRZ 1449(14)
SHEET 18 OF 33 R.O.W. Sheet 5 of 6	

DRAWING SCALE 1" = 40'

BR-6